

OVERHEAD EASEMENT (RIGHT OF WAY) NO. O-1466

On DEC 17TH, 1991, for the consideration of system betterment, Grantor grants to Grantee a permanent overhead easement ("Right of Way") in, on and across a part of Grantor's Land called the "Right of Way Area".

"Grantor" is:

Stephen J. Crowley and Kathryn S. Crowley, husband and wife, 190 Corey Ct., Ortonville, Michigan 48462

"Grantee" is:

The Detroit Edison Company, a Michigan corporation, 2000 Second Avenue, Detroit, Michigan 48226

"Grantor's Land" is in Brandon Township, Oakland County, described as:

Part of SW 1/4, Sec. 10, T5N., R9E., beg at pt dist S 00°17'18" E 592.72 ft and N 89°39'17" E 187.77 ft from W 1/4 cor, th N 89°39'17" E 200 ft, th S 33°09'20" E 876.30 ft, th S 89°51'34" W 370 ft, th N 22°51'57" W 795.88 ft to beginning. 4.81 acres. Sidwell No: 03-10-300-028

The "Right of Way Area" is a part of Grantor's Land and is described as:

A 10 foot wide easement with its C/L described as follows: Beg at a pt located on the C/L of Corey Ct., approximately 5 feet W of the E P/L thence in a southeasterly direction approximately 265 feet to a pt, said pt being located approximately 5 feet W of the E P/L and pt of ending.

- 1. Purpose:** The purpose of this Right of Way is to construct, reconstruct, modify, add to, operate and maintain overhead utility line facilities consisting of poles, guys, anchors, wires, cables, transformers and accessories.
- 2. Access:** Grantee has the right of access to and from the Right of Way Area.
- 3. Buildings or other Permanent Structures:** No buildings or other permanent structures shall be placed in the Right of Way Area without Grantee's prior written consent.
- 4. Trees, Bushes, Branches or Roots:** Grantee may trim, cut down, remove or otherwise control any trees, bushes, branches or roots in the Right of Way Area (or that could grow into the Right of Way Area) that Grantee believes could interfere with the safe and reliable construction, operation and maintenance of Grantee's facilities.
- 5. Restoration:** If Grantee's employees, contractors, vehicles or equipment damage Grantor's Land while entering Grantor's Land for the purposes stated in this Right of Way, then Grantee shall restore Grantor's Land as nearly as can be to its original condition.
- 6. Successors:** This Right of Way runs with the land and binds and benefits Grantor's and Grantee's successors, lessees, licensees and assigns.

Witnesses:(type or print name below signature)

Grantor:(type or print name below signature)

Gayle Brooks
 GAYLE BROOKS

Lorraine H. Patchett
 LORRAINE H. PATCHETT

Stephen J. Crowley
 Stephen J. Crowley

Kathryn S. Crowley
 Kathryn S. Crowley

O.K. — LM

Acknowledged before me in OAKLAND County, Michigan, on December 17TH, 1991 by STEPHEN J. CROWLEY AND KATHRYN S. CROWLEY, HUSBAND AND WIFE.

TERRY L. BENEDICT
 Notary Public, Oakland County, MI
 Notary's Stamp My Commission Expires July 1, 1992

Notary's Signature *Terry L. Benedict*

Prepared by and Return to: Terry L. Benedict, 30400 Telegraph Rd., Suite 277, Birmingham, Mi 48025

#36 REG/DEEDS FRI
 0001 MAR.06.92 12:34PM
 5424 MISC 7.00

#36 REG/DEEDS FRI
 0001 MAR.06.92 12:34PM
 5424 RPT FEE 2.00

RECORDED RIGHT OF WAY NO. 48998

T. Benedict

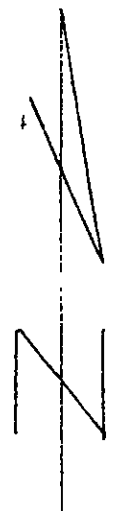
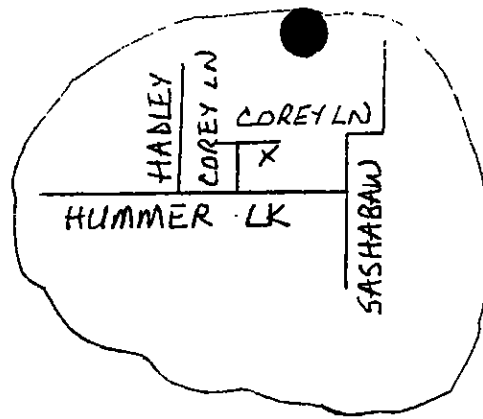

RECORDED RIGHT OF WAY NO. 41798

W. 1/4 COR.
W. 1/2 SEC. 10
T. 5N R. 9E

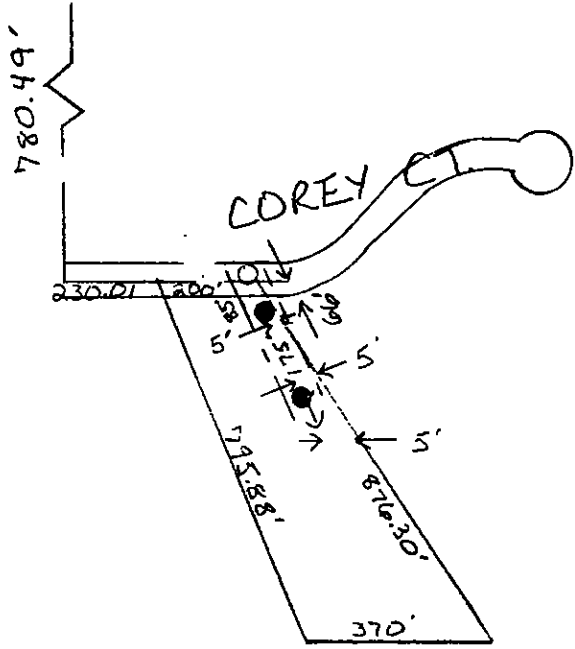

ARMLESS CONSTRUCTION
IN 40' + 45' POLE
DOWN GUY ANCHOR
@ 20' FROM POLE

SIDWELL# D3-10-300-028
190 COREY CT
C/O 2537 SOMERSET APT. 214
TROY, MI 48084
STEPHEN J. CROWLEY
KATHRYN S. CROWLEY > R/W SECURED
PH# 362-3767 #
583-8268 W

R/W SECURED BY TERRY BENEDICT

THE DETROIT EDISON COMPANY-SERVICE PLANNING DEPARTMENT				
LEGEND FOREIGN POLE EXIST D.E. CO. POLE PROPOSED POLE EXIST ANCHOR PROPOSED ANCHOR TREE 120/240 VOLT LINE 4800 VOLT LINE 13,200 VOLT LINE 40,000 VOLT LINE	CITY OR TOWNSHIP Brandon		COUNTY Oakland	
	MAP SECT 2-250-496		QTR & TWP SECT NO W. 1/2 10	DEPT ORDER NO A54405
	PROJECT NAME		TOWN 5N	RANGE 9E
	CIRCUIT 8822 WOLF#		JOINT R/W REQUIRED YES <input type="checkbox"/> NO <input checked="" type="checkbox"/>	R/W NO. 01466
	REASON D.H. A/W Request for 190 Corey Ct.		PLANNER P-H. P. HESSY	DATE 9/18/91
SCALE 1" = 400'		PROJ OR PART NO		
OFW SO OR PE, NO		BUDGET ITEM NO		
DE FORM 963-2237 1-80				