

OVERHEAD EASEMENT (RIGHT OF WAY) NO. R 9309816-01

On 2-10, 1994, for the consideration of system betterment, Grantor grants to Grantee a permanent overhead easement ("Right of Way") in, on and across a part of Grantor's Land called the "Right of Way Area".

"Grantor" is:

William A. Poquette and Margaret A. Poquette, Husband and Wife, 1805 White Lake, Highland, Michigan

"Grantee" is:

The Detroit Edison Company, a Michigan corporation, 2000 Second Avenue, Detroit, Michigan 48226

"Grantor's Land" is in the Township of Highland, Oakland County, described as:

Part of Northwest one-quarter (1/4) of Southeast one-quarter (1/4), Town 3 North, Range 7 East, Section 2, beginning at point distant South 89°54'00" East 338.32 feet and South 00°25'30" West 1158.52 feet from center of section, thence South 00°25'30" West 165 feet, thence South 89°09'30" East 270 feet, thence North 00°25'30" East 165 feet, thence North 89°09'30" West 270 feet, to beginning, containing approximately 1.02 acres, more or less, Oakland County Records. Sidwell No. 11-02-401-006.

The "Right of Way Area" is a part of Grantor's Land and is described as:

The East Ten (10) feet of Grantor's land.

- 1. Purpose: The purpose of this Right of Way is to construct, reconstruct, modify, add to, operate and maintain overhead utility line facilities consisting of poles, guys, anchors, wires, cables, transformers and accessories.
2. Access: Grantee has the right of access to and from the Right of Way Area.
3. Building or other Permanent Structures: No buildings or other permanent structures shall be placed in the Right of Way Area without Grantee's prior written consent.
4. Trees, Bushes, Branches or Roots: Grantee may trim, cut down, remove or otherwise control any trees, bushes, branches or roots in the Right of Way Area (or that could grow into the Right of Way Area) that Grantee believes could interfere with the safe and reliable construction, operation and maintenance of Grantee's facilities.
5. Restoration: If Grantee's employees, contractors, vehicles or equipment damage Grantor's Land while entering Grantor's Land for the purposes stated in this Right of Way, then Grantee shall restore Grantor's Land as nearly as can be to its original condition.
6. Successors: This Right of Way runs with the land and binds and benefits Grantor's and Grantee's successors, lessees, licensees and assigns.

Witnesses:(type or print name below signature)

Grantor:(type or print name below signature)

James D. McDonald
JAMES D. McDONALD
Kimberly A. Dinoto
KIMBERLY A. DINOTO

William A. Poquette
William A. Poquette
Margaret A. Poquette
Margaret A. Poquette

Acknowledged before me in OAKLAND County, Michigan, on William A. Poquette and Margaret A. Poquette, Husband and Wife.

PAID 1.00 MISCELLANEOUS RECORDING
RECORDED - OAKLAND COUNTY
RECEIPT# 1658
NOV 94 12:38 P.M.
LYNN D. ALLEN, CLERK/REGISTER OF DEEDS
\$ 2.00 RENOVIMENTATION

JAMES D. McDONALD
Notary Public, Oakland County, MI
My Commission Expires April 24, 1995
Notary's Stamp (Notary's name, county and date commission expires)

Notary's Signature James D. McDonald

Prepared by and Return to: James D. McDonald, 30400 Telegraph Road, Suite 210, Birmingham, Michigan 48025/kad

1.00
2.00 RMT

OK - G.K.

RECORDED RIGHT OF WAY NO. 46433

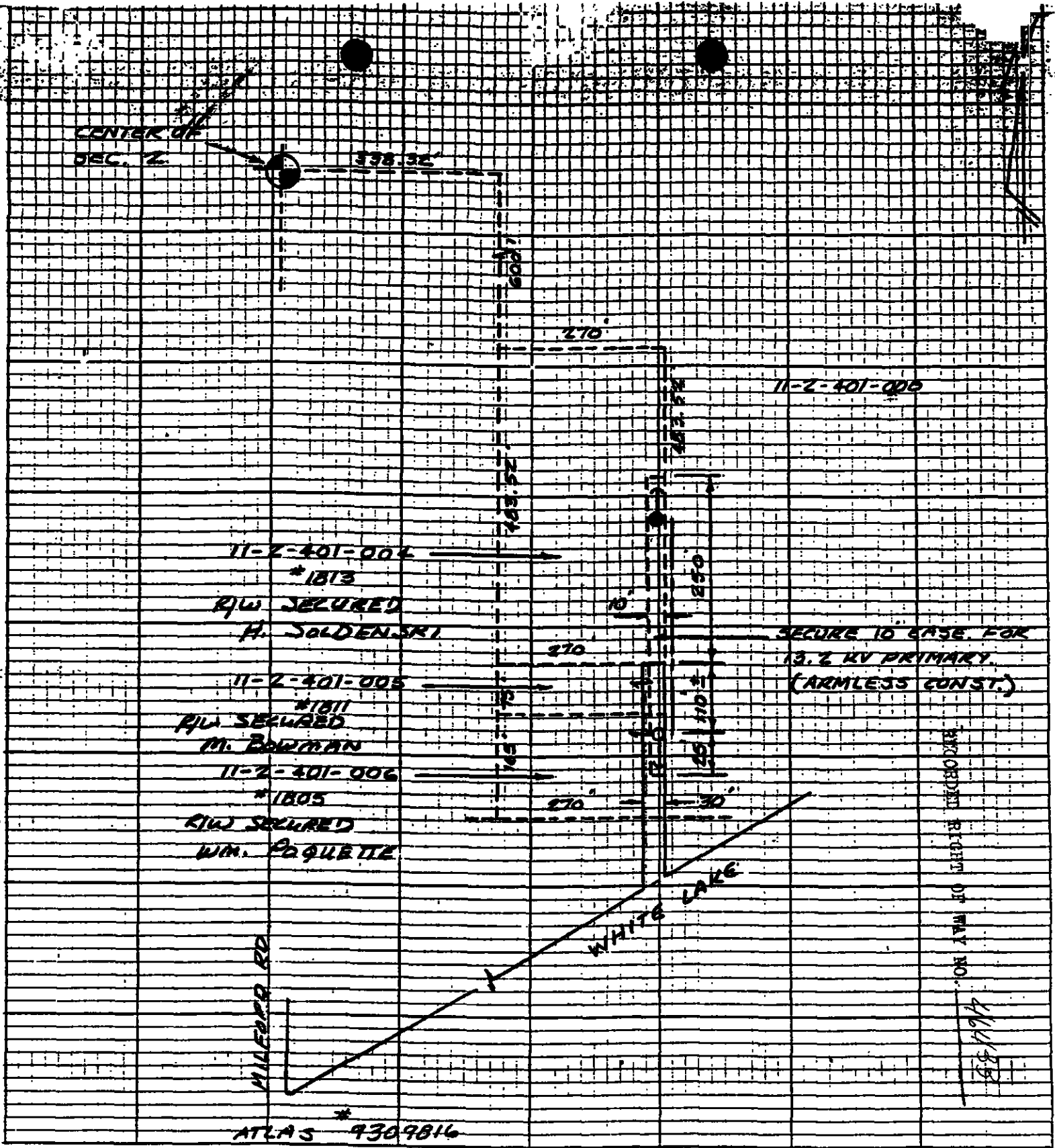

PROPOSED RIGHT OF WAY NO. 481185

LEGEND	
	FOREIGN POLE
	EXIST D.E. CO. POLE
	PROPOSED POLE
	EXIST ANCHOR
	PROPOSED ANCHOR
	TREE
	120/240 VOLT LINE
	4800 VOLT LINE
	13,200 VOLT LINE
	40,000 VOLT LINE

THE DETROIT EDISON COMPANY-SERVICE PLANNING DEPARTMENT			
CITY OR TOWNSHIP HIGHLAND	COUNTY OAKLAND	CTR. & TWP. SECT. NO. SE SEC. 2	DEPT. ORDER NO.
MAP SECT. 2-196-432	TOWN T3N	RANGE R7E	JOINT R/W REQUIRED YES <input type="checkbox"/> NO <input checked="" type="checkbox"/>
PROJECT NAME HELEN SOLDENSKI			R/W NO. R-9309816-01
CIRCUIT DC-8009 WHTLK			PROJ. OR PART NO.
REASON NEW RES. CUST. AT 1813 WHITE LK RD.			O.F.W. S.O. OR P.E. NO.
PLANNER RON GRAY			BUDGET ITEM NO.
SCALE 1" = 200'		DATE 1-14-94	