

LIBR 12174 PG 274

**Detroit
Edison**

[Handwritten signature]

OVERHEAD EASEMENT (RIGHT-OF-WAY) NO. 0-1374

On September 12, 1991, for the consideration of system betterment, Grantor grants to Grantee a permanent overhead easement ("Right-of-Way") in, on and across a part of Grantor's Land called the "Right of Way Area".

"Grantor" is: Sun Refining and Marketing Company, A Pennsylvania Corporation, Successor by merger and name change to Sun Oil Company, a New Jersey Corporation, 1801 Market St., Philadelphia, PA 19103.

"Grantee" is: The Detroit Edison Company, a Michigan corporation, 2000 Second Avenue, Detroit, Michigan, 48226; and United Artists Cable of Oakland County, Inc., 4500 Delemere Boulevard, Royal Oak, Michigan 48073.

"Grantor's Land" is in the City of Rochester, Oakland County, Michigan described as: Part of SW 1/4, Sec. 11 T3N, R11E, Supervisor's replat of blocks 1, 2, 3 & part of blocks 6 & 7 of Woodward's add Lot 22 exc beg at SE lot cor, th N 00°44'00" W 149.60 ft, th S 89°16'00" W 50.00 ft, th S 00°44'00" E 82.00 ft, th S 88°12'43" W 189.91 ft, th S 28.01 ft, th N 88°12'43" E 190.19 ft, th S 00°44'00" E 68.19 ft, th northerly 58.29 ft to beg. Sidwell No: 15-11-305-021.

The "Right of Way Area" is a part of Grantor's Land described as: Two anchors for support as shown on Detroit Edison Company drawing 0-1374 dated 8-5-91 which is attached hereto and made a part hereof. The right of way is three (3) feet in width.

- Purpose:** The purpose of this Right of Way is to construct, reconstruct, modify, add to, operate and maintain overhead utility line facilities consisting of poles, guys, anchors, wires, cables, transformers and accessories.
- Access:** Grantee has the right of access to and from the Right of Way Area.
- Buildings or other Permanent Structures:** No buildings or other permanent structures shall be placed in the Right of Way Area without Grantee's prior written consent.
- Trees, Bushes, Branches or Roots:** Grantee may trim, cut down, remove or otherwise control any trees, bushes, branches or roots in the Right of Way Area (or that could grow into the Right of Way Area) that Grantee believes could interfere with the safe and reliable construction, operation and maintenance of Grantee's facilities.
- Restoration:** If Grantee's employees, contractors, vehicles or equipment damage Grantor's Land while entering Grantor's land for the purposes stated in this Right of Way, then Grantee shall restore Grantor's Land as nearly as can be to its original condition.
- Successors:** This Right of Way runs with the land and binds and benefits Grantor's and Grantee's successors, lessees, licensees and assigns.
- Grantee indemnifies Grantor from liability resulting from Grantee's exercise of Rights granted herein.**

REG. FEES PAID
0001 NOV.13.91 01:24PM
2158 RMT FEE 2.00

Witnesses
[Signature]
Charles Schanz
[Signature]
Richard Merchant, III

Grantor:
SUN REFINING AND MARKETING COMPANY
A Pennsylvania Corporation
[Signature]
By: Thomas N. Tosko, Manager, Real Estate

11.00
2.00 RMT
CORRECTED RIGHT OF WAY NO. 42394

Acknowledged before me in Philadelphia County, Pennsylvania, on September 12, 1991 by Thomas N. Tosko, the Manager, Real Estate of Sun Refining and Marketing Company, a Pennsylvania corporation, for the corporation.

[Signature]
Notary's Signature

NOTARIAL SEAL
ELAINE A. WIGGINS, Notary Public
Philadelphia, Philadelphia County
My Commission Expires Nov. 14, 1994

OK - G.K.

OWNER:
 R/W FOR A SIDE WALK
 ANCHOR GUY
 SUNOCO GAS STA.
 SUN OIL CO.
 LARRY WILCOX
 313-591-1327
 FAX 591-3558
 IN-30-3555
 IN-5/16 POLE GUY
 IN-5/16 S.W. GUY

LIBER 12174PG275

OWNER

ST. PHILIP'S EPISCOPAL CHURCH
 100 ROMEO RD + ROCHESTER
 CITY ROCHESTER, MI
 CONTACT DENNIS SCHLITZ
 313 476-9870
 15-11-351 001 -

CHURCH

1-322-434

RUSH!

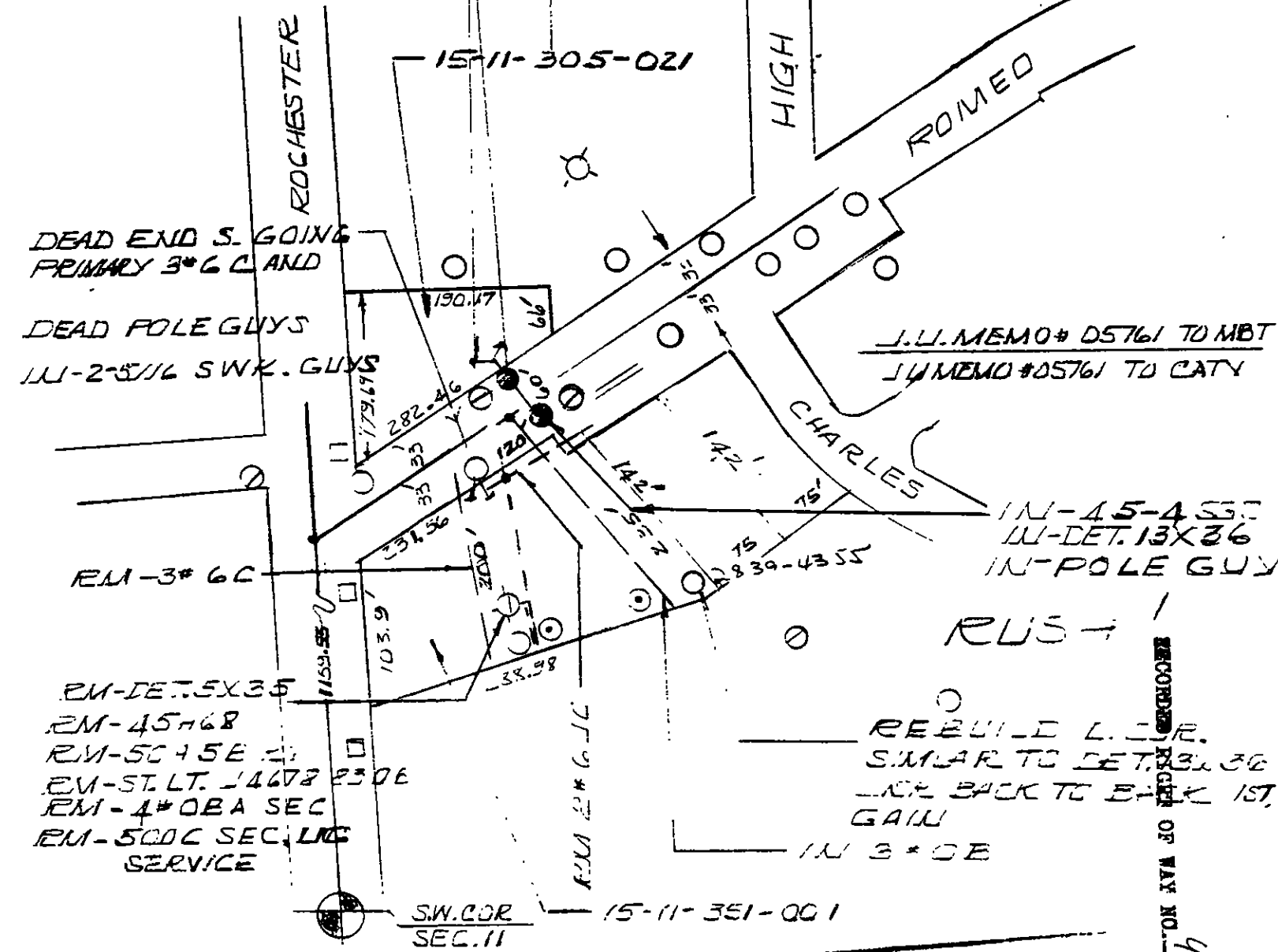

LEGEND

- FOREIGN POLE
- EXIST D.E. CO. POLE
- PROPOSED POLE
- EXIST ANCHOR
- PROPOSED ANCHOR
- TREE
- 120/240 VOLT LINE
- 4800 VOLT LINE
- 13,200 VOLT LINE
- 40,000 VOLT LINE

THE DETROIT, MICHIGAN, COMMUNITY SERVICE PLANNING DEPARTMENT

CITY OR TOWNSHIP ROCHESTER CITY	COUNTY WAYNE	HQ. CORR. & TWP. SECT. NO.	DEPT. ORDER NO. REL 370
MAP SECT. 1-322-434	TOWN ROCK	RANGE 18	JOINT R/W REQUIRED YES <input type="checkbox"/> NO <input type="checkbox"/>
PROJECT NAME DC 1338	TEL. ENGR. & DIST. 3M	SCALE N.T.S.	DATE 8-5-91
REASON R/W FOR 100' ROMEO	PLANNER JOHNIE MARTIN	PLANNING DEPARTMENT	BUDGET ITEM NO.

POLE AND GUY

1-322-487

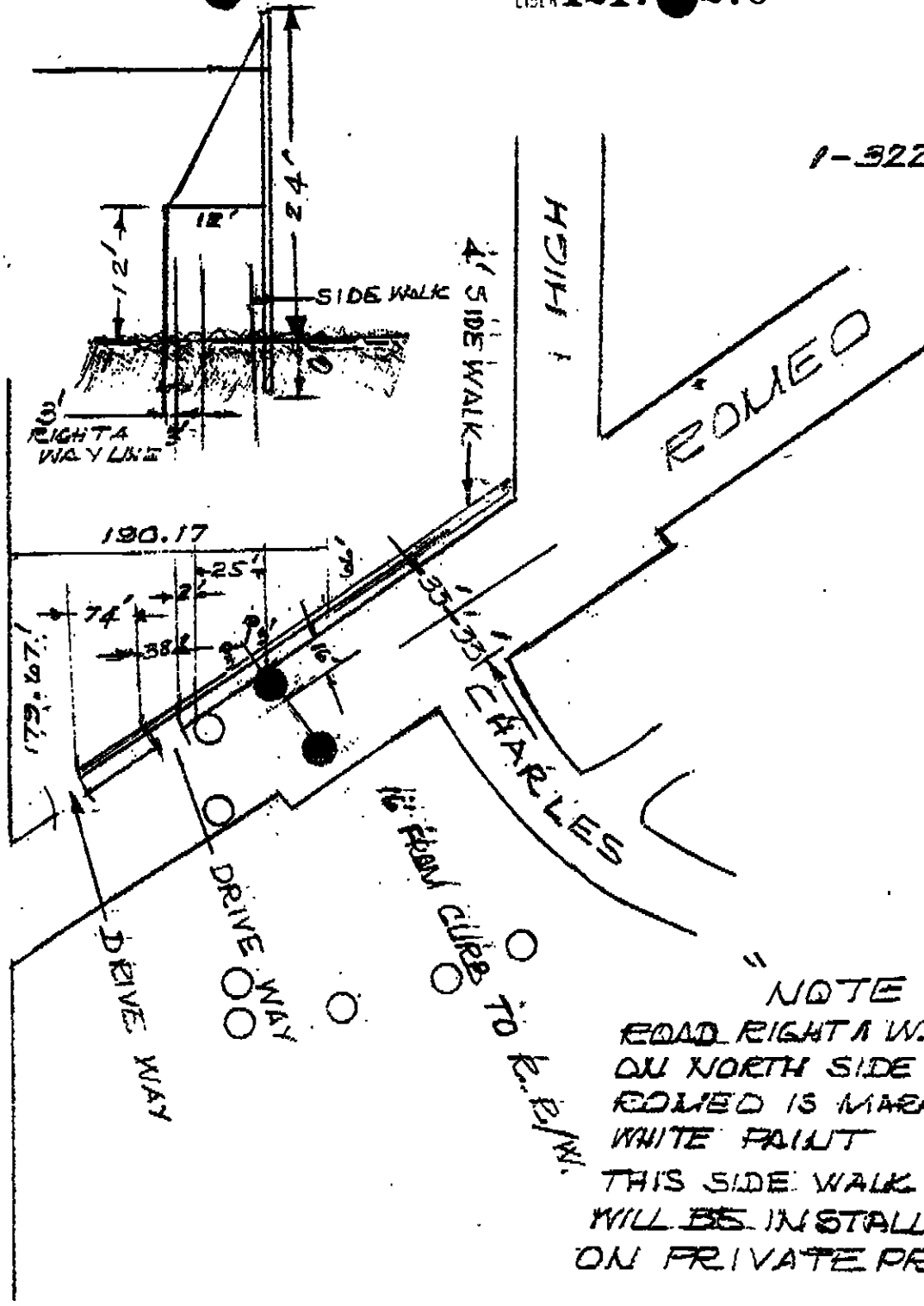

RECORDING TICKET OR MAP NO. 42394

"NOTE"
 ROAD RIGHT-A-WAY
 ON NORTH SIDE OF
 ROCHED IS MARKED WITH
 WHITE PAINT
 THIS SIDE WALK GUY
 WILL BE INSTALLED 3" IN.
 ON PRIVATE PROPERTY

THE DETROIT EDISON COMPANY - SERVICE PLANNING DEPARTMENT			
LEGEND ○ FOREIGN POLE ○ ○ EXIST. D.E. CO. POLE ○ ○ PROPOSED POLE ○ EXIST. ANCHOR ○ PROPOSED ANCHOR ○ TREE --- 120/240 V LINE --- 4800 V LINE --- 13,200 V LINE --- 40,000 V LINE	CITY OR TOWN		COUNTY
	ROCHESTER		DEPT. ORDER NO...
	MAP SECT.	TOWN	RANGE
	1-322-434		
	PROJECT NAME		TEL. ENGR. & DIST.
CIRCUIT		JOINT R/W REQUIRED	R/W NO.
DC 1858 ROCHE 4.5KV		YES <input type="checkbox"/> NO <input type="checkbox"/>	1374
REASON		PROJ. OR PART NO...	
IN-A POLE GUY & ANCH. GUY		O.F.W. S.O. OR P.E. NO.	
PLANNER		BUDGET ITEM NO...	
CHARLIE MARTIN		DATE	
SCALE		8-5-91	
N.T.S.			