

2.11  
31

EASEMENT

FORD MOTOR COMPANY, a Delaware corporation with offices at The American Road, Dearborn, Michigan 48121 (herein called "Grantor") for and in consideration of the sum of One Dollar (\$1.00), the receipt of which is hereby acknowledged, does hereby give, grant and convey unto THE DETROIT EDISON COMPANY, a corporation existing concurrently under the laws of the States of Michigan and New York with offices at 2000 Second Avenue, Detroit, Michigan 48226 (herein called "Grantee"), an easement (herein called the "Easement") for the construction, installation, maintenance, repair, alteration, inspection, operation, replacement and removal of three poles and a 40 kilowatt electric line (the "Electric Line") and appurtenances thereto in, under and across a parcel of land (the "Land") in the City of Troy, Oakland County, Michigan, as more particularly described on Exhibit 1 annexed hereto.

The Easement is granted to and accepted by Grantee upon and subject to the following terms and conditions:

1. All work performed by Grantee, its agents and servants, in and about the construction, installation, maintenance, repair, alteration, operation, replacement and/or removal of the Electric Line shall be conducted with the least possible inconvenience to Grantor and, upon the completion of any work, Grantee, at its own cost and expense, shall promptly remove all debris, materials and equipment and restore the surface of the Land and installations thereon to the same condition, including, but not limited to replacement of roads, walks, parking areas, fences and ground cover, as the same existed prior to such work.

Troy Twp.  
Sec. 31, NE 1/4 of

RECORDED RIGHT OF WAY NO. 29114

9.00

- 2 -

2. Grantor shall not erect any permanent structure within the limits of the Land, but shall at all times have the right to make such other use thereon, including, without limitation, installation of paved walks, drives and/or parking areas, as shall not be inconsistent with the exercise by Grantee of the rights and privileges granted to it hereunder.

3. Grantee shall indemnify and save Grantor harmless from and against any and all losses or claims, demands, actions, liabilities, expenses (including reasonable attorneys' fees) and costs for damage to property or persons whatsoever, arising from or in any manner based upon the construction, installation, alteration, operation, replacement and/or removal of the Electric Line.

4. Grantee shall, in the exercise of the rights and privileges granted to it hereunder, adhere to and comply with all laws, orders and regulations applicable to the construction, installation, maintenance, repair, alteration, operation, replacement and/or removal of the Electric Line.

5. The Easement is granted subject to the existing rights, if any, of third persons, including, without limitation, any and all rights of way, easements and licenses, whether of record or unrecorded, heretofore acquired or granted in, over and across the Land.

6. In the event that Grantee shall discontinue use of the Land for the above stated purposes for any period of 18 or more consecutive months, all rights granted hereunder shall cease and terminate, and upon written demand of Grantor, Grantee shall remove all its property and equipment from and restore the surface of the Land.

RECORDED RIGHT OF WAY NO. 2177

IN WITNESS WHEREOF, Grantor has executed this Easement as of the 30th day of November, 1973.

WITNESS:

FORD MOTOR COMPANY

Janette De Luca  
JEANETTE DE LUCA  
Luann Bonjai  
LUANN BONJAI

By [Signature]  
D. R. JOLLIFFE  
ASSISTANT SECRETARY

RECORDED  
BANK AND COUNTY MICHIGAN  
REGISTER OF DEEDS RECORDS  
1973 FEB 22 AM 11:27  
LYNN D. ALLEN  
CLERK-REGISTER OF DEEDS

STATE OF MICHIGAN }  
COUNTY OF WAYNE } SS.

On this 30th day of November, 1973, before me appeared D. R. Jolliffe to me personally known, who, being by me duly sworn did say that he is Assistant Secretary of FORD MOTOR COMPANY and that the seal affixed to said instrument is the corporate seal of said corporation, and that said instrument was signed and sealed in behalf of said Corporation by authority of its Board of Directors, and said D. R. Jolliffe acknowledged said instrument to be the free act and deed of said corporation.

[Signature]  
GEORGE A. ANDERSON  
Notary Public, Washtenaw County, Mich.  
Acting in Wayne County, Mich.  
My Commission Expires July 15, 1974

APPROVED AS TO FORM 12-31-73 DATE  
LEGAL DEPARTMENT B

PREPARED BY  
GEO. A. ANDERSON  
THE AMERICAN ROAD  
DEARBORN, MICH.

RECORDED RIGHT OF WAY NO. 29114

EASEMENT FOR GRANT BY  
FORD MOTOR COMPANY  
TO THE DETROIT EDISON COMPANY

**LIBER 6249 PAGE 140**

An easement over and across a strip of land 12 feet wide, located in Section 31, Town 2 North, Range 11 East, City of Troy, Oakland County, Michigan, more particularly described as follows:

Commencing at the northeast corner of Section 31, Town 2 North, Range 11 East; thence South 01 degree 41 minutes 10 seconds West 2815.45 feet along the east line of Section 31 also being the centerline of Coolidge Highway, 120 feet wide, to the northerly line of the Grand Trunk Railroad right-of-way 300 feet wide; thence along the northerly line of said right-of-way North 87 degrees 22 minutes 16 seconds West 60.00 feet to the westerly line of Coolidge Highway and the true point of beginning for the strip of land herein described; thence along the northerly line of the Grand Trunk Western Railroad North 87 degrees 22 minutes 16 seconds West 707.97 feet; thence North 27 degrees 26 minutes 20 seconds West 13.87 feet; thence along a line 12.00 feet northerly of and parallel with the northerly line of the Grand Trunk Railroad right-of-way South 87 degrees 22 minutes 16 seconds East 714.72 feet to the westerly line of Coolidge Highway 120 feet wide; thence South 01 degree 41 minutes 10 seconds West 12.00 feet along the westerly line of Coolidge Highway to the true point of beginning.

DESCRIPTION APPROVED  
DATE 5/25/73 PEO. ABS.  
N.U.

PLANT ENGINEERING OFFICE

MAY 25, 1973

RECORDED RIGHT OF WAY NO. 29114

RIGHT OF WAY PAYMENT SHEET

City of Troy, Oakland Co. Job Description: Relocate feed to Berry Substation. Work Order No. 350 B3

Item	Trapper	Number of Poles and Anchors	Dollars per Pole & Anchor	Overhang of Flat Paym't.	Date of Permit	Total Payment	Pay to	Date Paid
1.	The Stanley Works 195 Lake Street New Britain, Conn. 06050 B2214	7	5.00		12-13-73	35.00	Same	
2.	Byrne Plywood Co. 2400 Cole Ave. Birmingham, Michigan 48012 B1977A	3	5.00		2-14-73	15.00	Same	
	Ford Motor Company Room 1135 The American Road Dearborn, Michigan 48121 B2215	7	5.00		11-30-73	35.00	Same	
						\$85.00		

PREPARED BY:  
Paul E. Lagrou, Real Estate & R/W Dept.  
1-29-74  
P.E. P.O. 737

RECORDED RIGHT OF WAY NO. 28112/4

APPLICATION FOR RIGHT OF WAY

DE FORM MS 80 6-58

PLEASE SECURE RIGHT OF WAY AS FOLLOWS

DATE 9-15-72

LOCATION Coolidge & Industrial Rowe

APPLICATION NO. PO-737

CITY OR VILLAGE Troy

DEPT ORDER NO \_\_\_\_\_

TOWNSHIP Troy COUNTY Oakland

O F W NO 1kAOH9/H56

DATE BY WHICH RIGHT OF WAY IS WANTED 10-27-72

BUDGET ITEM NO 1KAOH-KAH

THIS R/W IS 100 % OF TOTAL PROJECT NO 2F15 ACCUM \_\_\_\_\_ %

INQUIRY NO \_\_\_\_\_

JOINT RIGHT OF WAY REQUIRED YES  NO

NOTE: Identify on print or sketch the subdivisions as to section location and liber and page.

KIND AND DESCRIPTION OF RIGHT OF WAY REQUESTED \_\_\_\_\_

PURPOSE OF RIGHT OF WAY Relocate 40KV from Tower Line to Berry Door Sub. Trk 3506

SIGNED John A Yesh

*John Thomas*

Pontiac

OFFICE

Service Planning

DEPARTMENT

REPORT OF REAL ESTATE AND RIGHTS OF WAY DEPT

Recordable R/W secured as shown on the attached sketch.

Contacts by P.E. Lagrou, Real Estate and Rights of Way Dept.

Ser. Pln. 3

PERMITS IN GENERAL FILES 3 R/W DEPT. FILE \_\_\_\_\_ GRANTOR Ford Motor Company

NO OF PERMITS 3 NO OF STRUCTURES \_\_\_\_\_ NO OF MILES \_\_\_\_\_ PERMITS TO MBT \_\_\_\_\_

DATE 1-29-74

SIGNED

*James A. Robertson*

JAMES A. ROBERTSON

RECORDED RIGHT OF WAY NO. 891274

9-18-72 WD 10-13-72

RECORDED R/W PLANS

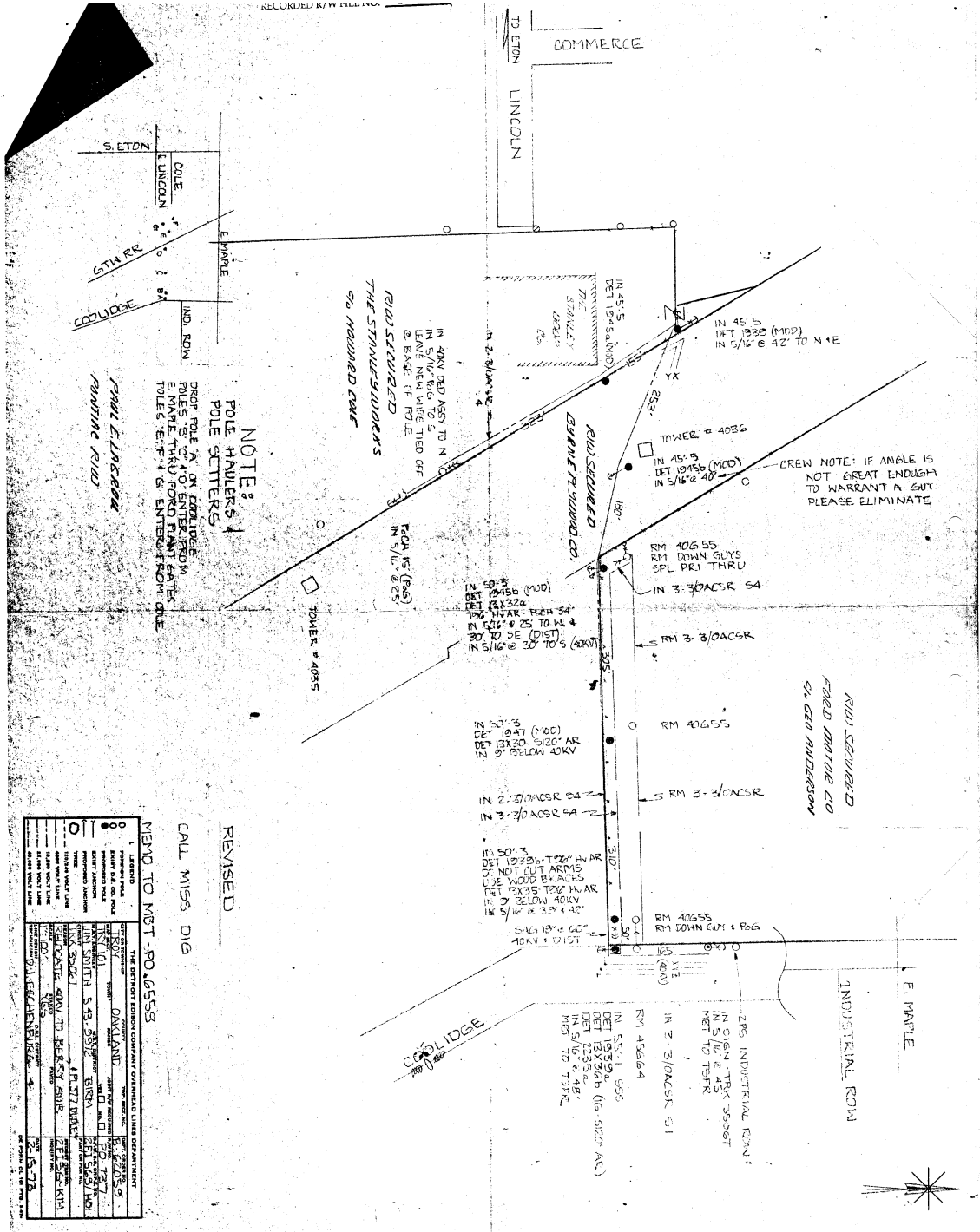

**NOTE:**  
 POLE HANDLERS  
 POLE SETTERS  
 DROP POLE 4' ON EACH SIDE  
 POLES TO BE ADJ. ENTER FROM  
 E. MAPLE THRU FORD PLANT GATES  
 TO E. E. F. + S. ENTER FROM ONE

ROAD STABILIZED  
 THE STANLEY BROTHERS  
 CO. HOUNDED CMT

CREW NOTE: IF ANGLE IS  
 NOT GREAT ENOUGH  
 TO WARRANT A CUT  
 PLEASE ELIMINATE

REVISED

CALL MISS. DIG

MEMO TO MGT. - PO. 0553

1. LEGEND	
○	PROPOSED POLE
●	EXISTING POLE
○	PROPOSED TOWER
●	EXISTING TOWER
○	PROPOSED CROSS
●	EXISTING CROSS
○	PROPOSED GUY
●	EXISTING GUY
○	PROPOSED WIRE
●	EXISTING WIRE
○	PROPOSED TRUNK
●	EXISTING TRUNK
○	PROPOSED BRANCH
●	EXISTING BRANCH
○	PROPOSED SERVICE
●	EXISTING SERVICE
○	PROPOSED TIE
●	EXISTING TIE
○	PROPOSED GROUND
●	EXISTING GROUND
○	PROPOSED MARKER
●	EXISTING MARKER
○	PROPOSED SIGN
●	EXISTING SIGN
○	PROPOSED CURB
●	EXISTING CURB
○	PROPOSED DRIVE
●	EXISTING DRIVE
○	PROPOSED ALLEY
●	EXISTING ALLEY
○	PROPOSED LOT
●	EXISTING LOT
○	PROPOSED ROAD
●	EXISTING ROAD
○	PROPOSED RAILROAD
●	EXISTING RAILROAD
○	PROPOSED CANAL
●	EXISTING CANAL
○	PROPOSED DITCH
●	EXISTING DITCH
○	PROPOSED FENCE
●	EXISTING FENCE
○	PROPOSED WALL
●	EXISTING WALL
○	PROPOSED CURB
●	EXISTING CURB
○	PROPOSED DRIVE
●	EXISTING DRIVE
○	PROPOSED ALLEY
●	EXISTING ALLEY
○	PROPOSED LOT
●	EXISTING LOT
○	PROPOSED ROAD
●	EXISTING ROAD
○	PROPOSED RAILROAD
●	EXISTING RAILROAD
○	PROPOSED CANAL
●	EXISTING CANAL
○	PROPOSED DITCH
●	EXISTING DITCH
○	PROPOSED FENCE
●	EXISTING FENCE
○	PROPOSED WALL
●	EXISTING WALL