

OVERHEAD EASEMENT (RIGHT OF WAY) NO. R-9410650-01

On MARCH 13, 1995, for the consideration of system betterment, Grantor grants to Grantee a permanent overhead easement ("Right of Way") in, on and across a part of Grantor's Land called the "Right of Way Area".

"Grantor" is:

Patricia A. Ruppel, 22990 Elm Grove, Farmington Hills, Michigan 48336-3714

"Grantee" is:

The Detroit Edison Company, a Michigan corporation, 2000 Second Avenue, Detroit, Michigan 48226
Ameritech, 54 Mill, Pontiac, Michigan 48342
Metrovision Cablevision, 37635 Enterprise Court, Farmington Hills, Michigan 48018

"Grantor's Land" is in The City of Farmington Hills, Oakland County, described as:

Elm Grove Valley, N 1/3 of Lot 28, Part of the E 1/2 of the SW 1/4, Sec. 25, T1N, R9E, as recorded in Liber 34, Page 43 of Plats, Oakland County Records. Sidwell No. 23-25-377-001

The "Right of Way Area" is a part of Grantor's Land and is described as:

As shown on the attached Detroit Edison Company drawing # R-9410650-01, dated December 15, 1994. Width of Right of Way is ten (10) feet.

- 1. Purpose:** The purpose of this Right of Way is to construct, reconstruct, modify, add to, operate and maintain overhead utility line facilities consisting of poles, guys, anchors, wires, cables, transformers and accessories.
- 2. Access:** Grantee has the right of access to and from the Right of Way Area.
- 3. Building or other Permanent Structures:** No buildings or other permanent structures shall be placed in the Right of Way Area without Grantee's prior written consent.
- 4. Trees, Bushes, Branches or Roots:** Grantee may trim, cut down, remove or otherwise control any trees, bushes, branches or roots in the Right of Way Area (or that could grow into the Right of Way Area) that Grantee believes could interfere with the safe and reliable construction, operation and maintenance of Grantee's facilities.
- 5. Restoration:** If Grantee's employees, contractors, vehicles or equipment damage Grantor's Land while entering Grantor's Land for the purposes stated in this Right of Way, then Grantee shall restore Grantor's Land as nearly as can be to its original condition.
- 6. Successors:** This Right of Way runs with the land and binds and benefits Grantor's and Grantee's successors, lessees, licensees and assigns.

RECORDED RIGHT OF WAY NO. 46840

Witnesses: (type or print name below signature)

Terry L. Benedict
TERRY L. BENEDICT

Edward F. Camps
EDWARD F. CAMPS

Grantor: (type or print name below signature)

Patricia A. Ruppel
Patricia A. Ruppel

Acknowledged before me in OAKLAND County, Michigan, on MARCH 13, 1995 by Patricia A. Ruppel.

TERRY L. BENEDICT
Notary Public, Oakland County, MI
My Commission Expires June 17, 1996

Notary's Stamp _____ Notary's Signature Terry L. Benedict
(Notary's name, county and date of commission)

\$ 9.00 MISCELLANEOUS RECORDING 9.00
\$ 2.00 RENOVATION
5 APR 95 1:42 P.M. RECEIPT# 1338
PAID RECORDED - OAKLAND COUNTY
LYNN D. ALLEN, CLERK/REGISTER OF DEEDS

Prepared by and Return to: Terry Benedict, 56500 Grand River, New Hudson, MI 48165

O.K. - J.S.

RECORDED RIGHT OF WAY NO. 4687D

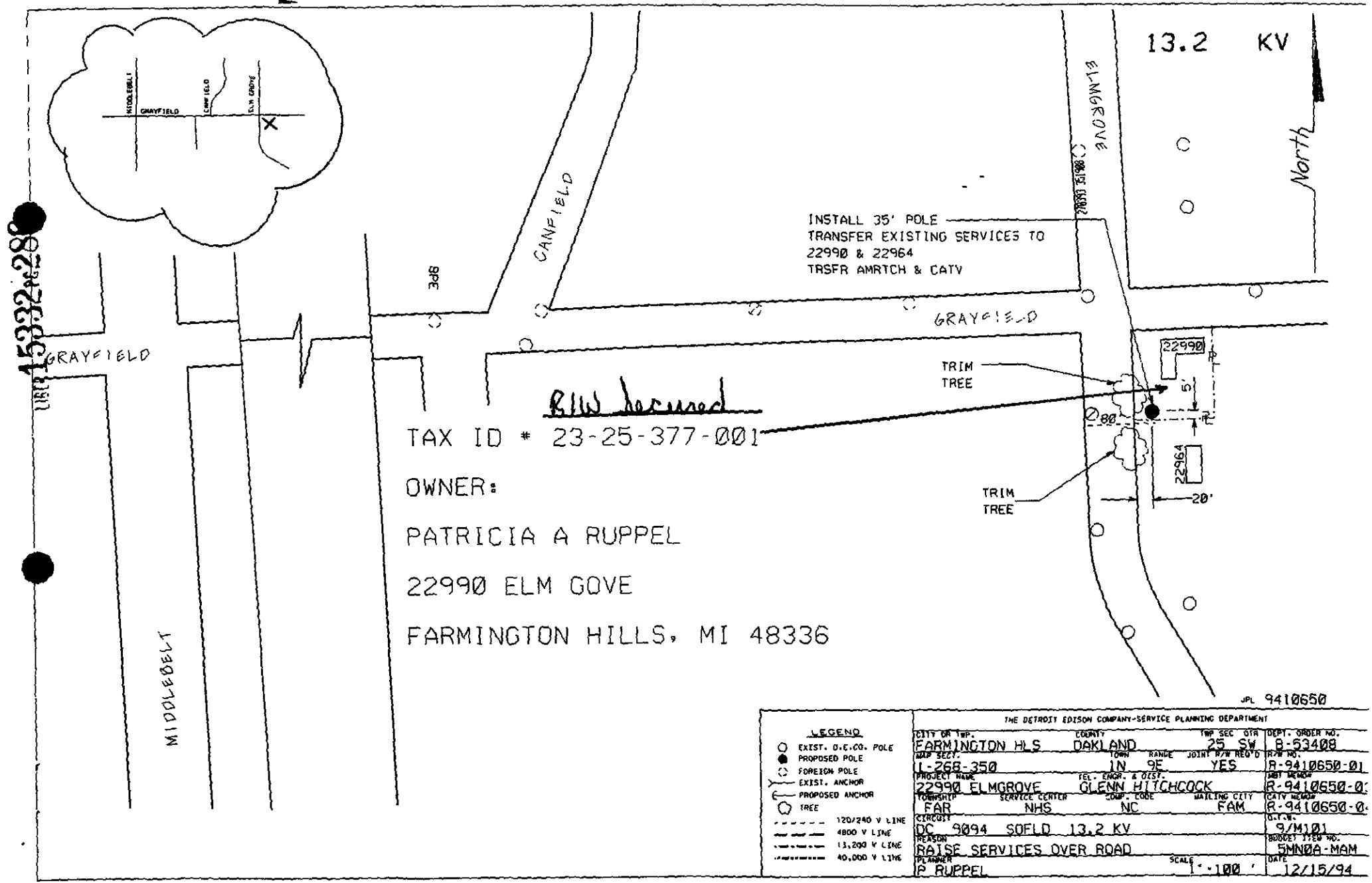

TAX ID * 23-25-377-001
 OWNER:
 PATRICIA A RUPPEL
 22990 ELM GOVE
 FARMINGTON HILLS, MI 48336

LRP 15332 & 286

JPL 9410650

THE DETROIT EDISON COMPANY-SERVICE PLANNING DEPARTMENT									
CITY OR TWP.	COUNTY	TWP. SEC.	QTR.	DEPT. ORDER NO.					
FARMINGTON HLS	DAKLAND	25	SW	B-93408					
MAP SECT.	TOWN	RANGE	JOINT R/W REQ'D	REV. NO.					
1-268-350	1N	9E	YES	R-9410650-01					
PROJECT NAME	TEL. ENGR. & DIST.	JOB ORDER							
22990 ELMGROVE	GLENN HITCHCOCK	R-9410650-01							
TOWNSHIP	SERVICE CENTER	COMP. CODE	MAILING CITY	CITY ORDER					
FAR	NHS	NC	FAM	R-9410650-01					
CIRCUIT	DC 9094	SOFLD	13.2 KV	DATE					
REASON	RAISE SERVICES OVER ROAD			9/1/01					
PLANNER	P RUPPEL			BUDGET ITEM NO.					
				5NNBA-MAM					
				DATE					
				12/15/94					