

MARCH 26, 1990

For good and valuable consideration of system betterment, the undersigned hereby grant and convey to THE DETROIT EDISON COMPANY, a Michigan corporation of 2000 Second Avenue, Detroit, Michigan, hereinafter referred to as "EDISON," the right to construct, reconstruct, modify, add to, operate and maintain overhead line facilities consisting of poles, guys, anchors, wires, cables, transformers and accessories required to provide electric services in, upon, over and across property located in the City of Farmington Hills, County of Oakland State of Michigan, further described as follows:

All of Lots 4, 5, 6 and 7 and part of Lot 8 of "Maple Lane Subdivision", as recorded in Liber 73, Page 9 of Plats, Oakland County, Michigan Records and a part of the Northwest 1/4 of Section 16, T1N, R9E, City of Farmington Hills, Oakland County, Michigan, more particularly described as: Commencing at the North 1/4 corner of Section 16, thence South 87° 53' 28" West 438.54 ft. along the North line of said Section, thence South 02° 23' 23" East 90.00 ft. to the point of beginning on the Southerly right-of-way line of Twelve Mile Road, thence South 02° 23' 23" East, 1010.00 ft., thence South 87° 53' 28" West 420.00 ft., thence South 02° 23' 23" East 169.36 ft. to the Northerly line of Interstate 696, thence South 85° 28' 16" West 911.24 ft. along said line, thence North 02° 06' 32" West, 717.02 ft., thence North 47° 06' 32" West 166.01 ft., thence North 02° 14' 32" West, 413.41 ft. to the Southerly line of Twelve Mile Road, thence along said line the following three courses: (1) North 87° 53' 28" East, 872.85 ft., and (2) South 02° 23' 23" East, 30.00 ft., and (3) North 87° 53' 28" East 570.00 ft. to the point of beginning.

Tax Parcel No. 23-16-104-000 - Ent Arboretum office PARK OCCP# 454 unit 1-4

The route of the line facilities is described as follows: Two (2) 3ft. X 20 ft. anchor slots as shown on the attached Detroit Edison drawing 0-9698 dated 11/15/89 which is made a part hereof.

The right of way is three (3) feet in width.

REG/DEEDS PAID 0001 MAY.21.90 08:57AM 6622 MISC 11.00

The rights hereby granted include the right of access to and from the right of way and the right to trim, cut down or otherwise control brush and trees either within the right of way or on property adjoining the right of way which in the opinion of EDISON interferes with the construction or operation of the line facilities. It is expressly understood and agreed that EDISON shall, at no time, trim or cut down any trees unless, in EDISON'S opinion, it is absolutely necessary to do so. EDISON shall restore premises to its original condition or as near as can be in the event of damages caused by its employes, contractors, vehicles and equipment entering premises for the purposes set forth herein. No buildings or structures are to be placed within said right of way herein granted without the written consent of the GRANTEE. This grant is declared to be binding upon the heirs, successors, lessees, licensees and assigns of the parties hereto.

IN WITNESS WHEREOF, the undersigned have hereunto set their hand(s) on the date of this agreement.

Witnesses:

Grantors:

Witness signatures: MARSHA E. FEUCHT, JANE THOMAS, BARBARA J. MASLIN, TARI HELLMER

Arboretum Development Limited Partnership A Michigan Limited Partnership

O.K. - LM

Ronald L. Hughes, General Partner

Peter K. Burton, General Partner

Prepared by: Gerald S. Misiak/vkc TARI HELLMER The Detroit Edison Company 30400 Telegraph Road, Suite 277 Birmingham, Mi 48010

Address: 30100 Telegraph Road Suite 316 Birmingham, MI 48010

APPROVED AS TO FORM 4/25/90 DATE LEGAL DEPARTMENT

Return on Back

State of Michigan)
) SS:
County of OAKLAND.)

On this 26th day of March, 1990, the foregoing instrument was acknowledged before me, a notary public in and for said county by Ronald L. Hughes, General Partner and Peter K. Burton, General Partner of Arboretum Development Limited Partnership, a Michigan Limited Partnership.

My Commission Expires: 8/16/93

Barbara M. Hollins
Barbara M. Hollins
Notary Public, Macomb County
County, Michigan

BARBARA M. HOLLINS
Notary Public, Macomb County, MI
My Commission Expires August 16, 1993
August 16, 1993

**Acting in Oakland
County, Michigan**

RECORDED RIGHT OF WAY NO. 4053X

11-15-87	D.J. ESCHENBURG
12-100	12 MILE ROAD WIDENING
	12 MILE ROAD WIDENING
	12 MILE ROAD WIDENING
	12 MILE ROAD WIDENING

NEW POLE LINE TO SET 119' S OF SEC. LINE
 TO BE AOKV SHIELD WIRE ARMLESS CONST.
 WITH ISKV UNDERBUILD.

23-15-104-002
 SAMPLED & DEVELOPMENT

ARBORETOUR OFFICE PARK
 25-15-104-000
 DETROIT PRIVATE EDISON COMPANY

20' ANC SLT
 REQUIRED
 (425' W OF
 IN GUARD
 DETROIT PRIVATE EDISON COMPANY

20' ANC SLT
 REQUIRED
 (SEC 16 OF R.)

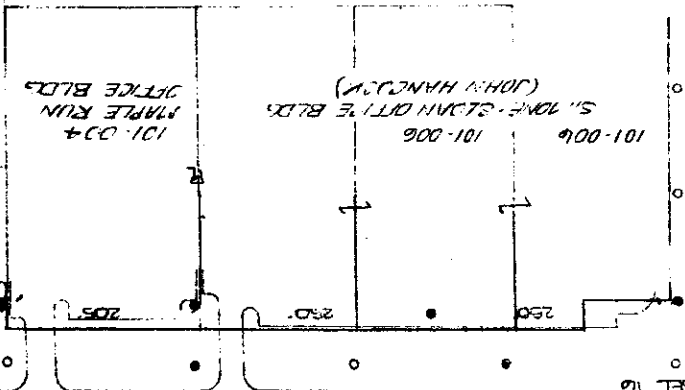

12 MILE

N.W. COR
 SEC 16

BUNKER HILL

WHITE PLAINS

DRAKE

11384063

11384062

RECORDED RIGHT OF WAY NO. 710623X

