

(87 15840)
87217157

JANUARY 15, 19 87

For valuable consideration, the receipt of which is hereby acknowledged, the undersigned hereby grant and convey to THE DETROIT EDISON COMPANY, a corporation organized and existing concurrently under the laws of the States of Michigan and New York, of 2000 Second Avenue, Detroit, Michigan 48226 hereinafter referred to as "EDISON", the easements and right to erect, lay, maintain, reconstruct and replace underground facilities consisting of wires, cables, conduits, fixtures and appurtenances including the necessary above ground equipment, connections, poles and accessories which may from time to time be required in, under, upon, over and across the land located in the City of Farmington Hills, Oakland County, Michigan, and more particularly described on the attached Appendix "A", with the full right to EDISON of ingress and egress upon said land for the purposes of this grant, and the further right to trim, cut down or otherwise control brush and trees within the easements herein described.

Said easements shall be Ten (10') feet in width unless otherwise indicated and their route is described as follows: The exact location of said easements shall be shown on a drawing to be recorded within 90 days after construction.

(2)

B#92 REG/DEEDS PAID
0001 NOV. 25 87 04:00PM
9863 MISC 11.00

RECORDED RIGHT OF WAY NO. 37722

In order to provide for the proper maintenance and protection of EDISON, the undersigned covenant and agree that:

1. The easements will be graded to within four (4) inches of final grade before EDISON lines are installed and this ground elevation must be maintained after installation of utilities to avoid the pooling of water in, on or around above ground EDISON equipment.

2. No buildings or structures other than EDISONS' equipment are to be placed within the easements herein granted. No excavation is to be permitted within said easements without approval of EDISON.

3. No shrubs or foliage shall be planted or grown within five (5) feet of the front door of transformers or switching cabinet enclosures. EDISON shall not be responsible to Owners for damages to or removal of trees or plant life planted in front of said door or within the easement causing an interference with EDISONS' maintenance of their equipment.

4. If the lines of facilities of EDISON are damaged by the acts of Owners, their agents, employes or contractors, repairs shall be made by EDISON at the cost and expense of Owners. Owners are defined as those persons owning the land at the time the damage occurred.

THIS GRANT is declared to be binding upon the heirs, successors, lessees, licensees and assigns of the parties hereto.

IN WITNESS WHEREOF, the undersigned have hereunto set their hand and seal on this date:

Witnesses:

Grantors: River Valley Partners,
A Michigan Co-Partnership

Lauri Piché
Lauri Piché
Lauri Piché
Lauri Piché
Edward Attard
Edward Attard

Douglas Kay
Douglas Kay, Co-Partner
Sherman Kay
Sherman Kay, Co-Partner

Prepared By: Omer V. Racine
The Detroit Edison Company
30400 Telegraph Road, #264
Birmingham, MI 48010

Address: 33060 Northwestern Hwy., Ste. 204
West Bloomfield, MI 48033

This easement is re-recorded for purposes of showing the planned "as installed" centerlines of easements granted as shown on drawing attached hereto.

[Handwritten signature]

STATE OF MICHIGAN)
COUNTY OF OAKLAND) SS.

(LIBER 9740 PAGE 842)

On this 15th day of January, 1987, before me, a notary public in and for said county, personally appeared DOUGLAS KAY, Co-Partner and SHERMAN KAY, Co-Partner; doing business as River Valley Partners, A Michigan Co-Partnership, to me known to be the persons who executed the foregoing instrument, and acknowledged that they executed the foregoing instrument as such Co-Partnership as the free act and deed of said Co-Partnership, by its authority.

EDWARD J. ATTARD
Notary Public Oakland County, Mich.
My Commission Expires August 8, 1988



Edward J. Attard

Notary Public, OAKLAND County, Michigan

My Commission Expires: _____

Appendix "A"

Part of the Northeast 1/4 of Section 34, T1N., R9E., City of Farmington Hills, Oakland County, Michigan, being described as: Beginning at a point S 89°24'03" W. along the North line of Section 34, 653.30 ft. and S 0°02'40" E., 110.01 ft. from the Northeast corner of Section 34, and proceeding thence S 89°24'03" W., along a line 110.00 ft. South of, and parallel to the North line of Section 34, 603.72 ft., thence S 0°12'00" W., 254.85 ft.; thence S 65°49'26" E along the centerline of Nine Mile Road 150.00 ft.; thence S 0° 06'21" W., 143.34 ft.; thence S 73°30'55" E along the North line of Freedom Road 198.53 ft.; thence N 16°29'44" E., 116.90 ft.; thence N 82°44'22" E., 246.70 ft.; thence N 0°02'40" W., 379.00 ft. to the point of beginning.

SIDWELL NO. 23-34-226-002
- 003

RECORDED RIGHT OF WAY NO. 37722

To (Supervisor, RE & RW)	For RE & RW Dept. Use	Date Received	Dist. Office P. No.
J. McDONALD		12-1-86	OE 86-43J
Division	Date	Application No.	
OAKLAND		Q-8521	

We have included the following necessary material and information.

Material:

- A Proposed Subdivision
 - 1 copy of complete final proposed plat - All pages

- or
- ✓ B. Other than proposed subdivision (condo, apts, mobile home park — other)
 - ✓ 1. Property description
 - ✓ 2. Site plan.
 - ✓ 3. title information (deed, title commitment, contract with title commitment, or title search).

Note: Do not submit application for URD easements until all above material has been acquired.

Information

1 Project Name		County
RIVER VALLEY APTS		OAKLAND
City/Township/Village		Section No.
FARMINGTON HILLS		34
Type of Development		
<input type="checkbox"/> Proposed Subdivision	<input checked="" type="checkbox"/> Apartment Complex	<input type="checkbox"/> Condominium
<input type="checkbox"/> Subdivision	<input type="checkbox"/> Mobile Home Park	<input type="checkbox"/> Other
2 Name of Owner		Phone No.
RIVER VALLEY PARTNERS		
Address		
33060 NORTHWESTERN HWY No. 204 WEST BLOOMFIELD MI		
Owner's Representative		Phone No.
EDWARD ATTARD		855-0343
Date Service is Wanted		
1-15-87		

- 4. Entire Project will be developed at one time. Yes No
- 5. Joint easements required — Michigan Bell Telephone Yes No
- Consumers Power Yes No

a Name of Other Utilities If Not Michigan Bell Telephone or Consumers Power

b Other Utility Engineer Names	Phone Numbers
Addresses	

6 Additional Information or Comments

Note. Trenching letter attached will be submitted later

Service Planner	Signed (Service Planning Supervisor)
G. GIBSON	<i>[Signature]</i>
Phone No.	Address
4137	

RECORDED RIGHT OF WAY NO.

37792

PLEASE ADVISE RECORDS CENTER

MEMORANDUM ORDER
FOR GENERAL USE
BY FORM NS 77 12-53

TO Records Center

DATE 12-17-87 TIME _____

Please set up R/W file for: RIVER VALLEY APTS
Being a part of Northeast 1/4 of Section 34, CITY OF FARMINGTON HILLS
Oakland County, Michigan

RECORDED
RIGHT OF WAY NO.

COPIES TO: _____

SIGNED

Omer V. Racine

Omer V. Racine
267 Oakland Div. Hqters

REPORT _____

FARMINGTON TWP.
SEC. 34

37722

DATE RETURNED _____

TIME _____

SIGNED _____

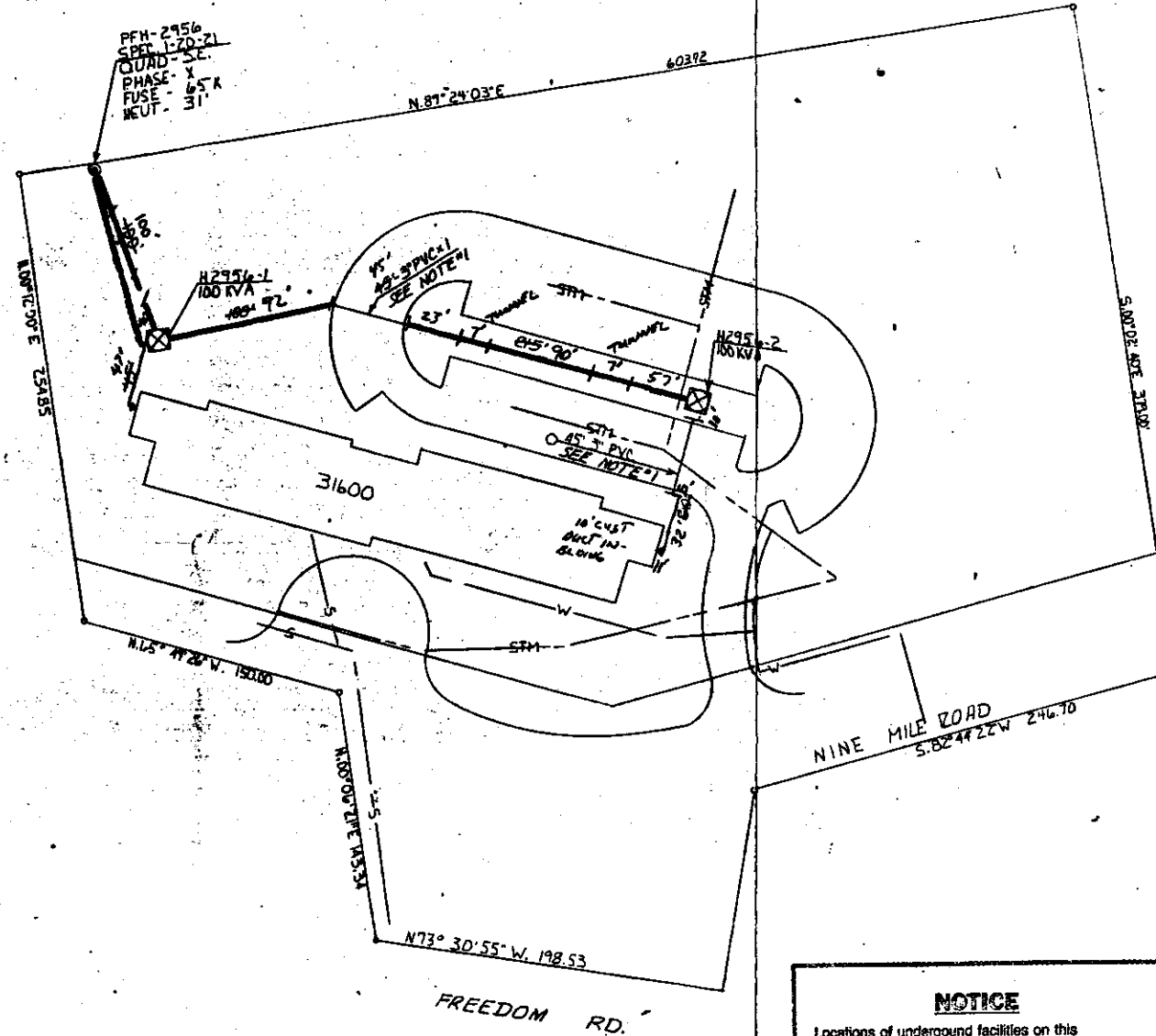
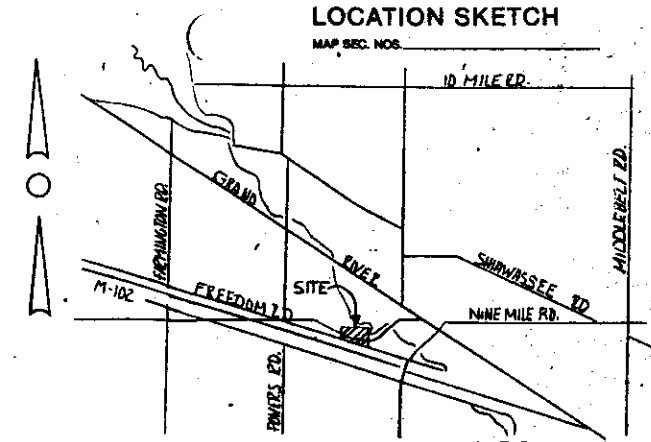

TRANSFORMER DATA

U.D.T. NO.	SIZE	ED. STK. NO.
H-2956-1	100 KVA	
H-2956-2	100 KVA	

TRANSFORMER SPECS. 1-17-261
 PEDISTAL SPEC.
 NO. OF PEDISTALS
 NO. OF TEMPORARY CABLE MARKERS
 TEMPORARY CABLE MARKER SPEC.
 SECONDARY CONNECTION BOX SPEC.

CODE

- ⊙ TEMPORARY SECONDARY PEDISTAL/TEMPORARY CABLE MARKER
- DFT (DEAD FRONT TYPE)
- UUT (NON-SWITCHING—LIVE FRONT TYPE)
- ⊞ UOT (SWITCHING—LIVE FRONT TYPE)
- DIRECTION OF TRANSFORMER DOOR OPENING
- SECONDARY PEDISTAL
- ⊞ SECONDARY CONNECTION BOX
- ⊙ CABLE POLE
- ⊞ PRIMARY SWITCH CABINET
- BURIED PRIMARY CABLE—ALL VOLTAGES
- BURIED SECONDARY CABLE
- BURIED SECONDARY SERVICE CABLE
- DETROIT EDISON TRENCH ONLY
- TELEPHONE TRENCH ONLY
- WATER
- GAS
- PROPOSED CONDUIT
- ⊞ SEP CORR CABINET

CABLE SUMMARY

ITEM #	DESCRIPTION	QUANTITY	UNIT
1	30' 1/2" x 1 1/2" KV	713-0307	FT
2	AP-808 & 1-40 800 V.	713-0337	FT
3	AP-808 & 1-01 600 V.	713-0314	FT

TRENCH SUMMARY

JOINT USE	D.E. ONLY	T.E. ONLY	GAS ONLY	OTHERS	TOTAL
		420' 372'	115'		420' 372' 115'
TOTAL					420' 372' 115'

NOTE: SITE SUPT. MIKE PHONE NO. 855-0343

GENERAL NOTES

TRENCHING TO BE DONE BY DECO.
 TRENCH AND CABLE LENGTHS ARE APPROXIMATE.
 SEE SECTION 26 US LINE CONSTRUCTION STANDARDS FOR TRANS. MAT. DETAILS.
 SEE PAGE 30-11 S.I.M. DETAIL " " FOR ENTRANCE POINT DETAILS (APPL. ONLY).
 SEE SECTION 43 US LINE CONSTRUCTION STANDARDS FOR PLACEMENT OF CABLES, TRANSFORMERS AND PEDISTALS (BUSTS ONLY).
 D.E. SERVICE PLANNER: J. SLOMEZENSKI ~ 645-4110
 TEL. CO.:
 GAS CO.:
 OTHERS:
 CONTACT "MBS DIG" (800-482-7171) BEFORE DOING ANY EXCAVATION.
 EASEMENTS INDICATED BY OUR CENTERLINE ARE IN WIDTH UNLESS OTHERWISE NOTED.

PERMITS REQUIRED

CITY OF _____ COUNTY: NOTIFICATION ONLY
 STATE YES NO

NOTICE
 Locations of underground facilities on this drawing are only approximate. Exact locations must be determined by the UTILITY COMPANIES. For exact location, telephone MISS DIG on 800-482-7171 as required by Public Act 53 of 1974 before doing any power excavating.

NOTE:
 CONDUIT BY CUSTOMER
 NOTE:
 DEVELOPER IS RESPONSIBLE FOR ALL ON-SITE SOIL EROSION & SEDIMENTATION CONTROL.

START DATE ~ 8-17-87

REVISION			REVISION			REVISION			REVISION			REVISION			REVISION			REVISION			REVISION			REVISION		
A REVISION AS INSTALLED												NAME			DATE			JOB TITLE			THE DETROIT EDISON COMPANY					
DO# 86A-64302												DRAWN BY			DATE			JOB TITLE			SERVICE PLANNING					
START												JIM KEENEY			12-15-86			SCALE								
FINISH												JOHN SLOMEZENSKI			7-21-87			1" = 50'								
NOTES & MEAS. BY CARRY												CHECKED BY			DATE			NUMBER OF UNITS								
ENG. BY HARLAN 8-27-87												RJ MURPHY			7-10-87			45								
DRAWN BY												APPROVED BY			DATE			DISTRIBUTION CIRCUIT								
CHECKED BY												T. J. Farnham			7-30-87			DL 8873 FRMTN-13.2								
APPROVED BY												DRAWN BY			DATE			DEPT. ORDER NUMBER								
DRAWN BY												CHECKED BY			DATE			86A-64302								
CHECKED BY												APPROVED BY			DATE			SHEET OF SHEETS								
APPROVED BY												DRAWN BY			DATE			86A-64302								
DRAWN BY												CHECKED BY			DATE			CITY OF FARMINGTON HILLS OAKLAND CO								
CHECKED BY												APPROVED BY			DATE											
APPROVED BY												DRAWN BY			DATE											
DRAWN BY												CHECKED BY			DATE											
CHECKED BY												APPROVED BY			DATE											
APPROVED BY												DRAWN BY			DATE											

RECORDED RIGHT OF WAY NO. 3772