

For good and valuable considerations, the right is hereby granted to The Detroit Edison Company, 2000 Second Avenue, Detroit, Michigan 48226, its successors and assigns, to construct line facilities for the purpose of providing electric service and Company communication service including the necessary poles, guys, anchors, wires and equipment upon, over and across the property described hereinafter. The rights hereby granted include the right of access to and from the said premises, the right to construct, reconstruct, modify, operate and maintain said line facilities, and to trim or cut down any trees belonging to the grantor, either within said right of way or upon the lands of the grantor adjoining said right of way, which, in the opinion of the grantee, at any time interfere with the construction and operation of said line facilities. It is expressly understood and agreed that the grantee shall, at no time, trim or cut down any trees unless, in the grantee's opinion, it is absolutely necessary to do so. Upon the written consent of the grantee, buildings or structures may be placed within said right of way. This grant shall be binding upon the successors and assigns of the grantors. Before construction is completed, the Company shall pay the sum of Five and 00/100 (\$5.00) Dollars for each pole and for each anchor, or the sum of Five and 00/100 (\$5.00) Dollars if no poles or anchors are installed. The Company shall reimburse the grantors and assigns for all damage caused by its men, vehicles and equipment in entering said property for the purposes set forth herein.

The property over which this grant is conveyed is situated in the City of Farmington Hills,

#10  
County of Oakland, State of Michigan and further described as follows: Route of Lines: As shown on attached sketch #8310 dated 6-20-86, attached hereto and made a part hereof. Part of the northwest 1/4 of Section 31, Town 1 North, Range 9 East, City of Farmington Hills, Oakland County, Michigan, described as beginning at the West 1/4 corner of said Section 31, Town 1 North, Range 9 East and proceeding thence North 01°39'25" West 532.77 feet; thence North 87°22'03" East 549.59 feet thence along the westerly right-of-way line of Interstate 96 on a curve to the right radius 11,244.16 feet, central angle 02°43'27" an arc distance of 534.63 feet and whose chord bears North 02°12'02" East a distance of 534.59 feet; thence South 87°22'03" West 513.62 feet to the point of beginning. Containing 6.52696 acres. Sidwell 23-31-101-010.

Witness:

Stuart Chipman  
STUART CHIPMAN

C. George Williams  
C. George Williams

Prepared By:

Stuart Chipman  
The Detroit Edison Company  
30400 Telegraph Rd., Suite 264  
Birmingham, Michigan 48010

STATE OF MICHIGAN )  
) SS.  
COUNTY OF Oakland

On this 9<sup>th</sup> day of Sept A.D. 1986, before me, the sub-

scriber, a Notary Public in and for said county, appeared DALE H. SPENCER, JOHN H. H'DONALD,

ROBERT GLIWE & GARY R. SCHLABACH to me personally known, who being by me duly sworn did say that they are the TRUSTEE'S

of FIRST CHURCH OF THE NAZARENE OF DETROIT, MICH A MICHIGAN NON-PROFIT CORPORATION and that the seal affixed to said instrument is the corporate seal of said corporation and that said instrument was

signed and sealed in behalf of said corporation by authority of its board of directors and \_\_\_\_\_

\_\_\_\_\_ and \_\_\_\_\_ acknowledged said instrument to be the free act and deed of said corporation.

Stuart R. Chipman  
Notary Public, STUART R. CHIPMAN County, Michigan  
Notary Public, Oakland County, Mich  
My Commission Expires Feb. 5, 1990

My Commission Expires: 2-5-1990

REG/DEEDS PAID  
0001 FEB 12 '87 02:41PM  
1453 WISC 9.00

By: Dale H. Spencer  
By: John H. McDonald  
Robert Glive  
Gary R. Schlabach  
FIRST CHURCH OF THE NAZARENE OF  
DETROIT, MICHIGAN

APPROVED AS TO FORM 1-22-87 DATE  
LEGAL DEPARTMENT J.B. Kozak

RECORDED RIGHT OF WAY NO. 310855

900

[Signature]

9/31

KNOW ALL MEN BY THESE PRESENTS: That William W. Bowman and Barbara B. Bowman, His wife  
whose address is 21430 Haggerty Road, Northville, Michigan 48167

Convey(s) and Warrant(s) to First Church of the Nazarene of Detroit, Michigan a Michigan  
non profit Corporation  
whose address is 19316 Grand River, Detroit, Michigan 48223

the following described premises situated in the City of Farmington Hills  
County of Oakland and State of Michigan, to-wit:

A parcel of land in and being a part of the Northwest 1/4 of Section 31, T. 1 N.,  
R. 9 E., City of Farmington Hills, Oakland County, Michigan, described as beginning  
at the West 1/4 corner of said Section 31, Town 1 North, Range 9 East and proceeding  
thence North 01 degree 39 minutes 25 seconds West 532.77 feet; thence North 87 degrees  
22 minutes 03 seconds East 549.59 feet; thence along the Westerly right-of-way line of  
Interstate 96 on a curve to the right Radius 11,244.16 feet, central angle 02 degrees  
43 minutes 27 seconds an arc distance of 534.63 feet and whose chord bears North 02  
degrees 12 minutes 02 seconds East a distance of 534.59 feet; thence South 87 degrees  
22 minutes 03 seconds West 513.62 feet to the point of beginning. Containing 6.52696  
acres.

23-31-101-010

for the full consideration of Two Hundred Thirty Three Thousand (\$233,000.00) dollars  
subject to Restrictions and Easements of Record

Dated this 16th day of August 1978

Witnesses:  
Jamice Childs  
Jamice Childs  
Carol C. Higley  
Carol C. Higley

Signed and Sealed.  
William W. Bowman (L.S.)  
William W. Bowman  
Barbara B. Bowman (L.S.)  
Barbara B. Bowman

STATE OF MICHIGAN  
COUNTY OF Oakland

The foregoing instrument was acknowledged before me this 16th day of August 1978  
by William W. Bowman and Barbara B. Bowman

My commission expires February 7, 1982  
Carol C. Higley  
Notary Public Wayne County, Michigan

Instrument Drafted by Carol C. Higley Business Address 32823 Twelve Mile Road, Farmington Hills Michigan 48018

County Treasurer's Certificate  
JACKSON COUNTY TREASURER'S CERTIFICATE  
No. 100  
100  
8-21-78  
I HEREBY CERTIFY that there are no TAX  
LITIGATION or LITIGATION held by the State or any its  
divisions against the within description, nor  
all TAXES are same and paid for 91 years  
previous to the date of this instrument, or  
amount by the records in the office of the  
Treasurer.

City Treasurer's Certificate  
STATE OF MICHIGAN  
REAL ESTATE  
TRANSFER TAX  
EXCHANGED  
PB, Sec

Recording Fee \$4.00  
State Transfer Tax \$256.30

When recorded return to Aaron W. Goren  
1702 Ford Building  
Detroit, Michigan 48226

Tax Parcel # 23-31-101-010

Send subsequent tax bill to Grantee 55291

RECORDED ON MAY 10, 1978

APPLICATION FOR RIGHT OF WAY

DK 983-0811 5-7455\* (MS 80)

Sec 31, NW 1/4 of

PLEASE SECURE RIGHT OF WAY AS FOLLOWS

DATE JUNE 20, 1986

LOCATION HAGGERTY RD. NORTH OF 8 MILE ROAD

APPLICATION NO. 0-8310

CITY OR VILLAGE FAR, HILLS

DEPT ORDER NO \_\_\_\_\_

TOWNSHIP \_\_\_\_\_ COUNTY OAKLAND

O F W NO 6GIOH9/H21

BUDGET ITEM NO 6GIOH-WEH

DATE BY WHICH RIGHT OF WAY IS WANTED JULY 25, 1986

INQUIRY NO \_\_\_\_\_

THIS R/W IS 15 % OF TOTAL PROJECT NO. 6GIOA ACCUM. \_\_\_\_\_ %

JOINT RIGHT OF WAY REQUIRED YES  NO

NOTE: Identify on print or sketch the subdivisions as to section location and liber and page.

KIND AND DESCRIPTION OF RIGHT OF WAY REQUESTED REMOVE 40 KV & 13KV LEAD FROM THE MIDDLE OF CHURCH OF NAZARENE PROPERTY AND REBUILD IT TO 120K & 13 KV CONSTRUCTION ~~OR~~ ALONG THEIR NORTH PROPERTY LINE.

PURPOSE OF RIGHT OF WAY 120 KV FEED FOR NEW HAGGER SUBSTATION IN WAYNE AREA.

RECORDED RIGHT OF WAY NO

SIGNED Darral J. Burton SUPERVISOR  
OAK, DIV. HEADQUARTERS SER. PLANNING  
OFFICE DEPARTMENT

30855

REPORT OF REAL ESTATE AND RIGHTS OF WAY DEPT

Corporate Right of Way secured as requested as per attached sketch. Contacts made by Stuart Chipman, Representative, Real Estate, Rights of Way & Claims - Oakland.

PERMITS IN RECORD CENTER 1 R.E. & R/W DEPT, FILE 1 GRANTOR First Church of Nazarene of Detroit, Michigan

NO OF PERMITS 1 NO OF STRUCTURES \_\_\_\_\_ NO OF MILES \_\_\_\_\_ PERMITS TO MBT 0

DATE January 26, 1987 SIGNED James D. McDonald  
James D. McDonald, Sr. Representative

6-24-86 WD 7-24-86

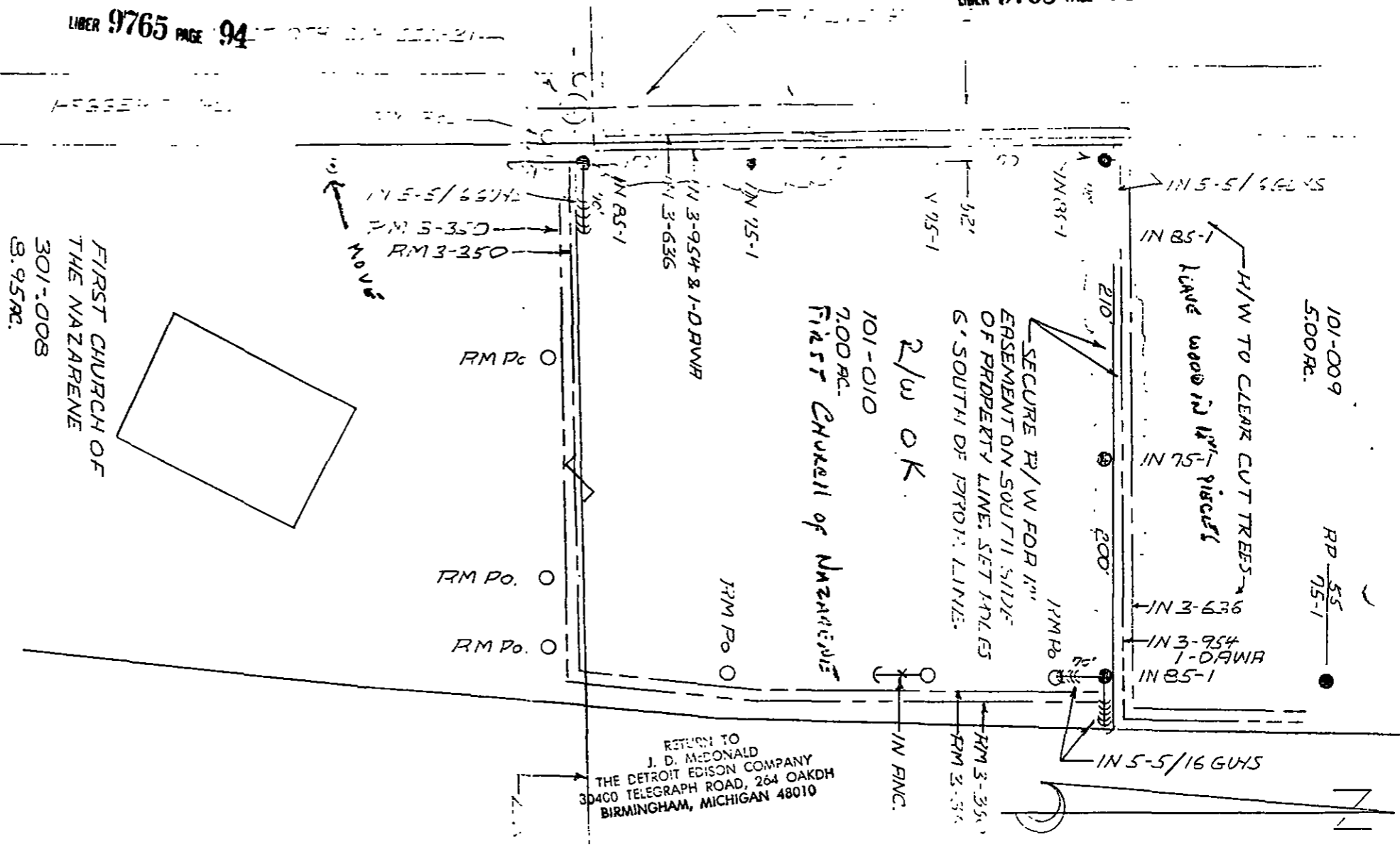

FIRST CHURCH OF THE NAZARENE  
301-008  
S. 95 AC.

101-009  
5.00 AC.  
RD 75-1  
RP 55

RETURN TO  
J. D. McDONALD  
THE DETROIT EDISON COMPANY  
30400 TELEGRAPH ROAD, 264 OAKDH  
BIRMINGHAM, MICHIGAN 48010

PROPERTIES AND RIGHTS TO BE SECURED AS SHOWN ON THIS SECTION	RECORD CENTER	1
DATE 7-25-86	R/W MILES	1
	LAST	1
	OK NUMBER	1
	TOTAL	1

LEGEND		THE DETROIT EDISON COMPANY - SERVICE PLANNING DEPARTMENT			
○	FOREIGN POLE	CITY OR TWP.	COUNTY	QTR. & TWP. SECT. NO.	DEPT. ORDER NO.
○	EXIST. D.E. CO. POLE				
○	PROPOSED POLE	MAP SECT.	TOWN	RANGE	JOINT R/W REQUIRED YES <input type="checkbox"/> NO <input checked="" type="checkbox"/>
○	EXIST. ANCHOR	PROJECT NAME	TEL. ENGR. & DIST.		PROJ. OR PART NO.
○	PROPOSED ANCHOR	CIRCUIT			O.F.W. S.O. OR P.E. NO.
○	TREE	REASON			BUDGET ITEM NO.
—	120/240 V LINE	PLANNER	SCALE		DATE
—	4800 V LINE				
—	13,200 V LINE				
—	40,000 V LINE				