

APPLICATION FOR RIGHT OF WAY

DE 96370811 5-7485 (MS 80)

Hickory Sub.
Job: 94-056

PLEASE SECURE RIGHT OF WAY AS FOLLOWS.

DATE April 5, 1994

LOCATION East of Evergreen and South of 13 Mile Rd.

APPLICATION NO. _____

CITY OR VILLAGE XXXXXXXX Southfield

DEPT ORDER NO _____

TOWNSHIP Southfield COUNTY Oakland

O F W NO. 4KB78/H01

DATE BY WHICH RIGHT OF WAY IS WANTED May, 1994

BUDGET ITEM NO _____

INQUIRY NO. _____

THIS R/W IS _____ % OF TOTAL PROJECT NO. _____ ACCUM. _____ %.

JOINT RIGHT OF WAY REQUIRED YES NO

NOTE: Identify on print or sketch the subdivisions as to section location and liber and page.

KIND AND DESCRIPTION OF RIGHT OF WAY REQUESTED A 10'x22' Detroit Edison easement with rights of ingress and egress.

DRWG U1-1-3596

PURPOSE OF RIGHT OF WAY To install a primary switch cabinet to cut over primary service 6994 to Evergreen Center from O.H. to U.G.

SIGNED John Witherell

520 S.B.
OFFICE

John Witherell
Underground Design
DEPARTMENT

RECORDED RIGHT OF WAY NO. 46192

REPORT OF REAL ESTATE AND RIGHTS OF WAY DEPT.

PERMITS IN RECORD CENTER _____ R.E. & R/W DEPT. FILE _____ GRANTOR _____

NO. OF PERMITS _____ NO. OF STRUCTURES _____ NO. OF MILES _____ PERMITS TO MBT _____

DATE _____ SIGNED Jim McDonald 10-29-94



13 MILE RD 120' W.D.

N.W. COR. SEC. 11
FIN. RICE

EVERGREEN RD. 120' W.D.

540'

295'

11-101-022

EVERGREEN CENTER
30800 EVERGREEN
SOUTHFIELD, MI.

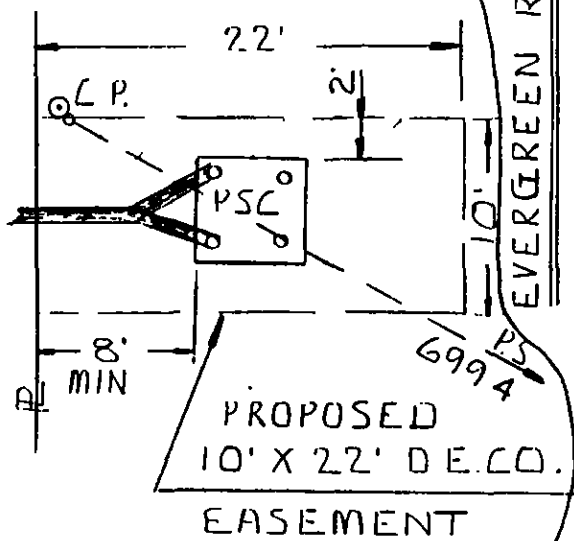

DETAIL 'A'
1" = 10'

PRIMARY SERVICE TO
EVERGREEN CENTER TO
BE CUT OVER TO NEW
PRI. SW. CAB, 4 OH REMOVED

PROPOSED U.G. CONDUIT

841'

376'

PLAN
1" = 200'

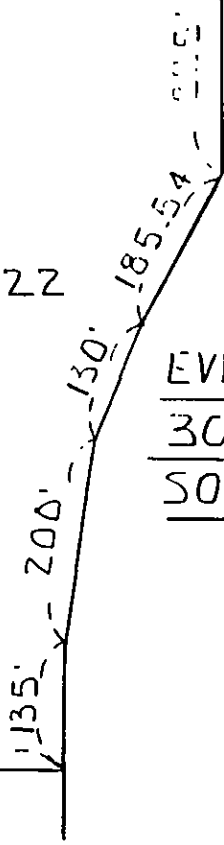

RECORDED RIGHT OF WAY NO. 476192

OFW 4KB78 / H01
JOB 94-056
HICKORY SUB
R/W USE ONLY

Reference	Drawn	RHC	3/31/94	Title PROPOSED 10' X 22' EASEMENT EVERGREEN, SOUTH OF 13 MILE RD CITY OF SOUTHFIELD OAKLAND CO	The Detroit Edison Company	
U3-5-9815 E	OK.	RAG	4/5/94		SCALE AS SHOWN	No. U1-1-3596
	Approved	JMW	4/5/94			

UNDERGROUND EASEMENT (RIGHT OF WAY) NO. R-9402699-01

On June 2, 1994, for the consideration of system betterment, Grantor grants to Grantee a permanent underground easement ("Right of Way") in, on and across a part of Grantor's Land called the "Right of Way Area".

"Grantor" is:

School District for the City of Birmingham, a Michigan School District, 550 West Merrill Street, Birmingham, Michigan 48012,

"Grantee" is:

The Detroit Edison Company, a Michigan Corporation, 2000 Second Avenue, Detroit, Michigan 48226

\$ 9.00 MISCELLANEOUS RECORDING

RECORDING INFORMATION

"Grantor's Land" is in the City of Southfield, Oakland County, described as:

Part of Northwest one-quarter (1/4), Section 11, Town 1 North, Range 10 East, beginning at Northwest corner of the South 89°56'00" East 600 feet, thence South 285 feet, thence South 29°00'59" West 185.54 feet, thence South 135 feet, thence South 06°53'32" West 200 feet, thence South 135 feet, thence North 89°56'00" West 436 feet, thence North 901 feet to beginning exc Northerly 60 feet and Westerly 60 feet taken for roads, containing approximately 8.74 acres, more or less, Oakland County Records. Sidwell No. 24-11-101-022.

The "Right of Way Area" is a part of Grantor's Land and is described as:

The Southerly Ten (10) feet of the Northerly Three Hundred Five (305) feet of the Westerly Twenty-Two (22) feet of Grantor's land, further described on the attached drawing No. U1-1-3596.

- Purpose:** The purpose of this Right of Way is to construct, reconstruct, modify, add to, operate and maintain underground utility line facilities consisting of poles, guys, anchors, wires, manholes, conduits, pipes, cables, transformers and accessories.
- Access:** Grantee has the right of access to and from the Right of Way Area.
- Buildings or other Permanent Structures:** No buildings or other permanent structures shall be placed in the Right of Way Area without Grantee's prior written consent.
- Excavation:** As required by Public Act 53 of 1974, MISS DIG must be called on 1-800-482-7171 before anyone excavates in the Right of Way Area.
- Trees, Bushes, Branches, Roots, Structures and Fences:** Grantee may trim, cut down, remove or otherwise control any trees, bushes, branches and roots in the Right of Way Area (or that could grow into the Right of Way Area) and remove structures and fences in the Right of Way Area that Grantee believes could interfere with the safe and reliable construction, operation and maintenance of Grantee's facilities. No trees, plant life, structures and fences shall be planted, grown or installed within 8 feet of the front door and within 2 feet of the other sides of transformers and switching cabinet enclosures. Grantee shall not be responsible to Grantor for damages to or removal of trees, plant life, structures and fences placed in front of transformer doors.
- Restoration:** If Grantee's employees, contractors, vehicles or equipment damage Grantor's Land while entering Grantor's Land for the purposes stated in this Right of Way, then Grantee shall restore Grantor's Land as nearly as can be to its original condition.
- Successors:** This Right of Way runs with the land and binds and benefits Grantor's and Grantee's successors, lessees, licensees and assigns.

RECORDED RIGHT OF WAY NO. 46192

Witnesses:(type or print name below signature)

Grantor:(type or print name below signature)

School District for the City of Birmingham, a Michigan School District

Rosemary Kling
Rosemary Kling

[Signature]
By:

Assistant Superintendent for Business Services

Anora Fisher
Anora Fisher

Acknowledged before me in Oakland County, Michigan, on June 2, 1994 by Richard E. Perry the Asst Sup for Business of School District for the City of Birmingham, a Michigan School District, for the Michigan School District.

Notary's Stamp Notary Public, Livingston County, MI
(Notary's Commission Expires May 23, 1998)

Notary's Signature Patricia Anne Brand

Prepared by and Return to: James D. McDonald, 30400 Telegraph Road, Suite 210, Birmingham, Michigan 48025/kad

O.K. -S.R.