

For good and valuable considerations, the right is hereby granted to The Detroit Edison Company, 2000 Second Avenue, Detroit, Michigan 48226, its successors and assigns, to construct, reconstruct, operate and maintain its underground lines for the transmission and distribution of electricity and Company communication facilities including the necessary conduits, fixtures, cables and cable poles, manholes and equipment under and across the property described hereinafter. The rights hereby granted include the right of access to and from the said premises, the right to construct, reconstruct, modify, operate and maintain said line facilities, and to trim or cut down any trees belonging to the grantor, either within said right of way or upon the lands of the grantor adjoining said right of way which, in the opinion of the grantee, at any time interfere with the construction and operation of said line facilities. It is expressly understood and agreed that the grantee shall, at no time, trim or cut down any trees unless, in the grantee's opinion, it is absolutely necessary to do so. Upon the written consent of the grantee, buildings or structures may be placed within said right of way. This grant shall be binding upon the successors and assigns of the grantors. The Company shall reimburse the grantors and assigns for all damage caused by its men, vehicles and equipment in entering said property for the purposes set forth herein.

1-10/21

The property over which this grant is conveyed is situated in the City of Southfield

County of Oakland, State of Michigan and further described as follows: The North 6 feet of the east 110 feet of the following described property. Part of the East half of the Northeast quarter of Section 21, Town 1 North, Range 10 East, Commencing at the point of intersection of the Northerly line of 10-1/2 Mile Road and the Westerly line of Lahser Road; thence Northerly along the Westerly line of Lahser Road 550 ft. thence Westerly at right angles to the Westerly line of Lahser Road 500 feet; thence Southerly on a course parallel to the Westerly line of Lahser Road to 10-1/2 Mile Road; thence Easterly along the Northerly line of 10-1/2 Mile Road to be the place of beginning.

Jewish Home For Aged
A Michigan Non-Profit Corporation
19100 W. Seven Mile Rd.
Detroit, MI

TAX I.D. NO. 24-21-202-015

1 #

X Marvin Fleischman Witness: X Paul Borman

MARVIN FLEISCHMAN - EX-MEMBER, IMMEDI. PAST-PRES

PAUL BORMAN

X Jack Schon
JACK SCHON - TREASURER

WALTER E. TOUCHIE
WALTER E. TOUCHIE

SEP 26

RECORDED RIGHT OF WAY NO. 35-7917

Prepared By:

Walter E. Touchie
30400 Telegraph Rd.
Birmingham, MI 48010

Jewish Home for Aged
A Michigan Non-Profit Corporation
19100 W. Seven Mile Rd.
Detroit, MI

STATE OF MICHIGAN)
) SS.
COUNTY OF OAKLAND)

On this 22 day of July, A.D. 1985, before me the sub-

scriber, a Notary Public in and for said county, appeared MARVIN FLEISCHMAN and JACK

SCHON to me personally known, who being by me duly sworn did say that they are the EXECUTIVE COMMITTEE MEMBER IMMEDI. PAST PRES. and TREASURER

of JEWISH HOME FOR AGED

and that the seal affixed to said instrument is the corporate seal of said corporation and that said instrument was

signed and sealed in behalf of said corporation by authority of its board of directors and MARVIN

FLEISCHMAN and JACK SCHON

acknowledged said instrument to be the free act and deed of said corporation.

APPROVED AS TO FORM. 8/9/85 DATE
LEGAL DEPARTMENT

X Jane Ellen Tompko

Notary Public, Wayne County, Michigan

My Commission Expires: Nov. 27, 1988

RETURN TO
J. D. McDONALD
THE DETROIT EDISON COMPANY
30400 TELEGRAPH ROAD, 264 OAKDH.
BIRMINGHAM, MICHIGAN 48010

11-1-3350

Angola Sub.
Job No. 85-007

PLEASE SECURE RIGHT OF WAY AS FOLLOWS.

DATE June 18, 1985

LOCATION Civic Center No. (10 1/2 Mile Rd.) & Mahser.

APPLICATION NO. U1-1-3380

CITY OR VILLAGE Southfield

DEPT. ORDER NO. _____

TOWNSHIP _____ COUNTY Oakland

O F W NO _____

DATE BY WHICH RIGHT OF WAY IS WANTED July 15, 1985

BUDGET ITEM NO. _____

THIS R/W IS _____ % OF TOTAL PROJECT NO. _____ ACCUM. _____ %.

INQUIRY NO. _____

JOINT RIGHT OF WAY REQUIRED YES NO

NOTE: Identify on print or sketch the subdivisions as to section location and liber and page.

KIND AND DESCRIPTION OF RIGHT OF WAY REQUESTED Proposed 6' x 110' D.E. Company Easement with rights of ingress and egress as shown on Drawing U1-1-3380.

PURPOSE OF RIGHT OF WAY Install Conduit necessary to install Transformer #3 and three Distribution Circuits at Angola Substation.

RECORDED RIGHT OF WAY NO. 35747

SIGNED R. F. Burtwell / RFB
R.F. Burtwell, Supervisor
Engineering, Planning & Layout Division Services
OFFICE DEPARTMENT

REPORT OF REAL ESTATE AND RIGHTS OF WAY DEPT.

RIGHT OF WAY SECURED AS REQUESTED ON THE ATTACHED SKETCH.
CONTACTS MADE BY WALTER TOUCHIE, REAL ESTATE, R/W & CLAIMS,
OAKLAND DIVISION

PERMITS IN RECORD CENTER 1 R.E. & R/W DEPT. FILE _____ GRANTOR JENISH HOME FOR AGED

NO. OF PERMITS 1 NO. OF STRUCTURES _____ NO. OF MILES _____ PERMITS TO MBT _____

DATE 8-22-85 SIGNED James D. McDonald

6-24-85 WD 8-1-85

WARRANTY DEED

LIBER 5676 PAGE 358

71 41505

STATUTORY FORM

KNOW ALL MEN BY THESE PRESENTS: That BERNARD ZIMETBAUM and SYLVIA EPSTEIN, as Trustees under the Last Will and Testament of Israel Zimetbaum dated December 15, 1937, as amended by Codicil dated October 30, 1943 (Bernard Zimetbaum and Sylvia Epstein being the surviving Trustees thereunder, Edward Gettinger, a former Trustee, now whose address is 4262 W. Fort Street, Detroit, Michigan 48209, being deceased),

Convey and Warrant to JEWISH HOME FOR AGED, a Michigan non-profit corporation,

whose street number and postoffice address is 19100 W. Seven Mile Road, Detroit, Michigan,

the following described premises situated in the City of Southfield, County of Oakland, and State of Michigan, to-wit:

See Exhibit A attached hereto and made a part hereof.

RECORDED
OAKLAND COUNTY, MICHIGAN
REGISTER OF DEEDS RECORDS
97th JUN 17 PM 2 51
J. H. Allen
Recorder

together with all and singular the tenements, hereditaments and appurtenances therunto belonging or in anywise appertaining, for the sum of One Million Four Hundred Twelve Thousand Dollars (\$1,412,000.00),

subject to right-of-way to Michigan Bell Telephone Company recorded in Liber 3183, Page 175 of Oakland County Records and right-of-way to Wagner Drain Drainage District recorded in Liber 5489, Page 175 of Oakland County Records.

Deed this 10th day of June, 1971.

Signed in the presence of:

Linda Federico
Linda Federico
Marcella M. Sutak
Marcella M. Sutak

Signed by:
Bernard Zimetbaum
Bernard Zimetbaum
Sylvia Epstein
Sylvia Epstein, as Trustees under the Last Will and Testament of Israel Zimetbaum dated December 15, 1937, as amended by Codicil dated October 30, 1943.

OAKLAND COUNTY
511030
STATE OF MICHIGAN
REAL ESTATE TRANSFER TAX
Dept of Taxation JUN 17 71
554.20
STATE OF MICHIGAN
County of Wayne

On this 10th day of June, 1971, before me personally appeared Bernard Zimetbaum and Sylvia Epstein, as Trustees under the Last Will and Testament of Israel Zimetbaum dated December 15, 1937, as amended by Codicil dated October 30, 1943, to me known to be the persons described in and who executed the foregoing instrument and acknowledged that they executed the same as their free act and deed.

Marcella M. Sutak
Marcella M. Sutak
Notary Public
Wayne County, Michigan

My Commission expires Feb. 6, 1972.

County Treasurer's Certificate
OAKLAND COUNTY TREASURER'S CERTIFICATE
No. 12104
I HEREBY CERTIFY that there are no TAX LIENS or TITLES held by the State of Michigan in any division against the within jurisdiction on all TAXES. These are used for the year previous to the date of this instrument, as appears by the records in this office as so stated.
P. Hugh ...
P. HUGH COUNTY, County Treasurer
Sec. 135 Art. XX, 1893 Act Am.

City Treasurer's Certificate
STATE OF MICHIGAN
REAL ESTATE TRANSFER TAX
Dept of Taxation JUN 17 71
998.00
PB 10560

When recorded return fee Recording Fee 3.00 Drafted by: Mark Shaevsky
Sylvan Papaport, 1400 Lafayette Building, Detroit, Michigan Business address: 2290 First National Building, Detroit, Michigan 48226
48-26 Rev. Stamp 173.20 *See note to P.A. 1961, No. 116, on reverse side.

BURTON ABSTRACT AND TITLE COMPANY HAS OPERATED CONTINUOUSLY SINCE 1866

MAKE YOUR REAL ESTATE TRANSFERS SAFE BY USING BURTON TITLE INSURANCE

EXHIBIT A

Land in the City of Southfield, County of Oakland, State of Michigan, described as:

Part of the East half of the Northeast quarter of Section 21, Town 1 North, Range 10 East, Commencing at the point of intersection of the Northerly line of 10-1/2 Mile Road and the Westerly line of Lahser Road; thence Northerly along the Westerly line of Lahser Road 550 feet; thence Westerly at right angle to the Westerly line of Lahser Road 500 feet; thence Southerly on a course parallel to the Westerly line of Lahser Road to 10-1/2 Mile Road; thence Easterly along the Northerly line of 10-1/2 Mile Road to the place of beginning.

065506
090807

35797

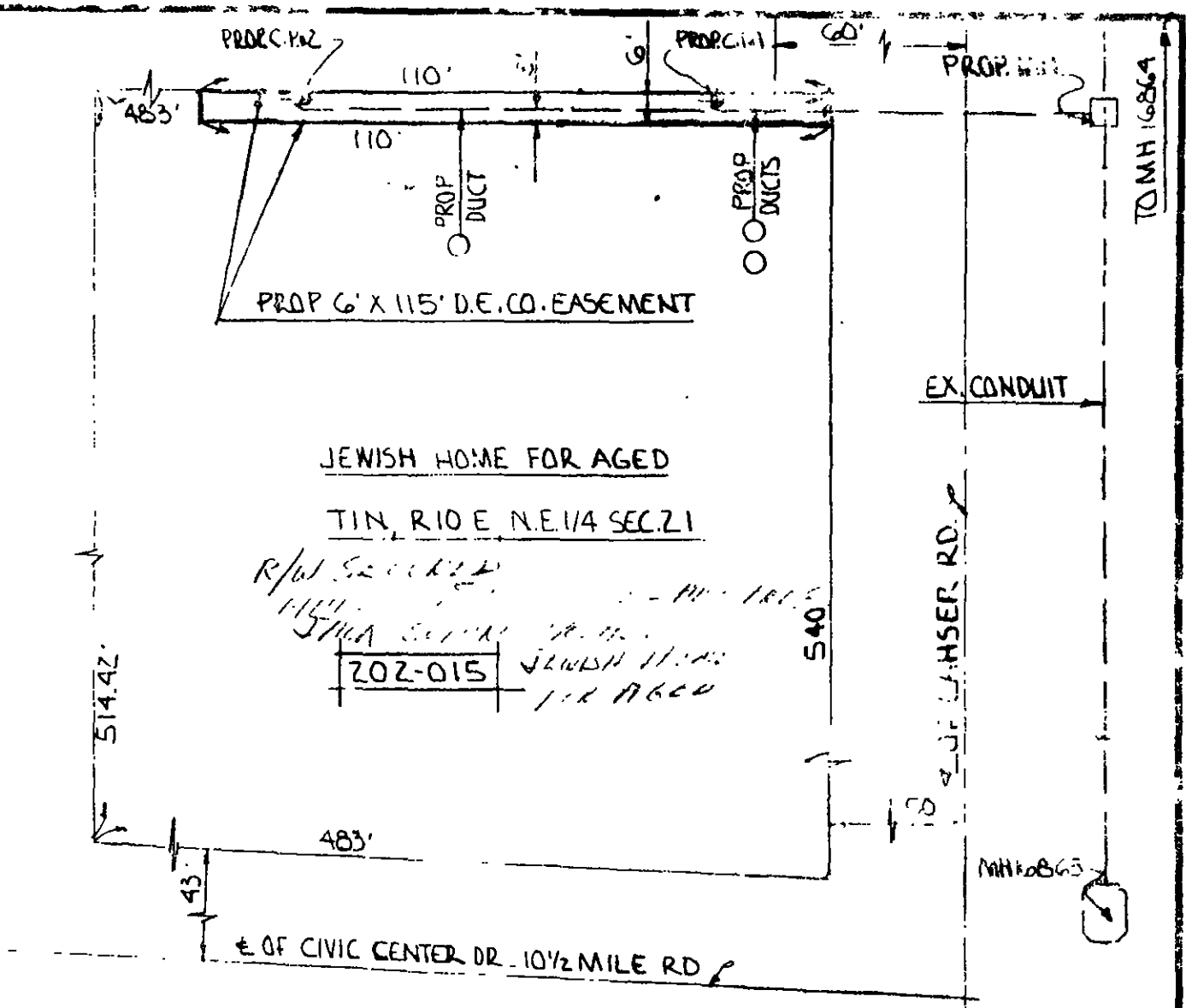

FOR R/W USE ONLY

DFW.5GG3B8/H01

R19 6-18-85 ANGOLA SUB

JOB NO. 85-007

REFERENCE	DRAWN	SECRET	6-18-85	TITLE	THE DETROIT EDISON COMPANY
	O. K.	RHE	6-18-85	10 1/2 MILE RD. & LAHSER RD PROP. 6' X 110' D.E. CO. EASEMENT	SCALE 1"=30'
	APPROVED	DSM	6-18-85	CITY OF SOUTHFIELD - OAKLAND CO.	NO. 11-1-3380

RECORDED RIGHT OF WAY NO. 35797