

Date January 24, 1983

For good and valuable considerations, the right is hereby granted to The Detroit Edison Company, 2000 Second Avenue, Detroit, Michigan 48226, its successors and assigns, to construct, reconstruct, operate and maintain its underground lines for the transmission and distribution of electricity and Company communication facilities including the necessary conduits, fixtures, cables and cable poles, manholes and equipment under and across the property described hereinafter. The rights hereby granted include the right of access to and from the said premises, the right to construct, reconstruct, modify, operate and maintain said line facilities, and to trim or cut down any trees belonging to the grantor, either within said right of way or upon the lands of the grantor adjoining said right of way which, in the opinion of the grantee, at any time interfere with the construction and operation of said line facilities. It is expressly understood and agreed that the grantee shall, at no time, trim or cut down any trees unless, in the grantee's opinion, it is absolutely necessary to do so. Upon the written consent of the grantee, buildings or structures may be placed within said right of way. This grant shall be binding upon the successors and assigns of the grantors. The Company shall reimburse the grantors and assigns for all damage caused by its men, vehicles and equipment in entering said property for the purposes set forth herein.

1-10
1/2

The property over which this grant is conveyed is situated in the _____ City _____ of Southfield

_____, County of _____ Oakland _____, State of Michigan and further described as follows:

C

Part of the Northwest 1/4 of Section 12, Town 1 North, Range 10 East, City of Southfield, Oakland County, Michigan, being more particularly described as follows:

1

Beginning at a point which is North 01 degrees 00 minutes 00 seconds East 495.00 feet along the West line of Section 12 from the West 1/4 corner of Section 12, Town 1 North, Range 10 East, thence North 01 degree 00 minutes 00 seconds East 478.17 feet along said West line of Section 12; thence South 88 degrees 25 minutes 30 seconds East 1322.64 feet along the subline of PINWOOD MANOR SUBDIVISION (Liber 106, Pages 21 and 22, O.C.R.) and said subline extended; thence South 01 degree 09 minutes 00 seconds West 297.61 feet along the subline of said PINWOOD MANOR
(CONTINUED ON BACK OF PAGE)

Easements as shown on attached drawing attached hereto and made a part thereof.

Witness: _____

Company
State Mutual Life Assurance Co. of
America, A Massachusetts Corporation
440 Lincoln St.
Worcester, Massachusetts 01605

X

X

Lillian W. DeSantis
Lillian W. DeSantis

Jane B. Simoneau
Jane B. Simoneau

Prepared By:

John C. Greenlee

30400 Telegraph Rd.

Birmingham, MI 48010

MASSACHUSETTS
STATE OF ~~MICHIGAN~~
) SS.
COUNTY OF ~~WORCESTER~~

By: John W. Nunley [Signature]
John W. Nunley, Assistant Vice President
By: Norman L. Kasparson [Signature]
Norman L. Kasparson, Assistant Secretary

83 FEB -2 15:59
RECORDED
DANK AND COURT OF MICHIGAN
REGISTER OF DEEDS RECORDS
34623
LYNN C. ALLEN
CLERK-REGIS. DIV.

On this 24th day of January, A.D. 1983, before me the sub-

scriber, a Notary Public in and for said county, appeared John W. Nunley and Norman L.

Kasparson to me personally known, who being by me duly sworn did say that they are the _____

Assistant Vice President and Assistant Secretary

of State Mutual Life Assurance Company of America

and that the seal affixed to said instrument is the corporate seal of said corporation and that said instrument was

signed and sealed in behalf of said corporation by authority of its board of directors and _____

John W. Nunley and Norman L. Kasparson

acknowledged said instrument to be the free act and deed of said corporation.

APPROVED AS TO FORM 1-31-83 DATE
LEGAL DEPARTMENT [Signature]

Walter F. Weldon, Jr. Notary Public

Walter F. Weldon, Jr.
Notary Public, Worcester County, Massachusetts

My Commission Expires: My Commission Expires October 18, 1985

[Handwritten signature]

34623
shd 9 01

1304

(CONTINUED)

SUBDIVISION; thence North 89 degrees 04 minutes 34 seconds West 330.39 feet; thence South 01 degree 26 minutes 00 seconds West 164.99 feet; thence North 89 degrees 06 minutes 28 seconds West 990.16 feet to the point of beginning, excepting any part thereof taken for road purposes, being the Westerly 102.00 feet lying East and adjacent to the West Line of Section 12 and the Center Line of Southfield Road. *ALSO KNOWN AS BALMORAL CLUB CONDO.*

(1)

~~PARCEL IDENT. #24-12-151-002~~

ENT 24-12-151-000

9000240

0740
83 FF-5
: e 1

RETURN TO
J. A. ROBERTSON
THE DETROIT EDISON COMPANY
30400 TELEGRAPH ROAD, 272 OAKDH
BIRMINGHAM, MICHIGAN 48010

APPLICATION FOR RIGHT OF WAY
DE FORM MS 80 5-74 SS

PLEASE SECURE RIGHT OF WAY AS FOLLOWS:

DATE October 4, 1982

LOCATION Balmoral Club Apartments

APPLICATION NO. _____

Southfield Road, south of 13 Mile Road

DEPT. ORDER NO. 82A-64903

CITY OR VILLAGE City of Southfield

O F W NO. _____

TOWNSHIP _____ COUNTY Oakland

BUDGET ITEM NO. _____

DATE BY WHICH RIGHT OF WAY IS WANTED November 15, 1982

INQUIRY NO. _____

THIS R/W IS 100 % OF TOTAL PROJECT NO. _____ ACCUM. _____ %.

JOINT RIGHT OF WAY REQUIRED YES NO

NOTE: Identify on print or sketch the subdivisions as to section location and liber and page.

KIND AND DESCRIPTION OF RIGHT OF WAY REQUESTED Additional Easements for primary cable reroute indicated in red on attached drawing.

PURPOSE OF RIGHT OF WAY Replace and reroute at four locations primary cable to avoid trenching through parking lots. Contact Mr. Gerald Rowin, Plaza Investment Company, 100 West Long Lake Road, Bloomfield Hills, Michigan 48013.

SIGNED [Signature] /Supervisor
Oakland Division HQ. Service Planning
OFFICE DEPARTMENT

REPORT OF REAL ESTATE AND RIGHTS OF WAY DEPT.

Recordable R/W secured as shown on the attached sketch.

Contacts by J. C. Greenlee, Real Estate, Rights of Way & Claims

RECORDED PERMIT OF RIGHT OF WAY NO. 34623

Permits to Service Planning - 1

PERMITS IN RECORD CENTER 1 R.E. & R/W DEPT. FILE _____ GRANTOR State Mutual Life

NO. OF PERMITS 1 NO. OF STRUCTURES _____ NO. OF MILES _____ PERMITS TO MBT _____

DATE 2/14/83 SIGNED _____

[Signature]
JAMES A. ROBERTSON

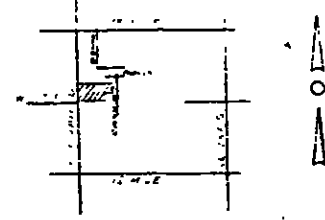

ON DIST 597-24

NOTICE

Locations of underground facilities on this drawing are shown approximately. It is the contractor's responsibility to locate and verify the location of all underground facilities before excavation.

For exact location of the MGS call 800-482-0177 or contact the Public Act 88 of 1994 and during any power excavating.

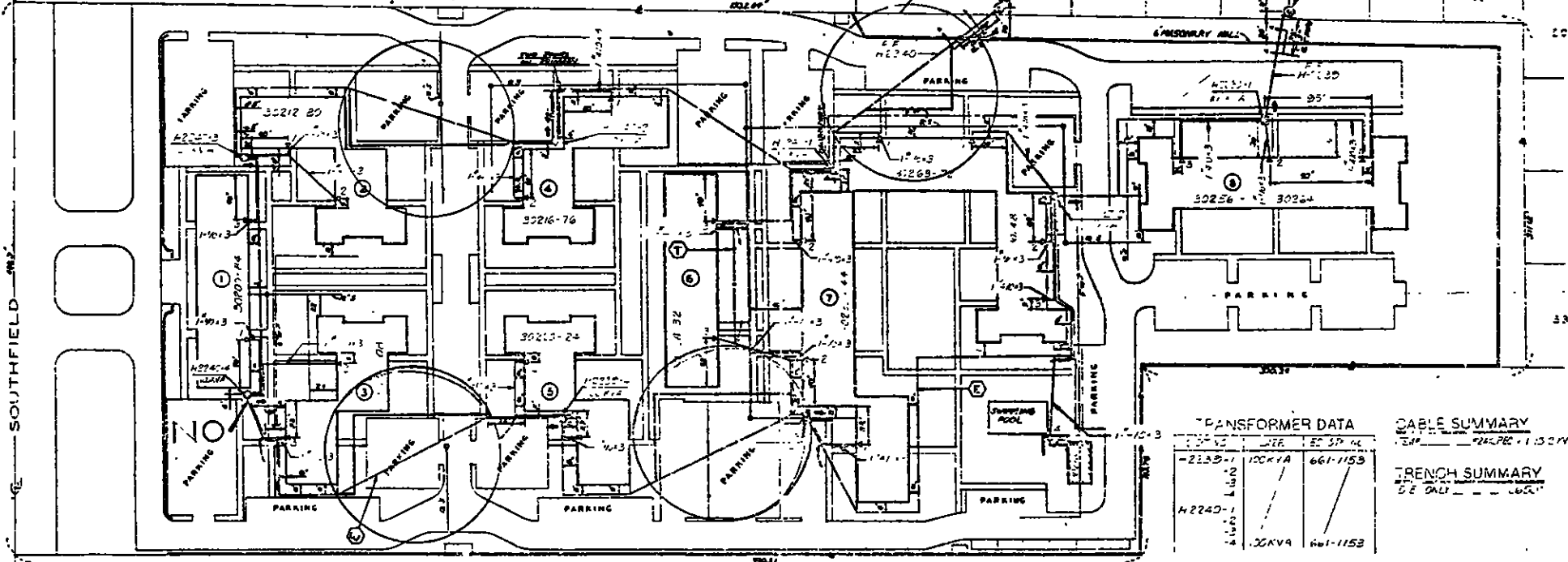

PF-H2240
CABLE IN SW QUAD.
SPEC 1-20-21
FUSE-60K
PHASE-Y
NEUT-28'

PF-H2239
CABLE IN SW QUAD
SPEC 1-20-21
FUSE-60K
PHASE-Y
NEUT-28'

TRANSFORMER DATA

NO.	TYPE	EST. SIZE
2133-1	150KVA	661-1153
H2240-1	150KVA	661-1153

CABLE SUMMARY
150KVA 24KPER 1153KV 719 2.424 22'5"

TRENCH SUMMARY
52' 24" 1153KV

NOTES:

1. ALL NEW UTILITIES SHALL BE INSTALLED IN ACCORDANCE WITH THE CITY OF BALTIMORE CODES AND REGULATIONS.

2. ALL UTILITIES SHALL BE INSTALLED IN ACCORDANCE WITH THE CITY OF BALTIMORE CODES AND REGULATIONS.

3. ALL UTILITIES SHALL BE INSTALLED IN ACCORDANCE WITH THE CITY OF BALTIMORE CODES AND REGULATIONS.

GENERAL NOTES

TRENCHES TO BE DONE BY THE CONTRACTOR.

DE SERVICE PLANNER: [Signature]

UPD: SFL/12

DATE: 12-27-2010 11:11 AM - 13.2KV

LEGENDS REQUIRED

ST: 111 SOUTHFIELD

Handwritten note: 12/16/10

NO.	DESCRIPTION	DATE	BY	APP.
1	ISSUED FOR PERMITS	12/16/10	[Signature]	[Signature]
2	ISSUED FOR PERMITS	12/16/10	[Signature]	[Signature]
3	ISSUED FOR PERMITS	12/16/10	[Signature]	[Signature]
4	ISSUED FOR PERMITS	12/16/10	[Signature]	[Signature]
5	ISSUED FOR PERMITS	12/16/10	[Signature]	[Signature]
6	ISSUED FOR PERMITS	12/16/10	[Signature]	[Signature]
7	ISSUED FOR PERMITS	12/16/10	[Signature]	[Signature]
8	ISSUED FOR PERMITS	12/16/10	[Signature]	[Signature]
9	ISSUED FOR PERMITS	12/16/10	[Signature]	[Signature]
10	ISSUED FOR PERMITS	12/16/10	[Signature]	[Signature]