

Date: Dec 17 1965

POLE LINE PERMIT

IN CONSIDERATION of the sum of One Dollar (\$1.00) and other valuable considerations, receipt of which is hereby acknowledged, the undersigned hereby grant to THE DETROIT EDISON COMPANY, its successors and assigns, the right to construct, operate and maintain its lines for the transmission and distribution of electricity and Company communication facilities, including the necessary poles, fixtures, guys and guy stubs, wires and equipment, and including also the right to trim or cut down any trees along said lines, which could fall into the lines or interfere in any way with their operation, upon, over and across our property located in the Village of Beverly Hills, County of Oakland, State of Michigan, and described as follows:

An easement 12 feet in width in the Westerly portion of Lot 24, Ronsdale Subdivision, part of the Southeast 1/4 of Section 3, Town 1 North, Range 10 East, according to the plat thereof recorded in Liber 61, Page 61, ~~to~~ Oakland County Records, in accordance with sketch of The Detroit Edison Company dated December 7, 1965, which is attached hereto and made a part hereof.

It is understood and agreed by the parties hereto that the electric line is established in its present location to avoid the further cutting of trees on said property. EDISON agrees upon request in the future by the property owners to move said pole line to the easement in the rear 20-feet of said Lot 24, provided that the owners of said Lot 24, will pay the cost of relocating, said lines and equipment before such removal or relocation and the cost shall be in such amounts as are computed by EDISON and shall include all costs and expenses attributable directly or indirectly to such removal or relocation.

In the presence of:  
[Signature]  
H S Fetz

[Signature]  
MARGARET S BUCHANAN

Witnesses to ALL SIGNATURES

KEATING LAND CO.  
27066 W 13 mi. W Birmingham  
[Signature] PRES  
A MICHIGAN CORPORATION  
Howard C. Keating  
[Signature]  
Harold L. Vogler

June L. Vogler

Address: 18415 Advertiser  
Birmingham, Michigan

RECORDED RIGHT OF WAY NO. 233514

sub. by

RETURN TO  
A. L. KASAMEYER  
The Detroit Edison Company  
2000 Second Avenue  
DETROIT, MICHIGAN 48215

RECEIVED  
DETROIT EDISON COMPANY  
NOV 22 1965

ACCEPTED:  
THE DETROIT EDISON COMPANY,  
2000 Second Avenue, Detroit 26, Michigan  
By [Signature]  
A. L. KASAMEYER, DIRECTOR  
PROPERTY AND PUBLIC RELATIONS DEPARTMENT

STATE OF MICHIGAN )  
COUNTY OF Oakland ) SS.

On this 14th day of December, 1965, before me the subscriber, a Notary Public in and for said County, appeared Howard T. Keating and Shirley L. Vogler, June T. Vogler to me known to be the persons described in and who executed the foregoing instrument and acknowledged that they executed the same as their free act and deed.

Audrey L. MacMillan  
AUDREY L. MAC MILLAN  
Notary Public, Oakland County, Michigan

My Commission Expires: June 9, 1968

STATE OF MICHIGAN )  
COUNTY OF OAKLAND ) SS.

On this 17th day of November, 1965, before me the subscriber, a Notary Public in and for said County, appeared HOWARD T. KEATING, to me personally known, who being by me duly sworn did say he is the President of KEATING LAND CO., a Michigan corporation, and that the seal affixed to said instrument is the corporate seal of said corporation, and that said instrument was signed in behalf of said corporation, by authority of its Board of Directors, and HOWARD T. KEATING acknowledged said instrument to be the free act and deed of said corporation.

Sophie U. Korte  
SOPHIE U. KORTE  
Notary Public, Oakland County, Michigan

My commission expires: November 3, 1968

Prepared by: Stephen A. McNamee  
2000 Second Avenue  
Detroit, Michigan, 48226

RETURN TO  
A. L. KASAMEYER  
The Detroit Edison Company  
2000 SECOND AVENUE  
DETROIT, MICHIGAN 48226

RECORDED IN BOOK 4836 PAGE 561

THE DETROIT EDISON COMPANY

INTERDEPARTMENT CORRESPONDENCE

LEGAL DEPARTMENT

January 5, 1966

I. W. GAMBLE  
*IW*  
JAN 5 1966  
PROP. & R/W DEPT.

MEMORANDUM TO:  
Mr. Ivan Gamble  
Properties & R/W Department  
310 General Offices

Recently while at Keating, Inc. on Company business, Mr. Keating brought up a problem of our electric line in the property of Mr. Harold Vogler in Lot 24, Ronsdale Sub., Village of Beverly Hills, County of Oakland. Mr. Vogler did not want the trees cut in our twenty (20') foot wide easement and has given us an easement to retain our line in his property in its present location. I added a provision about future location costs if the line must be moved in the future. This permit covers only Lot 24. Mr. Sell was consulted in this matter.

Would you please record this easement and send to Records Center with this memorandum as part of a record explanation.

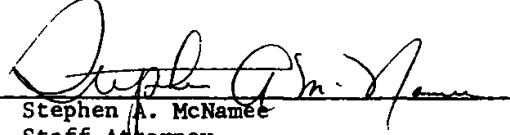
  
Stephen A. McNamee  
Staff Attorney

/veb

cc: F. Sell  
Birmingham Sales

RECORDED IN THE OFFICE OF THE CLERK OF THE COURT JAN 10 1966 23514

LIBR 4836 REC 562

ROSSDALE SEWER  
PART OF THE SE 1/4 OF SEC 3  
T1N R10E WILLAGE OF BEVERLY  
HILLS CALLEDWD CO MICH  
LIBR (1) PAGE 31

R/W NOTE THIS IS A  
REVISION R/W REQUIRED  
FROM LOT 24 ONLY

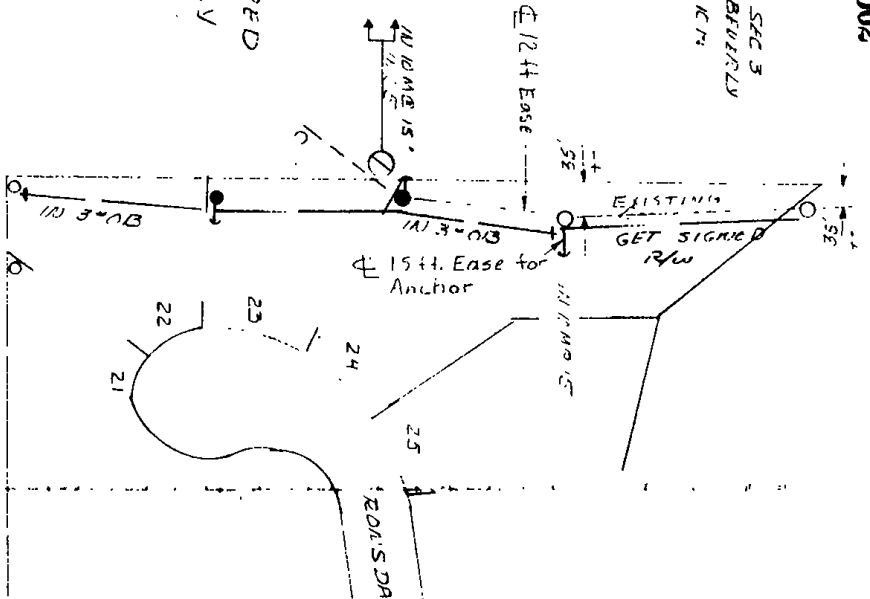

RETURN TO  
A. L. KASAMEYER  
The Detroit Edison Company  
2000 SECOND AVENUE  
DETROIT, MICHIGAN 48226

LIBR 4836 REC 563

LEGEND			
	FOREIGN POLE		
	EXISTING CO POLE		
	PROPOSED POLE		
	EXIST ANCHOR		
	PROPOSED ANCHOR		
	TREE		
	150/240 VOLT LINE		
	13,200 VOLT LINE		
	24,000 VOLT LINE		
	40,000 VOLT LINE		

THE DETROIT EDISON COMPANY OVERHEAD LINES DEPARTMENT			
CITY OR TOWNSHIP	COUNTY	RANGE	S&W SEC. NO.
BEVERLY	W.L. CAS	14	13-62444
DATE	TOWN	RANGE	JOINT W. REQUIRED
SEP 25			YES <input type="checkbox"/> NO <input checked="" type="checkbox"/>
BY ENGINEER			DATE
DC-1630	FCR		10-24-27
BY			DATE
J. W. KELLY			11/16/27
SCALE	STANDARD	PAVED	BUDGET ITEM NO.
1"=100'	YES		737 506
			INQUIRY NO.
			2170
			DATE
			12-7-65

DE FORM OL 180 FIG. 11-64