

July 28, 2008

ITC Holdings Corp.
C/O Fernando Guevara
27175 Energy Way
Novi, MI 48377

Attention: Fernando Guevara, Property Management Specialist

SUBJECT: 4800V Distribution Line
1000390749/Secord Twp/Gladwin County/

REFERENCE: Amended and Restated Easement Agreement (the "Agreement") dated April 29, 2002, between Consumers Energy Company ("Consumers") and Michigan Electric Transmission Company, now Michigan Electric Transmission Company, LLC ("METC")

Pursuant to Section 7.1 of the Agreement, Consumers hereby notifies METC that Consumers intends to build a new 4800V distribution line that crosses under a METC transmission line across certain land in which METC has an interest under the Agreement. The location of the land on which said line will be constructed, and a further description of the intended use, are set forth-on "Annex A", attached to this letter.

Under said Section 7.1 of the Agreement, METC must within 30 days of this notice notify Consumers, as "Initiating User," of whether or not METC approves the proposed use as a Compatible Use. If you do not notify us either way within 30 days of this notice, then, as provided in said Section 7.1, METC will be deemed to have approved the proposed use as being a Compatible Use. We would appreciate, however, receiving METC's express approval of the proposed use as being a Compatible Use as soon as possible so that we can start work without delay.

July 28, 2008
Page Two
4800V Distribution Line
1000390749/Secord Twp/Gladwin County/

This letter is being sent to you in duplicate. If METC agrees that the proposed use is a Compatible Use, please indicate that by signing and returning a copy of this letter to us as soon as possible, so that we can immediately proceed with construction. The other copy is for your records.

Very truly yours,



Stacie Lahr
Consumers Energy
One Energy Plaza
Jackson, MI 49201

APPROVED:

MICHIGAN ELECTRIC TRANSMISSION
COMPANY, LLC

By: _____

Date: _____

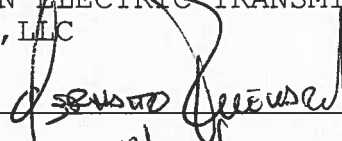

8/22/2008

ANNEX A

4800V Distribution Line
1000390749/Secord Twp/Gladwin County/

LAND TO BE IMPACTED:

Land located in the Township of Secord, County of Gladwin, State of Michigan, described as follows:

The Southwest 1/4 of Section 21, Township 19 North, Range 1 East.

PROPOSED USE:

Build a 4800V line that crosses under METC's 5S line, east of tower #909 in Sugar Wood Trail Road right of way. See attached 391 form and sketch.

Prepared by:
Stacie M Lahr 07/28/08
Consumers Energy Company
EP7-436
One Energy Plaza
Jackson, MI 49201



Date: August 20, 2008

To: Fernando Guevara
Real Estate and Rights of Way
ITC

From: Ashley DuPree
Engineering
ITC

Subject: **UGL081516/CU-352**
CE Reference No. 100390749/Secord Twp/Gladwin County
4800V Distribution Line

This request is hereby Approved

Approved

By David Doubley
David Doubley
Staff Engineer



Real Estate and Claims Division

**Project No: UGL081516
CU-352**

Date: August 5, 2008

To: David Doubley

From: Fernando Guevara
Real Estate

Subject: 480V Distribution Line
CE Reference No. 1000390749/Secord Twp/Gladwin County

The attached request was received from Consumers Energy. CE is proposing to build a 4800V line that crosses under METC's 5S line, east of tower #909 in Sugar Wood trail Road right of way. Furthermore, pursuant to the Amended and Restated Easement Agreement, METC/ITC needs to submit a response letter to CE by **August 29, 2008**.

Please review and return to my attention with your recommendations/comments.

Attachments

CONSUMERS ENERGY
**NOTIFICATION OF PROPOSED LINE CONSTRUCTION
 REQUIRING COORDINATION WITH HVD AND/OR TRANSMISSION LINES**

Send two (2) copies to:

HVD Lines Design and Standards

Att: EVANGELINE R HARVEY

Jackson, Michigan

TO BE FILLED IN BY SYSTEM OWNER / ENGINEER / CES	
Headquarters <u>GLADWIN</u>	
Notification No. <u>1000390749</u>	
Date <u>7/22/08</u>	

PROPOSED DISTRIBUTION CONSTRUCTION

Sketch Attached Yes No

Primary:

Voltage 4800 Phase X

No. of Wires 2 Crossarms Per Pole _____

Wire Size 4 ACSR Length of Crossarms _____

Distance Below Transmission 5.5FT

Skip-Span Yes No

Secondary:

No. of Wires N/A Wire Size N/A

Other Details: N/A

PROPOSED COMMUNICATION CONSTRUCTION TO BE FILLED IN BY FIELD TECHNICIAN	
Cable Dia. _____	
Weight/ft. _____	
Strand Size _____	
Tension _____	
Pole Attachment Height _____	
Map # _____	Pole # _____

EXISTING DISTRIBUTION FACILITIES

Description:

LOCATION

Township SECORD

County GLADWIN

Town 19 Range 1E Section 21

Transmission Line Involved GALLAGHER-BARD RD

Transmission Pole No. 808-809

TO BE FILLED IN BY HVD LINES DESIGN AND STANDARDS OR METC	
Clearance/Attachment Approved	<input type="checkbox"/>
Clearance/Attachment NOT Approved	<input type="checkbox"/>
Clearance requires further verification with Power System Analysis	<input type="checkbox"/> Yes <input type="checkbox"/> No
Structural Integrity - Engineering Required	<input type="checkbox"/> Yes <input type="checkbox"/> No
Calculated assuming STE rating of _____ °F Cond Temp	
Checked By _____	Date _____
Order No. _____	

REMARKS: THIS IS A CROSSING UNDERNEATH THE METC 138KV LINE. NOT ATTACHING TO ANY POLES. Line number 5S.

Prepared By Corey Slusser Date _____
System Planning and Performance / Electric Service

Reviewed By Evangeline Harvey Date July 24, 2008
HVD Lines Design and Standards

Reviewed By _____ Date _____
METC

METC lines are subject to the easement rights of METC. Your request has been forwarded to Real Estate for processing and will require a 30-day period prior to approval.

GLADWIN COUNTY

SECORD TWP

SECTION 21

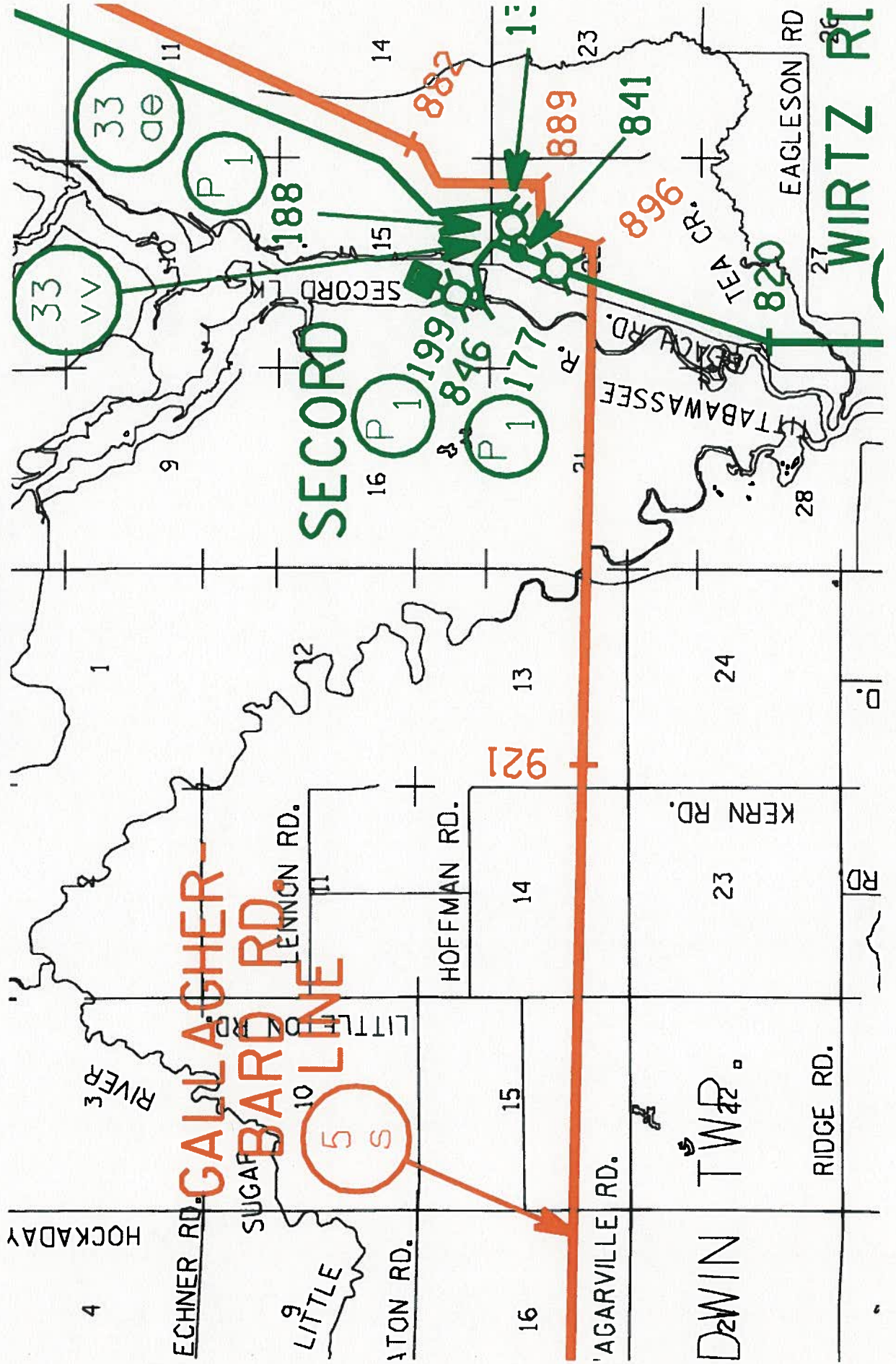

MAP 13
GLADWIN TWP.

SEE MAP
5-59

JOG 891.00'

5
S

33
YV

33
YV

1057-D33-8

105

783

791-D5-7

790-D-6

783-D-5

789-D-15
788-D-14

787-D-13

786-D5-12

X-1
981-D33-6

1054-D33-9
982-D33-7

786-D5-12

783-D5-11

JOG 1716.00'

SUGAR

RIVER

Z-1
979-D-10

TEA
CREEK

28

27

Z-2

977-D-15

978-D-9

SECORD

976.2-D-3

LINE NO. 33 AE IS
IN THE ROAD

976-D-7

976.1-D-2

JOG 1883.00'