

A CMS Energy Company

May 17th, 2012

Michigan Electric Transmission Company,
an ITC Company
Attn: Fernando Guevara
27175 Energy Way
Novi, MI 48377-3639

Attention: Executive Vice President and Chief Operating Officer

SUBJECT: Proposed: Distribution work in area of METC
138kV Transmission Line – Riggsville- Livingston Line 85I
Reference: Cheboygan/Burt/1006398039/Hatchard

REFERENCE: Amended and Restated Easement Agreement (the "Agreement") dated April 29, 2002, between Consumers Energy Company ("Consumers") and Michigan Electric Transmission Company, now Michigan Electric Transmission Company, LLC ("METC")

Pursuant to Section 7.1 of the Agreement, Consumers hereby notifies METC that Consumers is proposing to raise a secondary existing 46kV Line pole that run under an existing METC transmission line on certain land that METC has an interest under the Agreement. The location of the land on which said work will be performed, and a further description of the intended use, are set forth on "Annex A", attached to this letter.

Under said Section 7.1 of the Agreement, METC must within 30 days of this notice notify Consumers, as "Initiating User," of whether or not METC approves the proposed use as a Compatible Use. If you do not notify us either way within 30 days of this notice, then, as provided in said Section 7.1, METC will be deemed to have approved the proposed use as being a Compatible Use. We would appreciate, however, receiving METC's express approval of the proposed use as being a Compatible Use as soon as possible so that we can start work without delay.

Page Two

Reference No: Cheboygan/Burt/1006398039/Hatchard

This letter is being sent to you in duplicate. If METC agrees that the proposed use is a Compatible Use, please indicate that by signing and returning a copy of this letter to us as soon as possible, so that we can immediately proceed with construction. The other copy is for your records.

Sincerely,



Marcia A Losert, EP7-455
Real Estate Technical Analyst
Consumers Energy Company
One Energy Plaza
Jackson, MI 49201

MICHIGAN ELECTRIC TRANSMISSION
COMPANY, LLC, a Michigan limited liability
company

By: ITC Holdings Corp., its manager

By: _____
Christine Mason Soneral
Vice President and General Counsel-Utility
Operations of ITC Holdings Corp.

ANNEX A

Reference No: Cheboygan/Burt/1006398039/Hatchard

LAND TO BE IMPACTED:

That certain parcel of land in the Township of Burt, County of Cheboygan, State of Michigan, described as follows:

Located in Section 36, T36N, R3W of Burt Township, Cheboygan County, Michigan.

PROPOSED USE:

Consumers is proposing to raise an existing secondary located on Pole 324 that crosses below a METC Riggsville-Livingston 85I Transmission line on Pole #5668.

Please see specifications on attached forms 391 and drawings.

Rec 4/30/12
REC. 5/17/12

CONSUMERS ENERGY
**NOTIFICATION OF PROPOSED LINE CONSTRUCTION
REQUIRING COORDINATION WITH HVD AND/OR TRANSMISSION LINES**



Send two (2) copies to:

HVD Lines Design and Standards

Att: Angie Snyder

Jackson, Michigan

| |
|---|
| TO BE FILLED IN BY SYSTEM OWNER / ENGINEER / CES |
| Headquarters <u>Flint</u> |
| Notification No. <u>1006398039</u> |
| Date <u>4-17-2012</u> |

PROPOSED DISTRIBUTION CONSTRUCTION

Sketch Attached Yes No

Primary:

Voltage _____ Phase _____

No. of Wires _____ Crossarms Per Pole _____

Wire Size _____ Length of Crossarms _____

Distance Below Transmission _____

Skip-Span Yes No

Secondary:

No. of Wires _____ Wire Size _____

Other Details: _____

| |
|--|
| PROPOSED COMMUNICATION CONSTRUCTION TO BE FILLED IN BY FIELD TECHNICIAN |
| Cable Dia. _____ |
| Weight/ft. _____ |
| Strand Size _____ |
| Tension _____ |
| Pole Attachment Height _____ |
| Map # <u>360336</u> Pole # <u>3</u> |

EXISTING DISTRIBUTION FACILITIES

Description: Secondary crosses below.

LOCATION

Township Burt

County Cheboygan

Town 36 Range 03 Section 36

Transmission Line Involved 85 I

Transmission Pole No. 5668

| |
|--|
| TO BE FILLED IN BY HVD LINES DESIGN AND STANDARDS OR METC |
| Clearance/Attachment Approved <input type="checkbox"/> |
| Clearance/Attachment NOT Approved <input type="checkbox"/> |
| Clearance requires further verification <input type="checkbox"/> Yes <input type="checkbox"/> No with Power System Analysis |
| Structural Integrity - Engineering Required <input type="checkbox"/> Yes <input type="checkbox"/> No |
| Calculated assuming STE rating of _____ °F Cond Temp |
| Checked By _____ Date _____ |
| Order No. _____ |

METC

REMARKS: Survey for Charter. Applicant is not attached 5668. Evaluate as-is. Secondary on pole 324 crosses below HVD lines on pole 5668 and is being raised. Please include work details on the back of the pole detail form included.

Prepared By Charles Hatchard/JES Date 4/17/2012
System Planning and Performance / Electric Service

Reviewed By Angie Snyder Date 5/15/12
HVD Lines Design and Standards

Reviewed By _____ Date _____
METC

METC lines are subject to the easement rights of METC. Your request has been forwarded to Real Estate for processing and will require a 30-day period prior to approval.

FORWARD TO METC
5-11-12

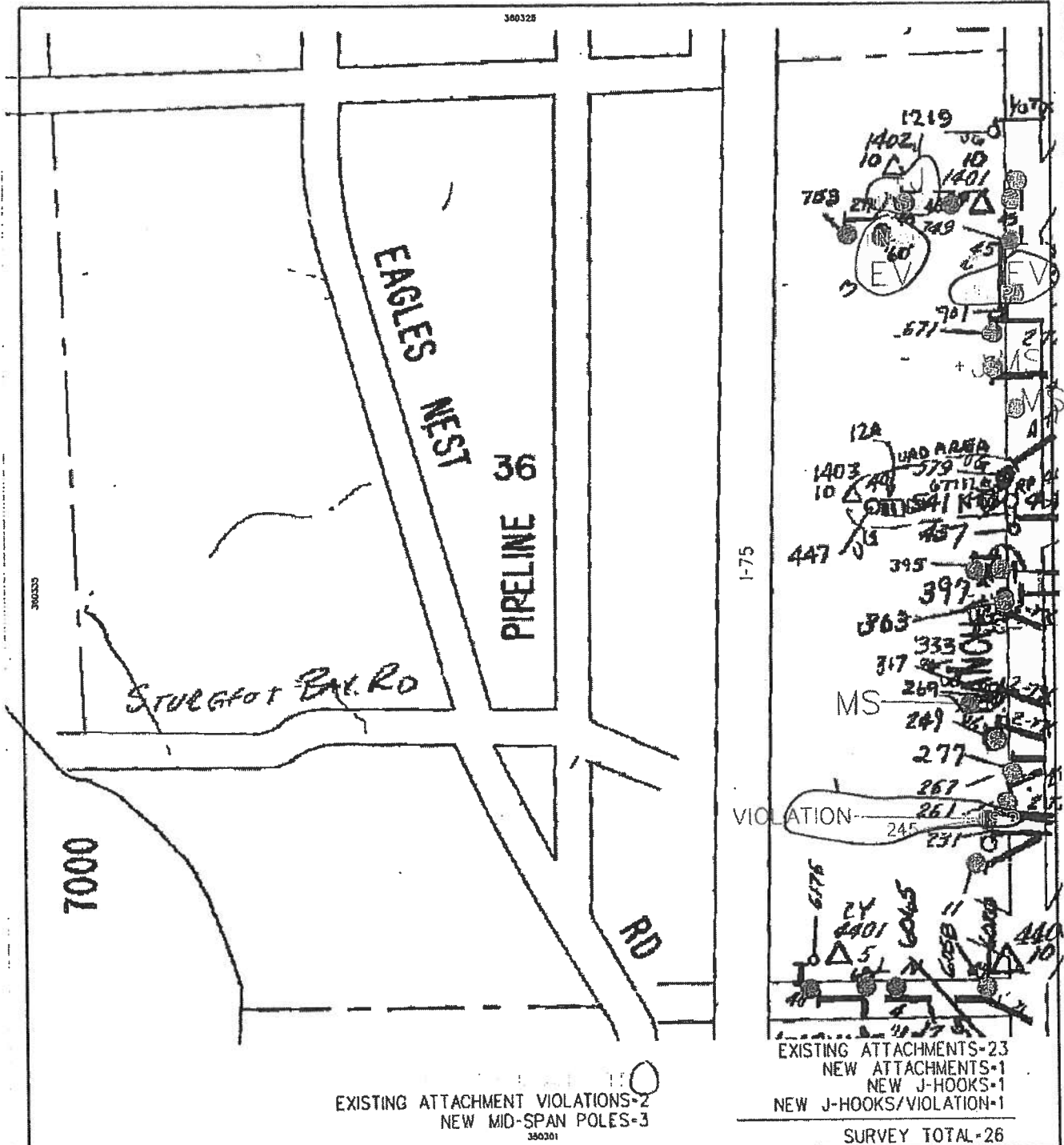

EXISTING ATTACHMENT VIOLATIONS=0
 NEW MID-SPAN POLES=3

EXISTING ATTACHMENTS=23
 NEW ATTACHMENTS=1
 NEW J-HOOKS=1
 NEW J-HOOKS/VIOLATION=1

SURVEY TOTAL=26

| | | | | | |
|-------------------|--|---|--|--------------------------------|------------------|
| COUNTY: CHEBOYGAN | <input type="checkbox"/> Pre-Test Approved <input type="checkbox"/> Secondary Attachment <input type="checkbox"/> Primary Needs assessment <input type="checkbox"/> Service Status of Service | <input checked="" type="checkbox"/> New Branch Attachment <input checked="" type="checkbox"/> Using Service Attachment <input type="checkbox"/> Unattached Pole <input type="checkbox"/> Pole-Top Work | Consumers Energy 31 CHARTER TRAVERSE CITY - 2006 SURVEY SURVEYOR NAME DL HAMPHREY ELECTRIC DISTRIBUTION MAP URBAN SECONDARY CAD OPER NAME DL HAMPHREY | DATE 01-09-07 DATE 02-22-07 | PAGE 36 OF 36 |
|-------------------|--|---|--|--------------------------------|------------------|

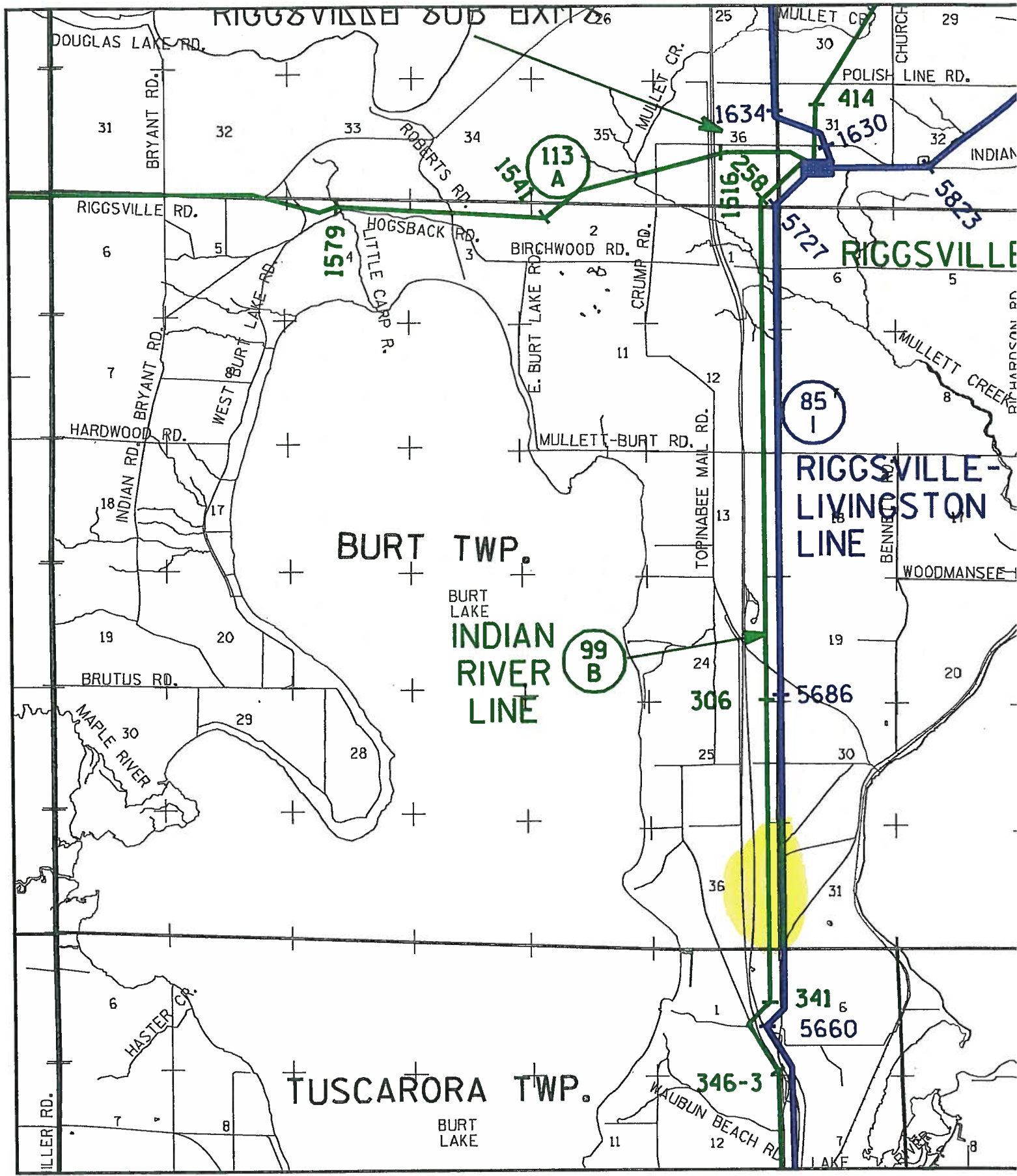

RIGGSVILLE SUB EXIT 26

DOUGLAS LAKE RD.

31

32

33

34

35

25

MULLETT CR.

29

BRYANT RD.

ROBERTS RD.

MULLETT CR.

POLISH LINE RD.

414

1634

1630

INDIAN

RIGGSVILLE RD.

6

5

4

3

2

BIRCHWOOD RD.

1

5727

RIGGSVILLE

5

1579

HOGSBACK RD.

LITTLE CARR R.

E. BURT LAKE RD.

CRUMP RD.

1516

1558

5823

BRYANT RD.

WEST BURT LAKE RD.

HARDWOOD RD.

MULLETT-BURT RD.

85 I

RIGGSVILLE-LIVINGSTON LINE

BURT TWP.

BURT LAKE INDIAN RIVER LINE

99 B

WOODMANSEE

19

20

TOPINABEE MAIL RD.

13

19

20

BRUTUS RD.

306

5686

MAPLE RIVER

29

28

25

30

36

31

341

5660

TUSCARORA TWP.

BURT LAKE

346-3

KAUBUN BEACH RD.

11

12

7

8

MILLER RD.

6

HASTER CR.

7

8

LAKE

