

Li-37785 Pa-146  
203149553 2/10/2003  
Bernard J. Youngblood  
Wayne Co. Register of Deeds

73742

RECORDED R/W FILE NO.

**Detroit Edison Underground Easement (Right of Way) No. Right of Way #RFW414459Can**

On Oct. 20, 2002, 2002, for the consideration of system betterment, Grantor grants to Grantee a permanent underground easement ("Right of Way") in, on and across a part of Grantor's Land called the "Right of Way Area."

**"Grantor" is:**

Van Vliet Condominium Association, a Michigan nonprofit corporation, 5219 Commonwealth, Detroit, Michigan 48208.

**"Grantee" is:**

The Detroit Edison Company, a Michigan corporation, 2000 Second Avenue, Detroit, Michigan 48226

**"Grantor's Land" is in PC 22, City of Detroit, Detroit Township, Wayne County, Michigan described as:**

Lot(s) 43 and 44, Dudley B. Woodbridge's Subdivision of the south 533 8/100 feet of Outlot 109, Woodbridge Farm, as recorded in Liber 9 of Plats, page 74, Wayne County Records.

**The "Right of Way Area" is a part of Grantor's Land and is described as:**

A 10 foot wide easement area, 5 feet on each side of the centerline of the installed facilities, the centerline of which begins at a point on the west line of the above described Grantors land, said west line also being the east line of the adjacent 14 foot wide alley area, said point being approximately at the northwest corner of the above described Lot 44; thence easterly approximately 6 feet to the center of a transformer location, approximately as shown on attached Exhibit A.

1. **Purpose:** The purpose of this Right of Way is to construct, reconstruct, modify, add to, operate and maintain underground utility line facilities consisting of poles, guys, anchors, wires, manholes, conduits, pipes, cables, transformers and accessories.
2. **Access:** Grantee has the right of access to and from the Right of Way Area.
3. **Buildings or other Permanent Structures:** No buildings or other permanent structures are allowed in the Right of Way Area without Grantee's prior written consent.
4. **Excavation:** Under 1974 Public Act 53, you must call MISS DIG (1-800-482-7171) before excavating in the Right of Way Area.
5. **Trees, Bushes, Branches, Roots, Structures and Fences:** Grantee may trim, cut down, remove or otherwise control any trees, bushes, branches and roots in the Right of Way Area (or that could grow into the Right of Way Area) and remove structures and fences in The Right of Way Area that Grantee believes could interfere with the safe and reliable construction, operation and maintenance of Grantee's facilities. No trees, plant life, structures and fences can be planted, grown or installed within 8 feet of the front door and within 2 feet of the other sides of transformers and switching cabinet enclosures. Grantee will not be responsible to Grantor for damages to or removal of trees, plant life, structures and fences placed in front of transformer doors.
6. **Restoration:** If Grantee's employees, contractors, vehicles or equipment damage Grantor's Land while entering Grantor's Land for the purposes stated in this Right of Way, then Grantee will restore Grantor's Land as nearly as can be to its original condition.
7. **Successors:** This Right of Way runs with the land and binds and benefits Grantor's and Grantee's successors and assigns.

**Grantor:** (Type or print name below signature)

Van Vliet Condominium Association

By: James M. Wickert  
Its: President

Acknowledged before me in Wayne County, Michigan, on Oct. 20, 2002, by James M. Wickert the President of Van Vliet Condominium Association, a Michigan nonprofit corporation, for the corporation.

Notary's Stamp	ALBERTA L. CURRY	Notary's Signature	<u>Alberta L. Curry</u>
	NOTARY PUBLIC STATE OF MICHIGAN WAYNE COUNTY MY COMMISSION EXP. NOV. 10, 2004 <small>(Notary's name, county, and date commission expires)</small>		

Prepared by and Return to: Tom Wilson, SR/WA, 12000 Dixie Road, Redford, MI 48239-2453, for DECO Caniff S.C.

EAS 2P 5A

1-94

PC22  
Detroit TP

Exhibit  
A

KIRBY

COMMONWEALTH

North

HECLA

AVERY

TRUMBULL

MERRICK

LI-37785

Pa-147

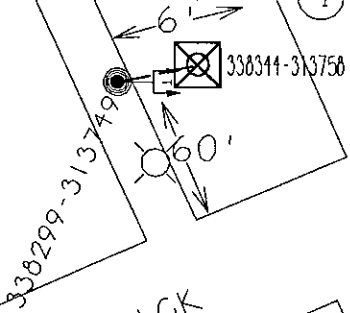

73742

RECORDED R/W FILE NO.

RFW Description Misc Request Service Planning				PD 23	SRW 15	PH 0	PLC 0	Conj. Group C	RFW Number 414459	
Circuit #1 DC 1422 GIBSN	Circuit #2	Service Center #1	Service Center #2	COH 0	COS 0	CUG 37	CUL 34	CUT 0	CUS 0	
Worksite City DETROIT		Worksite Twp.			Worksite County					
Town	Range	Sect	Qtr	Planner Name Trice, Christopher Q		Commit Date 8/15/2002	Scale 1" = 100'	Plot Date 8/15/2002		

337735-313406