

Li-37785 Pa-154
203149577 7/10/2003
Bernard J. Younshiorf
Wayne Co. Register of Deeds

73737
RECORDED R/W FILE NO.

Detroit Edison Underground Easement (Right of Way) No. Right of Way #RFW431208Can

On **OCTOBER 31**, 2002, for the consideration of system betterment, Grantor grants to Grantee a permanent underground easement ("Right of Way") in, on and across a part of Grantor's Land called the "Right of Way Area."

"Grantor" is:

130 Kercheval Associates, LLC, a Michigan limited liability company, 130 Kercheval Avenue, Grosse Pointe Farms, Michigan 48236.

"Grantee" is:

The Detroit Edison Company, a Michigan corporation, 2000 Second Avenue, Detroit, Michigan 48226

"Grantor's Land" is in PC 258, City of Grosse Pointe Farms, Grosse Pointe Township, Wayne County, Michigan described as:

Lot 149, Radnor Park Subdivision, as recorded in Liber 65 of Plats, page 80, Wayne County Records.

The "Right of Way Area" is a part of Grantor's Land and is described as:

The easterly 15 feet of the southerly 15 feet of the above described Grantors land.

1. **Purpose:** The purpose of this Right of Way is to construct, reconstruct, modify, add to, operate and maintain underground utility line facilities consisting of poles, guys, anchors, wires, manholes, conduits, pipes, cables, transformers and accessories.
2. **Access:** Grantee has the right of access to and from the Right of Way Area.
3. **Buildings or other Permanent Structures:** No buildings or other permanent structures are allowed in the Right of Way Area without Grantee's prior written consent.
4. **Excavation:** Under 1974 Public Act 53, you must call MISS DIG (1-800-482-7171) before excavating in the Right of Way Area.
5. **Trees, Bushes, Branches, Roots, Structures and Fences:** Grantee may trim, cut down, remove or otherwise control any trees, bushes, branches and roots in the Right of Way Area (or that could grow into the Right of Way Area) and remove structures and fences in The Right of Way Area that Grantee believes could interfere with the safe and reliable construction, operation and maintenance of Grantee's facilities. No trees, plant life, structures and fences can be planted, grown or installed within 8 feet of the front door and within 2 feet of the other sides of transformers and switching cabinet enclosures. Grantee will not be responsible to Grantor for damages to or removal of trees, plant life, structures and fences placed in front of transformer doors.
6. **Restoration:** If Grantee's employees, contractors, vehicles or equipment damage Grantor's Land while entering Grantor's Land for the purposes stated in this Right of Way, then Grantee will restore Grantor's Land as nearly as can be to its original condition.
7. **Successors:** This Right of Way runs with the land and binds and benefits Grantor's and Grantee's successors and assigns.

Grantor: *(Type or print name below signature)*
130 Kercheval Associates, LLC

By: **EDWARD J. RUSSELL, III**

Its: **MANAGING MEMBER**

Acknowledged before me in WAYNE County, Michigan, on OCTOBER 31, 2002, by EDWARD J. RUSSELL, III the MANAGING of 130 Kercheval Associates, LLC, a Michigan limited liability company, for the company.

MEMBER

Notary's Stamp ACTING IN WAYNE COUNTY Notary's Signature

(Notary's name, county, and date commission expires)

Prepared by and Return to: Tom Wilson, SR/WA, 12000 Dixie Road, Redford MI 48239-2453, for DECO Caniff S.C.

CYNTHIA L. NEVILLE
NOTARY PUBLIC MACOMB CO., MI
MY COMMISSION EXPIRES Nov 14, 2004

EAS R S A

FEEDER NUMBER A-7725		ATTACHMENT "A" AGREEMENT NUMBER 431208	
THE DETROIT EDISON COMPANY - SERVICE PLANNING			
REF. CUL. # REF 431208 CUL 34	REF. CC # REF 431208 CC 27	PRIMARY CABLE SIZE & TYPE 1CX3 X PEJ	STOCK NO. 213-3077 25
NAME NEW OFFICE BLDG		SECONDARY CABLE SIZE & TYPE L-5B8C L-5B8C L-5B8C L-5B8C	TRENCH MAKE-UP TOTAL 80' 105'
ADDRESS 120 KERCHEVAL		LENGTH NO. SETS 40' 2	D.E. CO. Y N
COUNTY WAYNE	CITY/TOWNSHIP G.P.E.	TRANSFORMER SPEC. 1-17-270	TRANSFORMER CONNECTION PAGE 1-17-224 CONN. 17
DISTRIBUTION CIRCUIT & VOLTAGE 2139 DENVER 4.8	MAP SECT. 431208 16	TRANSFORMER ES11561021	DETAIL 1-17-22 Y N
PRIM. TRENCH LENGTH 25 FT	SEC. TRENCH LENGTH 40 FT	TRANSFORMER SIZE 30 Y 300	STOCK NUMBER 661-0512
PRIM. CONDUIT SIZE & TYPE 4" PVC	FISH LINE Y N	CABLE POLE 40K X 40K 40K X 40K	DETAIL 2023B 1 NW
SEC. CONDUIT SIZE & TYPE 4" PVC	LENGTH 40 FT	HEIGHT 32'	DATE 1-15-2002
AS INSTALLED	TYPE	LENGTH	TOTAL
ON PUBLIC PROP.	DATE		
LEADER		CUSTOMER CONTRACTOR	
<input type="checkbox"/> SET NEW POLE	<input type="checkbox"/> SINGLE POLE TO BLDG END FOR FUTURE USE	NOTE: OPEN TRENCH	
<input type="checkbox"/> CABLE POLE	<input type="checkbox"/> TWO POLES TRANSFORMER/BLDG OR DEAD FRONT	INSPECTION REQUIRED, NOTIFY	
<input type="checkbox"/> POSITION OF SLEEP UP CABLE POLE	<input type="checkbox"/> DIRECTION OF TRANSFORMER OVER SPIND	D.E. CO. SERVICE-PLANNER	
<input type="checkbox"/> BONDED PRIMARY CABLE/L V-LINES	<input type="checkbox"/> BOND POST	TELEPHONE	
<input type="checkbox"/> BONDED SECONDARY CABLE	<input type="checkbox"/> PRELIM SWITCH ENGINEER	BEFORE BACK-FILLING	
<input type="checkbox"/> SINGLE BOLT OCCUPED	<input type="checkbox"/> S.C.C. SERVICE CONNECTION CEMENT	SER. PLANNER	
<input type="checkbox"/> DOUBLE BOLT - OCCUPED		DATE	
DE 953-3475 4/93		SCALE 1" = 100'	

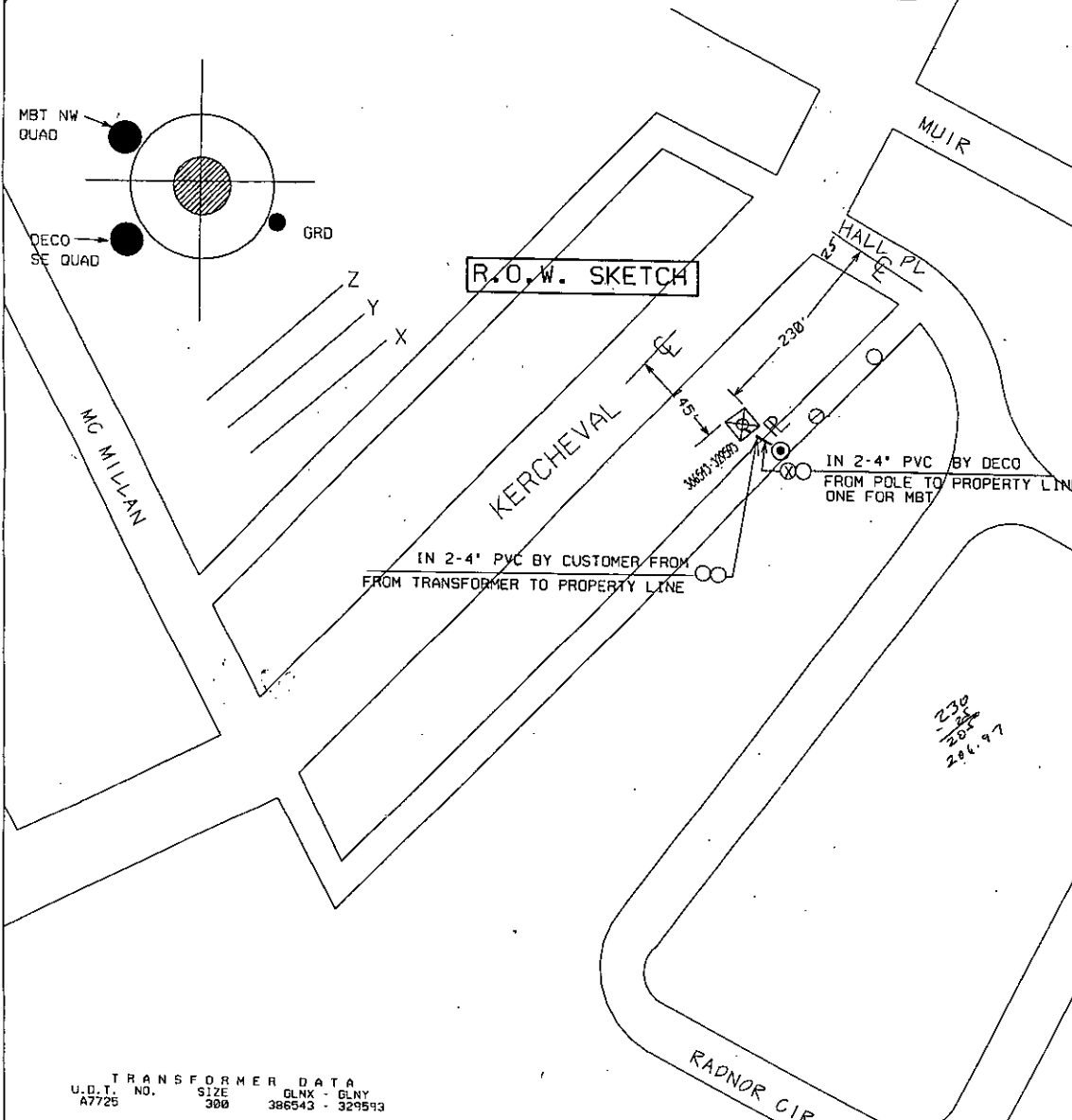

TRANSFORMER DATA
 U.D.T. NO. A7725
 SIZE 300
 GLNX - GLNY 386543 - 329593

RFW Description 120 KERCHEVAL-NEW BUILDING	PD 23	SRW 24	PH 0	PLC 0	Conj. Group 0	RFW Number 431208
Circuit #1 DC 2139 DENVR	Circuit #2	Service Center #1 CANIFF	Service Center #2	CON 0	COS 0	CUG 37
Worksite City GROSSE POINTE FARMS	Worksite Twp.	Worksite County WAYNE		CUL 34	CUT 0	CLS 0
Town Range Sect Ctr	Planner Name Jones, Thomas V	Commit Date 09/12/2002	Scale 1" = 100'	Plot Date 9/12/2002		

RECORDED R/W FILE NO. **7 3737**