

02 APR 22 AM 11:47

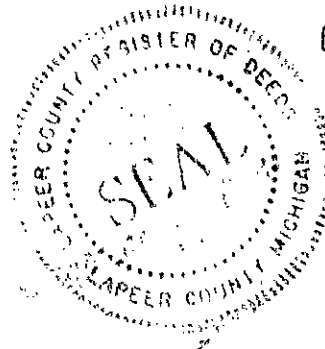
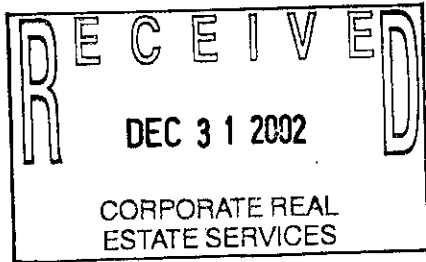

Melissa DeVaugh  
REGISTER OF DEEDS  
LAPEER COUNTY, MICHIGAN

RECORDED R/W FILE NO. 72018

**Detroit Edison Overhead Easement (Right of Way) No. 321459**

On Feb 4 2002, 2002, for the consideration of system betterment, Grantor grants to Grantee a permanent overhead easement ("Right of Way") in, on and across a part of Grantor's Land called the "Right of Way Area."

"Grantor" is:

Kenneth Oliver and Carol Oliver, husband and wife, 303 W. Barnes Road, Fostoria, MI 48435

"Grantee" is:

The Detroit Edison Company, a Michigan corporation, 2000 Second Avenue, Detroit, Michigan 48226

"Grantor's Land" is in Rich Township, Lapeer County, Michigan described as:

Section 19, T10N R10E The South 208' of the East 302' of the Southwest 1/4 of the Southeast 1/4

The "Right of Way Area" is a part of Grantor's Land and is described as:

A 12' wide easement for an anchor extending approximately 26' to the West from the East property line, as shown on Exhibit "A", which is attached hereto and made a part hereof.

- 1. **Purpose:** The purpose of this Right of Way is to construct, reconstruct, modify, add to, operate and maintain overhead utility line facilities consisting of poles, guys, anchors, wires, cables, transformers and accessories.
- 2. **Access:** Grantee has the right of access to and from the Right of Way Area.
- 3. **Buildings or other Permanent Structures:** No buildings or other permanent structures are allowed in the Right of Way Area without Grantee's prior written consent.
- 4. **Trees, Bushes, Branches, Roots, Structures and Fences:** Grantee may trim, cut down, remove or otherwise control any trees, bushes, branches and roots in the Right of Way Area (or that could grow into the Right of Way Area) and remove structures and fences in The Right of Way Area that Grantee believes could interfere with the safe and reliable construction, operation and maintenance of Grantee's facilities.
- 5. **Restoration:** If Grantee's employees, contractors, vehicles or equipment damage Grantor's Land while entering Grantor's Land for the purposes stated in this Right of Way, then Grantee will restore Grantor's Land as nearly as can be to its original condition.
- 6. **Successors:** This Right of Way runs with the land and binds and benefits Grantor's and Grantee's successors and assigns.

(2) Witnesses: (Type or print name below signature)

Grantor: (Type or print name below signature)

X Carol & Kenneth Oliver Kenneth Oliver  
Kenneth Oliver

X Patrick J. Ogg Patrick J. Ogg Carol Oliver  
Carol Oliver  
Jerry Ogg Jerry Ogg 989 795-3043

Acknowledged before me in Lapeer County, Michigan, on Feb. 4, 2002, by Kenneth Oliver and Carol Oliver, husband and wife.

Notary's Stamp Lapeer Cty. Expires 1-09-04 Notary's Signature Betty J. Dean  
(Notary's name, county, and date commission expires)

Prepared by and Return to: Betty J. Dean, lapsc, 1100 Clark Rd., Lapeer, MI 48446bjd

RECORDED R/W FILE NO. 72018

North

REPORT OF PROPERTIES AND RIGHTS OF WAY DEPARTMENT R/W SECURED AS INDICATED ON THIS SKETCH		PERMITS TO:	
BY	<u>Gm</u>	RECORD CENTER	<u>2</u>
DATE	<u>3-20-02</u>	R/W FILES	<u>2</u>
DATE WANTED		MBT	<u>0</u>
DISTRICT FIELDMAN	<u>B. J. ...</u>	ORIGINATOR	<u>2</u>
		TOTAL	<u>2</u>

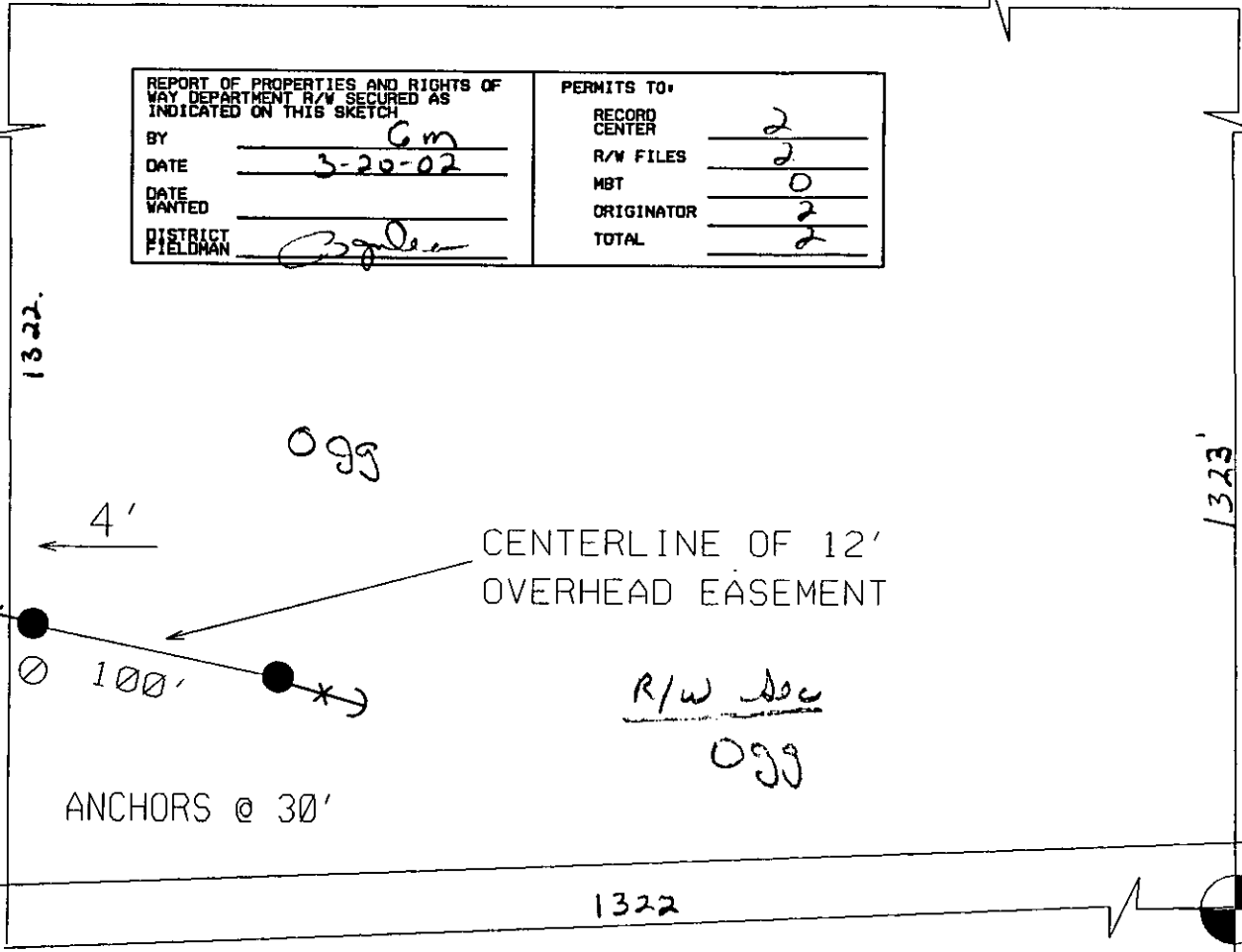

R/W Sec Oliver

CENTERLINE OF 12' OVERHEAD EASEMENT

R/W Sec OGG

ANCHORS @ 30'

BARNES

EXHIBIT A

SE 1/4 COR  
SEC 19  
RICH TWP

RFW Description				PD	SRW	PH	PLC	Conj. Group	RFW Number		
311 BARNES RD - NEW RES JERRY OGG				4	5	15	0	B	321459		
Circuit #1	Circuit #2	Service Center #1	Service Center #2	COH	COS	CUG	CUL	CUT	CUS		
DC 8089 RUSH				20	0	0	0	0	0		
Worksite City				Worksite Twp.				Worksite County			
				RICH							
Town	Range	Sect	Qtr	Planner Name			Commit Date	Scale	Plot Date		
10N	10E	19		Makar, Gary G			1/10/2002	1" = 100'	1/10/2002		

MISC D	9.00
ESMT	P0009
REMOVT	2.00