

Detroit Edison

C0247613 LIBER:06753 PAGE:309 01:48 09/07/1995
CARMELLA SABAUGH-MACOMB COUNTY, MI REG/DEEDS

13-

**UNDERGROUND DISTRIBUTION EASEMENT (RIGHT OF WAY) NO. R-9501261-01
PROJECT NAME FRANKLIN WOODS CONDOMINIUMS**

On 6-26, 1995, for the consideration of system betterment, Grantor grants to Grantee a permanent underground distribution easement ("Right of Way") in, on and across a part of Grantor's Land called the "Right of Way Area".

"Grantor" is:

Frank Karam, a single man, 34457 Maple Lane, Sterling Heights, Michigan 48312

Mark Korte, a/k/a Mark F. Korte and Carol L. Korte, husband and wife, 45800 Schoenherr, Shelby Township, Michigan 48316

"Grantee" is:

The Detroit Edison Company, a Michigan corporation, 2000 Second Avenue, Detroit, Michigan 48226

Comcast Cablevision, a Delaware corporation, 6808 - 19 1/2 Mile Road, Sterling Heights, Michigan 48314

Ameritech corporation, a Michigan corporation, 444 Michigan Avenue, Detroit, Michigan 48226

"Grantor's Land" is in Township of Shelby, Macomb County, described as:

Parcel 1:

A parcel of land in the Southwest 1/4 of Section 36, T3N, R12E, being described as: Commencing at the West 1/4 post of Section 36; thence South 03 degrees 35 minutes 00 seconds West 394.96 feet to the point of beginning; thence South 86 degrees 41 minutes 40 seconds East 1323.94 feet; thence South 03 degrees 27 minutes 40 seconds West 149.30 feet; thence North 89 degrees 08 minutes 01 seconds West 1305.59 feet along centerline of drain; thence North 62 degrees 58 minutes 00 seconds East 21.93 feet; thence North 03 degrees 35 minutes 00 seconds East 196.04 feet to the point of beginning.

Parcel 2:

Commencing at the West 1/4 post of Section 36, T3N, R12E; thence South 03 degrees West 98.75 feet to the point of beginning, thence South 86 degrees 41 minutes 40 seconds East 1323.10 feet; thence South 03 degrees 35 minutes West 295.50 feet; thence North 86 degrees 41 minutes 40 seconds West 1023.94 feet; thence North 03 degrees 35 minutes East 145 feet; thence North 86 degrees 41 minutes 40 seconds West 300 feet; thence North 03 degrees 35 minutes East 151.21 feet to the point of beginning.

Parcel 3:

A parcel of land in the Southwest 1/4 of Section 36, T3N, R12E; commencing at the West 1/4 post of Section 36; thence South 86 degrees 41 minutes 40 seconds East 680.00 feet along the East and West 1/4 line of Section 36 to the point of beginning; thence South 86 degrees 41 minutes 40 seconds East 643.10 feet; thence South 03 degrees 27 minutes 40 seconds West 98.75 feet; thence North 86 degrees 41 minutes 40 seconds West 643.31 feet; thence North 03 degrees 35 minutes 00 seconds East 98.75 feet to the point of beginning.

The "Right of Way Area" is a part of Grantor's Land and is described as:

Easements as shown on the attached sketch 95A73749. The exact location of underground equipment must be determined by the UTILITY COMPANIES. For exact locations, telephone MISS DIG at 1-800-482-7171. The exact location of underground equipment indicates the centerline of said Right of Way.

1. **Purpose:** The purpose of this Right of Way is to construct, reconstruct, modify, add to, operate and maintain underground distribution utility line facilities consisting of poles, guys, anchors, wires, manholes, conduits, pipes, cables, transformers and accessories.
2. **Access:** Grantee has the right of access to and from the Right of Way Area.
3. **Buildings or other Permanent Structures:** No buildings or other permanent structures shall be placed in the Right of Way Area without Grantee's prior written consent.
4. **Excavation:** As required by Public Act 53 of 1974, MISS DIG must be called on 1-800-482-7171 before anyone excavates in the Right of Way Area.
5. **Trees, Bushes, Branches, Roots, Structures and Fences:** Grantee may trim, cut down, remove or otherwise control any trees, bushes, branches and roots in the Right of Way Area (or that could grow into the Right of Way Area) and remove structures and fences in the Right of Way Area that Grantee believes could interfere with the safe and reliable construction, operation and maintenance of Grantee's facilities. No trees, plant life, structures and fences shall be planted, grown or installed within 8 feet of the front door and within 2 feet of the other sides of transformers and switching cabinet enclosures. Grantee shall not be responsible to Grantor for damages to or removal of trees, plant life, structures and fences placed in front of transformer doors.
6. **Ground Elevation:** Grantor must grade the Right of Way Area to within four inches of final grade before Grantee installs its facilities. Grantor must maintain this ground elevation after Grantee installs its facilities.
7. **Damages:** If Grantor, its agents, employees or contractors, damage Grantee's facilities, Grantee shall make repairs at Grantor's expense.
8. **Successors:** This Right of Way runs with the land and binds and benefits Grantor's and Grantee's successors, lessees, licensees and assigns.

C0287496 LIBER:06850 PAGE:876 09:38A 12/13/1995
CARMELLA SABAUGH-MACOMB COUNTY, MI REG/DEEDS

BEING re-recorded to reflect revised sketch 95A73749.

100897-18000

B 11/2

Detroit Edison

Witnesses:(type or print name below signature)

Grantor:(type or print name below signature)

Susan A. Putrycus

Frank Karam

SUSAN A. PUTRYCUS

Frank Karam, a single man

Robert Hornby
ROBERT HORNBY

Laura Pauluk
Laura Pauluk

Mark Korte

Mark Korte, a/k/a Mark F. Korte

Diane Lee
Diane Lee

Carol L. Korte

Carol L. Korte, his wife

Acknowledged before me in Macomb County, Michigan, on June 26, 1995 by Frank Karam, a single man.

SUSAN ANNE PUTRYCUS
Notary Public, Macomb County, Michigan
My Commission Expires July 26, 1995

Notary's Stamp

(Notary's name, county, and date commission expires)

Notary's Signature

Susan Anne Putrycus

Acknowledged before me in Macomb County, Michigan, on June 26, 1995 by Mark Korte, a/k/a Mark F. Korte and Carol L. Korte, husband and wife.

LAURA PAULUK
Notary Public, Macomb County, Michigan
My Commission Expires May 14, 1997

Notary's Stamp

(Notary's name, county, and date commission expires)

Notary's Signature

Laura Pauluk
Laura Pauluk

Prepared by and Return to: Susan Putrycus, 6301 23 Mile Road, Shelby Township, MI 48316

4184
665

LOCATION SKETCH
 MAP SEC. NO. 1-381-414
 21 MILE ROAD
 HALL ROAD (M-59)

C0247613 LIBER:06753 PAGE:312 01:48P 09/07/1995
 CARMELLA SABAUGH-MACOMB COUNTY, MI REG/DEEDS

C0247613 LIBER:06753 PAGE:311 01:48P 09/07/1995
 CARMELLA SABAUGH-MACOMB COUNTY, MI REG/DEEDS

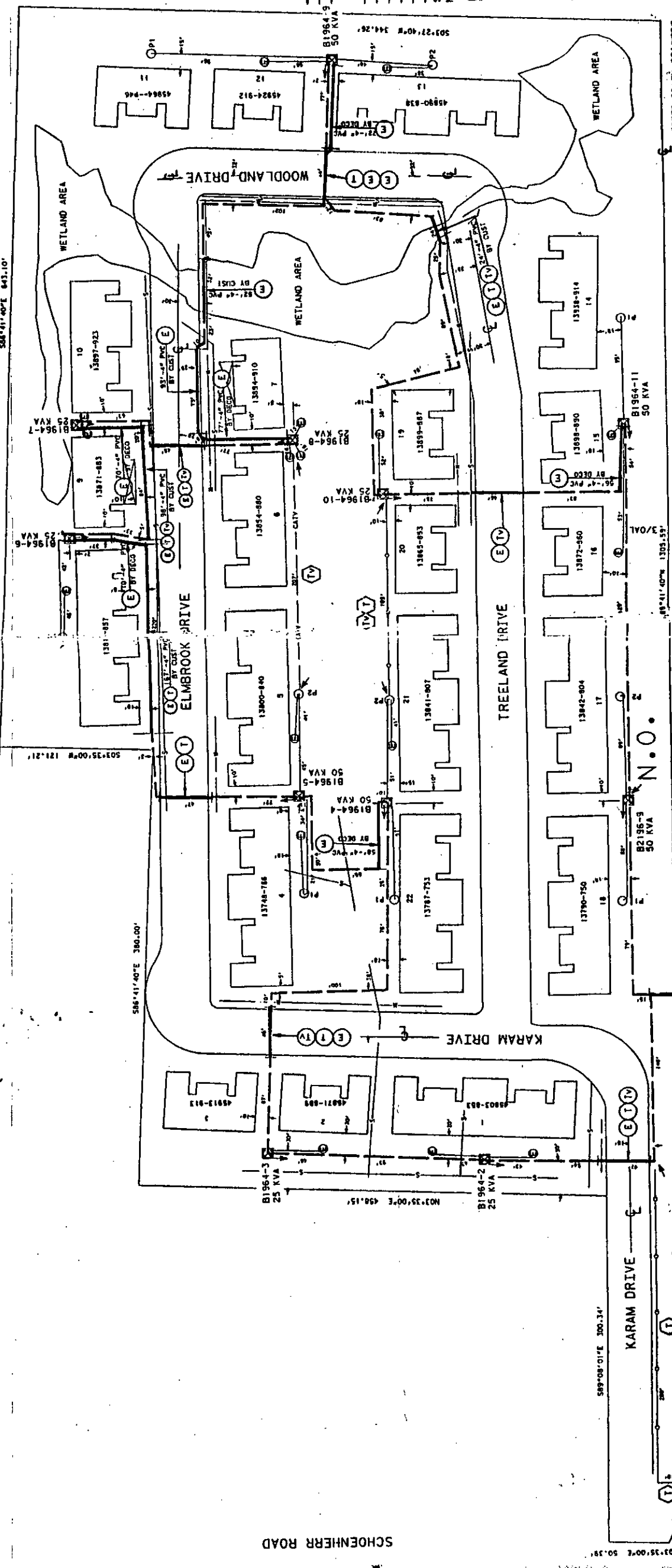

TRANSFORMER SPEC. 1-17-261
 PEDISTAL AMOUNT 1.0
 TEMPORARY CABLE MARKER AMOUNT 1.7
 SECONDARY CONNECTION BOX AMOUNT 1.7

CODE
 TEMPORARY SECONDARY PEDISTAL/TEMPORARY CABLE MARKER
 DFT (READ FRONT TYPE)
 WFT (NON-WETTING - LIVE FRONT TYPE)
 WDT (SWITCHING - LIVE FRONT TYPE)
 DIRECTION OF TRANSFORMER DOOR OPENING
 SECONDARY PEDISTAL
 SECONDARY CONNECTION BOX
 CABLE POLE
 PRIMARY SWITCH CABINET
 NUISSED PRIMARY CABLE - ALL VOLTAGES
 BANNED SECONDARY CABLE
 BANNED SECONDARY SERVICE CABLE
 DETROIT EXTENSION TRENCH ONLY

NOTE:
 METER SHALL BE LOCATED IN SHADY AREA CLOSEST TO D.E.CO. SOURCE

ESTIMATED
 713-3074-4251
 713-0310-1157
 713-0334-1157
 713-0814-5327

FRONT
 DWELLING

CABLE SUMMARY
 ITEM # 24PCS 2.1 13.2V
 ITEM # 4PCS 3.0 1-4/0 600V
 ITEM # 4PCS 3.0 1-4/0 600V
 ITEM # 4PCS 2.0 1.1PT 600V

TRENCH SUMMARY
 JURY USE E-T+V=2913'
 D.E. ONLY E-T=428'
 TEL. ONLY E-T=141'
 GAS ONLY E-T=185'
 CATV ONLY T=207'
 OTHERS T=239'

GENERAL NOTES
 TRENCHING TO BE DONE BY DECO
 TRENCH AND CABLE LOCATIONS ARE APPROXIMATE
 SEE SECTION 56 OF LUM CONSTRUCTION STANDARDS FOR TRENCH INT. DETAILS
 SEE PAGE 3-2-11 S.I.C.M. DETAIL " " FOR ENTRANCE POINT DETAILS (APTS. ONLY)
 SEE SECTION 43 OF LUM CONSTRUCTION STANDARDS FOR PLACEMENT OF CABLES,
 TRANSFORMERS AND PEDISTALS (SAB/US ONLY)
 D.E. SERVICE PLANNING BOB BILSCAR 228-4226
 TEL. CO. LEE DELELLA 466-1040
 GAS CO. 1
 CITY CO. 1 HENRY POSTL 726-4903
 OTHERS
 EASEMENTS INDICATED BY OUR CENTERLINE ARE IN WIDTH UNLESS OTHERWISE NOTED.

NOTICE
 Locations of underground facilities on this drawing are only approximate. Exact locations must be determined by the UTILITY COMPANIES. For exact locations, Telephone MESS DIG on 800-482-1171 as required by Public Act 53 of 1974 before doing any power excavating.

NOTES:
 ALL LOAD LOSSINGS ARE 50'-4" PVC BY CUSTOM
 ALL TCM'S ARE FEED WITH 2/OAL CABLE UNLESS NOTED OTHERWISE
 ALL PEDISTALS ARE FEED WITH 350M CABLE

TRANSFORMER DATA

U.D.T. NO.	SIZE	ED. STL. NO.
B1964-2	25 KVA	661-1151
B1964-3	25 KVA	661-1151
B1964-4	50 KVA	661-1152
B1964-5	50 KVA	661-1152
B1964-6	25 KVA	661-1152
B1964-7	25 KVA	661-1152
B1964-8	25 KVA	661-1152
B1964-9	25 KVA	661-1152
B1964-10	25 KVA	661-1152
B1964-11	50 KVA	661-1152
B2196-9	50 KVA	661-1152

DATE	BY	APPROVED BY	REVISION
06/20/95 <td>D. HUFFMAN <td> <td>A </td></td></td>	D. HUFFMAN <td> <td>A </td></td>	<td>A </td>	A
			B
			C
			D

PROJECT NO. SQA-74771

DATE 06/20/95

BY D. HUFFMAN

APPROVED BY [Signature]

SEALS TO UNIT

FRANKLIN WOODS CONDO'S

PARCEL OF LAND IN THE S.W. 1/4 SEC. 36 T34N12E

COUNTY OF SHELBY

8648 MALTA 13.2KV

95A-73749

THE DETROIT EDISON COMPANY
 SERVICE PLANNING
 NUMBER OF UNITS WORK ORDER NUMBER
 3678393J365