

+

+

RIGHT OF WAY FILE #

R46191

PROJECT #

DEPARTMENT ORDER #

CROSS REFERENCE #

PROJECT DESCRIPTION

SIDWELL TAX #

24-03-476-001

R/W TYPE

N

MAP

X

Y

N

O

RR INVOICE #

FAC TYPE

RR TOWNSHIP

RR CROSSING #

RR CODE #

OH / UG

OH

UG

GRANTOR #1 NAME

SCHOOL DISTRICT FOR

CITY OF BIRMINGHAM

STREET ADDRESS #1

550 WEST MERRIL ST

ST #1

MI

CITY/TOWN #1

BIRMINGHAM

ZIP CODE #1

48012

GRANTOR NAME #2

STREET ADDRESS #2

ST #2

CITY/TOWN #2

ZIP CODE #2

EASEMENT DESCRIPTION

10

AGREEMENT DATE

060294

AGREEMENT TYPE

R

P

C

LIBER #

14954

PAGE #

DRAWING R/W #

R940270101

PVT CL #

SECTION

3

QUARTER SECTION 3

1/4

1/2

QUARTER SECTION 2

1/4

1/2

QUARTER SECTION 1

SE

X

1/4

1/2

TOWNSHIP

SOUTHFIELD

COUNTY

OAKLAND

RTE OF LINE

N/S E/W B

TOWNSHIP RANGE

T1N R10E

DIVISION CODE

X

A D M O T W

SUBDIVISION NAME

EAST OF

WEST OF

EVERGREEN

NORTH OF

THIRTEEN MILE RD

SOUTH OF

OUT LOT

BLOCK #1

LOT #1

BLOCK #2

LOT #2

+

+

APPLICATION FOR RIGHT OF WAY

DE 963-0811 5-7455 (MS 80)

Hickory Sub
Job: 94-056

PLEASE SECURE RIGHT OF WAY AS FOLLOWS:

DATE April 5, 1994

LOCATION West of Evergreen and north of 13 Mile Rd.

APPLICATION NO. R-9402701-01R

CITY ~~XXXXXX~~ Beverly Hills

DEPT. ORDER NO. _____

TOWNSHIP Southfield COUNTY Oakland

O. F. W. NO. 4KB78/H01

DATE BY WHICH RIGHT OF WAY IS WANTED May, 1994

BUDGET ITEM NO. _____

THIS R/W IS _____ % OF TOTAL PROJECT NO. _____ ACCUM. _____ %.

INQUIRY NO. _____

JOINT RIGHT OF WAY REQUIRED YES NO

NOTE: Identify on print or sketch the subdivisions as to section location and liber and page.

KIND AND DESCRIPTION OF RIGHT OF WAY REQUESTED _____

A 10' x 20' Detroit Edison easement with rights of ingress and egress.
DRWG. UI-1-3597

PURPOSE OF RIGHT OF WAY To install a primary switch cabinet to cut over primary service
454 to Wylie E. Groves High School from O.H. to U.G. service.

SIGNED John Witherell
520 S.B. Underground Design
OFFICE DEPARTMENT

REPORT OF REAL ESTATE AND RIGHTS OF WAY DEPT.

RECORDED RIGHT OF WAY NO. 46191

PERMITS IN RECORD CENTER _____ R.E. & R/W DEPT. FILE _____ GRANTOR _____

NO. OF PERMITS _____ NO. OF STRUCTURES _____ NO. OF MILES _____ PERMITS TO MBT _____

DATE _____ SIGNED Jim McDaniel 10-26-94

UNDERGROUND EASEMENT (RIGHT OF WAY) NO. R-9402701-01

On JUNE 2, 1994, for the consideration of system betterment, Grantor grants to Grantee a permanent underground easement ("Right of Way") in, on and across a part of Grantor's Land called the "Right of Way Area".

"Grantor" is:

School District for the City of Birmingham, a Michigan School District, 550 West Merrill Street, Birmingham, Michigan 48012,

"Grantee" is:

The Detroit Edison Company, a Michigan Corporation, 2000 Second Avenue, Detroit, Michigan 48226,

\$ 9.00 MISCELLANEOUS RECORDING
\$ 2.00 RENOVATION
7 SEP 94 9:16 A.M. RECEIPT# 218
PAID RECORDED - OAKLAND COUNTY
LINDA D. ELLEN, CLERK/REGISTER OF DEEDS

"Grantor's Land" is in the City of Southfield, Oakland County, described as:

Part of Southeast one-quarter (1/4), Section 3, Town 1 North, Range 10 East, beginning at Southeast section corner, thence North 00°55'41" East 1364.41 feet, thence West 1631.61 feet, thence South 00°51'20" West 1306.97 feet, thence South 87°58'55" East 1630.04 feet to beginning, containing approximately 50 acres, more or less, Oakland County Records. Sidwell No. 24-03-476-001.

The "Right of Way Area" is a part of Grantor's Land and is described as:

The Northerly Ten (10) feet of the Southerly Three Hundred Fifty (350) feet of the Easterly Twenty (20) feet of Grantor's land, further described on the attached drawing No. U1-1-3597.

- 1. Purpose:** The purpose of this Right of Way is to construct, reconstruct, modify, add to, operate and maintain underground utility line facilities consisting of poles, guys, anchors, wires, manholes, conduits, pipes, cables, transformers and accessories.
- 2. Access:** Grantee has the right of access to and from the Right of Way Area.
- 3. Buildings or other Permanent Structures:** No buildings or other permanent structures shall be placed in the Right of Way Area without Grantee's prior written consent.
- 4. Excavation:** As required by Public Act 53 of 1974, MISS DIG must be called on 1-800-482-7171 before anyone excavates in the Right of Way Area.
- 5. Trees, Bushes, Branches, Roots, Structures and Fences:** Grantee may trim, cut down, remove or otherwise control any trees, bushes, branches and roots in the Right of Way Area (or that could grow into the Right of Way Area) and remove structures and fences in the Right of Way Area that Grantee believes could interfere with the safe and reliable construction, operation and maintenance of Grantee's facilities. No trees, plant life, structures and fences shall be planted, grown or installed within 8 feet of the front door and within 2 feet of the other sides of transformers and switching cabinet enclosures. Grantee shall not be responsible to Grantor for damages to or removal of trees, plant life, structures and fences placed in front of transformer doors.
- 6. Restoration:** If Grantee's employees, contractors, vehicles or equipment damage Grantor's Land while entering Grantor's Land for the purposes stated in this Right of Way, then Grantee shall restore Grantor's Land as nearly as can be to its original condition.
- 7 Successors:** This Right of Way runs with the land and binds and benefits Grantor's and Grantee's successors, lessees, licensees and assigns.

Witnesses:(type or print name below signature)

Grantor:(type or print name below signature)
School District for the City of Birmingham,
a Michigan School District

Rosemary Kling
Rosemary Kling

[Signature]
By:

Anora Fisher
Anora Fisher

Assistant Superintendent for
Its: Business Services

Acknowledged before me in Oakland County, Michigan, on June 2, 1994
by Richard Perry the Asst Sup for Business
of School District for the City of Birmingham, a Michigan School District, for the Michigan School District.

Notary's Stamp Notary Public, Livingston County, MI Notary's Signature Patricia Amelkond
My Commission Expires May 29, 1998
(Notary's name, county and date commission expires)

Prepared by and Return to: James D. McDonald, 30400 Telegraph Road, Suite 210, Birmingham, Michigan 48025/kad

O.K. -S.R.

RECORDED RIGHT OF WAY NO. 46/191

RETURN TO
J. D. McDONALD
THE DETROIT EDISON COMPANY
30400 TELEGRAPH ROAD, SUITE 210
BIRMINGHAM, MICHIGAN 48025

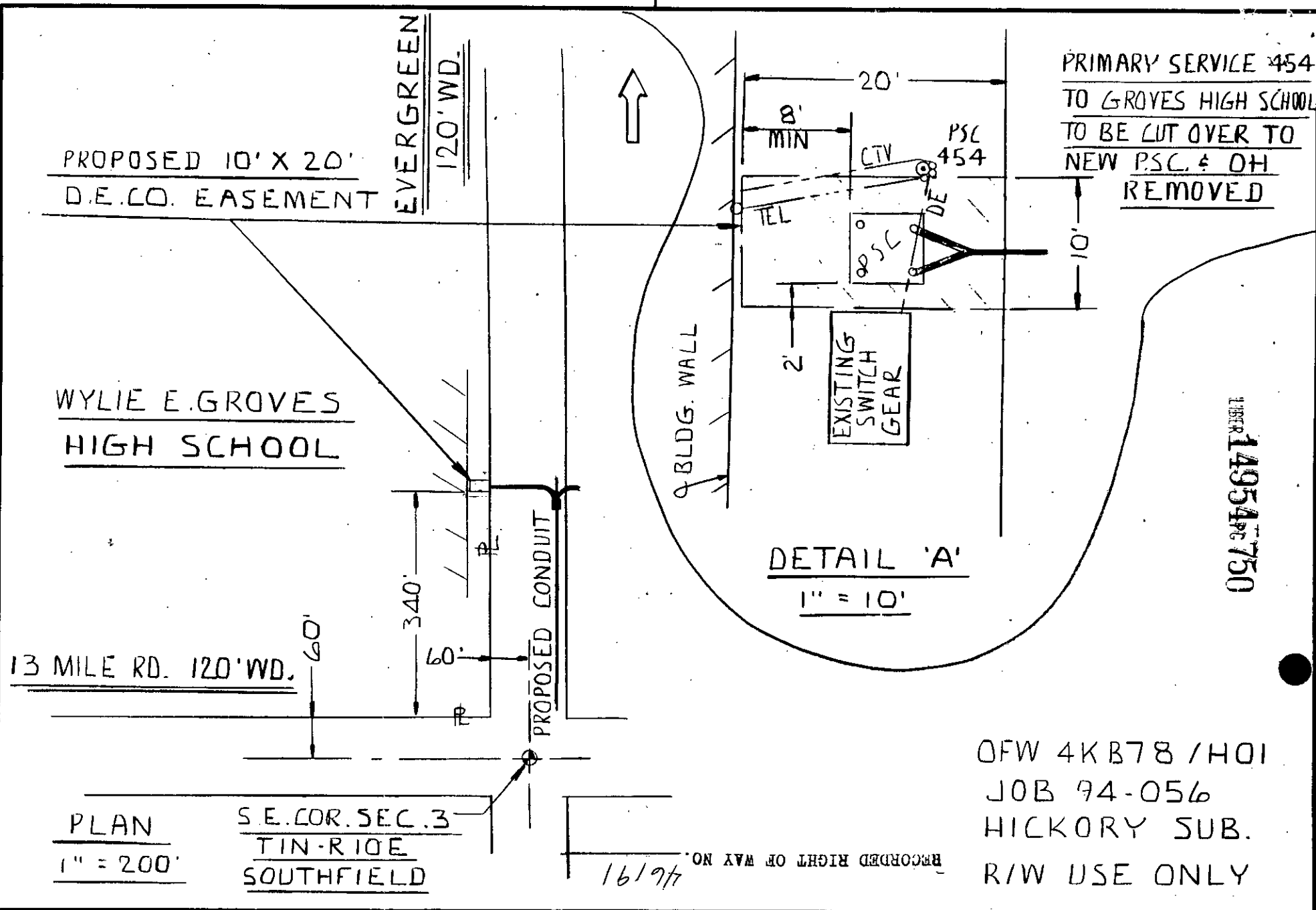

149547750

OFW 4KB78 / H01
 JOB 94-056
 HICKORY SUB.
 R/W USE ONLY

RECORDED RIGHT OF WAY NO. 16197

PLAN
 1" = 200'

S.E. COR. SEC. 3
 T1N-R10E
 SOUTHFIELD

| | | | | | |
|-------------------------|----------|-----|---------|--|----------------------------|
| Reference U3-5-9815E | Drawn | RHC | 3/31/94 | Title PROPOSED 10' X 20' EASEMENT EVERGREEN, NORTH OF 13 MILE VILLAGE OF BEVERLY HILLS - OAKLAND CO | The Detroit Edison Company |
| | O.K. | RAG | 4/5/94 | | |
| | Approved | JMW | 4/5/94 | | |
| | | | | | SCALE AS SHOWN |
| | | | | | No. U1-1-3597 |

11/11/11

RETURN TO
J. D. McDONALD
THE DETROIT PERSON COMPANY
30400 TELEGRAPH ROAD, SUITE 310
BIRMINGHAM, MICHIGAN 48025