

LIBER 14655 PC 00

88 88193 128180

LIBER 10458 PC 597

A#36 REG/DEEDS PAID
0001 JUN.20.88 01:51PM
6504 MISC 9.00

Detroit Edison

Right of Way Agreement

April 1, 19 88

3
MIT

This easement is re-recorded for purposes of showing the planned "as installed" centerlines of easements granted as shown on drawing attached hereto.

For valuable consideration, the receipt of which is hereby acknowledged, the undersigned hereby grant and convey to THE DETROIT EDISON COMPANY, a corporation organized and existing concurrently under the laws of the States of Michigan and New York, of 2000 Second Avenue, Detroit, Michigan 48226 and the MICHIGAN BELL TELEPHONE COMPANY, a Michigan corporation, of 444 Michigan Avenue, Detroit, Michigan 48226 hereinafter referred to as "UTILITIES", the easement and right to erect, lay, maintain, reconstruct and replace underground facilities consisting of wires, cables, conduits, fixtures and appurtenances including the necessary above ground equipment, connections, poles and accessories which may from time to time be required in, under, upon, over and across the land located in the Township of Waterford, Oakland County, Michigan, and more particularly described on the attached Appendix "A", with the full right to the UTILITIES of ingress and egress upon said land for the purposes of this grant, and the further right to trim, cut down or otherwise control brush and trees within the easements herein described.

Said easements shall be ten (10) feet in width unless otherwise indicated and their route is described as follows:

The exact location of said easements shall be shown on a drawing to be recorded within 90 days after construction.

In order to provide for the proper maintenance and protection of UTILITIES, the undersigned covenant and agree that:

1. The easements will be graded to within four (4) inches of final grade before the UTILITIES lines are installed and this ground elevation must be maintained after installation of utilities to avoid the pooling of water in, on or around above ground UTILITIES' equipment.

2. No buildings or structures other than UTILITIES equipment are to be placed within the easements herein granted. No excavation is to be permitted within said easement without approval of UTILITIES.

3. If the lines or facilities of UTILITIES are damaged by the acts of Owners, their agents, employees or contractors, repairs shall be made by the Utility company so damaged at the cost and expense of Owners. Owners are defined as those persons owning the land at the time the damage occurred, provided, however, Joseph and Pearl Cook shall have no liability whatsoever under this paragraph until they obtain full title (including the beneficial interest of Chantal Development) in the Property.

4. No shrubs or foliage shall be planted or grown within five (5) feet of the front door of transformers or switching cabinet enclosures. UTILITIES shall not be responsible to Owners for damages to or removal of trees or plant life planted in front of said door or within the easement causing an interference with UTILITIES maintenance of their equipment.

THIS GRANT is declared to be binding upon the heirs, successors, lessees, licenses and assigns of the parties hereto.

IN WITNESS WHEREOF, the undersigned have hereunto set their hand and seal on this date.

Witnesses:

Grantors:

B#92 REG/DEEDS PAID
0001 MAY.03.94 11:57AM
9161 MISC 13.00

See Next Page

B#92 REG/DEEDS PAID
0001 MAY.03.94 11:57AM
9161 MISC 13.00

Prepared By: Omer V. Racine
The Detroit Edison Company
30400 Telegraph Rd., Suite 264
Birmingham, MI 48010

Address:

[Handwritten signature]

O.K. - J.S.

RECORDED RIGHT OF WAY NO. 45921

**RETURN TO:
TERRY L. BENEDICT
THE DETROIT EDISON COMPANY
1970 ORCHARD LAKE ROAD
SYLVAN LAKE, MI 48320**

~~Return to S. M. Donald
Detroit Edison
30400 Orchard Lake
Birmingham, MI 48019~~

Witnesses:

Michael B. Perlman
MICHAEL B. PERLMAN

Joseph L. Cook
Joseph L. Cook

JoAnn McGee
JOANN MCGEE

Pearl D. Cook
Pearl D. Cook, his wife
3921 Kirkland Court
Bloomfield Hills, MI 48013

"LAND CONTRACT VENDOR"

State of Michigan)
) SS:
County of OAKLAND)

Personally came before me this 1st day of April, 1988, the above named **Joseph L. Cook** and **Pearl D. Cook**, his wife, known to be the persons who executed the foregoing instrument and acknowledged that they executed the same as their free act and deed.

My Commission Expires: 2/5/90

JoAnn McGee
JOANN MCGEE
Notary Public,
County, Michigan

RECORDED
INDEXED
APR 15 1988

Witnesses:

Chhatwal Development
a Michigan co-partnership
21771 Hidden Rivers North Dr.
Southfield, MI 48075

JoAnn McGee
JOANN MCGEE

Melanie Turley
MELANIE TURLEY

By: T.S. Chhatwal
T. S. Chhatwal
Its: Managing Partner

"LAND CONTRACT VENDEE"

State of Michigan)
) SS:
County of OAKLAND)

Personally came before me this 1st day of April, 1988, the foregoing instrument was acknowledged before me by **T. S. Chhatwal**, Managing Partner of Chhatwal Development, a Michigan co-partnership, on behalf of the partnership.

My Commission Expires: 2/5/90

JoAnn McGee
JOANN MCGEE
Notary Public,
County, Michigan

**RETURN TO:
TERRY L. BENEDICT
THE DETROIT EDISON COMPANY
1970 ORCHARD LAKE ROAD
SYLVAN LAKE, MI 48320**

~~Handwritten scribbles and signatures at the bottom of the page, including what appears to be a name and address.~~

Appendix "A"

Land in the Township of Waterford, Oakland County, Michigan, more particularly described as:

Lot 2, excepting the Easterly 690 ft. thereof, Lot 3, excepting the Northerly 50 ft. of the Easterly 180 ft. thereof, and all of Lot 4, Keith Acres, a replat of Lots 4 and 5 and part of Lot 10 of Supervisor's Plat No. 54 and part of E. 1/2 of SE. 1/4, Section 31, T3N, R9E. Waterford Township, Oakland County, Michigan, as recorded in Liber 77, Page 30 of Plats, Oakland County Records.

(Sidwell No. 13-31-476-070)

(Nkka 13-31-476-073 lots 2,3)
(77030 and 4)

NKA:

Ent 13-31-476-000 - Rolling Hills Coach Houses Condo.

OCCP# 509

Units 1-20

9000009

&

Rolling Hills Estates
Units 1-45

OCCP# 833

Ent. 13-31-477-000

RECORDED RIGHT OF WAY NO.

4591
18691

RETURN TO:
TERRY J. BENEDICT
THE DETROIT EDISON COMPANY
1870 ORCHARD LAKE ROAD
SYLVAN LAKE, MI 48359

000-57-01-001

RETURN TO:
TERRY L. BENEDICT
THE DETROIT EDISON COMPANY
1970 ORCHARD LAKE ROAD
SYLVAN LAKE, MI 48323

~~Return to: J. McDonald~~
~~3000 Telegraph 5264~~
~~Ann Arbor, Michigan 48106~~

LOCATION SKETCH
MAP REF. NO.

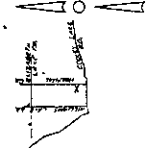

TRANSFORMER DATA

LINE NO.	SIZE	TO SERVE
720-45-2	150KVA	SEPT III
720-45-51	100KVA	SEPT III

TRANSFORMER SPEC. 17-17-66
 NO. OF TRANSFORMERS 2
 NO. OF TRANSFORMER CABLES 2
 TRANSFORMER CABLE MARKING SPEC.
 TRANSFORMER CONNECTION SPEC.

CODE
 1: 150KVA
 2: 100KVA
 3: 75KVA
 4: 50KVA
 5: 25KVA
 6: 15KVA
 7: 10KVA
 8: 5KVA
 9: 3KVA
 10: 1.5KVA

CABLE SUMMARY
 TYPE: 150KVA
 LENGTH: 1000 FT
 APPROX. 1.5 MI. BY
 PERMITS 1-11-81

TRENCH SUMMARY
 TYPE: 150KVA
 LENGTH: 1000 FT
 APPROX. 1.5 MI. BY
 PERMITS 1-11-81

GENERAL NOTES
 1. ALL WORK SHALL BE IN ACCORDANCE WITH THE CITY OF CHICAGO SPECIFICATIONS FOR TRENCHING AND BACKFILLING.
 2. THE CONTRACTOR SHALL BE RESPONSIBLE FOR OBTAINING ALL NECESSARY PERMITS FROM THE CITY OF CHICAGO.
 3. THE CONTRACTOR SHALL BE RESPONSIBLE FOR PROTECTING ALL EXISTING UTILITIES AND STRUCTURES.
 4. THE CONTRACTOR SHALL BE RESPONSIBLE FOR MAINTAINING ACCESS TO ALL ADJACENT PROPERTIES.
 5. THE CONTRACTOR SHALL BE RESPONSIBLE FOR RESTORING ALL AREAS TO ORIGINAL CONDITION OR BETTER.
 6. THE CONTRACTOR SHALL BE RESPONSIBLE FOR REMOVING ALL EXCESS MATERIAL FROM THE SITE.
 7. THE CONTRACTOR SHALL BE RESPONSIBLE FOR DISPOSING OF ALL WASTE MATERIAL IN ACCORDANCE WITH CITY ORDINANCES.
 8. THE CONTRACTOR SHALL BE RESPONSIBLE FOR MAINTAINING ALL RECORDS OF THE WORK.
 9. THE CONTRACTOR SHALL BE RESPONSIBLE FOR NOTIFYING THE CITY OF CHICAGO OF ANY CHANGES TO THE WORK.
 10. THE CONTRACTOR SHALL BE RESPONSIBLE FOR OBTAINING ALL NECESSARY INSURANCE COVERAGE.

CITY OF CHICAGO
 DEPT. OF PUBLIC WORKS
 PERMITS SECTION
 PERMIT NO. 82A64743
 START DATE: 5-2-82
 EXPIRES: 5-2-83

NORTH
ARROW

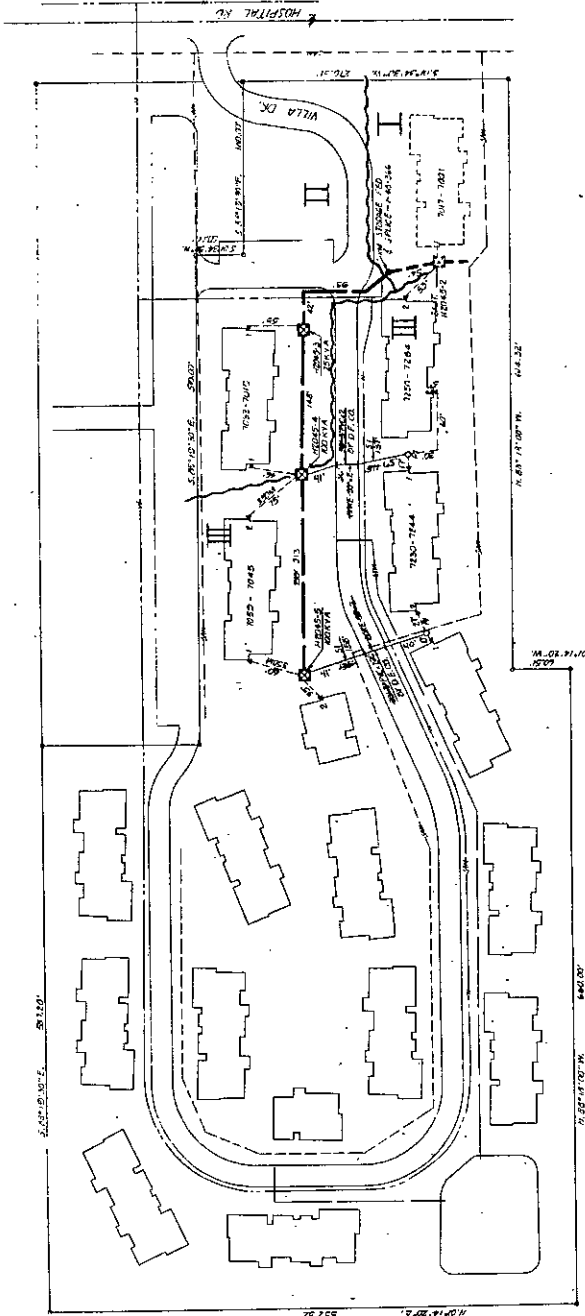

APPENDIX A

RECORDED RIGHT OF WAY NO. 45921

82A64743

NO.	DATE	DESCRIPTION	BY	CHECKED
1	5/2/82	ISSUED	J. J. [unclear]	[unclear]
2	5/2/82	REVISED	J. J. [unclear]	[unclear]
3	5/2/82	REVISED	J. J. [unclear]	[unclear]
4	5/2/82	REVISED	J. J. [unclear]	[unclear]
5	5/2/82	REVISED	J. J. [unclear]	[unclear]
6	5/2/82	REVISED	J. J. [unclear]	[unclear]
7	5/2/82	REVISED	J. J. [unclear]	[unclear]
8	5/2/82	REVISED	J. J. [unclear]	[unclear]
9	5/2/82	REVISED	J. J. [unclear]	[unclear]
10	5/2/82	REVISED	J. J. [unclear]	[unclear]
11	5/2/82	REVISED	J. J. [unclear]	[unclear]
12	5/2/82	REVISED	J. J. [unclear]	[unclear]
13	5/2/82	REVISED	J. J. [unclear]	[unclear]
14	5/2/82	REVISED	J. J. [unclear]	[unclear]
15	5/2/82	REVISED	J. J. [unclear]	[unclear]
16	5/2/82	REVISED	J. J. [unclear]	[unclear]
17	5/2/82	REVISED	J. J. [unclear]	[unclear]
18	5/2/82	REVISED	J. J. [unclear]	[unclear]
19	5/2/82	REVISED	J. J. [unclear]	[unclear]
20	5/2/82	REVISED	J. J. [unclear]	[unclear]
21	5/2/82	REVISED	J. J. [unclear]	[unclear]
22	5/2/82	REVISED	J. J. [unclear]	[unclear]
23	5/2/82	REVISED	J. J. [unclear]	[unclear]
24	5/2/82	REVISED	J. J. [unclear]	[unclear]
25	5/2/82	REVISED	J. J. [unclear]	[unclear]
26	5/2/82	REVISED	J. J. [unclear]	[unclear]
27	5/2/82	REVISED	J. J. [unclear]	[unclear]
28	5/2/82	REVISED	J. J. [unclear]	[unclear]
29	5/2/82	REVISED	J. J. [unclear]	[unclear]
30	5/2/82	REVISED	J. J. [unclear]	[unclear]
31	5/2/82	REVISED	J. J. [unclear]	[unclear]
32	5/2/82	REVISED	J. J. [unclear]	[unclear]
33	5/2/82	REVISED	J. J. [unclear]	[unclear]
34	5/2/82	REVISED	J. J. [unclear]	[unclear]
35	5/2/82	REVISED	J. J. [unclear]	[unclear]
36	5/2/82	REVISED	J. J. [unclear]	[unclear]
37	5/2/82	REVISED	J. J. [unclear]	[unclear]
38	5/2/82	REVISED	J. J. [unclear]	[unclear]
39	5/2/82	REVISED	J. J. [unclear]	[unclear]
40	5/2/82	REVISED	J. J. [unclear]	[unclear]
41	5/2/82	REVISED	J. J. [unclear]	[unclear]
42	5/2/82	REVISED	J. J. [unclear]	[unclear]
43	5/2/82	REVISED	J. J. [unclear]	[unclear]
44	5/2/82	REVISED	J. J. [unclear]	[unclear]
45	5/2/82	REVISED	J. J. [unclear]	[unclear]
46	5/2/82	REVISED	J. J. [unclear]	[unclear]
47	5/2/82	REVISED	J. J. [unclear]	[unclear]
48	5/2/82	REVISED	J. J. [unclear]	[unclear]
49	5/2/82	REVISED	J. J. [unclear]	[unclear]
50	5/2/82	REVISED	J. J. [unclear]	[unclear]
51	5/2/82	REVISED	J. J. [unclear]	[unclear]
52	5/2/82	REVISED	J. J. [unclear]	[unclear]
53	5/2/82	REVISED	J. J. [unclear]	[unclear]
54	5/2/82	REVISED	J. J. [unclear]	[unclear]
55	5/2/82	REVISED	J. J. [unclear]	[unclear]
56	5/2/82	REVISED	J. J. [unclear]	[unclear]
57	5/2/82	REVISED	J. J. [unclear]	[unclear]
58	5/2/82	REVISED	J. J. [unclear]	[unclear]
59	5/2/82	REVISED	J. J. [unclear]	[unclear]
60	5/2/82	REVISED	J. J. [unclear]	[unclear]
61	5/2/82	REVISED	J. J. [unclear]	[unclear]
62	5/2/82	REVISED	J. J. [unclear]	[unclear]
63	5/2/82	REVISED	J. J. [unclear]	[unclear]
64	5/2/82	REVISED	J. J. [unclear]	[unclear]
65	5/2/82	REVISED	J. J. [unclear]	[unclear]
66	5/2/82	REVISED	J. J. [unclear]	[unclear]
67	5/2/82	REVISED	J. J. [unclear]	[unclear]
68	5/2/82	REVISED	J. J. [unclear]	[unclear]
69	5/2/82	REVISED	J. J. [unclear]	[unclear]
70	5/2/82	REVISED	J. J. [unclear]	[unclear]
71	5/2/82	REVISED	J. J. [unclear]	[unclear]
72	5/2/82	REVISED	J. J. [unclear]	[unclear]
73	5/2/82	REVISED	J. J. [unclear]	[unclear]
74	5/2/82	REVISED	J. J. [unclear]	[unclear]
75	5/2/82	REVISED	J. J. [unclear]	[unclear]
76	5/2/82	REVISED	J. J. [unclear]	[unclear]
77	5/2/82	REVISED	J. J. [unclear]	[unclear]
78	5/2/82	REVISED	J. J. [unclear]	[unclear]
79	5/2/82	REVISED	J. J. [unclear]	[unclear]
80	5/2/82	REVISED	J. J. [unclear]	[unclear]
81	5/2/82	REVISED	J. J. [unclear]	[unclear]
82	5/2/82	REVISED	J. J. [unclear]	[unclear]
83	5/2/82	REVISED	J. J. [unclear]	[unclear]
84	5/2/82	REVISED	J. J. [unclear]	[unclear]
85	5/2/82	REVISED	J. J. [unclear]	[unclear]
86	5/2/82	REVISED	J. J. [unclear]	[unclear]
87	5/2/82	REVISED	J. J. [unclear]	[unclear]
88	5/2/82	REVISED	J. J. [unclear]	[unclear]
89	5/2/82	REVISED	J. J. [unclear]	[unclear]
90	5/2/82	REVISED	J. J. [unclear]	[unclear]
91	5/2/82	REVISED	J. J. [unclear]	[unclear]
92	5/2/82	REVISED	J. J. [unclear]	[unclear]
93	5/2/82	REVISED	J. J. [unclear]	[unclear]
94	5/2/82	REVISED	J. J. [unclear]	[unclear]
95	5/2/82	REVISED	J. J. [unclear]	[unclear]
96	5/2/82	REVISED	J. J. [unclear]	[unclear]
97	5/2/82	REVISED	J. J. [unclear]	[unclear]
98	5/2/82	REVISED	J. J. [unclear]	[unclear]
99	5/2/82	REVISED	J. J. [unclear]	[unclear]
100	5/2/82	REVISED	J. J. [unclear]	[unclear]