

UNDERGROUND EASEMENT (RIGHT OF WAY) NO. R-9305262-2A

On DEC 22, 1993, for the consideration of system betterment, Grantor grants to Grantee a permanent underground easement ("Right of Way") in, on and across a part of Grantor's Land called the "Right of Way Area".

"Grantor" is:

CREATIVE SOLUTIONS, INC., 7322 NEWMAN BLVD. DEXTER, MI 48130

"Grantee" is:

The Detroit Edison Company, a Michigan corporation, 2000 Second Avenue, Detroit, Michigan 48226

"Grantor's Land" is in ~~County~~, described as: SCIO TOWNSHIP, WASHTENAW COUNTY, DESCRIBED AS:

COM AT W 1/4 COR SEC 17, TH N 0-12-06 W 838.91 FT, TH N 89-12 E 505.25 FT TO POB TH N 89-12 E 152.16 FT, TH N 0-16-42 W 781.86 FT, TH N 89-45-08 E 682.13 FT, TH S 0-21-18 E 890.72 FT, TH S 89-59-56 W 836.80 FT, TH N 0-27 E 103.80 FT TO POB PART W 1/2 OF NW 1/4 SEC 17 T2S R5E 14.31 AC.

The "Right of Way Area" is a part of Grantor's Land and is described as:

ALL IN ACCORDANCE WITH DETROIT EDISON DRAWING R-9305262-2A WHICH IS ATTACHED HERE TO AND MADE A PART HERE OF. THE WIDTH OF RIGHT OF WAY IS TWELVE (12) FEET.

- 1. Purpose: The purpose of this Right of Way is to construct, reconstruct, modify, add to, operate and maintain underground utility line facilities consisting of poles, guys, anchors, wires, manholes, conduits, pipes, cables, transformers and accessories.
2. Access: Grantee has the right of access to and from the Right of Way Area.
3. Buildings or other Permanent Structures: No buildings or other permanent structures shall be placed in the Right of Way Area without Grantee's prior written consent.
4. Excavation: As required by Public Act 53 of 1974, MISS DIG must be called on 1-800-482-7171 before anyone excavates in the Right of Way Area.
5. Trees, Bushes, Branches, Roots, Structures and Fences: Grantee may trim, cut down, remove or otherwise control any trees, bushes, branches and roots in the Right of Way Area...
6. Restoration: If Grantee's employees, contractors, vehicles or equipment damage Grantor's Land while entering Grantor's Land for the purposes stated in this Right of Way, then Grantee shall restore Grantor's Land as nearly as can be to its original condition.
7 Successors: This Right of Way runs with the land and binds and benefits Grantor's and Grantee's successors, lessees, licensees and assigns.

Witnesses: (type or print name below signature)

Leslie J. Davidson
Leslie J. Davidson
Racquel C. Huddleston
Racquel C. Huddleston

Grantor: (type or print name below signature)
CREATIVE SOLUTIONS, INC.

William O. Pressprich, Vice President

Acknowledged before me in Washtenaw County, Michigan, on December 22, 1993 by WILLIAM O. PRESSPRICH, VICE PRESIDENT, CREATIVE SOLUTIONS, INC.

Notary's Stamp: PAMELA LAMBERT, NOTARY PUBLIC STATE OF MICHIGAN, WASHTENAW COUNTY, MY COMMISSION EXP. MAR. 21, 1998

Notary's Signature: Pamela Lambert

RECORDED RIGHT OF WAY NO. 455272

Addendum to Underground Easement (Right of Way) No. R-9305262-2A

Grantee agrees that Grantor may construct, use and maintain a permanent covered walkway approximately 60 feet by 12 feet which will cross the right of way area for a distance of approximately 12 feet. Grantee consents to the placement, use, and maintenance and repair by Grantor of the walkway. Grantor agrees to construct conduits for Grantee's underground lines under the walkway to Grantee's specifications. Grantee agrees to use its best efforts not to interfere with or damage the walkway within the right of way.

APPROVED AS TO FORM	1/7/94	DATE
LEGAL DEPARTMENT	<i>[Signature]</i>	

JAN 10 3 12 PM '94

PECCY M. HAINES
COUNTY CLERK/REGISTER

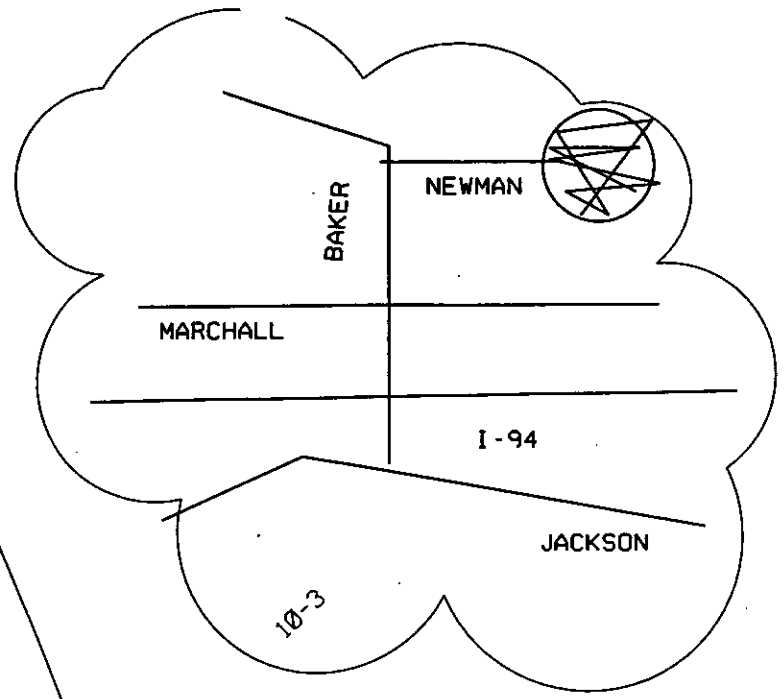

R-9305262 -1A
R/W FOR CREATIVE SOLUTION
7322 NEWMAN BLVD
SCIO TWP
313-426-5860
12' UG EASEMENT

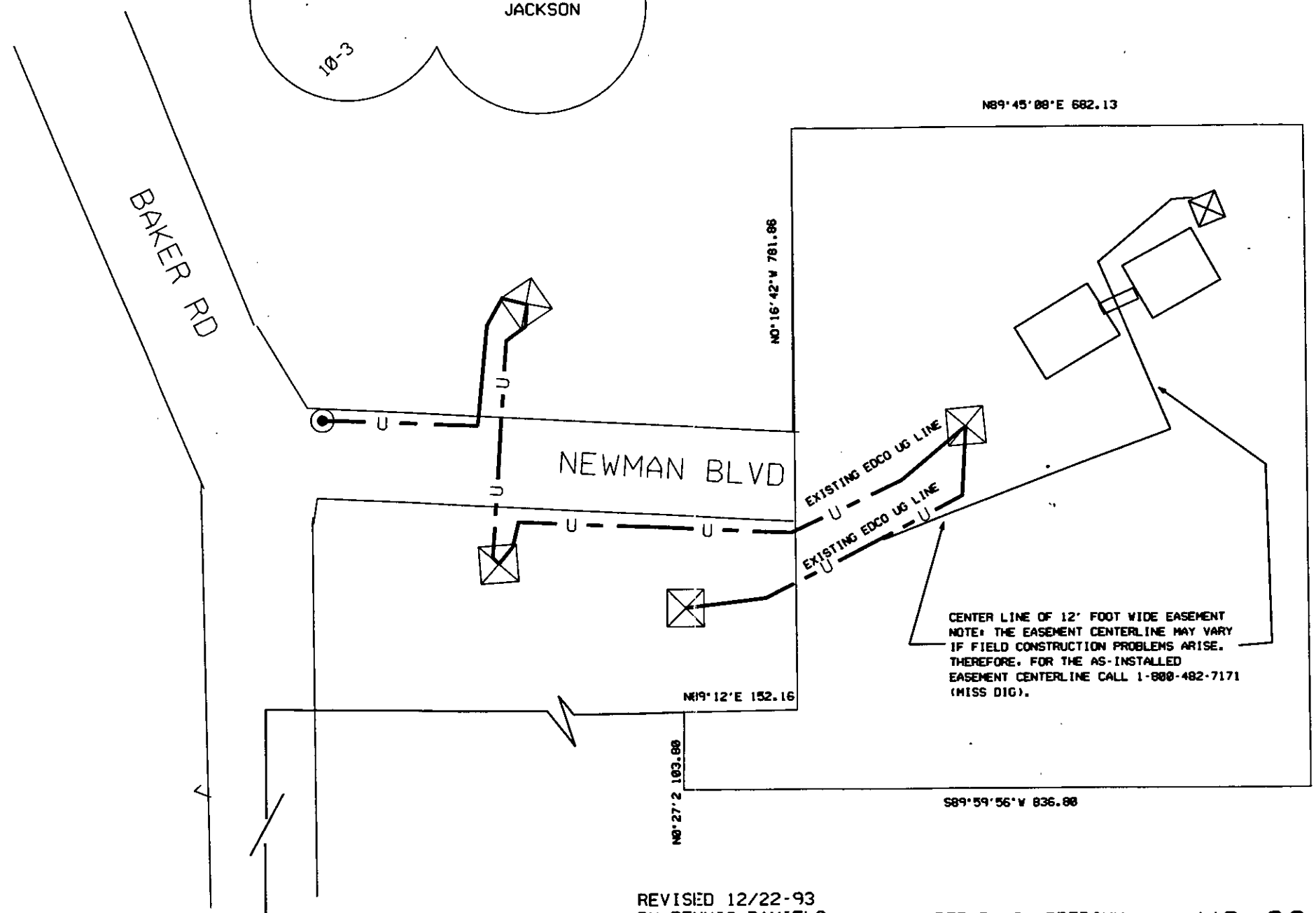

REVISED 12/22-93
BY DENNIS DANIELS

PREPARED BY S. PREDIUM
SERVICE PLANNER

NO SCALE

3

4

1/4 CORNER
SEC 17, T25, R5E,
SCIO TWP

as noted

339

13⁰⁰
2⁰⁰

SSRF 2.00
8333 0333003 6667 2:37PM 1/10/94

NUMB 317
MISC 13.00
8333 0333003 6667 2:36PM 1/10/94

PEGGY M. JAMES
COUNTY CLERK, REGISTER

JAN 10 3 12 PM '94

RECORDED
WASHINGTON COUNTY, MI

100 100