

OVERHEAD EASEMENT (RIGHT OF WAY) NO. R-9311238-01

On 10-20-93, 1993, for the consideration of system betterment, Grantor grants to Grantee a permanent overhead easement ("Right of Way") in, on and across a part of Grantor's Land called the "Right of Way Area".

"Grantor" is:

Lawrence J. Gruber and Ruth A. Gruber, Husband and Wife and Gordon C. Briggs, Jr. and Susan E. Briggs, Husband and Wife, 5555 Hillsboro, Davisburg, Michigan 48350

"Grantee" is:

The Detroit Edison Company, a Michigan corporation, 2000 Second Avenue, Detroit, Michigan 48226
Michigan Bell Telephone Company, a Michigan corporation, 444 Michigan Avenue, Detroit, Michigan 48226
North Oakland Cablevision, Inc., a Michigan corporation, 37269 Huron River Drive, New Boston, Michigan 48164

"Grantor's Land" is in Springfield Township, Oakland County, Michigan, described as:

Part of Southeast 1/4 of Section 28, T4N, R8E, beginning at point distance South 88°27'57" E 1337.64 feet and North 02°09'10" E 1919.66 feet and North 88°25'24" W 1007.24 feet from South 1/4 corner; thence North 88°25'24" W 178.50 feet; thence North 01°33'24" E 713.86 feet; thence South 88°06'53" E 178.50 feet; thence South 01°33'24" W 1212.89 feet to beginning. 2.92 acres.

Sidwell No: 07-28-403-004

0001 NOV.29.93 12:10PM
5886 MISC 7.00

The "Right of Way Area" is a part of Grantor's Land and is described as:

The East 10 feet of the South 540 feet of the Grantor's Land. The right of way is 10 feet in width.

- 1. Purpose: The purpose of this Right of Way is to construct, reconstruct, modify, add to, operate and maintain overhead utility line facilities consisting of poles, guys, anchors, wires, cables, transformers and accessories.
2. Access: Grantee has the right of access to and from the Right of Way Area.
3. Building or other Permanent Structures: No buildings or other permanent structures shall be placed in the Right of Way Area without Grantee's prior written consent.
4. Trees, Bushes, Branches or Roots: Grantee may trim, cut down, remove or otherwise control any trees, bushes, branches or roots in the Right of Way Area (or that could grow into the Right of Way Area) that Grantee believes could interfere with the safe and reliable construction, operation and maintenance of Grantee's facilities.
5. Restoration: If Grantee's employees, contractors, vehicles or equipment damage Grantor's Land while entering Grantor's Land for the purposes stated in this Right of Way, then Grantee shall restore Grantor's Land as nearly as can be to its original condition.
6. Successors: This Right of Way runs with the land and binds and benefits Grantor's and Grantee's successors, lessees, licensees and assigns.

Witnesses:(type or print name below signature)

Grantor:(type or print name below signature)

Mary E. Johnston
MARY E. JOHNSTON

Lawrence J. Gruber

Mary E. Johnston
MARY E. JOHNSTON

Ruth A. Gruber

Brian Gruber
BRIAN GRUBER

Gordon C. Briggs, Jr.

Brian Gruber
BRIAN GRUBER

Susan E. Briggs

Acknowledged before me in Oakland County, Michigan, on October 20, 1993 by Lawrence J. Gruber and Ruth A. Gruber, Husband and Wife and Gordon C. Briggs, Jr. and Susan E. Briggs, Husband and Wife.

Notary's Stamp July 17, 1995 Notary's Signature Elizabeth J. Balch

Prepared by and returned to: John C. Greenlee, 1970 Orchard Lake Road, Sylvan Lake, Michigan 48320/kjk.

Ret-over

O.K. - J.S.

RECORDED RIGHT OF WAY NO. 452170

**RETURN TO:
TERRY L. BENEDICT
THE DETROIT EDISON COMPANY
1970 ORCHARD LAKE ROAD
SYLVAN LAKE, MI 48323**

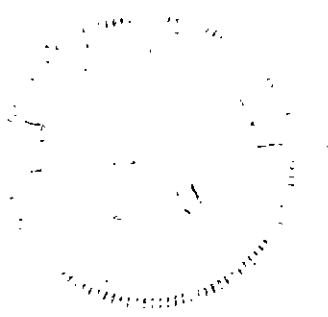

NW COR
W 1/2 SE. 1/4
SEC 28

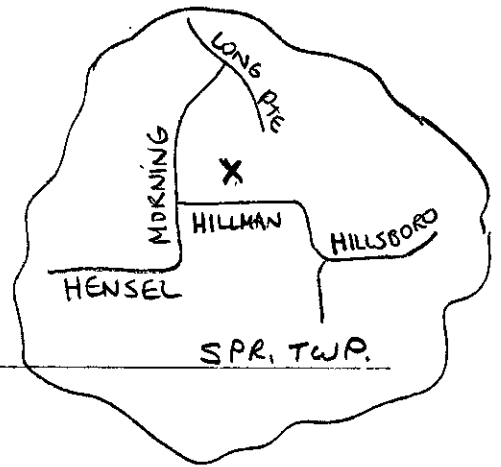

MORNING DR

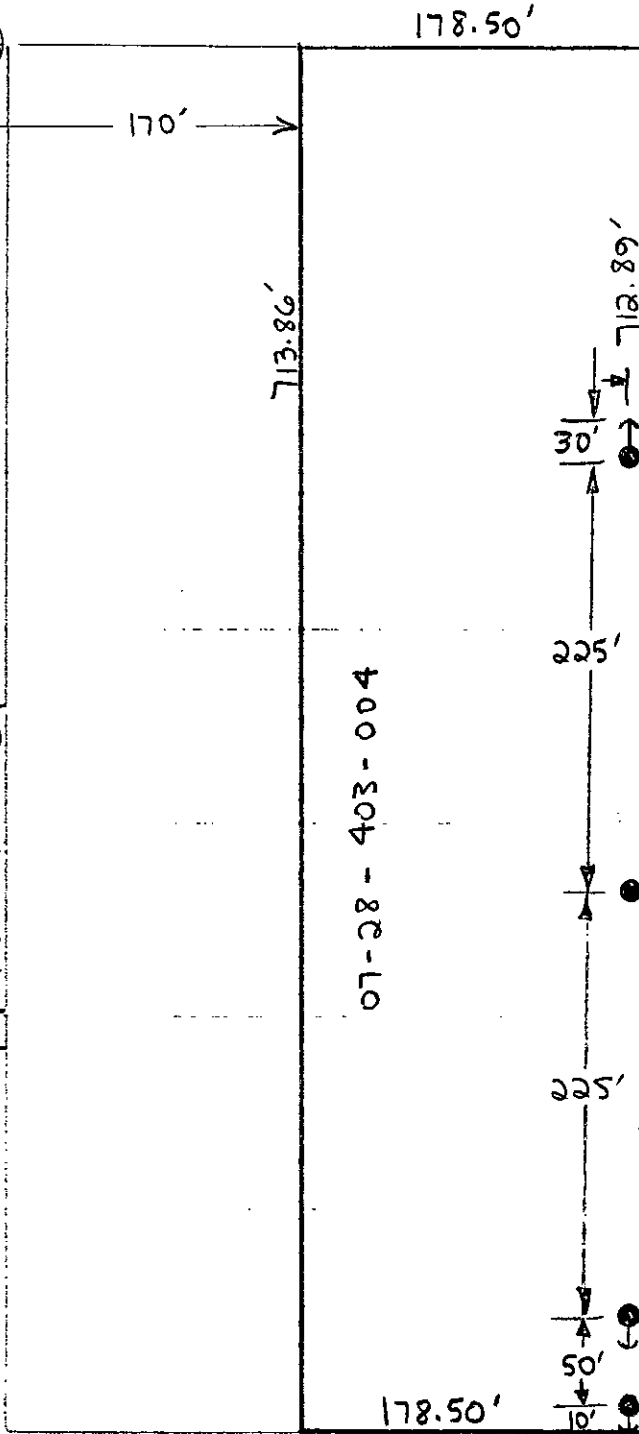

PLEASE OBTAIN A
RECORDED R/W FOR
AN OVERHEAD LINE
EXTENSION TO
SERVE 11420 HILLMAN
R/W # 9311238-01

NOTE:
EXTENSION TO BE OF
ARMLESS CONSTRUCTION.

R/W SECURED
John Swank

RECORDED RIGHT OF WAY NO. 452470

HILLMAN DR.

SYMBOLS

- = NEW POLE
- ← = GUY & ANCHOR