

**UNDERGROUND EASEMENT (RIGHT OF WAY) NO. R-9302443-10**

On Sept 28, 1993, for the consideration of system betterment, Grantor grants to Grantee a permanent underground easement ("Right of Way") in, on and across a part of Grantor's Land called the "Right of Way Area".

**"Grantor" is:**

Alan King and Paula King, Husband and Wife, 670 Grampian Court, Lake Orion, Michigan 48362

**"Grantee" is:**

The Detroit Edison Company, a Michigan corporation, 2000 Second Avenue, Detroit, Michigan 48226  
Michigan Bell Telephone Company, a Michigan corporation, 444 Michigan Avenue, Detroit, Michigan 48226  
United Artist of Oakland County, Inc., a Michigan corporation, 4500 Delemere, Royal Oak, Michigan 48073

**"Grantor's Land" is in Orion Township, Oakland County, Michigan, described as:**

Part of the East 1/2 of the Northwest 1/4 of Section 12, T4N, R10E, as recorded in Liber 25, page 21 of Plats, Oakland County Records, Wm Winter's Sub, part of Lot 3, beginning at Southwest Lot Corner; thence North 40°22'00" W 346.19 feet; thence North 60°54'00" E 255.49 feet; thence North 40°19'51" W 352.92 feet; thence North 61°00'00" E 61.19 feet; thence South 40°19'51" E 414.01 feet; thence South 60°54'00" W 211.15 feet; thence South 40°22'00" E 285 feet; thence South 60°54'00" W 105.48 feet to beginning. Sidwell No: 09-12-178-014

**The "Right of Way Area" is a part of Grantor's Land and is described as:**

As shown on the attached D.E. Company Drawing No: R-9302443-10, dated June 3, 1993. The Right of Way is ten feet in width.

- Purpose:** The purpose of this Right of Way is to construct, reconstruct, modify, add to, operate and maintain underground utility line facilities consisting of poles, guys, anchors, wires, manholes, conduits, pipes, cables, transformers and accessories.
- Access:** Grantee has the right of access to and from the Right of Way Area.
- Buildings or other Permanent Structures:** No buildings or other permanent structures shall be placed in the Right of Way Area without Grantee's prior written consent.
- Excavation:** As required by Public Act 53 of 1974, MISS DIG must be called on 1-800-482-7171 before anyone excavates in the Right of Way Area.
- Trees, Bushes, Branches, Roots, Structures and Fences:** Grantee may trim, cut down, remove or otherwise control any trees, bushes, branches and roots in the Right of Way Area (or that could grow into the Right of Way Area) and remove structures and fences in the Right of Way Area that Grantee believes could interfere with the safe and reliable construction, operation and maintenance of Grantee's facilities. No trees, plant life, structures and fences shall be planted, grown or installed within 8 feet of the front door and within 2 feet of the other sides of transformers and switching cabinet enclosures. Grantee shall not be responsible to Grantor for damages to or removal of trees, plant life, structures and fences placed in front of transformer doors.
- Restoration:** If Grantee's employees, contractors, vehicles or equipment damage Grantor's Land while entering Grantor's Land for the purposes stated in this Right of Way, then Grantee shall restore Grantor's Land as nearly as can be to its original condition.
- Successors:** This Right of Way runs with the land and binds and benefits Grantor's and Grantee's successors, lessees, licensees and assigns.

B#92 REG/DEEDS PAID  
0001 NOV.29'93 12:11PM  
5886 MISC 9.00

B#92 REG/DEEDS PAID  
0001 NOV.29'93 12:11PM  
5886 MISC 2.00

**Witnesses:**(type or print name below signature)

**Grantor:**(type or print name below signature)

Janet M Furwa  
JANET M FURWA  
Philip H O'Brien  
PHILIP H. O'BRIEN

Alan King  
Alan King  
Paula King  
Paula King

9.00  
2.00 RMC

Acknowledged before me in Oakland County, Michigan, on Sept 28, 1993 by Alan King and Paula King, Husband and Wife. ACTING IN OAKLAND COUNTY

Notary's Stamp PHILIP H. O'BRIEN  
GENESSEE COUNTY, MICHIGAN  
Notary's Signature Philip H O'Brien  
(Notary's name, county and date commission expires) MY COMMISSION EXPIRES OCTOBER 31, 1993

Prepared by and Return to: Terry L. Benedict, 1970 Orchard Lake Road, Sylvan Lake, Michigan 48320/kjk.

Ret-over

RECORDED RIGHT OF WAY NO. 45-452

00000 03

000 00000 0000



0000 00000 0000  
0000 00000 0000  
0000 00000 0000

0000 00000 0000  
0000 00000 0000  
0000 00000 0000

**RETURN TO:**  
**TERRY L. BENEDICT**  
**THE DETROIT EDISON COMPANY**  
**1670 ORCHARD LAKE ROAD**  
**SYLVAN LAKE, MI 48320**

APPROVED AS TO FORM 10/6/93 DATE  
LEGAL DEPARTMENT [Signature]

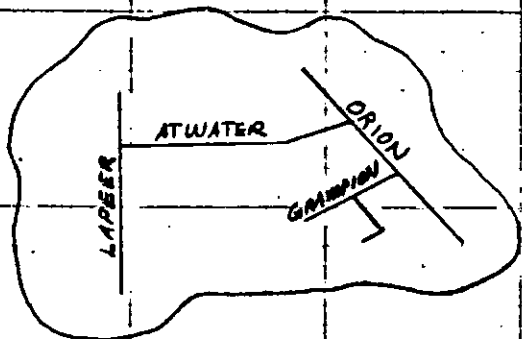

16.1 FT. PRIVATE EASEMENT  
FOR PUBLIC UTILITIES  
SECURE 10 FT. R.O.W.  
FOR BORING UNDER  
PRIVATE ROAD.

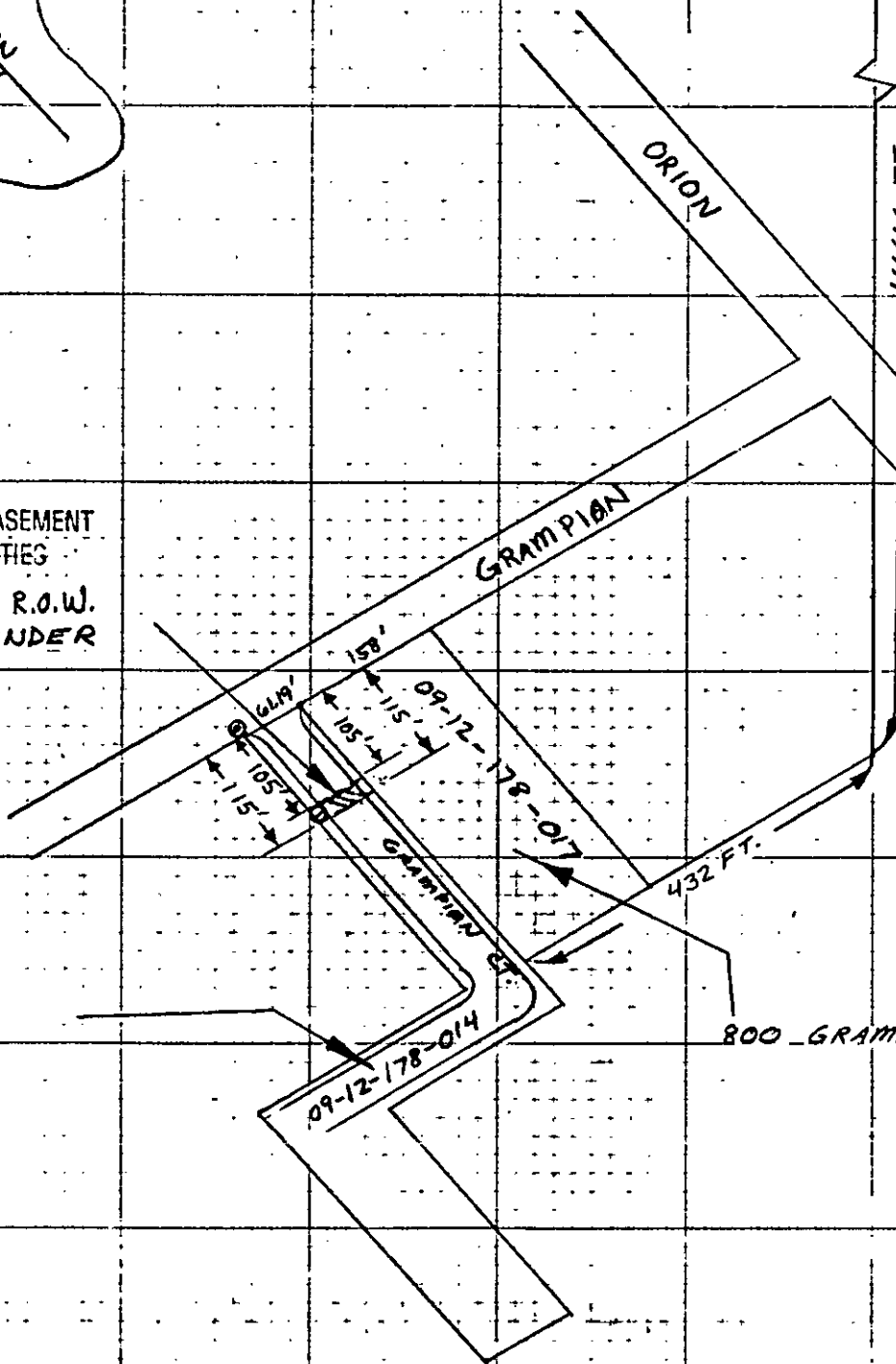

ALAN KING

800 GRAMPAN

RECORDED  
CITY OF HAY RD.

45763

LEGEND	
	FOREIGN POLE
	EXIST D.E. CO. POLE
	PROPOSED POLE
	EXIST ANCHOR
	PROPOSED ANCHOR
	TREE
	120/240 VOLT LINE
	4800 VOLT LINE
	13,200 VOLT LINE
	40,000 VOLT LINE

THE DETROIT EDISON COMPANY-SERVICE PLANNING DEPARTMENT			
CITY OR TOWNSHIP <b>LAKE ORION</b>	COUNTY <b>OAKLAND</b>	QTR. & TWP. SECT. NO. <b>E 1/2 N.W. 1/4 S. 12</b>	DEPT. ORDER NO.
MAP SECT. <b>1-295-466</b>	TOWN RANGE <b>T. 4 N. R. 10 E.</b>	JOINT R/W REQUIRED YES <input checked="" type="checkbox"/> NO <input type="checkbox"/>	R/W NO. <b>R-9302443-10</b>
PROJECT NAME <b>VIRGINIA TONEY - LAKE ORION</b>	TEL ENGR & DIST.	PROJ. OR PART NO.	
CIRCUIT <b>D.C. 301 ORION</b>	REASON <b>R.O.W. FOR U.G. NEW SERVICE - 800 GRAMPAN</b>		O.F.W. S.O. OR P.E. NO.
PLANNER <b>J. HAMMOND</b>	SCALE <b>1"=200'</b>	DATE <b>6-3-93</b>	

**RETURN TO:**  
**TERRY L. BENEDICT**  
**THE DETROIT EDISON COMPANY**  
**1970 ORCHARD LAKE ROAD**  
**SYLVAN LAKE, MI 48320**