

OVERHEAD EASEMENT (RIGHT OF WAY) NO. R-9302466-1A

On Aug. 17, 1993, for the consideration of system betterment, Grantor grants to Grantee a permanent overhead easement ("Right of Way") in, on and across a part of Grantor's Land called the "Right of Way Area".

"Grantor" is:

Oscar C. Henes, a single man, 7941 Bethel Church Road, Saline, Michigan 48176

"Grantee" is:

The Detroit Edison Company, a Michigan corporation, 2000 Second Avenue, Detroit, Michigan 48226

"Grantor's Land" is in Lodi Township, Washtenaw County, described as:

The S 6 ft of the E 450 ft of the following described land: The N 25 acres of the E 1/2 of the SE 1/4 of Sec. 2, T3S, R5E.

The "Right of Way Area" is a part of Grantor's Land and is described as:

In an easterly and westerly direction along the south property line for a distance of approximately 450' as shown on the attached drawing R-9302466-1A, revision dated 7-29-93. Upon installation of said line facilities, the width of the right of way granted herein shall be limited to six (6) feet, the centerline of which shall be the line as installed and in addition a strip of land five (5) feet wide for guy wires and anchors installed. The width of the right of way is six (6) feet.

- 1. Purpose** The purpose of this Right of Way is to construct, reconstruct, modify, add to, operate and maintain overhead utility line facilities consisting of poles, guys, anchors, wires, cables, transformers and accessories.
- 2. Access** Grantee has the right of access to and from the Right of Way Area.
- 3. Buildings or other Permanent Structures** No buildings or other permanent structures shall be placed in the Right of Way Area without Grantee's prior written consent.
- 4. Trees, Bushes, Branches or Roots** Grantee may trim, cut down, remove or otherwise control any trees, bushes, branches or roots in the Right of Way Area (or that could grow into the Right of Way Area) that Grantee believes could interfere with the safe and reliable construction, operation and maintenance of Grantee's facilities.
- 5. Restoration** If Grantee's employees, contractors, vehicles or equipment damage Grantor's Land while entering Grantor's Land for the purposes stated in this Right of Way, then Grantee shall restore Grantor's Land as nearly as can be to its original condition.
- 6. Successors** This Right of Way runs with the land and binds and benefits Grantor's and Grantee's successors, lessees, licensees and assigns.

Witnesses: (type or print name below signature)

Grantor: (type or print name below signature)

Steve Finch  
 STEVE FINCH

Curtis G. Nokes  
 CURTIS G. NOKES

Oscar C. Henes  
 Oscar C. Henes, a single man

Acknowledged before me in WASHTENAW County, Michigan, on AUGUST 17, 1993 by Oscar C. Henes, a single man.

Notary's Stamp: GERALD S. MISIAK  
 Notary Public, Wayne County, MI  
 My Commission Expires Jan. 23, 1996  
 ACTING IN WASHTENAW COUNTY

Notary's Signature: Gerald S. Misiak

See A180: MISC. RIGHT OF WAY FILE NO. 255171

RECORDED RIGHT OF WAY NO. 45778

**RETURN TO:**

~~GERALD S. MISIAK~~  
THE DETROIT EDISON COMPANY  
425 S. MAIN STREET, ROOM 900  
ANN. ARBOR, MI 48106

APPROVED AS TO FORM 9/14/93 DATE  
LEGAL DEPARTMENT \_\_\_\_\_

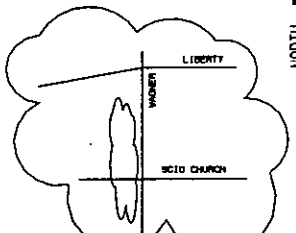
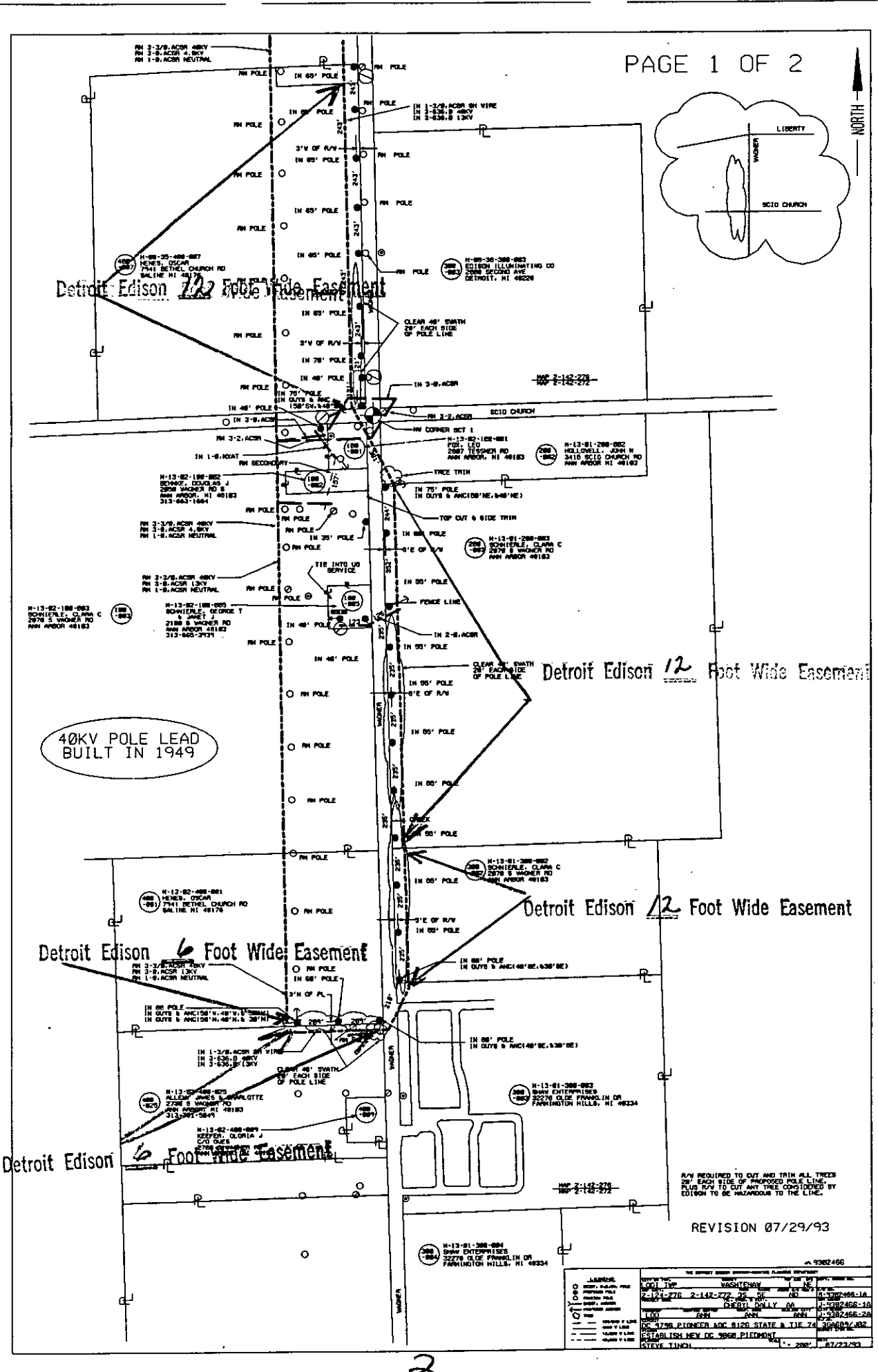

See Also:  
 M. SC. RIGHT OF WAY FILE NO. 255171

RECORDED RIGHT OF WAY NO. 45178

R/W REQUIRED TO CUT AND TRIM ALL TREES 20' EACH SIDE OF PROPOSED POLE LINE. PLUS R/W TO CUT ANY TREE CONSIDERED BY EDISON TO BE HAZARDOUS TO THE LINE.

REVISION 07/29/93

LEGEND	
---	100' TYP. VASHLEY
---	2-12-278 2-142-772 25' NE
---	DEPT. POLY. CO.
---	100' TYP. R/W
---	3750 PIONEER AND 8120 STATE & TIE 74
---	ESTABLISH NEW CG. 3000 PIONEER
---	STEVE TINCAL

2

007-0029

Vertical text or markings along the right edge of the page, possibly a scanning artifact or a page number.

**RETURN TO:**

**FERALD'S MISIAK**  
**THE DETROIT EDISON COMPANY**  
**425 S. MAIN STREET, ROOM 332**  
**ANN ARBOR, MI 48104**

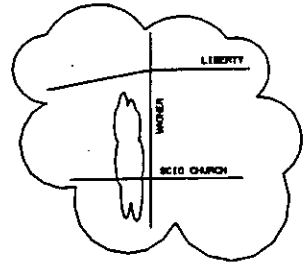

NORTH

2-142-278  
2-142-278

RECORDED  
WASHTENAW COUNTY, MI  
NOV 17 12 07 PM '93  
PEGGY M. HAINES  
COUNTY CLERK/REGISTER

RECORDED RIGHT OF WAY NO.

45178

40KV POLE LEAD  
BUILT IN 1949

Detroit Edison 12 Foot Wide Easement

Detroit Edison 12 Foot Wide Easement

Detroit Edison 12 Foot Wide Easement

Detroit Edison 12 Foot Wide Easement  
SEE PAGE 1 OF 2

R/W REQUIRED TO CUT AND TRIM ALL TREES  
20' EACH SIDE OF PROPOSED POLE LINE.  
PLUS 5' TO CUT ANY TREE CONSIDERED BY  
EDISON TO BE HAZARDOUS TO THE LINE.

REVISION 07/29/93

9302466

NO.	DATE	DESCRIPTION
1	07/29/93	ESTABLISH NEW CIRCUIT
2	07/29/93	STEVE TINEH

RECORDED  
WASHTENAW COUNTY MI

Nov 17 12 07 PM '93

PEGGY M. HAINES  
COUNTY CLERK/REGISTER

*1100*  
*1100*

*1471*  
*As Made*

DEED 11.00  
8333 0333003 3949 12:02PM 11/17/93

SSRF 2.00  
8333 0333003 3949 12:02PM 11/17/93

RETURN TO:

~~GERALD S. MISIAN~~  
GERALD S. MISIAN  
THE DETROIT EDISON COMPANY  
425 S. MAIN STREET, ROOM 332  
ANN ARBOR, MI 48104