

**DETROIT EDISON
CORPORATE REAL ESTATE SERVICES**

AT TIME OF SCANNING, RIGHT OF WAY DOCUMENT(S) WERE NOT AVAILABLE

MISC. RIGHT OF WAY FILE NO. R44363

ATTACHMENT
"A"
LI26113PA941

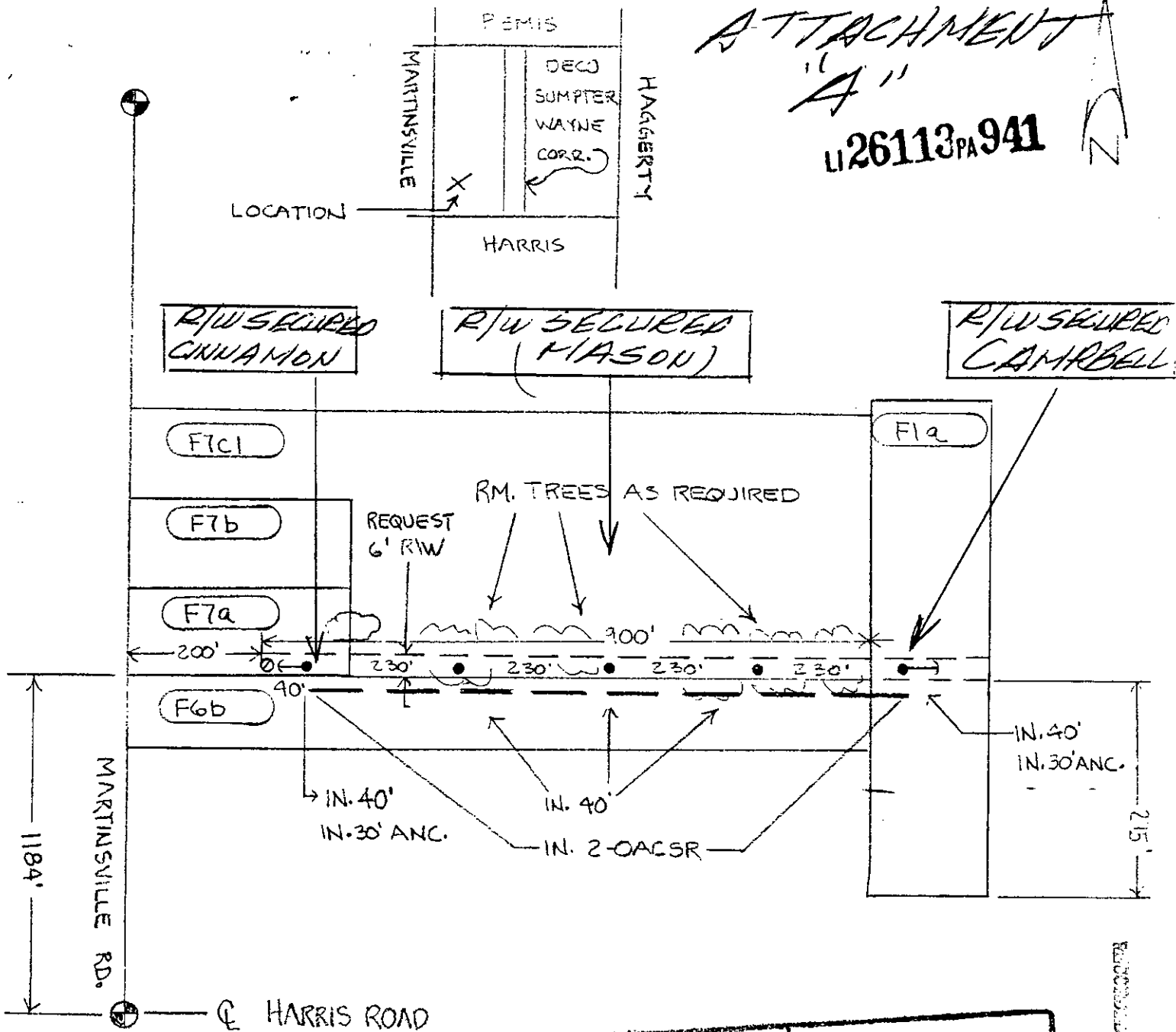

REPORT OF PROPERTIES AND RIGHTS OF WAY DEPARTMENT R/W SECURED AS INDICATED ON THIS SKETCH

BY [Signature]

DATE 9-15-92

DATE WANTED _____

DISTRICT FIELDMAN _____

PERMITS TO:
 RECORD CENTER [initials]
 R/W FILES [initials]
 MBT [initials]
 ORIGINATOR [initials]
 TOTAL [initials]

LEGEND

○	FOREIGN POLE
○	EXIST D.E. CO. POLE
●	PROPOSED POLE
— —	EXIST ANCHOR
— —	PROPOSED ANCHOR
○	TREE
---	120/240 VOLT LINE
---	4800 VOLT LINE
---	13,200 VOLT LINE
---	40,000 VOLT LINE

THE DETROIT EDISON COMPANY-SERVICE PLANNING DEPARTMENT

CITY OR TOWNSHIP <u>SUMPTER</u>	COUNTY <u>WAYNE</u>	QTR. & TWP. SECT. NO. <u>NW SUMPTER 2</u>	DEPT. ORDER NO.
MAP SECT. <u>2-232-244</u>	TOWN <u>45</u>	RANGE <u>9E</u>	JOINT R/W REQUIRED YES <input checked="" type="checkbox"/> NO <input type="checkbox"/>
PROJECT NAME <u>3105 DAYTN</u>	TEL ENGR & DIST.	PROJ. OR PART NO.	O.F.W. S.O. OR P.E. NO.
CIRCUIT <u>3105 DAYTN</u>	REASON <u>NEW RESIDENCE - 4270 HARRIS</u>	BUDGET ITEM NO. <u>IMM JA - MAM</u>	DATE <u>9-15-92</u>
PLANNER <u>M. R. ASKEN</u>	SCALE <u>NONE</u>		

44369

10/29/92 36204 REMO FEE 2.00
10/29/92 36204 DEED 14.00

10/29/92