

**UNDERGROUND DISTRIBUTION EASEMENT (RIGHT OF WAY) NO. OE 91-14T
PROJECT NAME - WEXFORD TOWNHOMES CONDO**

On June 19, 1992, for the consideration of system betterment, Grantor grants to Grantee a permanent underground distribution easement ("Right of Way") in, on and across a part of Grantor's Land called the "Right of Way Area".

"Grantor" is:

Singh of Wexford Limited Partnership, a Michigan limited partnership, By: Its General Partner, Singh General Corporation, a Michigan corporation, 219 Elm Street, Birmingham, Michigan 48009

B#92 REG/DEEDS PAID
0001 MAR.12'93 01:53PM
0182 MISC 13.00

"Grantee" is:

The Detroit Edison Company, a Michigan corporation, 2000 Second Avenue, Detroit, Michigan 48226
Michigan Bell Telephone, a Michigan corporation, 444 Michigan Avenue, Detroit, Michigan 48226
Consumers Power Company, a Michigan corporation, 4600 Coolidge Hwy, Royal Oak, Michigan 48073

A#36 REG/DEEDS PAID
0001 MAR.12'93 01:29PM
0170 RMT FEE 2.00

"Grantor's Land" is in City of Novi, Oakland County, described as:

See Attached Appendix "A"

The "Right of Way Area" is a part of Grantor's Land and is described as:

The exact location of said easements shall be shown on a drawing to be recorded 90 days after construction. The right of way is ten (10) feet in width.

- Purpose:** The purpose of this Right of Way is to construct, reconstruct, modify, add to, operate and maintain utility line facilities consisting of poles, guys, anchors, wires, manholes, conduits, pipes, cables, transformers and accessories.
- Access:** Grantee has the right of access to and from the Right of Way Area.
- Buildings or other Permanent Structures:** No buildings or other permanent structures shall be placed in the Right of Way Area without Grantee's prior written consent.
- Excavation:** As required by Public Act 53 of 1974, MISS DIG must be called on 1-800-482-7171 before anyone excavates in the Right of Way Area.
- Trees, Bushes, Branches, Roots, Structures and Fences:** Grantee may trim, cut down, remove or otherwise control any trees, bushes, branches and roots in the Right of Way Area (or that could grow into the Right of Way Area) and remove structures and fences in the Right of Way Area that Grantee believes could interfere with the safe and reliable construction, operation and maintenance of Grantee's facilities. No trees, plant life, structures and fences shall be planted, grown or installed within 3 feet of the front door and within 2 feet of the other sides of transformers and switching cabinet enclosures. Grantee shall not be responsible to Grantor for damages to or removal of trees, plant life, structures and fences placed in front of transformer doors.
- Ground Elevation:** Grantor must grade the Right of Way Area to within four inches of final grade before Grantee installs its facilities. Grantor must maintain this ground elevation after Grantee installs its facilities.
- Damages:** If Grantor, its agents, employees or contractors, damage Grantee's facilities, Grantee shall make repairs at Grantor's expense.
- Successors:** This Right of Way runs with the land and binds and benefits Grantor's and Grantee's successors, lessees, licensees and assigns.

B#92 REG/DEEDS PAID
0001 JUL.16'92 12:40PM
6215 MISC 9.00

B#92 REG/DEEDS PAID
0001 JUL.16'92 12:40PM
6215 RMT FEE 2.00

Prepared by and Return to: Omer V. Racine, 30400 Telegraph Road, Room 277, Bingham Farms, Michigan 48025

~~OK - G.K.~~
~~OK - G.K.~~

RECORDED RIGHT OF WAY NO. 4433000

13.00
2.00 RMT

9.00
2.00 RMT

This easement is re-recorded for purposes of showing the planned "as installed" centerlines of easements granted as shown on drawing attached hereto.

008

021M 0510



RETURN TO
J. D. McDONALD
THE DETROIT EDISON COMPANY
26400 TELEGRAPH ROAD, SUITE 277
BIRMINGHAM, MICHIGAN 48025

RW#: OE 91-14T

Witnesses:(type or print name below signature)

Grantor:(type or print name below signature)
SINGH OF WEXFORD LIMITED PARTNERSHIP,
a Michigan Limited Partnership
by its: General Partner, SINGH GENERAL
CORPORATION, a Michigan corporation

G. Michael Kahm

Lushman S. Grewal

G. Michael Kahm

Lushman S. Grewal, Vice President

Sharon L. Rochon

Sharon L. Rochon

Acknowledged before me in Oakland County, Michigan on 6-19, 1992, by Lushman S. Grewal, V.P. of SINGH GENERAL CORPORATION, a general partner of SINGH OF WEXFORD LIMITED PARTNERSHIP, a Michigan limited partnership, for the limited partnership.

Notary's Stamp SHARON L. EAHROW
Notary Public, Oakland County, MI
My Commission Expires Sept. 5, 1993

Notary's Signature *Sharon L. Rochon-Eahrow*

APPENDIX "A"

A part of the SE ¼ of Section 2, T1N, R8E, City of Novi, Oakland County, Michigan; more particularly described as commencing at the S ¼ corner of said Section 2; th S 89°32'34" E, 86.00 ft. along the South line of said Section 2 and the centerline of Thirteen Mile Road, to the East right-of-way of Decker Road, and the point of beginning (previously described as S 89°32'50" E); th N 00°54'00" E, 2650.19 ft., along the East right-of-way of said Decker Road, to the E and W ¼ line of said Section 2 (previously described as 2650.23 ft.); th S 89°33'03" E, 578.76 ft., along the E and W ¼ line of said Section 2 (previously described as S 89°33'08" E); th S 00°49'30" W, 2650.25 ft., to the South line of said Section 2 and the centerline of said Thirteen Mile Road (previously described as S 00°49'29" W); th N 89°32'34" W, 582.23 ft. along the South line of said Section 2 and the centerline of said Thirteen Mile Road, to the point of beginning (previously described as N 89°32'50" W, 582.24 ft.). All of the above containing 35.317 Acres. All of the above being subject to the rights of the public in Thirteen Mile Road. All of the above being subject to easements, restrictions and right-of-ways of record. Sidwell No. 22-02-400-010.

RECORDED RIGHT OF WAY NO. 44320

RETURN TO
J. D. McDONALD
THE DETROIT EDISON COMPANY
30450 TELEGRAPH ROAD, SUITE 277
BIRMINGHAM, MICHIGAN 48025

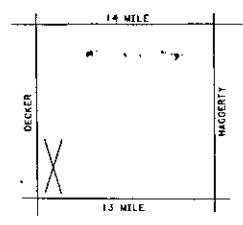

S 00° 49' 29" W 2650.25'

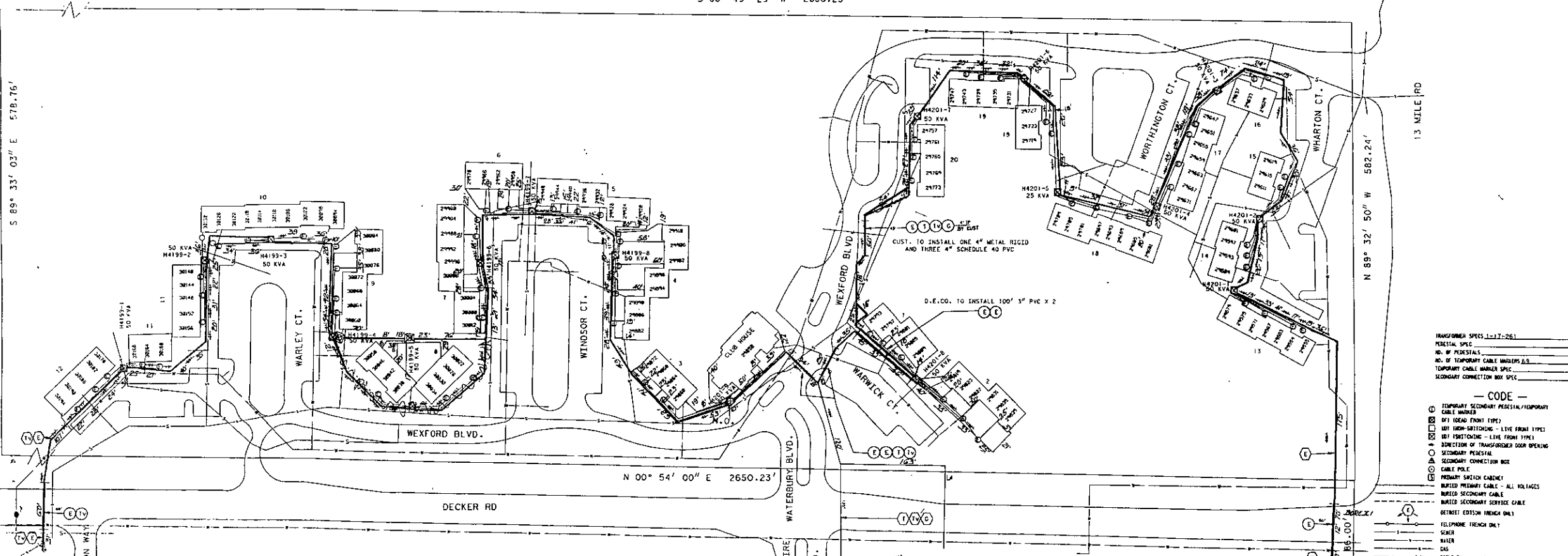

TRANSFORMER SPEC 1-17-261
PEDESTAL SPEC
NO. OF PEDESTALS
NO. OF TEMPORARY CABLE MARKERS E.S.
TEMPORARY CABLE MARKER SPEC.
SECONDARY CONNECTION BOX SPEC.

- CODE —
- TEMPORARY SECONDARY PEDESTAL/TEMPORARY CABLE MARKER
 - 9FT (HEAD FROM TYPE)
 - 10FT (SHORT SWITCHING - LIVE FROM TYPE)
 - 10FT (SHORT SWITCHING - LIVE FROM TYPE)
 - DIRECTION OF TRANSFORMER DOOR OPENING
 - SECONDARY PEDESTAL
 - SECONDARY CONNECTION BOX
 - CABLE POLE
 - PRIMARY SWITCH CABINET
 - BURIED PRIMARY CABLE - ALL VOLTAGES
 - BURIED SECONDARY CABLE
 - BURIED SECONDARY SERVICE CABLE
 - DETROIT EDISON TRENCH ONLY
 - TELEPHONE TRENCH ONLY
 - SLOTTED
 - WATER
 - GAS
 - CABLE TV
 - PROPOSED CONDUIT
 - SEP COMM CABINET

TRANSFORMER DATA

U.S.T. NO.	SIZE	CR. STA. NO.
H4199-1	50 KVA	661-1182
H4199-2	50 KVA	661-1182
H4199-3	50 KVA	661-1182
H4199-4	50 KVA	661-1182
H4199-5	50 KVA	661-1182
H4199-6	50 KVA	661-1182
H4199-7	50 KVA	661-1182
H4199-8	50 KVA	661-1182
H4201-1	50 KVA	661-1182
H4201-2	50 KVA	661-1182
H4201-3	50 KVA	661-1182
H4201-4	50 KVA	661-1182
H4201-5	25 KVA	661-1181
H4201-6	50 KVA	661-1182
H4201-7	50 KVA	661-1182
H4201-8	50 KVA	661-1182
H4201-9	50 KVA	661-1182

EASEMENT LOCATIONS

Locations on lot to be utility space at time of construction. See page 10 for details.

- Buried Primary Cable
- Buried Secondary Cable
- Buried Secondary Service Cable
- Substation Trench Only
- Gas
- Proposed Conduit

CABLE SUMMARY

ITEM # 02-A-11 715-3073-4635 4188'
 ITEM # 02-B-11 715-3073-4635 2480'
 ITEM # 02-C-11 715-3073-4635 1188'

TRENCH SUMMARY

JOINT USE 1-T.V. 0' 200'
 D.E. ONLY 1-T.V. 0' 200'
 GAS ONLY 1-T.V. 0' 200'
 CTV ONLY 1-T.V. 0' 200'
 OTHER 1-T.V. 0' 200'

GENERAL NOTES

TRENCHING TO BE DONE BY D.E.CO.
 TRENCH AND CABLE LENGTHS ARE APPROXIMATE.
 SEE SECTION 34 FOR LINE CONSTRUCTION STANDARDS FOR TRANS. MAT. DETAILS.
 SEE PAGE 10-11 FOR DETAILS OF TRENCHES FOR EXTERIOR FROM DETAILS LAPS, DRIP.
 SEE SECTION 43 FOR LINE CONSTRUCTION STANDARDS FOR PLACEMENT OF CABLES,
 TRANSFORMERS AND PEDESTALS (SUM'US ONLY).
 D.E. SERVICE PLANNING J. SEQUENTIAL 6-12-81
 TEL. CO. 1-800-448-7171
 GAS 1-800-448-7171
 CTV 1-800-448-7171
 OTHER 1-800-448-7171

START DATE : 08-26-92

DESIGNED BY	CHECKED BY	APPROVED BY	DATE	JOB TITLE
<p>DESIGNED BY: J. D. BARNUM CHECKED BY: J. D. BARNUM APPROVED BY: J. D. BARNUM DATE: 12/16/92</p>				
<p>REFERENCE: O.H.D.O.-A-55513</p>				
<p>WEXFORD TOWN HOMES-CONDOS PART OF THE S.E. 1/4 OF SEC 2 1 1 N. R. 6 E. NOVI TWP. OAKLAND COUNTY 92A-63644</p>				
<p>SCALE: 1"=50' SHEET NO. 104 TOTAL SHEETS 367B4J166 SHEET NUMBER 8964 AKRON</p>				

RECORDED RIGHT OF WAY NO. 44320