

**UNDERGROUND EASEMENT (RIGHT OF WAY) NO. R-9202084-1AR**

On July 3, 1992, for the consideration of system betterment, Grantor grants to Grantee a permanent underground easement ("Right of Way") in, on and across a part of Grantor's Land called the "Right of Way Area".

**"Grantor" is:**

DONALD L. SCHAEFER and MARIE SCHAEFER, HUSBAND & WIFE, 2782 Danbury Lane, Ann Arbor, Michigan 48103

**"Grantee" is:**

The Detroit Edison Company, a Michigan corporation, 2000 Second Avenue, Detroit, Michigan 48226

**"Grantor's Land" is in Ann Arbor Township, Washtenaw County, described as:**

Lot 97, Huron River Heights No. 3, Subdivision, as recorded in Liber 18 of Plats, Pages 13 and 14, Washtenaw County Records.

**The "Right of Way Area" is a part of Grantor's Land and is described as:**

The West 12 feet of the South 30 feet. The width of Right of Way is twelve (12) feet.

1. **Purpose:** The purpose of this Right of Way is to construct, reconstruct, modify, add to, operate and maintain underground utility line facilities consisting of poles, guys, anchors, wires, manholes, conduits, pipes, cables, transformers and accessories.
2. **Access:** Grantee has the right of access to and from the Right of Way Area.
3. **Buildings or other Permanent Structures:** No buildings or other permanent structures shall be placed in the Right of Way Area without Grantee's prior written consent.
4. **Excavation:** As required by Public Act 53 of 1974, MISS DIG must be called on 1-800-482-7171 before anyone excavates in the Right of Way Area.
5. **Trees, Bushes, Branches, Roots, Structures and Fences:** Grantee may trim, cut down, remove or otherwise control any trees, bushes, branches and roots in the Right of Way Area (or that could grow into the Right of Way Area) and remove structures and fences in the Right of Way Area that Grantee believes could interfere with the safe and reliable construction, operation and maintenance of Grantee's facilities. No trees, plant life, structures and fences shall be planted, grown or installed within 8 feet of the front door and within 2 feet of the other sides of transformers and switching cabinet enclosures. Grantee shall not be responsible to Grantor for damages to or removal of trees, plant life, structures and fences placed in front of transformer doors.
6. **Restoration:** If Grantee's employees, contractors, vehicles or equipment damage Grantor's Land while entering Grantor's Land for the purposes stated in this Right of Way, then Grantee shall restore Grantor's Land as nearly as can be to its original condition.
7. **Successors:** This Right of Way runs with the land and binds and benefits Grantor's and Grantee's successors, lessees, licensees and assigns.

RECORDED RIGHT OF WAY NO. 43372

**Witnesses:** (type or print name below signature)

Matthew Paul Schaefer  
MATTHEW PAUL SCHAEFER

**Grantor:** (type or print name below signature)

Donald L. Schaefer, M.D.  
DONALD L. SCHAEFER

Sarah A. Schaefer  
Sarah A. Schaefer

Marie Schaefer  
MARIE SCHAEFER, HUSBAND & WIFE

Acknowledged before me in Washtenaw County, Michigan, on July 3, 1992 by Donald L. Schaefer and Marie Schaefer, Husband & Wife.

Notary Public, Washtenaw County, Michigan  
My Commission Expires June 11, 1994

Notary's Stamp

Notary's Signature

Debbie L. Stehle  
DEBBIE L. STEHLE

To (Supervisor, RE & R/W) <b>RICHARD LONGUISH</b>	For RE & R/W Dept. Use	Date Received	DE/Bell/C.P. No
Division <b>ANN ARBOR</b>	Date <b>6-1-92</b>	Application No. <b>R 9202084 1AR</b>	

We have included the following necessary material and information:

**Material:**

- A. Proposed Subdivision
  - 1. copy of complete final proposed plat - All pages
- or
- B. Other than proposed subdivision (condo., apts. mobile home park — other)
  - 1. Property description.
  - 2. Site plan.
  - 3. title information (deed, title commitment, contract with title commitment, or title search).

Note: Do not submit application for URD easements until all above material has been acquired.

REPORT OF REAL ESTATE AND RIGHTS OF WAY DEPARTMENT R/W SECURED AS INDICATED ON THIS SKETCH BY <u>Richard Longuish</u> DATE <u>7-30-92</u> DATE WANTED _____ DISTRICT FIELDMAN <u>Richard Longuish</u>	PERMITS TO:
	RECORD CENTER <u>2</u>
	R/W FILES <u>2</u>
	MBT <u>1</u>
	ORIGINATOR <u>2</u>
	TOTAL <u>2</u>

**Information**

1. Project Name <b>HURON RIVER HEIGHTS No. 3</b>	County <b>WASHTENAW</b>
City/Township/Village <b>ANN ARBOR</b>	Section No. <b>18</b>

Type of Development

<input checked="" type="checkbox"/> Proposed Subdivision	<input type="checkbox"/> Apartment Complex	<input type="checkbox"/> Condominium
<input checked="" type="checkbox"/> Subdivision	<input type="checkbox"/> Mobile Home Park	<input checked="" type="checkbox"/> Other

2. Name of Owner  
**RICHARD THEILE** Phone No. **995-8067**

Address  
**2712 DANBURY — ANN ARBOR, MI. 48103**

Owner's Representative  
**SELF** Phone No. **995-8067**

Date Service is Wanted  
**6-21-92**

4. Entire Project will be developed at one time .....  Yes  No

5. Joint easements required — Michigan Bell Telephone .....  Yes  No

— Consumers Power .....  Yes  No

a. Name of Other Utilities If Not Michigan Bell Telephone or Consumers Power

b. Other Utility Engineer Names Phone Numbers

Addresses

6. Additional Information or Comments  
**THIS EASEMENT REQUEST IS THE RESULT OF A DISAGREEMENT BETWEEN THE CUSTOMER & DETROIT EDISON OVER THE EXISTING O.H. LINE ON HIS PROPERTY.**

Note: Trenching letter  attached  will be submitted later

Service Planner **Jerry Smart** Signed (Service Planning Supervisor) **L. C. BAILEY**

Phone No. **185-0408** Address **JUN 02 1992**

RECORDED RIGHTS OF WAY NO. 43371 & 43372

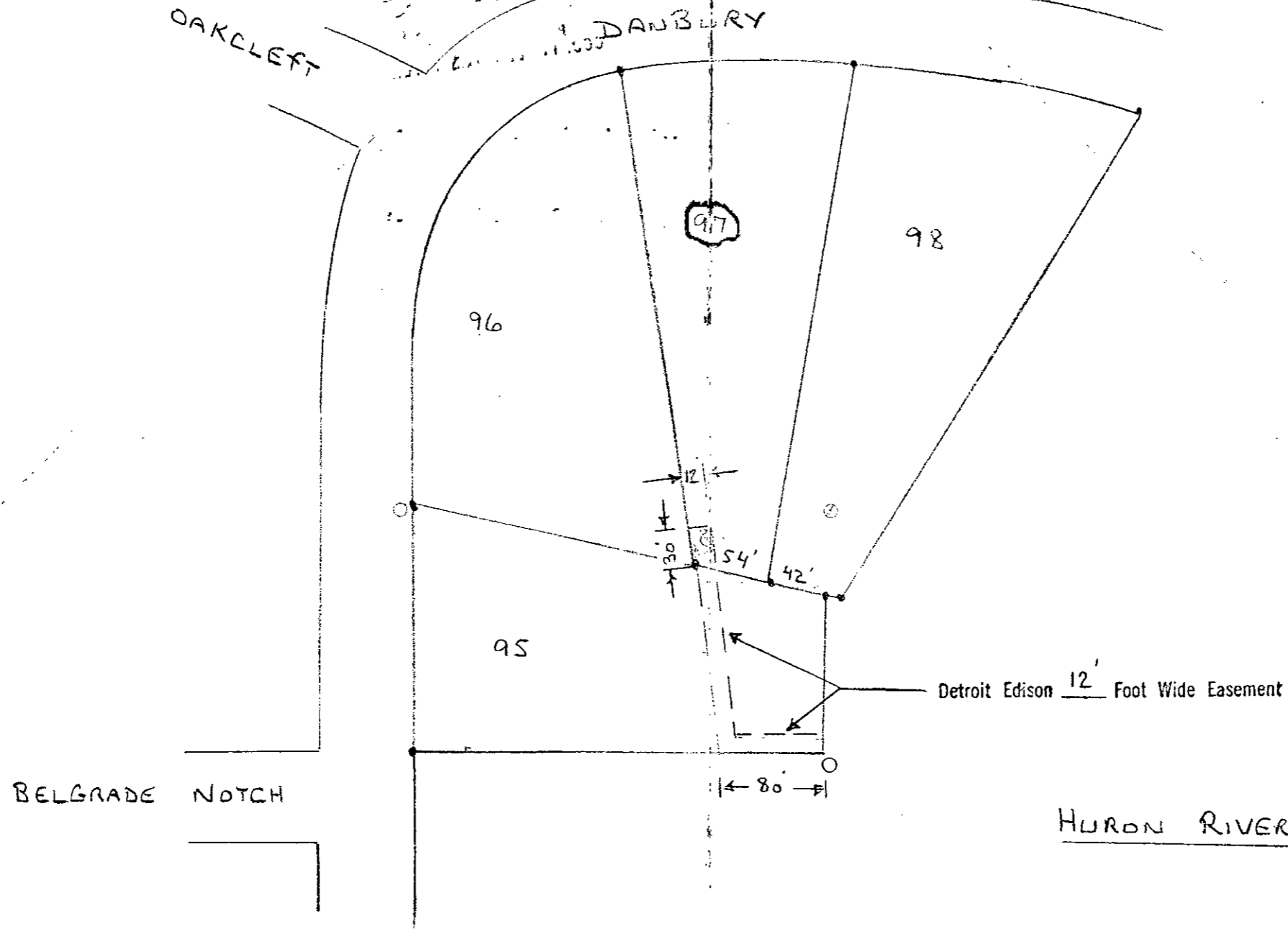

RECORDED  
 WASHENAW COUNTY MI  
 JUL 20 11 00 AM '92  
 REGISTRY/HARRIS  
 COURT CLERK/REGISTER

RECORDED RIGHT OF WAY NO. 43372

HURON RIVER HEIGHTS No. 3

LEGEND		THE DETROIT EDISON COMPANY - SERVICE PLANNING DEPARTMENT		
○	FOREIGN POLE	CITY OR TWP.	COUNTY	QTR. & TWP. SECT. NO.
○	EXIST. D.E. CO. POLE	ANN ARBOR	WASHENAW	NW 1/4-18
○	PROPOSED POLE	MAP SECT.	TOWN	RANGE
○	EXIST. ANCHOR	1-148-296	2S	6E
○	PROPOSED ANCHOR	PROJECT NAME		JOINT R/W REQUIRED
○	TREE	TEL. ENG'R. & DIST.		YES <input type="checkbox"/> NO <input checked="" type="checkbox"/>
—	120/240 V LINE	CIRCUIT	R/W NO.	
—	4800 V LINE	DC	315 HOBART	
—	13,200 V LINE	REASON	O.F.W. S.O. OR P.E. NO.	
—	40,000 V LINE	PROVIDE UNDERGROUND EASEMENT	BUDGET ITEM NO.	
		PLANNER	SCALE	DATE
		TERRY SMART		6-1-92

as directed  
69 ✓  
note plat

602  
601

SSRF 2.00  
8333 0333003 8371 10:37AM 7/20/92

DEED 11.00  
8333 0333003 8371 10:37AM 7/20/92

PEGGY H. HAINES  
COUNTY CLERK/REGISTER

JUL 20 11 00 AM '92

WASHTENAW COUNTY MI

RECORDED

WASHTENAW COUNTY MI  
CLERK'S OFFICE  
LANSING, MI 48106

1982-1983