

LIBER 126620343

077201  
139694

LONGACRE WOODS CONDO

Real Estate and Rights of Way

**Detroit Edison**

# Joint Underground Residential Distribution Right of Way Agreement

(LIBER 10917PG566)

APRIL 25, 1989

This easement is re-recorded for purposes of showing the planned "as installed" centerlines of easements granted as shown on drawing attached hereto.

For good and valuable consideration of system betterment, the undersigned hereby grant and convey to THE DETROIT EDISON COMPANY, a Michigan corporation of 2000 Second Avenue, Detroit, Michigan, MICHIGAN BELL TELEPHONE COMPANY, a Michigan corporation of 444 Michigan Avenue, Detroit, Michigan and Metrovision of Oakland County, Inc., a Michigan

corporation of 37635 Enterprise Ct., Farmington Hills, MI 48018 hereinafter referred to collectively as "GRANTEE", the right to erect, lay, maintain, reconstruct, add to and replace underground facilities consisting of wires, cables, conduits, fixtures and appurtenances including the necessary above ground equipment, connections, poles and accessories required in, under, upon, over and across the property located in the City of Farmington, County of Oakland

State of Michigan, and more particularly described on the attached Appendix "A"; with the full right to the GRANTEE of ingress and egress upon said property for the purposes of this grant, and the further right to trim, cut down or otherwise control brush and trees within the right of way herein described.

Said right of way shall be ten (10) feet in width unless otherwise indicated and the route is described as follows:

The exact location of said easements shall be shown on a drawing to be recorded 90 days after construction.

(1)

B#92 REG/DEEDS PAID  
0001 MAY.26.89 11:29AM  
9694 MISC 7.00

RECORDED RIGHT OF WAY NO. 43088

In order to provide for the proper maintenance and protection of GRANTEE, the undersigned covenant and agree that:

1. The right of way will be graded to within four inches of final grade before the GRANTEE'S lines are installed and this ground elevation must be maintained after installation of utilities to avoid the pooling of water in, on or around GRANTEE'S above ground equipment.
2. No buildings or structures other than GRANTEE'S equipment are to be placed within the right of way herein granted. No excavation is to be permitted within said right of way without approval of GRANTEE.
3. No shrubs or foliage shall be planted or grown within eight feet of the front door of transformers or switching cabinet enclosures. GRANTEE shall not be responsible to owners for damages to or removal of trees or plant life planted in front of said door or within the right of way causing an interference with GRANTEE'S maintenance of their equipment.
4. If the lines or facilities of GRANTEE are damaged by the acts of owners, their agents, employes or contractors, repairs shall be made by the granting company so damaged at the cost and expense of owners. Owners are defined as those persons owning the property at the time the damage occurred.

THIS GRANT is declared to be binding upon the heirs, successors, lessees, licensees and assigns of the parties hereto.

IN WITNESS WHEREOF, the undersigned have hereunto set their hand(s) on the date of this agreement.

Witnesses:

B#92 REG/DEEDS PAID  
0001 JUN.05.92 11:10AM  
6277 RMT FEE 2.00

See Next Page

908  
[Signature]

REC-2

Prepared by: Omer V. Racine/vkc  
The Detroit Edison Company  
30400 Telegraph Road, Suite 277  
Birmingham, MI 48010

Address:

(LIBER 109170567)

LIBER 1266 344

Witnesses:

Milo Properties, Inc.  
A Michigan Corporation  
23290 Farmington Road  
Farmington, MI 48024

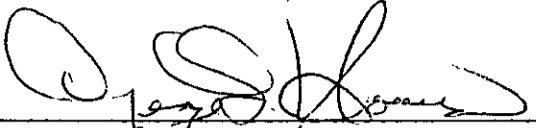
  
GEORGE L. HOWES

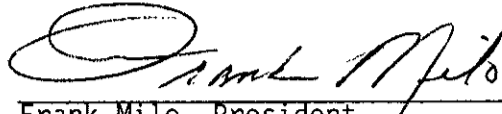
  
Frank Milo, President

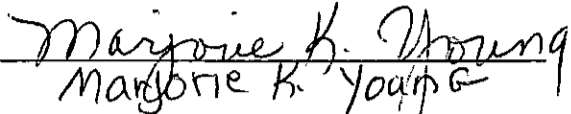
  
Marjorie K. Young

State of Michigan )  
County of Oakland ) SS:

Personally came before me this 25 day of APRIL, 1989, **Frank Milo**, President of the above named corporation, to me known to be such President of said corporation and acknowledged that he executed the foregoing instrument as such officer as the free act and deed of said corporation by its authority.

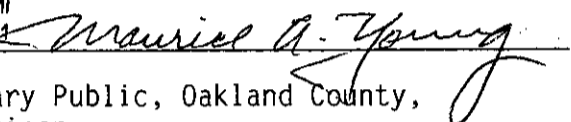
My Commission Expires: MAURICE A. YOUNG  
Notary Public, Oakland County, MI  
My Commission Expires July 2, 1991   
Notary Public, Oakland County,  
Michigan

RECORDED RIGHT OF PAY NO. 43088

Appendix "A"

A parcel of land in the West 1/2 of Section 28, T1N, R9E, situated in both the City of Farmington and the City of Farmington Hills, Oakland County, Michigan, described as beginning at a point on the south line of Woodcroft Subdivision as recorded in Liber 57, Page 17 of Plats, Oakland County Records, distance N. 89°41'40" W. 633.70 ft. from the southeast corner of said Woodcroft Subdivision and proceeding thence S. 00°28'04" W. 401.79 ft. to a point of intersection on the north line of Beechwood Estates Subdivision as recorded in Liber 143, Pages 20 through 22 of Plats, Oakland County Records, thence along said line N. 70°04'23" W. 351.89 ft. to the northwest corner of said Beechwood Estates Subdivision, thence N. 70°03'12" W. 609.07 ft., thence N. 07°58'12" E. 14.90 ft. to a point of intersection on the east and west 1/4 line of said Section 28, thence along said line S. 89°35'51" E. 217.02 ft., thence N. 00°05'57" E. 64.52 ft. to the southwest corner of lot 128 of said Woodcroft Subdivision., said point being the southwest corner of said Subdivision, thence along the west line of said lot N. 00°46'49" E. 190.09 ft. to a point of intersection on the southerly line of Arundel Drive., 60.0 ft., wide, thence along said southerly line, said line being the north line of said lot S. 89°44'16" E. 78.33 ft. to the northeast corner of said lot, thence along the east line of said lot S. 00°38'19" W. 190.15 ft. to a point on the southerly line of Woodcroft Subdivision, said point being the southeast corner of said lot, thence along said Subdivision line S. 89°41'40" E. 608.47 ft. to the point of beginning, said parcel containing 5.020 acres.

Sidwell NO. 23-28-179-001 - lot 128 of Woodcroft Sub. }  
23-28-326-009 - SW 1/4 } 57017 } Same as original  
23-28-179-011 - SW 1/4

NKA 23-28-301-007 - SW 1/4  
and Ent 23-28-326-000  
Longacre Woods  
OCEP # 658

Applicant Name <b>J. McDONALD</b>	Date <b>1-17-89</b>	Account No. <b>OE 89-2T</b>
Division <b>OAKLAND</b>	Date <b>1-9-89</b>	Account No.

We have included the following necessary material and information:

- Material:**
- A. Proposed Subdivision
1. copy of complete final proposed plat - All pages
- or
- B. Other than proposed subdivision (condo., apts. mobile home park - other)
- 1 Property description.
  - 2 Site plan.
  - 3 title information (deed, title commitment, contract with title commitment, or title search).

Note: Do not submit application for URD easements until all above material has been acquired.

**Information**

1 Project Name  
**LONGAERE WOODS CONDOMINIUMS**

City/Township/Village  
**FARMINGTON**

County  
**OAKLAND**

City/Block No.  
**28**

Type of Development

Proposed Subdivision       Apartment Complex       Condominium

Subdivision       Mobile Home Park       Other

2 Name of Owner  
**FRANK MILO**

Address  
**23290 FARMINGTON RD FARMINGTON MI 48024**

Owner's Representative  
**FRANK MILO**

Phone No.  
**471-0711**

Date Service is Wanted  
**March**

3 Name of Other Utilities If Not Michigan Bell Telephone or Consumers Power

4. Entire Project will be developed at one time  Yes  No

5. Joint easements required — Michigan Bell Telephone  Yes  No  
 -- Consumers Power  Yes  No

6 Other Utility Engineer Names  
**METROVISION - BOB HENDZELL**

Phone Numbers  
**538-1823**

Addresses  
**25000 CAPITOL AVE. REDFORD TWP. MICH 48239**

7 Additional Information or Comments  
**FUT IT USE MEMO # 9077 ISSUED 1-9-89**

CONDUIT RIGID OR MAX NO. 48028

19 JAN 89

Note: Trenching letter  attached  will be submitted later

Service Planner \_\_\_\_\_ Signed (Service Planning Supervisor) \_\_\_\_\_

Phone No \_\_\_\_\_ Address \_\_\_\_\_

MEMORANDUM ORDER  
FOR GENERAL USE  
DE FORM MS 77 12-53

TO Records Center

DATE 7-22-92 TIME \_\_\_\_\_

Please set up R/W file for: LONGACRE WOODS CONDO

Being a part of West 1/2 of Section 28, City of Farmington Hills

Oakland County, Michigan

COPIES TO: \_\_\_\_\_

SIGNED

*Omer V. Racine*  
Omer V. Racine

277 Oakland Division Headquarters

REPORT \_\_\_\_\_

DATE RETURNED \_\_\_\_\_

TIME \_\_\_\_\_

SIGNED \_\_\_\_\_

RECORDED RIGHT OF MAY NO.

43988

RES

LIBER 12662PC345

LIBER 12662PC346

NORTH ARROW

ARUNDEL DR.

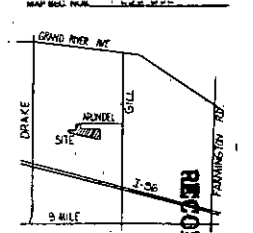
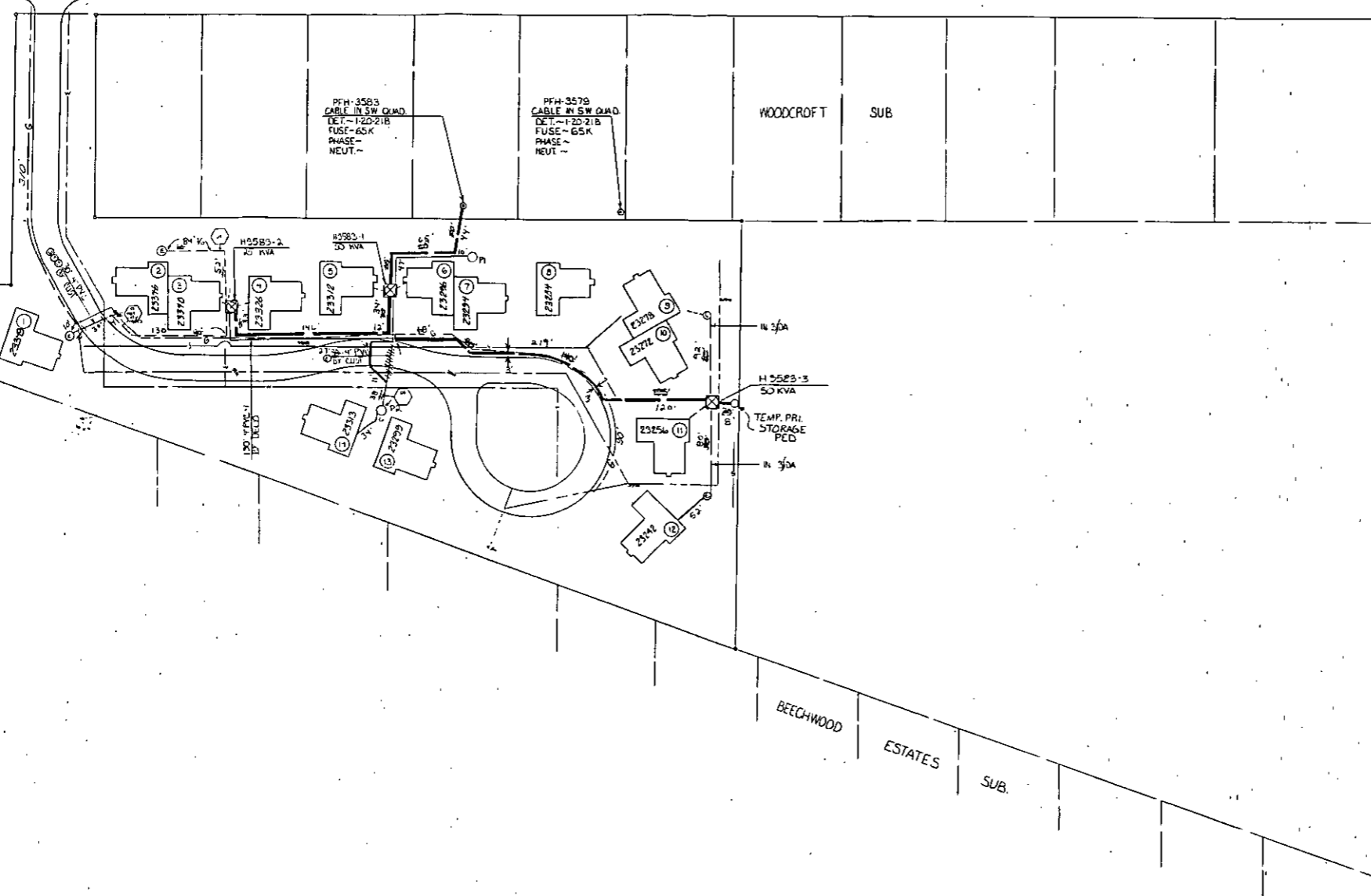

RECORDED RIGHT OF WAY NO. 43088

**EASEMENT LOCATIONS**  
(TRENCH OR LOCATED FROM THE EXISTING RECORD OR DRAW AS SHOWN BY DATE WITH THE DATE WITH THE DATE AS SHOWN)

- Buried Primary Cable
- Buried Secondary Cable
- Telephone Trench Only
- Gas
- Proposed Conduit

**TRANSFORMER DATA**

U.D.T. NO.	SIZE	ED. STK. NO.
H5583-1	50 KVA	661-1152
2	25	51
3	50	52

TRANSFORMER SPEC. 1-17-261  
 PEDESTAL SPEC. \_\_\_\_\_  
 NO. OF PEDESTALS 3  
 NO. OF TEMPORARY CABLE MARKERS 4  
 TEMPORARY CABLE MARKER SPEC. \_\_\_\_\_  
 SECONDARY CONNECTION BOX SPEC. \_\_\_\_\_

- CODE —**
- ⊕ TEMPORARY SECONDARY PEDESTAL/TEMPORARY CABLE MARKER
  - ⊗ DFT DEAD FRONT TYPE
  - ⊠ LOT SWITCHING—LIVE FRONT TYPE
  - ⊡ LOT SWITCHING—LIVE FRONT TYPE
  - ⊙ DIRECTION OF TRANSFORMER DOOR OPENING
  - ⊕ SECONDARY PEDESTAL
  - ⊗ SECONDARY CONNECTION BOX
  - ⊠ CABLE POLE
  - ⊡ PRIMARY SWITCH CABINET
  - ⊕ BURIED PRIMARY CABLE—ALL VOLTAGES
  - ⊗ BURIED SECONDARY CABLE
  - ⊠ DETROIT EDISON TRENCH ONLY
  - ⊡ TELEPHONE TRENCH ONLY
  - ⊕ SEWER
  - ⊗ WATER
  - ⊠ GAS
  - ⊡ PROPOSED CONDUIT
  - ⊕ REF CONN CABINET

**CABLE SUMMARY**

ITEM #	DESCRIPTION	QUANTITY	UNIT
1	22X1/2PEC X 1132 KV	713-3078	1000'
2	AP2-300A & 140 800 V	713-0037	250'
3	AP2 250 & 141 800 V	713-0014	700'
4	AP2 250 & 141 800 V	713-0014	400'

**TRENCH SUMMARY**

ITEM #	DESCRIPTION	QUANTITY	UNIT
1	JOINT USE 2" TRENCH 55' T.V. 35'	17	100'
2	DE ONLY	17	100'
3	TEL ONLY T.V. 1/2"	277	100'
4	GAS ONLY	433	100'
5	OTHERS	1859	100'
TOTAL		1859	100'

SITE Supt. ROBERT PRINCE, PHONE NO. 473-9249

**— GENERAL NOTES —**

TRENCHING TO BE DONE BY D.E.C.

TRENCH AND CABLE LENGTHS ARE APPROXIMATE.

SEE SECTION OF UG LINE CONSTRUCTION STANDARDS FOR TRANS. MAT. DETAILS.

SEE PAGE 2-21 (S.M.) DETAIL " " FOR ENTRANCE POINT DETAILS (APPL. ONLY).

SEE SECTION 43 UG LINE CONSTRUCTION STANDARDS FOR PLACEMENT OF CABLES, TRANSFORMERS AND PEDESTALS (SEWER ONLY).

D.E. SERVICE PLANNER: G. WHITE - 425-4109

TEL. CO.: G. COX - 456-0847

GAS CO.: D. CARTER - 427-5700

OTHERS: B. HENDZELI - 538-1829

CONTACT "MISS DIO" (800-467-7170) BEFORE DOING ANY EXCAVATION.

EASEMENTS INDICATED BY OUR CENTERLINE ARE IN WIDTH UNLESS OTHERWISE NOTED.

**PERMITS REQUIRED**

CITY OF \_\_\_\_\_ COUNTY, NOTIFICATION ONLY.

STATE  YES  NO

START DATE ~ 10-10-91

D	C	B	A	REVISION	DATE	JOB TITLE
			A REVISION: AS INSTALLED D.W. 8-23-91 U.S. 3-18-91 START 11-22-91 FINISH 11-26-91 UNDER 4-11-91 NOTES: 7-18-91 C.D.P. 12-14-91 S.A.P. 12-14-91	REVISION: CHD - A-55002 URD -	DRAWN BY: R. MARTIN 1-27-89 CHECKED BY: J. SKONIECZNY 9-24-91 APPROVED BY: G. BOROWSKI 9-24-91 F.G. RAUNSTADT 9-24-91	LONGACRE WOODS CONDOS CITY OF FARMINGTON HILLS OAKLAND CO.

**THE DETROIT EDISON COMPANY**

SCALE: 1"=50'

NUMBER OF SHEETS: 14

SHEET NUMBER: 367B14J684

LATEST REVISION: 8873 FRMTN 132KV

DEPT. ORDER NUMBER: 89A-63634

DATE: 10-10-91