

This easement is re-recorded for purposes of showing the planned "as installed" centerlines of easements granted as shown on drawing attached hereto.

LIBER 12598 PG 065

LIBER 11995 PG 148

91 122466

92 114863

Maple Grove Condo

**UNDERGROUND DISTRIBUTION EASEMENT (RIGHT OF WAY) NO. OE 91-4J**

On June 4, 1991, for the consideration of system betterment, Grantor grants to Grantee a permanent underground distribution easement ("Right of Way") in, on and across a part of Grantor's Land called the "Right of Way Area".

A#36 REG/DEEDS PAID  
0001 MAY.11.92 12:59PM  
9987 MISC 13.00

**"Grantor" is:**

Longview / Barnard, Inc., a Michigan corporation, 5403 Livernois, Troy, Michigan 48098

**"Grantee" is:**

The Detroit Edison Company, a Michigan corporation, 2000 Second Avenue, Detroit, Michigan 48226  
Michigan Bell Telephone Company, a Michigan corporation, 444 Michigan Avenue, Detroit, Michigan 48226  
United Cable Television of Oakland County, Ltd., a Michigan corporation, 4500 Delemere Blvd., Royal Oak, Michigan 48073

**"Grantor's Land" is in the City of Clawson, Oakland County, Michigan described as:**

See Attached Appendix "A"

A#36 REG/DEEDS PAID  
0001 MAY.11.92 12:59PM  
9987 RMT FEE 2.00

*ENT*

**The "Right of Way Area" is a part of Grantor's Land described as:**

The exact location of said easements shall be shown on a drawing to be recorded 90 days after construction.

- Purpose** The purpose of this Right of Way is to construct, reconstruct, modify, add to, operate and maintain utility line facilities consisting of poles, guys, anchors, wires, manholes, conduits, pipes, cables, transformers and accessories.
- Access** Grantee has the right of access to and from the Right of Way Area.
- Buildings or other Permanent Structures** No buildings or other permanent structures shall be placed in the Right of Way Area without Grantee's prior written consent.
- Excavation** As required by Public Act 53 of 1974, MISS DIG must be called on 1-800-482-7171 before anyone excavates in the Right of Way Area.
- Trees, Bushes, Branches, Roots, Structures and Fences** Grantee may trim, cut down, remove or otherwise control any trees, bushes, branches and roots in the Right of Way Area (or that could grow into the Right of Way Area) and remove structures and fences in the Right of Way Area that Grantee believes could interfere with the safe and reliable construction, operation and maintenance of Grantee's facilities. No trees, plant life, structures and fences shall be planted, grown or installed within 8 feet of the front door and within 2 feet of the other sides of transformers and switching cabinet enclosures. Grantee shall not be responsible to Grantor for damages to or removal of trees, plant life, structures and fences placed in front of transformer doors.
- Ground Elevation** Grantor must grade the Right of Way Area to within four inches of final grade before Grantee installs its facilities. Grantor must maintain this ground elevation after Grantee installs its facilities.
- Damages** If Grantor, its agents, employees or contractors, damage Grantee's facilities, Grantee shall make repairs at Grantor's expense.
- Successors** This Right of Way runs with the land and binds and benefits Grantor's and Grantee's successors, lessees, licensees and assigns.

RECORDED RIGHT OF WAY NO. 43038

**Witnesses:**

*[Signature]*

Michael R. Cole

*[Signature]*

Hazel Griffin

**Grantor:**

Longview / Barnard, Inc.

A Michigan Corporation

*[Signature]*  
Laurence R. Jeris, President

A#36 REG/DEEDS PAID  
0001 JUL.31.91 10:41AM  
1096 MISC 9.00

O.K. - LM

A#36 REG/DEEDS PAID  
0001 JUL.31.91 10:41AM  
1096 RMT FEE 2.00

O.K. - LM

for date to

*[Signature]*

**Prepared by and Return to:**

Omer V. Racine, 30400 Telegraph Rd., Suite 277, Birmingham, MI 48010

0001 MAY 11 1955 13:28PM  
2885 RNT FEE 5.00

0001 MAY 11 1955 13:28PM  
2885 RNT FEE 5.00

0001 MAY 11 1955 13:28PM

2885 RNT FEE 5.00



0001 MAY 11 1955 13:28PM  
2885 RNT FEE 5.00

RETURN TO  
J. D. McDONALD  
THE DETROIT EDISON COMPANY  
30400 TELEGRAPH ROAD, 277 OAKDH  
BIRMINGHAM, MICHIGAN 48010

LIBER 125960066<sup>2</sup>

LIBER 1199500149

RW #OE 91-4J

Appendix "A"

-17032

City of Clawson

Part of Lots 1, 2 and 3 and all of Lots 4 through 7 inclusive, McBride's Re-Subdivision, (as recorded in Liber 17, page 32, Plats, Oakland County Records). Also part of Lots 33, 34, 45 and 46, Eyster and Howarth Plat of Clawson, (as recorded in Liber 10, Page 1, Plats, Oakland County Records), City of Clawson, Oakland County, Michigan, more particularly described as follows: Beginning at the intersection of the north line of Fourteen Mile Road and the east line of High Street, thence South 89°34'51" east along the north line of Fourteen Mile Road 324.40 feet; thence north 00°25'00" west 260.00 feet; thence north 89°34'51" west 4.83 feet; thence north 00°25'00" west 158.00 feet; thence north 89°34'51" west 182.67 feet; thence south 00°25'00" east 202.00 feet; thence north 89°34'51" west 136.90 feet to the east line of High Street; thence along said line south 00°25'00" east 216.00 feet to the point of beginning.

10001

Sidwell No:

- 20-34-378-014 - lot 1 + 2
- 20-34-378-018 - lot 3
- 20-34-378-013 - lot 4
- 20-34-378-012 - lot 5
- 20-34-378-011 - lot 6
- 20-34-378-010 - lot 7
- (20-34-378-016)
- 20-34-378-016
- 20-34-378-049 - lot 45
- 20-34-378-050 - lot 45
- 20-34-378-085 - lot 46
- 20-34-378-086 - lot 46
- 20-34-378-091 - lot 33
- 089 - lot 34

Above Legal NKA  
Ent Maplegrove Village  
B Clawson Condo unit 1-37  
except 728 20-34-378-000

ENT 9000728

Acknowledged before me in Oakland County, Michigan, on JUNE 4, 19 91

by LAURENCE R. JERIS the PRESIDENT of LONGVIEW / BARNARD, INC., a Michigan corporation, for the corporation.

MICHAEL R. COLE  
Notary Public, Oakland County, MI  
My Commission Expires Feb. 8, 1993

Notary's Signature

Notary's Stamp

RECORDED RIGHT OF WAY NO.

43035

FOURTH

RETURN TO  
J. D. McDONALD  
THE DETROIT EDISON COMPANY  
6000 TELEGRAPH ROAD, 277 OAKDH  
DETROIT, MICHIGAN 48010

MEMORANDUM ORDER  
FOR GENERAL USE  
DE FORM MS 77 12-52

TO Records Center

DATE 6-9-92 TIME \_\_\_\_\_

Please set up R/W file for: MAPLE GROVE CONDO

Being a part of South 1/2 of Section 34, CITY OF CHANDLER

Oakland County, Michigan

COPIES TO: \_\_\_\_\_

SIGNED

*Omer V. Racine*

Omer V. Racine  
277 Oakland Division Headquarters

REPORT \_\_\_\_\_

DATE RETURNED \_\_\_\_\_

TIME \_\_\_\_\_

SIGNED \_\_\_\_\_

*Tracy Twp*  
*Sec. 34*

RECORDED  
RIGHT OF WAY NO.

43035

To (Supervisor, RE & R/W) <i>J. McDONALD</i>	For RE & R/W Dept. Use	Date Received <i>5-22-91</i>	DE/Bell/C P. No. <i>OE 91-4J</i>
Division <i>OAKLAND</i>	Date <i>5-16-91</i>	Application No.	

We have included the following necessary material and information:

**Material:**

- A. Proposed Subdivision
  - 1. copy of complete final proposed plat - All pages
- or
- B. Other than proposed subdivision (condo., apts. mobile home park — other)
  - 1. Property description.
  - 2. Site plan.
  - 3. title information (deed, title commitment, contract with title commitment, or title search).

Note: Do not submit application for URD easements until all above material has been acquired.

**Information**

1. Project Name <i>MAPLEGROVE CONDOS</i>	County <i>OAKLAND</i>
City/Township/Village <i>CLAWSON</i>	Section No.
Type of Development <input type="checkbox"/> Proposed Subdivision <input type="checkbox"/> Apartment Complex <input checked="" type="checkbox"/> Condominium <input type="checkbox"/> Subdivision <input type="checkbox"/> Mobile Home Park <input type="checkbox"/> Other	
2. Name of Owner <i>LONGVIEW BARNARD INC</i>	Phone No. <i>879-0920</i>
Address <i>5403 LIVERNOIS TROY MI 48098</i>	
Owner's Representative <i>LARRY JERIS</i>	Phone No. <i>879-0920</i>
Date Service is Wanted <i>JUNE 15, 1991</i>	
4. Entire Project will be developed at one time ..... <input checked="" type="checkbox"/> Yes <input type="checkbox"/> No	
5. Joint easements required — Michigan Bell Telephone ..... <input checked="" type="checkbox"/> Yes <input type="checkbox"/> No	
— Consumers Power ..... <input checked="" type="checkbox"/> Yes <input type="checkbox"/> No	
a. Name of Other Utilities If Not Michigan Bell Telephone or Consumers Power <i>UNITED ARTIST</i>	
b. Other Utility Engineer Names <i>JEFF WOOD</i>	Phone Numbers <i>5491236</i>
Addresses <i>4500 DELEWARE ROYAL OAK 48073</i>	
6. Additional Information or Comments <i>MEMO # 05381 CATV FEET JOINT USE</i> <i>MEMO # 05380 ART</i>	

RECORDED RIGHT OF WAY NO. 43035

Note: Trenching letter  attached     will be submitted later

Service Planner <i>T.S. TASSER</i>	Signed (Service Planning Supervisor)
Phone No. <i>167-4122</i>	Address <i>240 ODHQ</i>

LIBER 12596PG067

NORTH ARROW

LIBER 12596PG068

LOCATION SKETCH  
MAP SEC. NOS. 1-312-578

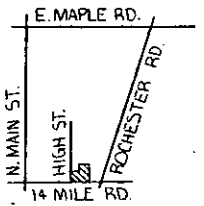

RECORDED RIGHT OF WAY NO. 43035

**TRANSFORMER DATA**

U.D.T. NO.	SIZE	ED. STK. NO.
H4096-1	25 KVA	6661-1156
-2	50 KVA	6661-1157
-3	50 KVA	6661-1157
H4100-1	50 KVA	6661-1157
-2	25 KVA	6661-1156
-3	50 KVA	6661-1157

TRANSFORMER SPECS. 1-17-263  
 PEDESTAL AMOUNT 6 SPEC. \_\_\_\_\_  
 TEMPORARY CABLE MARKERS AMOUNT \_\_\_\_\_ SPEC. \_\_\_\_\_  
 SECONDARY CONNECTION BOX AMOUNT \_\_\_\_\_ SPEC. \_\_\_\_\_

**CODE**

- ⊕ TEMPORARY SECONDARY PEDESTAL/TEMPORARY CABLE MARKER
- ⊖ DFT (DEAD FRONT TYPE)
- ⊕ UDT (NON-SWITCHING—LIVE FRONT TYPE)
- ⊖ UDT (SWITCHING—LIVE FRONT TYPE)
- DIRECTION OF TRANSFORMER DOOR OPENING
- SECONDARY CONNECTION BOX
- CABLE POLE
- ⊕ PRIMARY SWITCH CABINET
- BURIED PRIMARY CABLE—ALL VOLTAGES
- BURIED SECONDARY CABLE
- BURIED SECONDARY SERVICE CABLE
- DETROIT EDISON TRENCH ONLY
- TELEPHONE TRENCH ONLY
- SEWER
- WATER
- GAS
- PROPOSED CONDUIT
- SEP CONN CABINET

**EASEMENT LOCATIONS**

- Easements are located where the following symbols are shown. All easements are single width, area where care (two) symbol is shown.
- Buried Primary Cable
  - Buried Secondary Cable
  - Buried Secondary Service Cable
  - Telephone Trench Only
  - Gas
  - Proposed Conduit

**NOTE:-**

METER SHALL BE LOCATED IN SHADED AREA CLOSEST TO D.E.C.O. SOURCE.

INSTALLED	ITEM #	ESTIMATED
7754	AP2350M x 1-132 KV	713-3082 = 1147'
457	AP2350M & 1-40 600 V.	713-0537 = 441'
810	AP230 & 1-41 600 V.	713-0514 = _____

**TRENCH SUMMARY**

JOINT USE E+F+G+H+I+J+K+L+M+N+O+P+Q+R+T+V+U+W+X+Y+Z  
 D.E. ONLY G+T=82'  
 TEL ONLY: 6'  
 GAS ONLY: 25'  
 OTHERS G+T+V=137'  
 TOTAL \_\_\_\_\_ 1801'  
 SITE SUPT. \_\_\_\_\_ PHONE NO. \_\_\_\_\_

**GENERAL NOTES**

TRENCHING TO BE DONE BY THE DETROIT EDISON CO.  
 TRENCH AND CABLE LENGTHS ARE APPROXIMATE.  
 SEE SECTION 56 UG LINE CONSTRUCTION STANDARDS FOR TRANS. MAT. DETAILS.  
 SEE PAGE 32-11 S LMJ DETAIL " " FOR ENTRANCE POINT DETAILS (APTS. ONLY)  
 SEE SECTION 43 UG LINE CONSTRUCTION STANDARDS FOR PLACEMENT OF CABLES, TRANSFORMERS AND PEDESTALS (SUBS ONLY)  
 D.E. SERVICE PLANNER: TOM TASSEN 645-4122  
 TEL. CO.: DAN O'CONNELL 456-0823  
 GAS CO.: BILL VERNAGUS 549-5000  
 OTHERS: CATV: JIM KREMER 549-1236

**NOTICE**

Locations of underground facilities on this drawing are only approximate. Exact locations must be determined by the UTILITY COMPANIES. For exact locations, telephone MISS DIG on 800-482-7171 as required by Public Act 53 of 1974 before doing any power excavating.

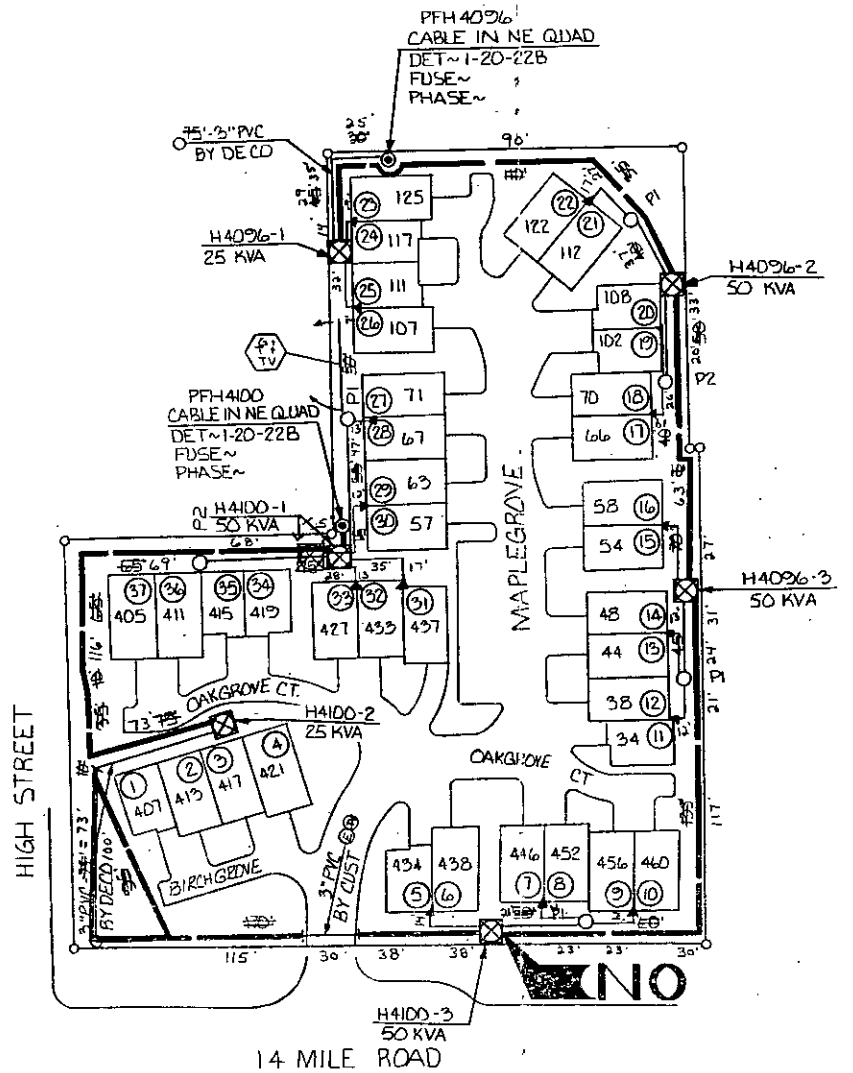

START DATE 8-15-91

D REVISION			C REVISION			B REVISION			A REVISION AS INSTALLED		
									D.O.	A-64710	
									W.O.	36784 3 209	
									START	8-22-91	
									FINISH	8-29-91	
									LABOR	UNION SVL	
									MATERIALS	5-0108800	
									QUANTITY	8-30-91	
									CONTRACT	3020	
DRAWN BY	CHECKED BY	APPROVED BY	DRAWN BY	CHECKED BY	APPROVED BY	DRAWN BY	CHECKED BY	APPROVED BY	DRAWN BY	RCM	
									CHECKED BY	3-11-92	

DRAWN BY	NAME	DATE	JOB TITLE
DRAWN BY	RALPH M WINCEL	5-15-91	
CHECKED BY	T. TASSEN	7-24-91	
APPROVED BY	Bill Berger	7-24-91	
	J. M. ...	7-24-91	
SEPIA TO MBT			

MAPLE GROVE CONDO'S  
 PART OF S 1/2 SEC. 34  
 T. 2N., R. 11E

CITY OF CLAWSON COUNTY OF OAKLAND

THE DETROIT EDISON COMPANY SERVICE PLANNING		
SCALE	NUMBER OF UNITS	WORK ORDER NUMBER
1" = 50'	37	36784 1909
LATEST REVISION	DISTRIBUTION CIRCUIT	
	8241 MAUME	
DEPT ORDER NUMBER		
91A-64710		
SHEET	OF	SHEETS