

PLEASE SECURE RIGHT OF WAY AS FOLLOWS:

DATE 12-13-90

LOCATION 4210 WHITE LAKE

APPLICATION NO. Ø-4130

12-06-329-008

DEPT. ORDER NO. _____

CITY OR VILLAGE WHITE LAKE, MI 48383

O. F. W. NO. _____

TOWNSHIP WHITE LAKE COUNTY OAKLAND

BUDGET ITEM NO. _____

DATE BY WHICH RIGHT OF WAY IS WANTED _____

INQUIRY NO. _____

THIS R/W IS 100 % OF TOTAL PROJECT NO. _____ ACCUM. _____ %.

JOINT RIGHT OF WAY REQUIRED YES NO

GTE ~~MEMO~~ MEMO # Ø-4210
CATV MEMO # Ø-4211

NOTE: Identify on print or sketch the subdivisions as to section location and liber and page.

KIND AND DESCRIPTION OF RIGHT OF WAY REQUESTED RECORDED EASEMENT AS SHOWN ON SKETCH.

EASEMENT TO BE JOINT WITH GTE AND CATV. 10' EASEMENT FROM EXISTING UTILITY (LOCATED 154' N. OF THE SOUTH PROPERTY LINE) TO THE EAST PROPERTY LINE.

PURPOSE OF RIGHT OF WAY 10' EASEMENT FOR PUBLIC UTILITIES

SIGNED _____

OFFICE _____ DEPARTMENT _____

REPORT OF REAL ESTATE AND RIGHTS OF WAY DEPT.

Recordable joint underground right of way secured as per attached sketch. Contacts made by C. George Williams, Representative, Real Estate, Rights of Way, Oakland Division.

RECORDED INDEX OF MAP NO. 4165-2

PERMITS IN RECORD CENTER 1 R.E. & R/W DEPT. FILE 1 GRANTOR Kyser

NO. OF PERMITS 1 NO. OF STRUCTURES _____ NO. OF MILES _____ PERMITS TO ~~MT~~ GTE 1

DATE 02/28/91 SIGNED James McDonald, Sr. Representative

Detroit Edison

**Real Estate and Rights of Way
Joint Underground
Right of Way Agreement**

LIBER 117750241

JANUARY 15TH 1991

For good and valuable consideration of system betterment, the undersigned hereby grant and convey to THE DETROIT EDISON COMPANY, a Michigan corporation of 2000 Second Avenue, Detroit, Michigan, and GENERAL TELEPHONE, a Michigan corporation of 455 E. Ellis, Muskegon, Michigan and GREATER MICHIGAN CABLEVISION, a Michigan corporation of 3166 Martin Road, Walled Lake, Michigan, hereinafter referred to collectively as "GRANTEE", the right to construct, reconstruct, modify, add to, operate and maintain underground line facilities consisting of poles, conduits, wires, cables, manholes, transformers and accessories required to provide electric and communication services in, under, upon, over and across property located in the **Township of White Lake, County of Oakland**, State of Michigan, further described as follows:

Part of Lot 22, Sec. 6., T3N., R8E., Supervisor's Plat No. 4, beg at pt dist N 65° 49'00" E 186.89 ft from NW lot cor, th N 65° 49'00" E 88.43 ft, th N 89° 47'30" E 119.80 ft, th S 00° 54'44" E 374.85 ft, th S 89° 43'40" W 200.97 ft, th N 00° 55'26" W 339.14 ft to beginning.

Sidwell No. 12-06-329-009

30050

B#92 REG/DEEDS PAID
0001 MAR 15 '91 11:58AM
3450 MISC 11.00

As shown on the attached drawing O-1130 dated 12/13/90 which is made a part hereof

Detroit
The right of way is ten (10) feet in width.

The rights hereby granted include the right of access to and from the right of way and the right to trim, cut down or otherwise control trees, brush or roots of any kind either within the right of way or on property adjoining the right of way which in the opinion of the GRANTEE interferes with the construction or operation of the line facilities. It is expressly understood and agreed that the GRANTEE shall, at no time, trim or cut down any trees unless, in the GRANTEE'S opinion, it is absolutely necessary to do so. The GRANTEE shall restore premises to its original condition or as near as can be in the event of damages caused by its employes, contractors, vehicles and equipment entering premises for the purposes set forth herein.

No buildings or structures are to be placed within said right of way herein granted without the written consent of the GRANTEE.

This grant is declared to be binding upon the heirs, successors, lessees, licensees and assigns of the parties hereto.

IN WITNESS WHEREOF, the undersigned have hereunto set their hand(s) on the date of this agreement.

Witnesses:

B#92 REG/DEEDS PAID
0001 MAR 15 '91 11:58AM
3450 RMT FEE 2.00

11.00
2.00 RMT
RL

Dean F. Raymoure
DEAN F. RAYMOURE

Kevin James Kyser
Kevin James Kyser

C. George Williams
C. George Williams

Annemette Brinch Kyser
Annemette Brinch Kyser, his wife

4300 White Lake Road

White Lake, Michigan 48383

Prepared by: C. George Williams/lhp
The Detroit Edison Company
30400 Telegraph Road, Suite 277
Birmingham, Mi 48010

Address: 4300 White Lake Road
White Lake, Mi 48383

O.K. — LM

APPROVED AS TO FORM 1/28/91
LEGAL DEPARTMENT

Return on Back

RECORDED RIGHT OF WAY NO. 41652

RETURN TO
J. D. McDONALD
THE DETROIT EDISON COMPANY
30400 TELEGRAPH ROAD, 277 OAKDH
BIRMINGHAM, MICHIGAN 48010

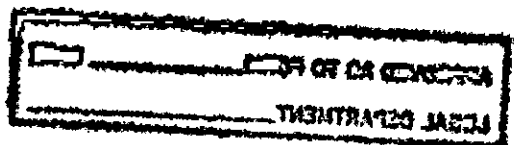

State of Michigan)
County of Oakland) SS:

On this 15TH day of JANUARY, 1991, the foregoing instrument was acknowledged before me, a notary public in and for said county by Kevin James Kyser and Annemette Brinch Kyser, his wife.

C. GEORGE WILLIAMS
Notary Public, Oakland County, MI
My Commission Expires Dec. 2, 1991

My Commission Expires: _____

C. George Williams
C. George Williams
Notary Public,
Oakland County, Michigan

RECORDED RIGHT OF WAY NO. 41652

APR 24 1964
U.S. POST OFFICE
BIRMINGHAM, ALABAMA

RETURN TO
J. D. McDONALD
THE DETROIT EDISON COMPANY
30400 TELEGRAPH ROAD, 277 OAKDH
BIRMINGHAM, MICHIGAN 48010

GTE MEMO-0-4210
 CATV MEMO 0-4211

LIBER 11775 PG 243

E 1/2 S.W. 1/4 SECT. 6

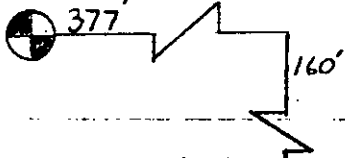

186.89 WHITE LAKE

12-06-329-008

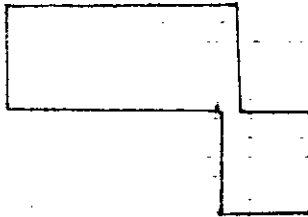

DEAN F. RAYMOURE
 4210 WHITE LAKE
 889-2205

* R/W SECURED
 * KEVIN JAMES KYSER
 12-06-329-009
 4300 WHITE LAKE

332.14

13 1/2

10' EASEMENT PO TO

10' FT PRIVATE EASEMENT
 FOR PUBLIC UTILITIES

263.37

154

RECORDED RIGHT OF WAY NO. 41658

REPORT OF PROPERTIES AND RIGHTS OF WAY DEPARTMENT R/W SECURED AS INDICATED ON THIS SKETCH

BY G. GEORGE WILLIAMS

DATE 1-17-91

DATE WANTED
 DISTRICT FIELDMAN

PERMITS TO:

RECORD CENTER	<u>1</u>
R/W FILES	<u>1</u>
NOT GTE	<u>1</u>
ORIGINATOR	<u>1</u>
TOTAL	<u>1</u>

175

LEGEND	
	FOREIGN POLE
	EXIST D.E. CO. POLE
	PROPOSED POLE
	EXIST ANCHOR
	PROPOSED ANCHOR
	TREE
	120/240 VOLT LINE
	4800 VOLT LINE
	13,200 VOLT LINE
	40,000 VOLT LINE

THE DETROIT EDISON COMPANY-SERVICE PLANNING DEPARTMENT			
CITY OR TOWNSHIP <u>WHITE LAKE</u>	COUNTY <u>OAKLAND</u>	QTR. & TWP. SECT. NO. <u>E 1/2 S.W. 1/4 SECT. 6</u>	DEPT. ORDER NO.
MAP SECT. <u>1-208-434</u>	TOWN <u>T3N</u>	RANGE <u>R8E</u>	R/W NO. <u>0-1130</u>
PROJECT NAME	TEL ENGR & DIST.	JOINT R/W REQUIRED YES <input checked="" type="checkbox"/> NO <input type="checkbox"/>	PROJ. OR PART NO.
CIRCUIT	REASON <u>SECURE U.G. EASEMENT FOR PUBLIC UTILITIES</u>	SCALE <u>NONE</u>	O.F.W. S.O. OR P.E. NO.
PLANNER <u>R. E. LAWITZKE</u>		DATE <u>12-13-90</u>	BUDGET ITEM NO.

1954-1971

RETURN TO
J. D. McDONALD
THE DETROIT EDISON COMPANY
30400 TELEGRAPH ROAD, 277 OAKDH
BIRMINGHAM, MICHIGAN 48010