

**MEMORANDUM ORDER**  
FOR GENERAL USE  
DE FORM MS 77 12-53

TO Records Center

DATE 4-3-91 TIME \_\_\_\_\_

Please set up R/W file for: University Place Apts Phase 1  
Being a part of Northeast 1/4 of Section 22, City of Pontiac  
Oakland County, Michigan

COPIES TO: \_\_\_\_\_

SIGNED

*Omer V. Racine*

Omer V. Racine

REPORT \_\_\_\_\_

277 Oakland Division Headquarters

DATE RETURNED \_\_\_\_\_

TIME \_\_\_\_\_

SIGNED \_\_\_\_\_

RECORDED  
RIGHT OF PAY  
O.

4/6/91

To (Supervisor, RH & R/W)	For RE & R/W Dept. Use	Date Received	DE/Bell/C.P. No.
		4-20-88	DE 88-14J
Division	Date	Application No.	
Oakland	4/15/88		

We have included the following necessary material and information:

**Material:**

- A. Proposed Subdivision
  1. copy of complete final proposed plat - All pages
- or
- B. Other than proposed subdivision (condo., apts. mobile home park — other)
  1. Property description.
  2. Site plan.
  3. title information (deed, title commitment, contract with title commitment, or title search).

Note: Do not submit application for URD easements until all above material has been acquired.

**Information**

1. Project Name	County
University Place Apts Phase II	Oakland
City/Township/Village	Section No.
Pontiac	22

Type of Development	<input checked="" type="checkbox"/> Apartment Complex	<input type="checkbox"/> Condominium
<input type="checkbox"/> Proposed Subdivision	<input type="checkbox"/> Mobile Home Park	<input type="checkbox"/> Other
<input type="checkbox"/> Subdivision		

2. Name of Owner	Phone No.
Leon Moskovitz,	861-0034

Address	Phone No.
17300 Wyoming Ave, Detroit MI, 48221	

Owner's Representative	Phone No.

Date Service is Wanted
7/15/88

4. Entire Project will be developed at one time	<input type="checkbox"/> Yes	<input checked="" type="checkbox"/> No
5. Joint easements required — Michigan Bell Telephone	<input checked="" type="checkbox"/> Yes	<input type="checkbox"/> No
— Consumers Power	<input type="checkbox"/> Yes	<input checked="" type="checkbox"/> No

a Name of Other Utilities If Not Michigan Bell Telephone or Consumers Power

b Other Utility Engineer Names	Phone Numbers
MBT Lou Faust	456-0824
Addresses	

6. Additional Information or Comments

Note: Trenching letter  attached  will be submitted later

Service Planner	Signed (Service Planning Supervisor)
P. Hennessy	<i>[Signature]</i>
Phone No.	Address
645-4152	240 DASH

RECORDED RIGHT OF WAY NO. 41627

LIBER 10420 PAGE 145

LIBER 11775 PG 147

Detroit Edison

Right of Way Agreement

88 72323

MAY 5, 19 88

For valuable consideration, the receipt of which is hereby acknowledged, the undersigned hereby grant and convey to THE DETROIT EDISON COMPANY, a corporation organized and existing concurrently under the laws of the States of Michigan and New York, of 2000 Second Avenue, Detroit, Michigan 48226 and the MICHIGAN BELL TELEPHONE COMPANY, a Michigan corporation, of 444 Michigan Avenue, Detroit, Michigan 48226 hereinafter referred to as "UTILITIES", the easement and right to erect, lay, maintain, reconstruct and replace underground facilities consisting of wires, cables, conduits, fixtures and appurtenances including the necessary above ground equipment, connections, poles and accessories which may from time to time be required in, under, upon, over and across the land located in the City of Pontiac, Oakland County, Michigan, and more particularly described on the attached Appendix "A", with the full right to the UTILITIES of ingress and egress upon said land for the purposes of this grant, and the further right to trim, cut down or otherwise control brush and trees within the easements herein described.

Said easements shall be ten (10) feet in width unless otherwise indicated and their route is described as follows: The exact location of said easements shall be shown on a drawing to be recorded 90 days after construction.

In order to provide for the proper maintenance and protection of UTILITIES, the undersigned covenant and agree that:

1. The easements will be graded to within four (4) inches of final grade before the UTILITIES lines are installed and this ground elevation must be maintained after installation of utilities to avoid the pooling of water in, on or around above ground UTILITIES' equipment.
2. No buildings or structures other than UTILITIES equipment are to be placed within the easements herein granted. No excavation is to be permitted within said easement without approval of UTILITIES.
3. If the lines or facilities of UTILITIES are damaged by the acts of Owners, their agents, employes or contractors, repairs shall be made by the Utility company so damaged at the cost and expense of Owners. Owners are defined as those persons owning the land at the time the damage occurred.
4. No shrubs or foliage shall be planted or grown within five (5) feet of the front door of transformers or switching cabinet enclosures. UTILITIES shall not be responsible to Owners for damages to or removal of trees or plant life planted in front of said door or within the easement causing an interference with UTILITIES maintenance of their equipment.

THIS GRANT is declared to be binding upon the heirs, successors, lessees, licenses and assigns of the parties hereto.

IN WITNESS WHEREOF, the undersigned have hereunto set their hand and seal on this date.

Witnesses:

Grantors:

B#92 REG/DEEDS PAID  
0001 MAR.15.91 11:55AM  
3450 MISC 15.00

B#92 REG/DEEDS PAID  
See Next Page  
0001 MAR.15.91 11:55AM  
3450 RMT FEE 2.00

A#36 REG/DEEDS PAID  
0001 MAY.20.88 02:43PM  
1117 MISC 7.00

Omer V. Racine  
The Detroit Edison Company  
30400 Telegraph Rd., Suite 264  
Birmingham, MI 48010

Address:

Prepared By:

RECORDING FEE ON WAY NO. 41627  
1000  
200 RMT  
AC  
2000

This easement is re-recorded for purposes of showing the planned "as installed" centerlines of easements granted as shown on drawing attached hereto.

Return on Back

ALBANY, N.Y.

1917

1917

1917

1917

RETURN TO  
J. D. McDONALD  
THE DETROIT EDISON COMPANY  
30400 TELEGRAPH ROAD, 264 OAKDH  
BIRMINGHAM, MICHIGAN 48010





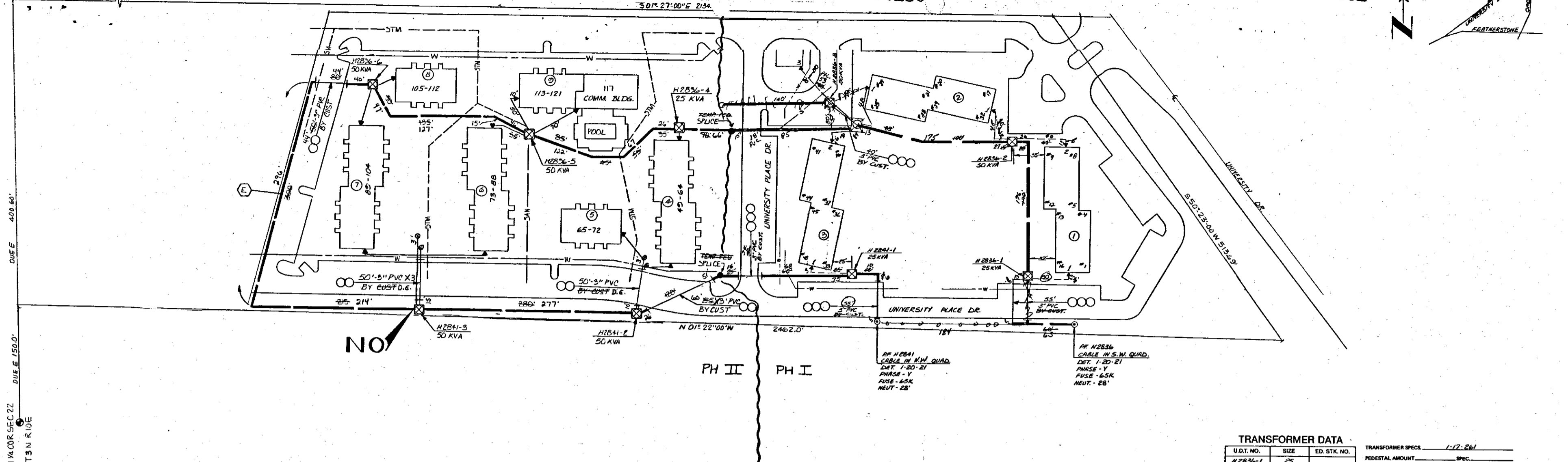

**TRANSFORMER DATA**

U.D.T. NO.	SIZE	ED. STK. NO.
N2836-1	25	
" - 2	50	
N2836-3	50	
N2841-1	25	
N2841-2	50	
N2841-3	50	
N2836-4	25	
" - 5	50	
N2836-6	50	

- TRANSFORMER SPECS** 1-17-261
- PEDESTAL AMOUNT \_\_\_\_\_ SPEC \_\_\_\_\_
- TEMPORARY CABLE MARKERS AMOUNT \_\_\_\_\_ SPEC \_\_\_\_\_
- SECONDARY CONNECTION BOX AMOUNT \_\_\_\_\_ SPEC \_\_\_\_\_
- CODE —**
- ⊙ TEMPORARY SECONDARY PEDESTAL/TEMPORARY CABLE MARKER
  - ⊠ DFT (DEAD FRONT TYPE)
  - ⊡ UOT (NON-SWITCHING—LIVE FRONT TYPE)
  - ⊞ UOT (SWITCHING—LIVE FRONT TYPE)
  - DIRECTION OF TRANSFORMER DOOR OPENING
  - SECONDARY PEDESTAL
  - △ SECONDARY CONNECTION BOX
  - ⊕ CABLE POLE
  - ⊞ PRIMARY SWITCH CABINET
  - BURIED PRIMARY CABLE—ALL VOLTAGES
  - BURIED SECONDARY CABLE
  - BURIED SECONDARY SERVICE CABLE
  - DETROIT EDISON TRENCH ONLY
  - TELEPHONE TRENCH ONLY
  - SEWER
  - WATER
  - GAS
  - PROPOSED CONDUIT
  - SEP CONN CABINET
- NOTE:—**  
METER SHALL BE LOCATED IN SHADED AREA CLOSEST TO D.E.CO. SOURCE.

**EASEMENT LOCATIONS**

Easements are located where the following symbols are shown. All easements are single width, even where more than one symbol is shown.

- Buried Primary Cable
- Buried Secondary Cable
- Buried Secondary Service Cable
- Telephone Trench Only
- Gas
- Proposed Conduit

RECORDED R/W FILE NO.  
**R411627**

**CABLE SUMMARY**

INSTALLED	PH II	FRONT
7533	3073	ESTIMATED
374	AP2-350M x 1-132 KV 17651 713-0092 = 1462 1774	
	AP2-350M & 1-400 600 V. 802 713-0037 = 442 476	
	AP2-20 & 1-81 600 V. 713-0014 = 28 87	

**TRENCH SUMMARY**

PHASE II	FRONT
JOINT USE E+T+CTV --- 460' 018	E+T+TV+H+SB+1046
D.E. ONLY ---	E --- 268' 334
TEL ONLY ---	E+T --- 214
GAS ONLY ---	
OTHERS M+T+TV --- 124	
TOTAL --- 660' 1002	1920' 1576

SITE SUPT: **BRUCE WISNYSKI** PHONE NO: **577-2202**  
LEON MOSKOWITZ 561-0034

**NOTICE**

Locations of underground facilities on this drawing are only approximate. Exact locations must be determined by the UTILITY COMPANIES. For exact locations, telephone MISS DIG on 800-482-7171 as required by Public Act 53 of 1974 before doing any power excavating.

**GENERAL NOTES**

TRENCHING TO BE DONE BY **D.E.CO.**

TRENCH AND CABLE LENGTHS ARE APPROXIMATE.

SEE SECTION 56 UG LINE CONSTRUCTION STANDARDS FOR TRANS. MAT. DETAILS.

SEE PAGE 32-11 (S.I.M.) DETAIL " " FOR ENTRANCE POINT DETAILS (APTS. ONLY).

SEE SECTION 43 UG LINE CONSTRUCTION STANDARDS FOR PLACEMENT OF CABLES.

TRANSFORMERS AND PEDESTALS (BURIED ONLY)

D.E. SERVICE PLANNER: **DAVE MOLEY PHEWNESSY 643-4466**

TEL. CO.: **F. FOUST 540-0801**

GAS CO.: **540-0801**

OTHERS: **CAB. TV MARK-MORPER J. CHURCH 674-0800**  
**C-374**

START DATE **9-1-86**

CITY OF \_\_\_\_\_ COUNTY \_\_\_\_\_ NOTIFICATION TO \_\_\_\_\_ YES

STATE  YES  NO

D	REVISION	C	REVISION AS INSTALLED	B	REVISION	A	REVISION AS INSTALLED	REFERENCE	NAME	DATE	JOB TITLE
		D.O.	A-6597C	INSTALL PHASE II	Do 86A-63943	URD PON-22			ED BOURHENN	7-23-86	
		W.O.	3678147364	D.O. ~ 28A-65370	NO. 3678147383				D. FOLEY	8-11-86	
		START	9-12-88	W.O. ~ 3678147364	START 10-5-86				J. HENNESSY	8-15-86	
		FINISH	9-11-88	UNITS ~ 72	NOTICE # 656011						
		LABOR	UNION G.C.	START DATE ~ 9-12-88	ENG. BY PARLAN W-22-86						
		NOTES	F. OSBORNE								
		ENCL	9-21-88								
		DATE	9-21-88								
		BY	W.S. B. ELEC.								
		APPROVED BY									
		DATE									
		BY									
		APPROVED BY									
		DATE									
		BY									
		APPROVED BY									
		DATE									
		BY									
		APPROVED BY									
		DATE									
		BY									
		APPROVED BY									
		DATE									
		BY									
		APPROVED BY									
		DATE									
		BY									
		APPROVED BY									
		DATE									
		BY									
		APPROVED BY									
		DATE									
		BY									
		APPROVED BY									
		DATE									
		BY									
		APPROVED BY									
		DATE									
		BY									
		APPROVED BY									
		DATE									
		BY									
		APPROVED BY									
		DATE									
		BY									
		APPROVED BY									
		DATE									
		BY									
		APPROVED BY									
		DATE									
		BY									
		APPROVED BY									
		DATE									
		BY									
		APPROVED BY									
		DATE									
		BY									
		APPROVED BY									
		DATE									
		BY									
		APPROVED BY									
		DATE									
		BY									
		APPROVED BY									
		DATE									
		BY									
		APPROVED BY									
		DATE									
		BY									
		APPROVED BY									
		DATE									
		BY									
		APPROVED BY									
		DATE									
		BY									
		APPROVED BY									
		DATE									
		BY									
		APPROVED BY									
		DATE									
		BY									
		APPROVED BY									
		DATE									
		BY									
		APPROVED BY									
		DATE									
		BY									
		APPROVED BY									
		DATE									
		BY									
		APPROVED BY									
		DATE									
		BY									
		APPROVED BY									
		DATE									
		BY									
		APPROVED BY									
		DATE									
		BY									
		APPROVED BY									
		DATE									
		BY									
		APPROVED BY									
		DATE									
		BY									
		APPROVED BY									
		DATE									
		BY									
		APPROVED BY									
		DATE									
		BY									
		APPROVED BY									
		DATE									
		BY									
		APPROVED BY									
		DATE									
		BY									
		APPROVED BY									
		DATE									
		BY									
		APPROVED BY									
		DATE									
		BY									
		APPROVED BY									
		DATE									
		BY									
		APPROVED BY									
		DATE									
		BY									
		APPROVED BY									
		DATE									
		BY									
		APPROVED BY									
		DATE									
		BY									
		APPROVED BY									
		DATE		</							

R 41627

Proposed Corridor

Gas

Telephone Trench Only

Buried Secondary Service Cable

Buried Secondary Cable

Buried Primary Cable

SEE SHEET ABOVE FOR DETAILS OF THE PROPOSED CORRIDOR.  
PROPOSED GAS MAINS ARE SHOWN IN GREEN.

**EASEMENT LOCATIONS**

RECORDED RIGHT OF WAY NO. 41627

RECORDED RIGHT OF WAY NO. 41627