

Real Estate & Rights of Way

**Detroit  
Edison**

**Joint Underground Residential Distribution  
Right of Way Agreement**

✓ AUGUST 8, 19 88

For good and valuable consideration of system betterment, the undersigned hereby grant and convey to THE DETROIT EDISON COMPANY, a Michigan corporation, of 2000 Second Avenue, Detroit, Michigan and MICHIGAN BELL TELEPHONE COMPANY, a Michigan corporation, of 444 Michigan Avenue, Detroit, Michigan, hereinafter referred to collectively as "UTILITY", the right to erect, lay, maintain, reconstruct, add to and replace underground facilities consisting of wires, cables, conduits, fixtures and appurtenances including the necessary above ground equipment, connections, poles and required to provide communication and electric services in, under, upon, over and across the property located in the           Township           of           Ypsilanti           County of           Washtenaw           State of Michigan, and more particularly described on the attached Appendix "A"; with the full right to the UTILITIES of ingress and egress upon said property for the purposes of this grant, and the further right to trim, cut down or otherwise control brush and trees within the right of way herein described.

Said right of way shall be six (6) feet in width unless otherwise indicated and the route is described as follows:

Easements to be as shown on a drawing to be recorded after construction.

**RECORDED**

THIS INSTRUMENT IN RE-RECORDED TO SHOW AS INSTALLED DRAWING AS STIPULATED.

WASHTENAW COUNTY MI

FEB 5 10 30 AM '91

PEGGY M. HAINES  
COUNTY CLERK/REGISTER

*re-recorded*

In order to provide for the proper maintenance and protection of UTILITY, the undersigned covenant and agree that:

1. The right of way will be graded to within four inches of final grade before the UTILITY'S lines are installed and this ground elevation must be maintained after installation of utilities to avoid the pooling of water in, on or around UTILITY'S above ground equipment.
2. No buildings or structures other than UTILITY'S equipment are to be placed within the right of way herein granted. No excavation is to be permitted within said right of way without approval of UTILITY.
3. No shrubs or foliage shall be planted or grown within eight feet of the front door of transformers or switching cabinet enclosures. UTILITY shall not be responsible to owners for damages to or removal of trees or plant life planted in front of said door or within the right of way causing an interference with UTILITY'S maintenance of their equipment.
4. If the lines or facilities of UTILITY are damaged by the acts of owners, their agents, employes or contractors, repairs shall be made by the utility company so damaged at the cost and expense of owners. Owners are defined as those persons owning the property at the time the damage occurred.

THIS GRANT is declared to be binding upon the heirs, successors, lessees, licensees and assigns of the parties hereto.

IN WITNESS WHEREOF, the undersigned have hereunto set their hand(s) on the date of this agreement.

Witnesses:

✓ Eric P. Helber

ERIC P. HELBER

✓ Marilyn D. Wilbarger

MARILYN D. WILBARGER

CARPOR <sup>Grantors:</sup>  
ONE - A MICHIGAN  
LIMITED PARTNERSHIP

✓ Robert R. Helber

ROBERT R. HELBER, GENERAL  
PARTNER

Prepared by:

James M. Davenport  
425 S. Main Street  
Ann Arbor, MI 48104

Address:

3773 E. Ellsworth

Ann Arbor, MI 48104

81-11-40-352.001

RECORDED RIGHT OF WAY NO. 41470

STATE OF MICHIGAN

County of WASHTENAW (SS)

On this 9th day of AUGUST, 1988, the foregoing instrument was acknowledged before me, a notary public in and for said county, by ROBERT R. HELBER, a general/~~managing~~ partner(s), on behalf of THE CARPORT ONE a partnership.

Eric P. Helber  
Notary Public, WASHTENAW County, Michigan

My commission expires 4/11/92

ERIC P. HELBER  
Notary Public, Washtenaw County, Michigan  
My Commission Expires April 11, 1992

APPENDIX "A"

Commencing at the Southwest corner of French Claim 691, Town 3 South, Range 7 East, Ypsilanti Township, Washtenaw County, Michigan, thence South 13°10'00" East 558.34 feet along the West line of French Claim 690 and the centerline of Hewitt Road, thence North 88°32'30" West 44.44 feet to the Point of Beginning, thence continuing North 88°32'30" West 416.38 feet; thence South 01°27'30" West 567.00 feet; thence South 88°32'30" East 401.50 feet along the North right-of-way line of Ellsworth Road (43.00 feet 1/2 width); thence North 01°27'30" East 145.00 feet; thence South 88°32'30" East 125.00 feet; thence North 13°10'00" West 436.12 feet along the West right-of-way line of Hewitt Road (43.00 feet 1/2 width) to the Point of Beginning. Being a part of the Southeast 1/4 of Section 7, Town 3 South, Range 7 East.

RECORDED

WASHTENAW COUNTY MI

AUG 10 1 45 PM '88

ROBERT R. LONGWISH  
COUNTY CLERK/REGISTER

RETURN TO:  
RICHARD LONGWISH  
THE DETROIT EDISON COMPANY  
425 S. MAIN STREET, ROOM 332  
ANN ARBOR, MI 48104

RECORDED  
AUG 10 1 45 PM '88  
WASHTENAW COUNTY MI  
COUNTY CLERK/REGISTER  
ROBERT R. LONGWISH

RECORDED  
NUMB 1307  
DEED 7.00  
9333 0333003 1182 1:40PM 8/10/88

89  
→

700

Ypsilanti Twp  
French Claim 691

**Detroit  
Edison**

**DATE:** 2-19-91  
**TO:** Corporate Real Estate Services  
2310 W.C.B.  
**FROM:** James M. Davenport *JMD*  
Real Estate & Rights-of-Way  
Howell Office  
Ann Arbor Division  
**SUBJECT:** Agreement/Easement/Restrictions for underground  
residential distribution for CARPORT  
CENTER  
Located In: YPSILANTI TOWNSHIP  
County: WASHTENAW

Attached is the executed agreement dated 8-8-88  
for the above named project.

Easements for this project were requested by JAMES  
SCHALLHORN  
Service Planning Department, Ann Arbor Division.

The agreement was negotiated by James M. Davenport of the  
Real Estate and Rights-of-Way Department, Ann Arbor  
Division.

Please make the attached papers a part of the recorded  
Right-of-Way file.

**Additional Information:** \_\_\_\_\_  
\_\_\_\_\_  
\_\_\_\_\_

JMD:pg:wp  
Attachment(s)

RECORDED RIGHT OF WAY NO. 41470

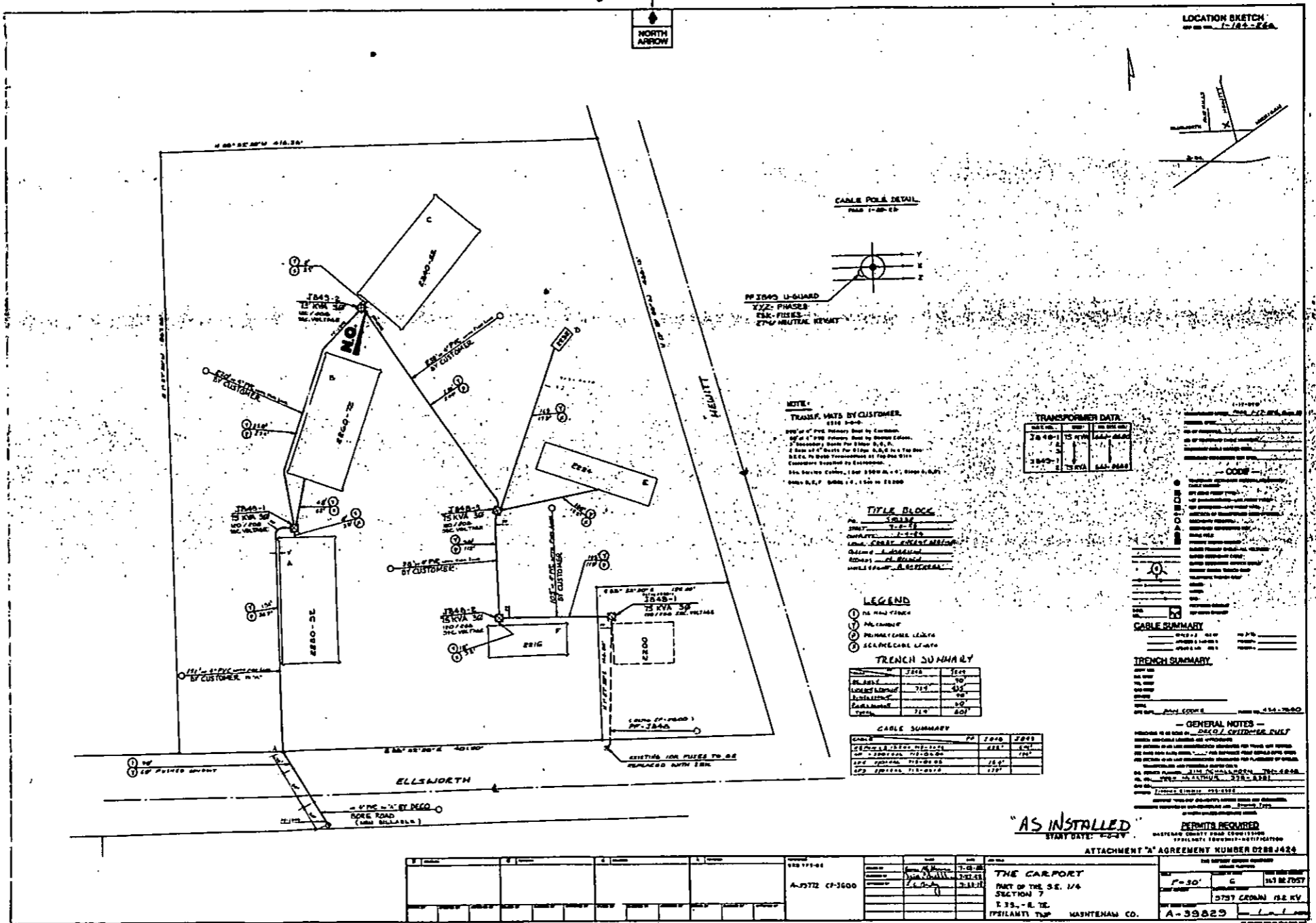

**NOTE:**  
TRANSF. DATA BY CUSTOMER.  
4800 3-0-0  
300' of 4" PVC Primary Run by Customer.  
100' of 4" PVC Secondary Run by Service Company.  
2 Secondary Runs Per House B, C, D, E, F.  
2 Run of 4" PVC For 1/2" 1/2" in the Box.  
2 Run of 4" PVC For 1/2" 1/2" in the Box.  
Customer to Supply at Top of Pole.  
See Section 244.1 for 244.1.1, 244.1.2, 244.1.3, 244.1.4, 244.1.5, 244.1.6, 244.1.7, 244.1.8, 244.1.9, 244.1.10, 244.1.11, 244.1.12, 244.1.13, 244.1.14, 244.1.15, 244.1.16, 244.1.17, 244.1.18, 244.1.19, 244.1.20, 244.1.21, 244.1.22, 244.1.23, 244.1.24, 244.1.25, 244.1.26, 244.1.27, 244.1.28, 244.1.29, 244.1.30, 244.1.31, 244.1.32, 244.1.33, 244.1.34, 244.1.35, 244.1.36, 244.1.37, 244.1.38, 244.1.39, 244.1.40, 244.1.41, 244.1.42, 244.1.43, 244.1.44, 244.1.45, 244.1.46, 244.1.47, 244.1.48, 244.1.49, 244.1.50, 244.1.51, 244.1.52, 244.1.53, 244.1.54, 244.1.55, 244.1.56, 244.1.57, 244.1.58, 244.1.59, 244.1.60, 244.1.61, 244.1.62, 244.1.63, 244.1.64, 244.1.65, 244.1.66, 244.1.67, 244.1.68, 244.1.69, 244.1.70, 244.1.71, 244.1.72, 244.1.73, 244.1.74, 244.1.75, 244.1.76, 244.1.77, 244.1.78, 244.1.79, 244.1.80, 244.1.81, 244.1.82, 244.1.83, 244.1.84, 244.1.85, 244.1.86, 244.1.87, 244.1.88, 244.1.89, 244.1.90, 244.1.91, 244.1.92, 244.1.93, 244.1.94, 244.1.95, 244.1.96, 244.1.97, 244.1.98, 244.1.99, 244.1.100.

**TRANSFORMER DATA**

TRANSFORMER NO.	KVA	PHASES	TYPE
T244-1	15	3	3
T244-2	15	3	3
T244-3	15	3	3
T244-4	15	3	3
T244-5	15	3	3
T244-6	15	3	3

**TITLE BLOCK**  
PROJECT: 7-2-12  
DRAWN BY: J. J. J.  
CHECKED BY: J. J. J.  
DATE: 7-2-12  
SCALE: AS SHOWN  
SHEET NO. 1 OF 3

**LEGEND**  
① 1/2" PVC  
② 1/2" PVC  
③ 1/2" PVC  
④ 1/2" PVC  
⑤ 1/2" PVC  
⑥ 1/2" PVC  
⑦ 1/2" PVC  
⑧ 1/2" PVC  
⑨ 1/2" PVC  
⑩ 1/2" PVC

**TRENCH SUMMARY**

ITEM	LENGTH	DEPTH	WIDTH
1. 1/2" PVC	71'	18"	12"
2. 1/2" PVC	71'	18"	12"
3. 1/2" PVC	71'	18"	12"
4. 1/2" PVC	71'	18"	12"
5. 1/2" PVC	71'	18"	12"
6. 1/2" PVC	71'	18"	12"
7. 1/2" PVC	71'	18"	12"
8. 1/2" PVC	71'	18"	12"
9. 1/2" PVC	71'	18"	12"
10. 1/2" PVC	71'	18"	12"

**CABLE SUMMARY**

CABLE	TYPE	SIZE	LENGTH
1. 1/2" PVC	1/2"	1/2"	71'
2. 1/2" PVC	1/2"	1/2"	71'
3. 1/2" PVC	1/2"	1/2"	71'
4. 1/2" PVC	1/2"	1/2"	71'
5. 1/2" PVC	1/2"	1/2"	71'
6. 1/2" PVC	1/2"	1/2"	71'
7. 1/2" PVC	1/2"	1/2"	71'
8. 1/2" PVC	1/2"	1/2"	71'
9. 1/2" PVC	1/2"	1/2"	71'
10. 1/2" PVC	1/2"	1/2"	71'

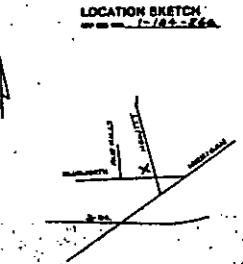

**"AS INSTALLED"**  
START DATE: 7-2-12  
ATTACHMENT "A" AGREEMENT NUMBER 0288 J424

PROJECT NO.	A-3772 CP-3600	CITY	THE CARPORT
ADDRESS	1/4 SECTION 7	SECTION	7
TOWNSHIP	R. 35., - E. 12.	COUNTY	WASHTENAW CO.
DATE	7-2-12	SCALE	AS SHOWN
DRAWN BY	J. J. J.	CHECKED BY	J. J. J.
PERMITS REQUIRED	YES	NO	NO
START DATE	7-2-12	END DATE	7-2-12
ATTACHMENT "A" AGREEMENT NUMBER	0288 J424	SCALE	AS SHOWN
PROJECT NO.	A-3772 CP-3600	CITY	THE CARPORT
ADDRESS	1/4 SECTION 7	SECTION	7
TOWNSHIP	R. 35., - E. 12.	COUNTY	WASHTENAW CO.
DATE	7-2-12	SCALE	AS SHOWN
DRAWN BY	J. J. J.	CHECKED BY	J. J. J.
PERMITS REQUIRED	YES	NO	NO
START DATE	7-2-12	END DATE	7-2-12
ATTACHMENT "A" AGREEMENT NUMBER	0288 J424	SCALE	AS SHOWN

RECORDED - RIGHT OF WAY NO. 44470

2000

RECORDED

WASHTENAW COUNTY MI

FEB 5 10 30 AM '91

PEGGY M. HAINES  
COUNTY CLERK/REGISTER

DEED 11.00  
R333 0333003 0208 10:22AM 2/05/91

SSRF 2.00  
R333 0333003 0208 10:22AM 2/05/91

*After*

*Do Directed*

*[Handwritten mark]*

RETURN TO:  
RICHARD LONGWISH  
THE DETROIT EDISON COMPANY  
425 S. MAIN STREET, ROOM 332  
ANN ARBOR, MI 48104