

Acknowledgement-Individual

STATE OF MICHIGAN
County of OAKLAND)SS

On this 30th day of November, 19 90, the foregoing instrument was acknowledged before me, a notary public in and for said county, by James M. Harless and Margaret R.M. Harless, his wife

Alison G. Workman
Notary Public, Oakland County, Michigan
ALISON G. WORKMAN
Notary Public, Oakland County, MI
My Commission Expires Oct. 30, 1991

My commission expires 10/30/91

Acknowledgement-Individual

STATE OF MICHIGAN
County of Washtenaw)SS

On this _____ day of _____, 19 90, the foregoing instrument was acknowledged before me, a notary public in and for said county, by Otto J. Mahnke and Lieselotte M. Mahnke, his wife

Notary Public, _____ County, Michigan

My commission expires _____

RECORDED
WASHTENAW COUNTY MI
Dec 13 9 54 AM '90
PEGGY M. HAINES
COUNTY CLERK/REGISTER

Detroit Edison Co

DEED 7.00
8333 0333003 7654 9:50AM 12/13/90

191

To (Supervisor, RE & R/W) DICK LONGWISH	For RE & R/W Dept. Use	Date Received	DE/Bell/C.P. No.
Division ANN ARBOR	Date 9-28-90	Application No. HS 4221 -R1	

We have included the following necessary material and information:

Material:

- A. Proposed Subdivision
 1. copy of complete final proposed plat - All pages
 or
 B. Other than proposed subdivision (condo., apts. mobile home or other)
 1. Property description.
 2. Site plan.
 3. title information (deed, title commitment, contract with title commitment, or title search).

REPORT OF REAL ESTATE AND RIGHTS OF WAY DEPARTMENT RAW SECURED AS INDICATED ON THIS SKETCH BY Richard Longwish DATE 12-21-90 DATE WANTED _____ DISTRICT Richard Longwish FIELDMAN _____	PERMITS TO: RECORD CENTER <u>2</u> R/W FILES <u>3</u> MBT <u>2</u> ORIGINATOR <u>2</u> TOTAL <u>3</u>
---	--

Note: Do not submit application for URD easements until all above material has been acquired.

Information

1. Project Name HARLESS RESIDENCE	County WASHTENAW
City/Township/Village WEBSTER TWP.	Section No. 9

Type of Development
 Proposed Subdivision Apartment Complex Condominium
 Subdivision Mobile Home Park Other

2. Name of Owner JAMES M. & MARGARET R. M. HARLESS	Phone No. (313) 662-1477 (313) 454-1100
--	--

Address
531 W. DELHI RD. ANN ARBOR MI. 48103

Owner's Representative JERRY JANIGA	Phone No. (313) 878-0177
---	---------------------------------

Date Service is Wanted
NOV. 1990

4. Entire Project will be developed at one time Yes No

5. Joint easements required — Michigan Bell Telephone **FJU MEMO # H-434-0** Yes No
 — Consumers Power Yes No
 — **MULTI CABLEVISION FJU MEMO # H-433-0** Yes No

a. Name of Other Utilities If Not Michigan Bell Telephone or Consumers Power

b. Other Utility Engineer Names MBT: JERRY DOTEM - A2 CATV: DAN BACKUS - MULTI - CABLEVISION	Phone Numbers (313) 996-5351 (313) 231-1872
--	--

6. Additional Information or Comments
OWNER OF PARCEL "D" IS LEAVING FOR FLORIDA IN 25 DAYS - PROBABLY BETTER IF WE HAVE HARLESS OBTAIN SIGNATURES

Note: Trenching letter attached will be submitted later

Service Planner Phil Capling	Signed (Service Planning Supervisor) OCT 02 1990 J. C. BAILEY
Phone No. 185-3307	Address HOWELL SPR CTR.

RECORDED RIGHT OF WAY NO. 41454 & 41453

RAW NOTE

PLEASE OBTAIN A RECORDED
15' WIDE EASEMENT FOR UNDERGROUND
ELECTRIC LINES AS INDICATED
ON SKETCH

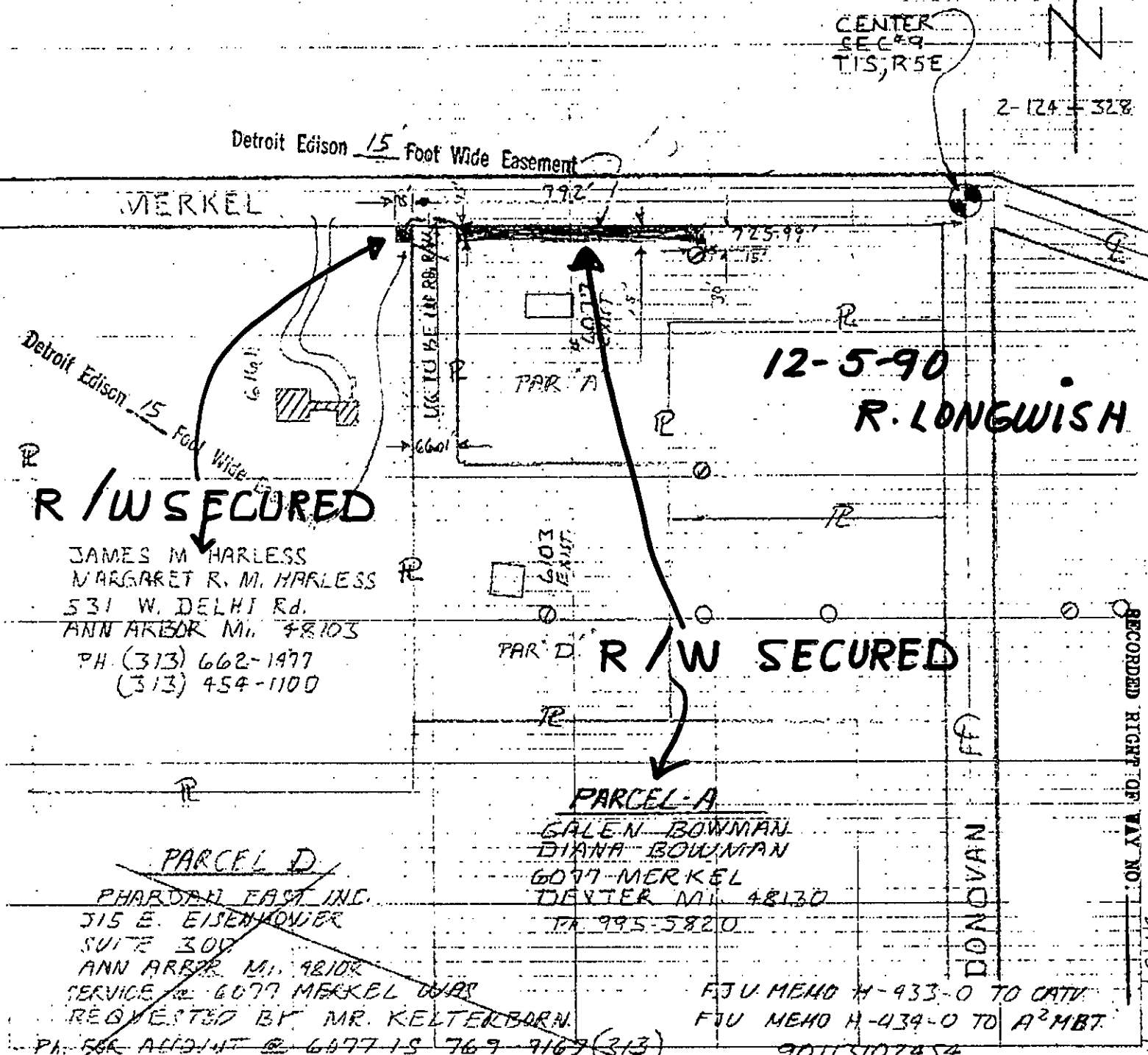

R / W SECURED
 JAMES M HARLESS
 MARGARET R. M. HARLESS
 531 W. DELHI Rd.
 ANN ARBOR MI 48103
 PH. (313) 662-1977
 (313) 454-1100

R / W SECURED

PARCEL A
 GALEN BOWMAN
 DIANA BOWMAN
 6077 MERKEL
 DEXTER MI 48130
 TR 995-5820

~~**PARCEL D**~~
~~PHAROLD EAST INC.
 315 E. EISENHOWER
 SUITE 300
 ANN ARBOR MI 48106
 SERVICE TO 6077 MERKEL WAS
 REQUESTED BY MR. KELTERBORN.
 PH. FOR ALIQUOT @ 6077 IS 769 9167 (313)~~

FJV MEMO H-433-0 TO CATV
 FJV MEMO H-434-0 TO A²MBT
 90113102454

RECORDED RIGHT OF WAY NO. 11457-41455

LEGEND	
	FOREIGN POLE
	EXIST D.E. CO. POLE
	PROPOSED POLE
	EXIST ANCHOR
	PROPOSED ANCHOR
	TREE
	120/240 VOLT LINE
	4800 VOLT LINE
	13,200 VOLT LINE
	40,000 VOLT LINE

THE DETROIT EDISON COMPANY-SERVICE PLANNING DEPARTMENT			
CITY OR TOWNSHIP WEBSTER	COUNTY WASHTENAW	GR- & TWP. SECT. NO. 9	DEPT. ORDER NO.
MAP SECT. 2-124-328	TOWN 15	RANGE 5E	JOINT R/W REQUIRED YES <input type="checkbox"/> NO <input checked="" type="checkbox"/>
PROJECT NAME HARLESS RESIDENCE	TEL. ENGR & DIST.	PROJ. OR PART NO.	DATE 7/5-4-22-90
CIRCUIT DC 8080 WHITMORE LK 4.8 KV	REASON PROVIDE SERVICE TO NEW HOUSE	BUDGET ITEM NO. OMJDA-MAJ	DATE 71-7-90
PLANNER P. CAPLING	SCALE 1" = 200'	DATE	DATE