

Detroit Edison

Real Estate and Rights of Way

**Joint Underground Residential Distribution
Right of Way Agreement**

Nov. 29, 1988

For good and valuable consideration of system betterment, the undersigned hereby grant and convey to THE DETROIT EDISON COMPANY, a Michigan corporation of 2000 Second Avenue, Detroit, Michigan, MICHIGAN BELL TELEPHONE COMPANY, a Michigan corporation of 444 Michigan Avenue, Detroit, Michigan and COLUMBIA CABLE OF MICHIGAN, a Michigan Partnership ~~corporation~~ of P. O. Box 998, Ann Arbor, Michigan hereinafter referred to collectively as "GRANTEE", the right to erect, lay, maintain, reconstruct, add to and replace underground facilities consisting of wires, cables, conduits, fixtures and appurtenances including the necessary above ground equipment, connections, poles and accessories required in, under, upon, over and across the property located in the City of Ann Arbor, County of Washtenaw State of Michigan, and more particularly described on the attached Appendix "A"; with the full right to the GRANTEE of ingress and egress upon said property for the purposes of this grant, and the further right to trim, cut down or otherwise control brush and trees within the right of way herein described.

Said right of way shall be 12 feet in width unless otherwise indicated and the route is described as follows:

Easement to be as shown on a Drawing to be recorded ~~after construction.~~

EASEMENTS IN ACCORDANCE WITH DETROIT EDISON DRAWING A-39955.

RECORDED
WASHTENAW COUNTY MI
FEB 5 10 30 AM '91
PEGGY M. HAINES
COUNTY CLERK/REGISTER

RECORDED RIGHT OF WAY NO. 41141

In order to provide for the proper maintenance and protection of GRANTEE, the undersigned covenant and agree that:

1. The right of way will be graded to within four inches of final grade before the GRANTEE'S lines are installed and this ground elevation must be maintained after installation of utilities to avoid the pooling of water in, on or around GRANTEE'S above ground equipment.
2. No buildings or structures other than GRANTEE'S equipment are to be placed within the right of way herein granted. No excavation is to be permitted within said right of way without approval of GRANTEE.
3. No shrubs or foliage shall be planted or grown within eight feet of the front door of transformers or switching cabinet enclosures. GRANTEE shall not be responsible to owners for damages to or removal of trees or plant life planted in front of said door or within the right of way causing an interference with GRANTEE'S maintenance of their equipment.
4. If the lines or facilities of GRANTEE are damaged by the acts of owners, their agents, employes or contractors, repairs shall be made by the granting company so damaged at the cost and expense of owners. Owners are defined as those persons owning the property at the time the damage occurred.

THIS GRANT is declared to be binding upon the heirs, successors, lessees, licensees and assigns of the parties hereto.

IN WITNESS WHEREOF, the undersigned have hereunto set their hand(s) on the date of this agreement.

Witnesses:

Grantors:

Ruth Josko
RUTH JOSKO
George Honicky
GEORGE HONICKY

SIGNATURE VILLAS PARTNERSHIP,
A Michigan Co-Partnership
James F. Hurlbert, Jr.
JAMES F. HURLBERT, JR., General Partner
Leo R. Tostio
LEO R. TOSTIO, General Partner

Prepared by:
Curtis G. Noles
2000 Second Avenue
Detroit, MI 48226

Address:
17400 W. 13 Mile Road
Birmingham, MI 48009

Acknowledgement-Partnership

STATE OF MICHIGAN

County of OAKLAND)SS

On this 29th day of Nov., 19 88, the foregoing instrument was acknowledged before me, a notary public in and for said county, by JAMES F. HURLBERT, JR. and LEO R. TOSTO

(a) general/~~managing~~ partner(s), on behalf of SIGNATURE VILLAS PARTNERSHIP A Michigan Co - partnership.

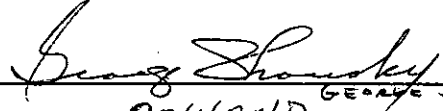
Notary Public, OAKLAND County, Michigan

My commission expires 1-3-90

DE 963-4181 9-86 CS

A P P E N D I X " A "

Commencing at the N 1/4 corner of Section 8, T3S, R6E, Pittsfield Township, Washtenaw County, Michigan; thence S 86°38'10" W 679.67 feet along the North line of said Section; thence S 0°50'20" E 642.16 feet for a PLACE OF BEGINNING; thence S 0°56'50" E 929.69 feet; thence S 86°38'10" W 721.09 feet; thence along the Northeasterly line of I-94 Expressway (limited access) along the following three courses, along the arc of a circular curve to the right radius 3694.83 feet, chord N 48°47'30" W 464.78 feet, N 45°11'10" W 287.91 feet and N 42°13' W 498.39 feet; thence N 86°38'10" E 915.17 feet; thence N 0°44' W 642.21 feet; thence along the North line of said Section and the centerline of Waters Road, N 86°38'10" E 3.57 feet; thence along the South line of Eisenhower Parkway along the arc of a circular curve to the left, radius 1793.86 feet, chord S 76°56' E 318.00 feet; thence S 0°50'20" E 552.13 feet; thence N 86°38'10" E 367.12 feet to the Place of Beginning, being a part of the Northwest 1/4 of said Section 8.

Detroit
Edison

DATE: 2-19-91

TO: Corporate Real Estate Services
2310 W.C.B.

FROM: James M. Davenport *JMD*
Real Estate & Rights-of-Way
Howell Office
Ann Arbor Division

SUBJECT: Agreement/Easement/Restrictions for underground
residential distribution for SIGNATURE
VILLAS APTS
Located In: CITY OF ANN ARBOR
County: WASHTENAW

RECORDED RIGHT OF WAY NO. 41411

Attached is the executed agreement dated 11-29-88
for the above named project.

Easements for this project were requested by H. COLE
Service Planning Department, Ann Arbor Division.

The agreement was negotiated by James M. Davenport of the
Real Estate and Rights-of-Way Department, Ann Arbor
Division.

Please make the attached papers a part of the recorded
Right-of-Way file.

Additional Information: _____

JMD:pg:wp

Attachment(s)

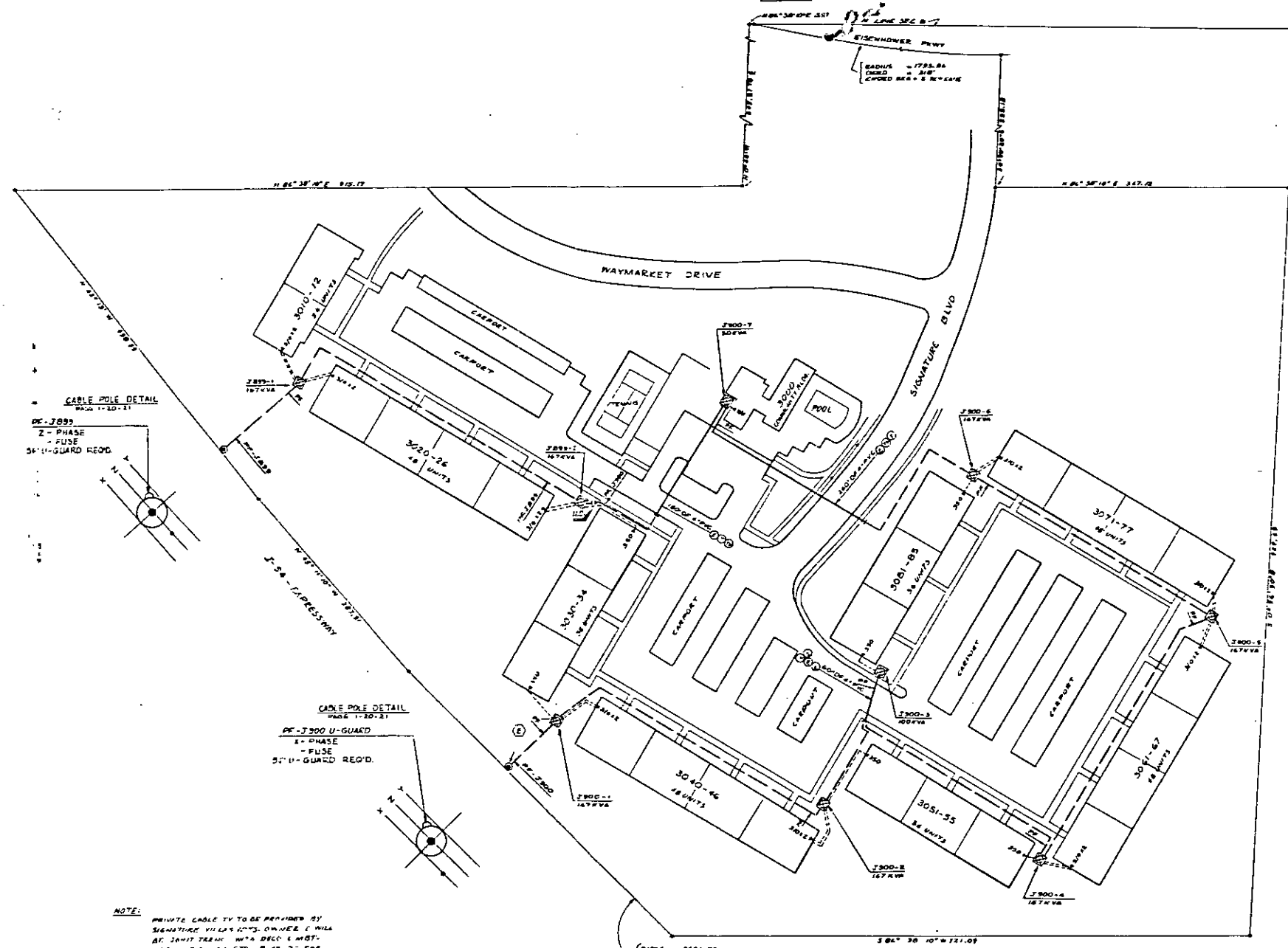
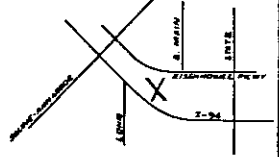

CABLE POLE DETAIL
PAGE 1-20-21

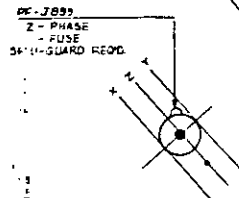

CABLE POLE DETAIL
PAGE 1-20-21

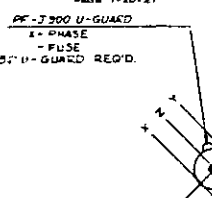

NOTE: PRINTED CABLE TO BE PROVIDED BY SIGNATURE VILLAGES. OWNER WILL BE JAHIT TRAIL WITH DEC 1 WBT. SEE LINT CONSL STD. P. 47-26 FOR TYPICAL SPECS.

RADIUS = 3690.83
REL = 224.78
DELTA =
CHORD = 4448.87-3074

NOTE: CONDUIT FOR EACH ROAD CROSSING PROVIDED BY APPLICANT. UTILITIES INSTALLED BY CUSTOMER (NON-BILLABLE)

TRANSFORMER DATA

UNIT NO	SIZE	ED BY NO
J899-1	167 KVA	661-1124
-2	167 KVA	661-1124
J900-1	167 KVA	661-1124
-2	167 KVA	661-1124
-3	167 KVA	661-1124
-4	167 KVA	661-1124
-5	167 KVA	661-1124
-6	167 KVA	661-1124
-7	167 KVA	661-1124

TRANSFORMER SPEC: J-17-881, 1-126-11
 FEDERAL SPEC:
 NO. OF FEEDERS:
 NO. OF TEMPORARY CABLE MARKERS:
 TEMPORARY CABLE MARKER SPEC:
 SECONDARY CONNECTION BOX SPEC:

— CODE —

- TEMPORARY SECONDARY FEEDER/TEMPORARY CABLE MARKER
- SET BACK FRONT YARD
- SET BACK SIDEYARD-LINE FRONT YARD
- SET BACK SIDEYARD-LINE REAR YARD
- DIRECTION OF TRANSFORMER DEEP COILING
- SECONDARY FEEDER
- SECONDARY CONNECTION BOX
- CABLE POLE
- PRIMARY SWITCH CABINET
- SECONDARY CABLE-ALL VOLTAGES
- SECONDARY CABLE
- SECONDARY SERVICE CABLE
- DETROIT EDISON TRENCH ONLY
- TELEPHONE TRENCH ONLY
- WATER
- GAS
- UNIDENTIFIED CONDUIT
- NEW CONDUIT

CABLE SUMMARY

CONDUCTOR	167 KVA	70777	355000
APRIL 1 1/2"	167 KVA	70777	355000
APRIL 1 1/2"	167 KVA	70777	355000
APRIL 1 1/2"	167 KVA	70777	355000

TRENCH SUMMARY

CONDUCTOR	2700 FT
TEL ONLY	220 FT
GAS ONLY	
OTHER	

— GENERAL NOTES —

- TRENCHES TO BE DONE BY DETROIT EDISON
- TRENCH AND CABLE LENGTHS ARE APPROXIMATE
- SEE SECTION 16.05 FOR CONSTRUCTION STANDARDS FOR TRUNK LINE DETAILS
- SEE SECTION 16.05 FOR CONSTRUCTION STANDARDS FOR TRUNK LINE DETAILS
- SEE SECTION 16.05 FOR CONSTRUCTION STANDARDS FOR TRUNK LINE DETAILS
- TRANSFORMERS AND FEEDERS DATA
- SEE DRAWING NUMBER: 13-13-13
- DATE: 10/13/09
- SCALE: AS SHOWN
- OTHER:

PERMITS REQUIRED

CITY OF ANN ARBOR-NOTIFICATION

START DATE: SEPT 13, 09

ATTACHMENT "A" AGREEMENT NUMBER D488J667

D	C	B	A	DATE	BY	APP. TITLE
				10/13/09	J. J. SPOURLOCK	PROJECT ENGINEER
				10/13/09	J. J. SPOURLOCK	PROJECT ENGINEER
				10/13/09	J. J. SPOURLOCK	PROJECT ENGINEER

PROJECT: SIGNATURE VILLAGES APTS. PART OF THE NW 1/4 SECTION 8 T35 - R6 E

CITY OF ANN ARBOR WASHINGTON CO. A-39955

THE DETROIT EDISON COMPANY

1" = 50'

324 36782749

MI 48106

BIUS STATE 13.2KV

RECORDED RIGHT OF WAY NO. 41411

2000

RECORDED

WASHTENAW COUNTY MI

FEB 5 10 30 AM '91

PEGGY M. HAINES
COUNTY CLERK/REGISTER

By Order
As directed

NUMB 306
DEED
8333 0333003 0208 10:21AM 2/05/91
11.00

SSRF
8333 0333003 0208 10:21AM 2/05/91
2.00

RETURN TO:
RICHARD LONGWISH
THE DETROIT EDISON COMPANY
425 S. MAIN STREET, ROOM 332
ANN ARBOR, MI 48104