

Date: October 4, 1990
To: Records Center
From: Michael J. McCabe *MJM*
Sr. Real Estate and Rights of Way Representative
Macomb Division
Subject: Right of Way Agreement for Underground Residential
Distribution for Regency Club Apartments, Phase 2,
located in part of the Southeast 1/4 of the Northeast
1/4 of Section 24, Town 1 North, Range 12 East, City of
Warren, Macomb County, Michigan

Attached for Records Center is the executed Right of Way Agreement, dated February 20, 1989, and other pertinent papers for the above named project.

Easement for this project was requested by William Hertz, Service Planner, Macomb Division. The Agreement was negotiated by Michael J. McCabe, Representative of Real Estate and Rights of Way, Macomb Division.

Detroit Edison Company, Consumers Power Company and Michigan Bell Telephone Company made this agreement with T. G. Warren, Inc., Michael E. Tobin, President the developers of Regency Club Apartments, Phase 2.

Please make the attached papers a part of recorded Rights of Way file.

MJM/caw

Attachment

RECORDED PROJECT OF WAY NO. 40910

LIBER 04958PG360

LIBER 04958PG361

LOCATION SKETCH
MAP SEC. NO.

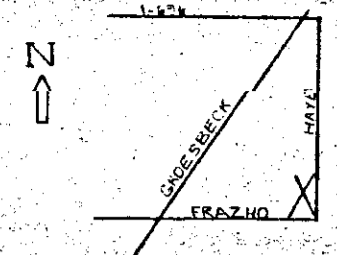

LIBER 04958PG361 A

019010

RECORDED RIGHT OF WAY
R40910

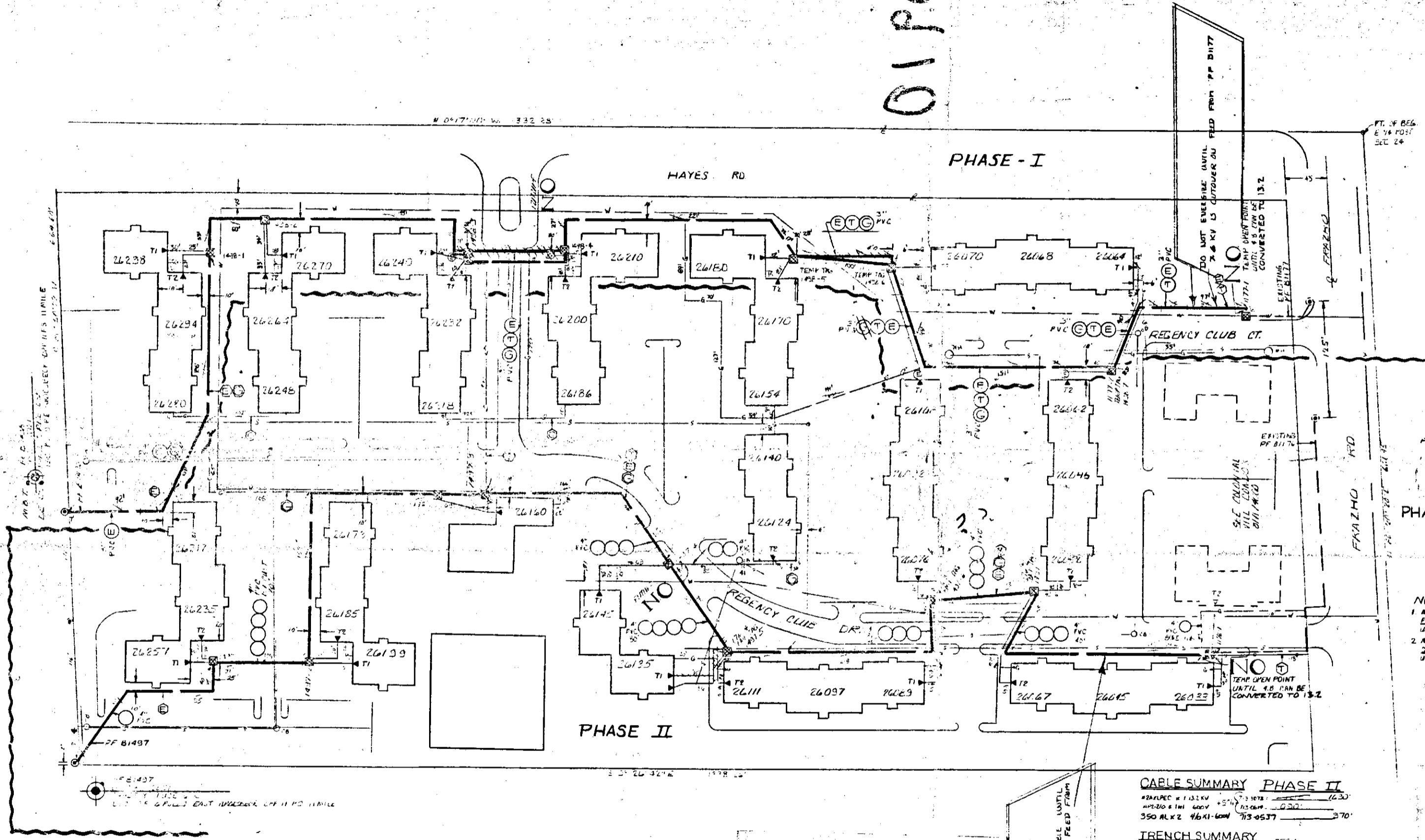

TRANSFORMER DATA

PHASE	U.D. NO.	SIZE	ED. STK. NO.
PHASE I	1478-1	120	661-1153
	1	100	1153
	2	100	1153
	3	100	1153
	4	100	1153
	5	100	1153
	7	100	1153
PHASE II	1457-1	100	1153
	2	100	1153
	3	50	1153
	4	100	1153
	5	100	1153
	6	100	1153
	7	100	1153

TRANSFORMER SPECS: 117-224
 PEDESTAL AMOUNT: 3 SPEC.
 TEMPORARY CABLE MARKERS AMOUNT: 3 SPEC.
 SECONDARY CONNECTION BOX AMOUNT: 3 SPEC.

- CODE**
- ⊙ TEMPORARY SECONDARY PEDESTAL/TEMPORARY CABLE MARKER
 - ⊠ DFT (DEAD FRONT TYPE)
 - ⊡ DFT (NON-SWITCHING—LIVE FRONT TYPE)
 - ⊢ DFT (SWITCHING—LIVE FRONT TYPE)
 - DIRECTION OF TRANSFORMER DOOR OPENING
 - ⊙ SECONDARY PEDESTAL
 - ⊡ SECONDARY CONNECTION BOX
 - ⊠ CABLE POLE
 - ⊡ PRIMARY SWITCH CABINET
 - ⊠ BURIED PRIMARY CABLE—ALL VOLTAGES
 - ⊡ BURIED SECONDARY CABLE
 - ⊡ SECONDARY SERVICE CABLE
 - ⊠ DETROIT EDISON TRENCH ONLY
 - ⊡ TELEPHONE TRENCH ONLY
 - ⊠ SEWER
 - ⊡ WATER
 - ⊠ GAS
 - ⊡ PROPOSED CONDUIT
 - ⊠ SEP. CONN. CABINET

NOTES APPLY TO PHASE I & II
 1. ALL SECONDARY CABLES TO BE 1153 AND TO BE PLACED IN TRENCHES OF 350MM DIA. IN 115-0537 UNLESS OTHERWISE NOTED.
 2. ALL SECONDARY CABLES TO BE 1153 AND TO BE PLACED IN TRENCHES OF 350MM DIA. IN 115-0537 UNLESS OTHERWISE NOTED.

NOTE:
 METER SHALL BE LOCATED IN SHADED AREA CLOSEST TO D.E.D. SOURCE.
 DWELLING

INSTALLED CABLE SUMMARY

ITEM #	QUANTITY	ESTIMATED
AP230M x 1-132 KV	713-036	713-036
AP230M x 1-40 800 V.	713-037	713-037
AP230 & 1-41 800 V.	713-038	713-038

TRENCH SUMMARY

JOINT USE	DE ONLY	TEL ONLY	GAS ONLY	OTHERS	TOTAL
7577	202	366	505	186	2186

CABLE SUMMARY PHASE II

#24ALPEC x 1153KV	1230
#24ALPEC x 140 800V	1230
350 ALX2 46A1-60W 73-0537	370

TRENCH SUMMARY

DE ONLY	TEL ONLY	GAS ONLY	OTHERS	TOTAL
202	366	505	186	2186

NOTICE
 Locations of underground facilities on this drawing are only approximate. Exact locations must be determined by the UTILITY COMPANIES. For exact locations, telephone MISS DIG on 800-482-7171 as required by Public Act 53 of 1974 before doing any power excavating.

GENERAL NOTES
 TRENCHING TO BE DONE BY...
 TRENCH AND CABLE LENGTHS ARE APPROXIMATE.
 SEE SECTION 28 US LINE CONSTRUCTION STANDARDS FOR TRANS. MAT. DETAILS.
 SEE PAGE 32-11 (S.I.M.) DETAIL... FOR ENTRANCE POINT DETAILS (A.P.T.S. ONLY).
 SEE SECTION 43 US LINE CONSTRUCTION STANDARDS FOR PLACEMENT OF CABLES.
 TRANSFORMERS AND PEDESTALS (S.B. DS ONLY)
 D.E. SERVICE PLANNER: M. CHILDS 286-9423
 TEL. CO.: DETROIT EDISON CO. 286-8253
 GAS CO.: C. VERDON 858-2222 EXT. 410
 CITY: C. VERDON 743-3440

PERMITS REQUIRED
 START DATE: _____
 CITY OF: _____ COUNTY: _____ NOTIFICATION TO: _____
 STATE: _____ YES NO

PHASE II TITLE BLOCK
 D.D. 57473672
 W.D. 36789720
 START 5-1-87
 FINISH 5-12-87
 TECH. P. OSBORNE
 LABOR UNION ELEC. CO.
 SPLICING HAYLAN
 SUPRV. P. LARON
 RECORDS P. WELCH

TITLE BLOCK PH I
 D.D. 57473672
 W.D. 36789720
 START 5-1-87
 FINISH 5-12-87
 TECH. P. OSBORNE
 LABOR UNION ELEC. CO.
 SPLICING HAYLAN
 SUPRV. P. LARON
 RECORDS P. WELCH

APPENDIX B

LIBER 04958PG362

LIBER 04958PG362 A

D	REVISION	C	REVISION	B	REVISION	A	REVISION	REFERENCE
			SHOWN AS INSTALLED IN FIELD PHASE II		SHOWN AS INSTALLED IN FIELD PHASE I		REVISED TO SHOW PHASE II	
DRAWN BY	CHECKED BY	APPROVED BY	DRAWN BY	CHECKED BY	APPROVED BY	DRAWN BY	CHECKED BY	APPROVED BY

THE DETROIT EDISON COMPANY SERVICE PLANNING

SCALE: 1" = 50'
 NUMBER OF UNITS: 320 PH I
 LATEST REVISION: C
 DISTRIBUTION CIRCUIT: C-14
 SHEET: 1 OF 1 SHEETS

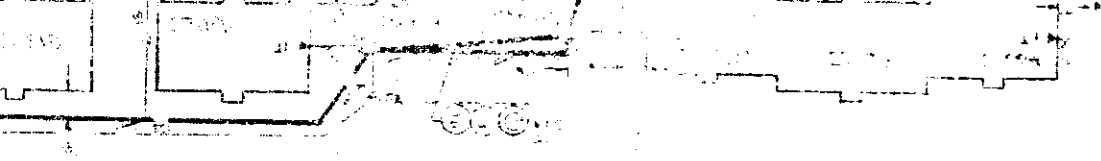

1948

PHASE - I

REGISTERED
IN THE
OFFICE OF THE
REGISTERED
DEEDS
AND
MORTGAGES
OF THE
STATE OF
MISSISSIPPI
ON
MAY 15 1955
AT
MEMPHIS
MISSISSIPPI

B-10
RECORDED

R40910

RECORDED RIGHT OF WAY NO. 40910

4
1955
MAY 15