

APPLICATION FOR RIGHT OF WAY

DE 963-0811 5-7455 (MS 80)

Handwritten: Feeing up 5/23/89

PLEASE SECURE RIGHT OF WAY AS FOLLOWS:

DATE August 17, 1989

LOCATION 15 Mile Road & Mound

APPLICATION NO. MC-K050

CITY OR VILLAGE Sterling Heights

DEPT. ORDER NO. _____

TOWNSHIP _____ COUNTY Macomb

O. F. W. NO. _____

DATE BY WHICH RIGHT OF WAY IS WANTED 8-25-89

BUDGET ITEM NO. _____

THIS R/W IS 100 % OF TOTAL PROJECT NO. _____ ACCUM. _____ %.

INQUIRY NO. _____

JOINT RIGHT OF WAY REQUIRED YES NO

NOTE: Identify on print or sketch the subdivisions as to section location and liber and page.

KIND AND DESCRIPTION OF RIGHT OF WAY REQUESTED Six ft. easement - 3 ft. on either side of Detroit Edison cable and conduit

RECORDED RIGHT OF WAY NO.

PURPOSE OF RIGHT OF WAY Provide service to 5702 thru 5770 15 Mile Road - new retail shopping center

Handwritten: 40165

SIGNED *George A. Rinaldi*
George A. Rinaldi, Supervisor
Mt. Clemens OFFICE Service Planning DEPARTMENT LS/JK

REPORT OF REAL ESTATE AND RIGHTS OF WAY DEPT.

Handwritten: R/W secured as requested.

PERMITS IN RECORD CENTER 1 R.E. & R/W DEPT. FILE 1 GRANTOR 1

NO. OF PERMITS 1 NO. OF STRUCTURES _____ NO. OF MILES _____ PERMITS TO MBT 1

DATE 12/21/89 SIGNED *Michael J. Wilke*

NOV 20, 19 89

For good and valuable consideration of system betterment, the undersigned hereby grant and convey to THE DETROIT EDISON COMPANY, a Michigan corporation of 2000 Second Avenue, Detroit, Michigan hereinafter referred to as "EDISON," the right to construct, reconstruct, modify, add to, operate and maintain underground line facilities consisting of poles, conduits, wires, cables, manholes, transformers and accessories required to provide electric service in, under, upon and across property located in the City of Sterling Heights, County of Macomb, State of Michigan, further described as:

Part of the NE¼, Beginning at a point which is N89°57'00" W 102.01 ft. along the North line of Section 32 and S00°45'20" W 60.00 feet from the the NE corner of Section 32, T2N, R12E,; thence S00°45'20" W 300.46 feet along the line which is parallel to and 102.00 feet West of the East line of Section 32; thence N89°56'00" W 558.00 feet; thence N00°45'20" E 96.48 feet; thence N89°57'00" W 112.49 feet; thence N01°24'19" E 203.86 feet thence S89°57'00" E 668.18 feet along a line which is parallel to and 60.00 feet South of the North line of Section 32 to the point of beginnig.

RECORDED IN MACOMB COUNTY
RECORDS AT: 1:23 P M.

DEC 12 1989

Edna Hill
CLERK - REGISTER OF DEEDS
MACOMB COUNTY, MICHIGAN

as shown on the attached drawing MC-K050 which is made a part hereof.

The right of way is six (6) feet in width.

The rights hereby granted include the right of access to and from the rights of way and the right to trim, cut down or otherwise control trees, brush or roots of any kind either within the right of way or on property adjoining the right of way which in the opinion of EDISON interferes with the construction or operation of the line facilities. It is expressly understood and agreed that EDISON shall, at no time, trim or cut down any trees unless, in EDISON'S opinion, it is absolutely necessary to do so. EDISON shall restore premises to its original condition or as near as can be in the event of damages caused by its employes, contractors, vehicles and equipment entering premises for the purposes set forth herein.

No buildings or structures are to be placed within said right of way herein granted without the written consent of EDISON.

This grant is declared to be binding upon the heirs, successors, lessees, licensees and assigns of the parties hereto.

IN WITNESS WHEREOF the undersigned have hereunto set their hand(s) on the date of this agreement.

Witnesses:

John Sheerin
JOHN SHEERIN

Jeanette J. Morrison
JEANETTE J. MORRISON
Jeanette J. Morrison

Grantors:

MIDWEST DEVELOPMENT, INC., A Michigan Corp.

Thomas L. Morris
Thomas L. Morris (1st President)

Land Contract Holder
Bragoje Djurovski
Bragoje Djurovski Owner a single man

Krsto Djordjevic
Krsto Djordjevic Owner a single man

35219 Dodge Park Rd. Sterling Heights, MI

Address:

764 Dressler
Rochester, MI 48093

Prepared by: and Return To:

Susan A. Putrycus
15600 Nineteen Mile
Mt. Clemens, MI 48044

APPROVED AS TO FORM 11/29/89 DATE

LEGAL DEPARTMENT *[Signature]*

RECORDED RIGHT OF WAY NO. 40165

Acknowledgement-Individual

STATE OF MICHIGAN

County of MACOMB)SS

On this 2 day of NOV, 19 89, the foregoing instrument was acknowledged before me, a notary public in and for said county, by KRISTO DZONDERICH, a single man

Walter J. Groesbeck
Walter J. Groesbeck
Notary Public, Oakland County, Michigan
acting in Macomb

My commission expires 12-8-90

Acknowledgement-Individual

STATE OF MICHIGAN

County of MACOMB)SS

On this 2 day of NOV, 19 89, the foregoing instrument was acknowledged before me, a notary public in and for said county, by Blazeyir J. Jurovski, a single man

Walter J. Groesbeck
Walter J. Groesbeck
Notary Public, Oakland County, Michigan
acting in Macomb

My commission expires 12-8-90

RECORDED RIGHT OF WAY NO. 40165

Acknowledgement-Corporation

STATE OF MICHIGAN

County of MICHIGAN)SS

On this 2 day of NOV, 19 89, the foregoing instrument was acknowledged before me, a notary public in and for said county, by John J. Mann
whose title(s) is/are President
of Midwest Development, Inc., a Michigan corporation, on behalf of the corporation.

Walter J. Groesbeck
Walter J. Groesbeck
Notary Public, Oakland County, Michigan
acting in Macomb

My commission expires 12-8-90

Acknowledgement-Partnership

STATE OF MICHIGAN

County of _____)SS

On this _____ day of _____, 19____, the foregoing instrument was acknowledged before me, a notary public in and for said county, by _____
(a) general/managing partner(s), on behalf of _____ a partnership.

Notary Public, _____ County, Michigan

My commission expires _____



LIBER 04780PG934

15 MILE RD

NE Cor
65 SECT 32

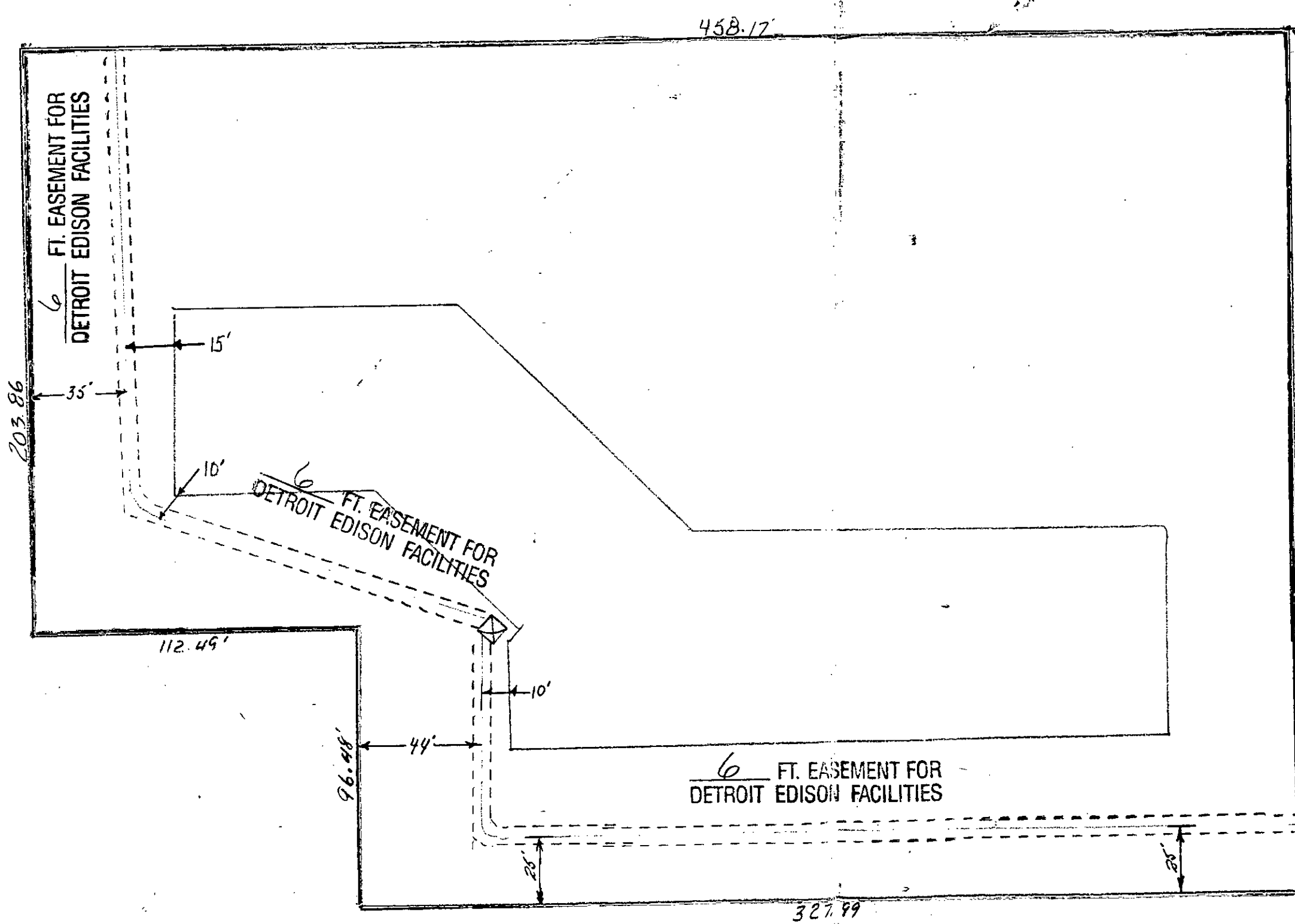

LIBER 04780PG935

MOUND RD

A PARCEL OF LAND
IN THE NE 1/4 OF SECT 32,
T24 R12E STERLING HTS.,
MICH. MACOMB CO.

RECORDED RIGHT OF WAY NO. 40165

REPORT OF PROPERTIES AND RIGHTS OF WAY DEPARTMENT R/W SECURED AS INDICATED ON THIS SKETCH	PERMITS TO:
BY _____	RECORD _____
DATE _____	R/W FILES _____
DATE _____	ASST _____
INTD _____	ORIGINATOR _____
BY _____	TOTAL _____
FIELDMAN _____	

LEGEND FOREIGN POLE EXIST. D.E. CO. POLE PROPOSED POLE EXIST. ANCHOR PROPOSED ANCHOR TREE 120/240 V LINE 4800 V LINE 13,200 V LINE 40,000 V LINE	THE DETROIT EDISON COMPANY - SERVICE PLANNING DEPARTMENT				
	CITY OR TWP. STERLING	COUNTY MACOMB	QTR. & TWP. SECT. NO. NE 1/4 32	DEPT. ORDER NO.	
	MAP SECT. 1-343-384	TOWN 21N	RANGE 12E	JOINT R/W REQUIRED YES <input type="checkbox"/> NO <input checked="" type="checkbox"/>	R/W NO. MC K050
	PROJECT NAME		TEL. ENG'R. & DIST.		PROJ. OR PART NO.
	CIRCUIT 8507 JASON				O.F.W. S.O. OR P.E. NO.
	REASON RETAIL CENTER - 7702-7770 15 MILE				BUDGET ITEM NO. 9
PLANNER L. SIMMS JR				DATE 8-11-89	
SCALE 1"=100'					