

2

To (Supervisor, RE & R/W) RICHARD LONGWISH	For RE & R/W Dept. Use	Date Received	DE/Bell/C.P. No.
Division ANN ARBOR	Date 10-30-89	Application No. AS-6824-6804	

We have included the following necessary material and information:

Material:

- A. Proposed Subdivision
 1. copy of complete final proposed plat - All pages
 or
 B. Other than proposed subdivision (condo., apts. mobile home park — other)
 1. Property description.
 2. Site plan.
 3. title information (deed, title commitment, contract with title commitment, or title search).

<p>REPORT OF REAL ESTATE AND RIGHTS OF WAY DEPARTMENT RAW SECURED AS INDICATED ON THIS SKETCH BY <u>Richard Longwish</u> DATE <u>12-21-89</u> DATE WANTED _____ DISTRICT _____ FIELDMAN <u>Richard Longwish</u></p>	<p>PERMITS TO: RECORD CENTER <u>1</u> RAW FILES <u>1</u> MBT <u>1</u> ORIGINATOR <u>1</u> TOTAL <u>1</u></p>
--	---

Note: Do not submit application for URD easements until all above material has been acquired.

Information **TRK# 89180161912**

1. Project Name ADAMS' RESIDENCE	County WASH TENAW
City/Township/Village LIMA TWP	Section No. 7

Type of Development

<input type="checkbox"/> Proposed Subdivision	<input type="checkbox"/> Apartment Complex	<input type="checkbox"/> Condominium
<input type="checkbox"/> Subdivision	<input type="checkbox"/> Mobile Home Park	<input checked="" type="checkbox"/> Other COMM. FEEDER

2. Name of Owner
GARY AND JANET ADAMS

Phone No.
475-1891

Address
2737 OAKCLEFT CT, ANN ARBOR, MICH

Owner's Representative
GARY ADAMS

Phone No.

Date Service is Wanted
NOV 20, 1989

*506 meHole
Check 48118*

4. Entire Project will be developed at one time Yes No

5. Joint easements required — Michigan Bell Telephone Yes No
 — Consumers Power Yes No

a. Name of Other Utilities If Not Michigan Bell Telephone or Consumers Power

b. Other Utility Engineer Names

Phone Numbers

Addresses

6. Additional Information or Comments
F.J.V. MEMO # A704-9

Note: Trenching letter attached will be submitted later

Service Planner
S. PREDIUM

Signed (Service Planning Supervisor)
U. C. BAILEY

Phone No.
761-4088

Address
RM 328 AADHQ

NOV 27 1989

RECORDED RIGHT OF WAY NO. 40103

NOVEMBER 10, 19 89

For good and valuable consideration of system betterment, the undersigned hereby grant and convey to THE DETROIT EDISON COMPANY, a Michigan corporation of 2000 Second Avenue, Detroit, Michigan, and MICHIGAN BELL TELEPHONE COMPANY, a Michigan Corporation of 444 Michigan Avenue, Detroit, Michigan, hereinafter referred to collectively as "GRANTEE," the right to construct, reconstruct, modify, add to, operate and maintain underground line facilities consisting of poles, conduits, wires, cables, manholes, transformers and accessories required to provide electric and communication services in, under, upon and across property located in the _____ Township of _____ Lima _____, County of _____ Washtenaw _____, State of Michigan, further described as follows:

The Southeast quarter of the Northeast quarter of Section 6; also all that part of the East half of the Northeast quarter of Section 7, which lies North of the Michigan Central Railroad, also commencing at the East half quarter post on the North line of said Section 7 and running thence South on the half quarter line of said Section 7 to the North line of the Michigan Central Railroad; thence West on the North line of said railroad so far that a line running thence North to the North line of said Section and parallel with the East half quarter line and thence on the Section line to the Place of Beginning, shall contain 15 acres of land, also the Southeast quarter of said Section 6, excepting and reserving 40 acres of land off from the West side of said Southeast quarter of said Section 6 heretofore sold to Thomas S. Sears described in the deed in Liber 56 of Deeds, page 278, Register's Office, Washtenaw County, Michigan

TIME RECORDED 8:57 AM
DATE Dec. 1 19 89
ROBERT M. HARRISON
WASHTENAW COUNTY CLERK/REGISTER

RECORDED
WASHTENAW COUNTY MI
Dec 1 8 57 AM '89
ROBERT M. HARRISON
COUNTY CLERK/REGISTER

The underground easement will be as shown on the attached drawing AS-6824 & dated 10/18/89 which is made a part hereof.

The right of way is twelve (12) feet in width.

The rights hereby granted include the right of access to and from the right of way and the right to trim, cut down or otherwise control trees, brush or roots of any kind either within the right of way or on property adjoining the right of way which in the opinion of the GRANTEE interferes with the construction or operation of the line facilities. It is expressly understood and agreed that the GRANTEE shall, at no time, trim or cut down any trees unless, in the GRANTEE'S opinion, it is absolutely necessary to do so. The GRANTEE shall restore premises to its original condition or as near as can be in the event of damages caused by its employees, contractors, vehicles and equipment entering premises for the purposes set forth herein.

No buildings or structures are to be placed within said right of way herein granted without the written consent of the GRANTEE.

This grant is declared to be binding upon the heirs, successors, lessees, licensees and assigns of the parties hereto.

IN WITNESS WHEREOF, the undersigned have hereunto set their hand(s) on the date of this agreement.

Witnesses:

Henry A. Amble, Jr.
Henry A. Amble, Jr.
JOSEPH F. SPRING

Grantors:

Gary F. Adams
GARY F. ADAMS
Janet C. Adams
JANET C. ADAMS, his wife

Prepared by:
Richard E. Longwish
425 S. Main, Ann Arbor, MI 48107

Address:
~~2737 Oakcliff Court~~ 506 McKinley
Ann Arbor, MI 48103- CHelsea, MI 48118

APPROVED AS TO FORM 11/29/89 DATE
LEGAL DEPARTMENT [Signature] OVER

RECORDED RIGHT OF WAY NO. 40103

Acknowledgement-Individual

STATE OF MICHIGAN

County of WASHTENAW SS

On this 10 day of NOVEMBER, 19 89, the foregoing instrument was acknowledged before me, a notary public in and for said county, by GARY F. ADAMS and JANET G. ADAMS, his wife

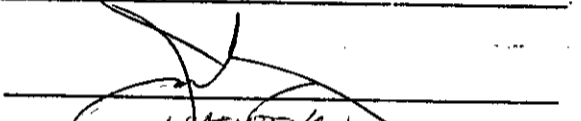
Notary Public, WASHTENAW County, Michigan

My commission expires June 26, 1993

JOSEPH F. SPRING
Notary Public, Washtenaw County, MI
My Commission Expires June 26, 1993

RETURN TO:
RICHARD LONGWISH
THE DETROIT EDISON COMPANY
425 S. MAIN STREET, ROOM 332
ANN ARBOR, MI 48104

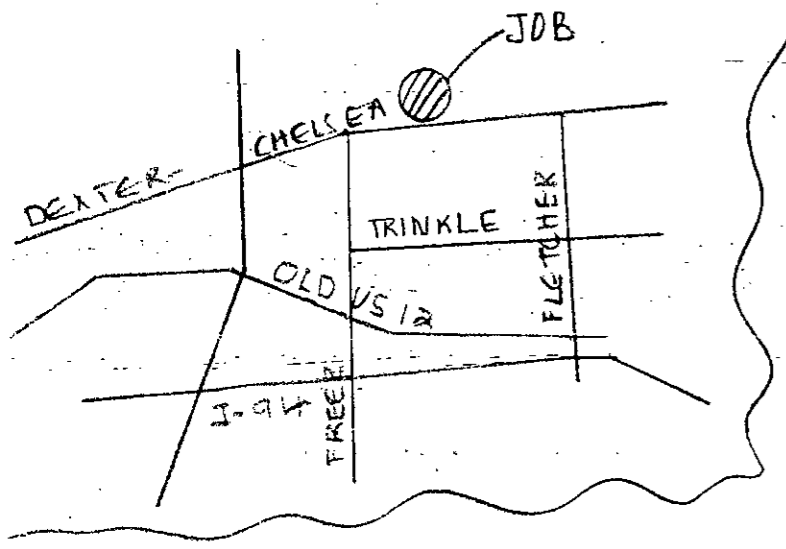

OWNER
 GARY F. AND JANET C. ADAMS
 2737 OAKCLEFT COURT
 ANN ARBOR, MICHIGAN 48103
 475-1891

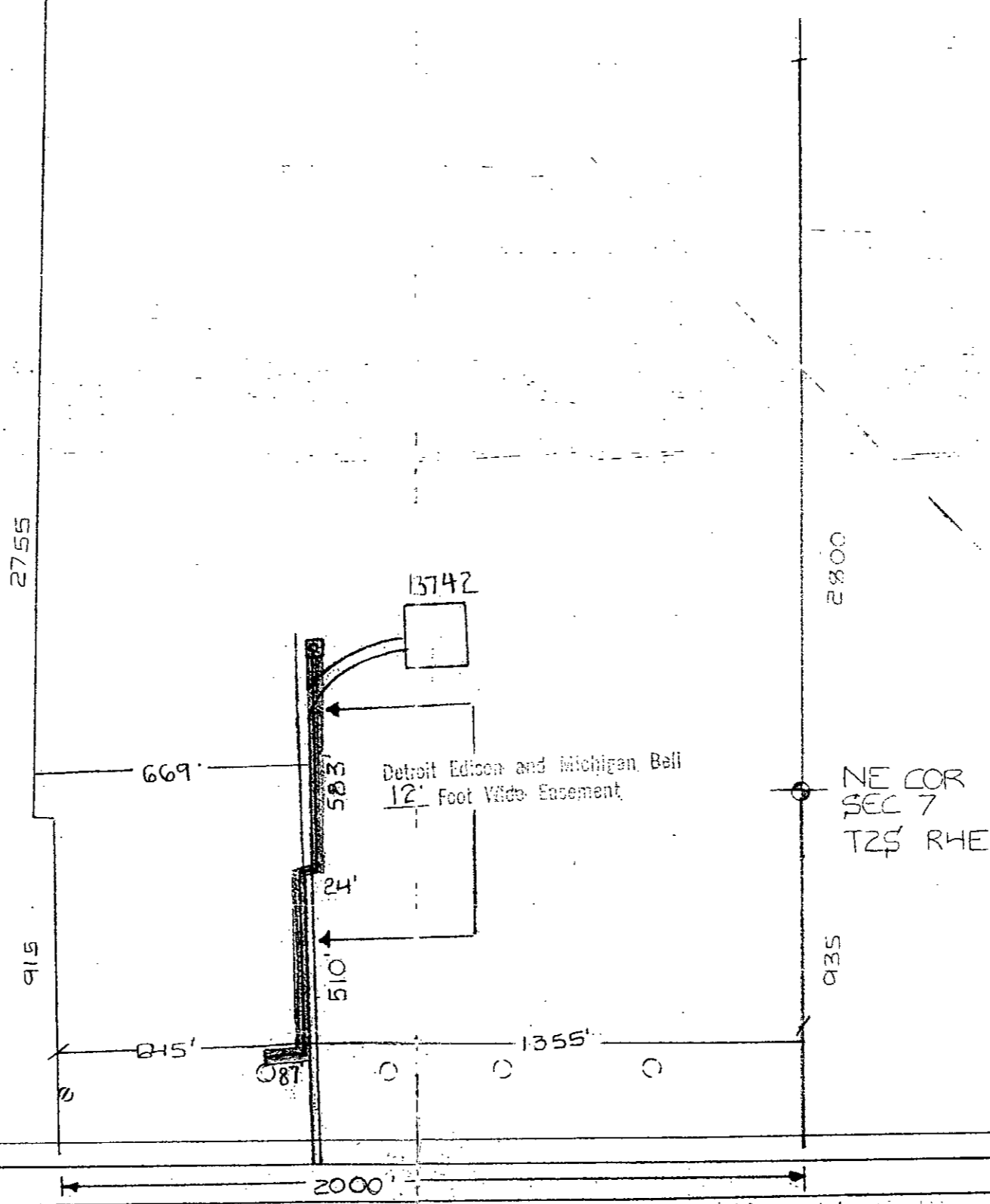

REPORT OF REAL ESTATE AND RIGHTS OF WAY DEPARTMENT R/W SECURED AS INDICATED ON THIS SKETCH BY _____ DATE _____ DATE WANTED: 12-1-89 DISTRICT _____ FIELDMAN _____	PERMITS TO: RECORD CENTER _____ R/W FILES _____ MST _____ ORIGINATOR _____ TOTAL _____
---	---

NOTICE

Locations of underground facilities on this drawing are only approximate. Exact locations must be determined by the UTILITY COMPANIES. For exact locations, telephone MISS DIG on 500-402-7171 as required by Public Act 53 of 1974 before doing any power excavating.

DEXTER-CHELSEA RD
 TRK# BA180161912

LEGEND FOREIGN POLE EXIST. D.E. CO. POLE PROPOSED POLE EXIST. ANCHOR PROPOSED ANCHOR TREE 120/240 V LINE 4800 V LINE 13,200 V LINE 40,000 V LINE	THE DETROIT EDISON COMPANY - SERVICE PLANNING DEPARTMENT			
	CITY OR TWP. LIMA	COUNTY WASHTENAW	QTR. & TWP. SECT. NO. NE 1/4 7	DEPT. ORDER NO. A-39753
	MAP SECT. 2-088-296	TOWN RANGE	JOINT R/W REQUIRED YES <input checked="" type="checkbox"/> NO <input type="checkbox"/>	R/W NO. AS-6824
	PROJECT NAME ADAMS RESIDENCE	TEL. ENG'R. & DIST.	PROJ. OR PART NO.	
	CIRCUIT D.C.	ANN LIM UC	O.F.W. S.O. OR P.E. NO.	
	REASON TO PROV SERV TO 13742 DEX-CHELSEA	PLANNER S. PREDILIM	SCALE 1"=400'	BUDGET ITEM NO. 91MJOB-MDJ
			DATE 10-18-89	

FJUMEMO #A1049

11/20/89

RECORDED
WASHTENAW COUNTY MI
DEC 1 8 57 AM '89
ROBERT M. HARRISON
COUNTY CLERK/REGISTER

Handwritten marks and scribbles on the right edge of the page.

65-7
50-12

RETURN TO:
RICHARD LONGWISH
THE DETROIT EDISON COMPANY
425 S. MAIN STREET, ROOM 332
ANN ARBOR, MI 48104