

August 4, 19 89

For good and valuable consideration of system betterment, the undersigned hereby grant and convey to THE DETROIT EDISON COMPANY, a Michigan corporation of 2000 Second Avenue, Detroit, Michigan, MICHIGAN BELL TELEPHONE COMPANY, a Michigan Corporation of 444 Michigan Avenue, Detroit, Michigan, and COLUMBIA CABLE OF MICHIGAN, a Michigan Co-Partnership of P. O. Box 998 Ann Arbor, Michigan 48106, hereinafter referred to collectively as "GRANTEE," the right to construct, reconstruct, modify, add to, operate and maintain underground line facilities consisting of poles, conduits, wires, cables, manholes, transformers and accessories required to provide electric and communication services in, under, upon and across property located in the Township of Ann Arbor, County of Washtenaw, State of Michigan, further described as follows:

Commencing at the South 1/4 corner of Section 24, T2S, R6E, Ann Arbor Township, Washtenaw County, Michigan; thence N 00°26'40" W 169.31 feet along the North-South 1/4 line of Section 24 to the Point of Beginning; thence N 76°03'30" W 151.40 feet; thence North-westerly 1342.81 feet along the arc of a 1102.92 foot radius curve to the right, the long chord of which bears N 41°10'47" W 1261.39 feet; thence N 89°33'20" E 969.79 feet; thence S 00°26'40" E 993.41 feet along the North-South 1/4 line back to the Point of Beginning. Containing 16.211 acres of land, more or less and being subject to a 40 foot wide easement for public utilities along the East side of the described parcel.

RECORDED
WASHTENAW COUNTY, MI
Dec 19 11 15 AM '89
ROBERT M. HARRISON
COUNTY CLERK/REGISTER

TIME RECORDED 11:15 A.M.
DATE Dec 19 19 89
ROBERT M. HARRISON
WASHTENAW COUNTY CLERK/REGISTER

RECORDED RIGHT OF WAY NO. 400-25-

The route of underground line facilities is as shown on the attached drawing AS-6749 which is made a part hereof

The right of way is Twelve (12) feet in width.

The rights hereby granted include the right of access to and from the right of way and the right to trim, cut down or otherwise control trees, brush or roots of any kind either within the right of way or on property adjoining the right of way which in the opinion of the GRANTEE interferes with the construction or operation of the line facilities. It is expressly understood and agreed that the GRANTEE shall, at no time, trim or cut down any trees unless, in the GRANTEE'S opinion, it is absolutely necessary to do so. The GRANTEE shall restore premises to its original condition or as near as can be in the event of damages caused by its employes, contractors, vehicles and equipment entering premises for the purposes set forth herein.

No buildings or structures are to be placed within said right of way herein granted without the written consent of the GRANTEE.

This grant is declared to be binding upon the heirs, successors, lessees, licensees and assigns of the parties hereto.

IN WITNESS WHEREOF, the undersigned have hereunto set their hand(s) on the date of this agreement.

Witnesses:

Grantors:

Eiji Okuyama

MITSUTAEA NAKAMURA

AISIN SEIKI COMPANY, LTD.,
A Japanese Corporation

TOSHIMIRO SUGIURA
DIRECTOR + GENERAL MANAGER

Prepared by: Curtis G. Noles
2000 Second Avenue
Detroit, MI 48226

Address: 1 Asahi-Machi 2-Chome
Kariya-City, Aichi Pref., Japan

--OVER--

APPROVED AS TO FORM 11/29/89 DATE
LEGAL DEPARTMENT

August 4, 19 89

For good and valuable consideration of system betterment, the undersigned hereby grant and convey to THE DETROIT EDISON COMPANY, a Michigan corporation of 2000 Second Avenue, Detroit, Michigan, MICHIGAN BELL TELEPHONE COMPANY, a Michigan Corporation of 444 Michigan Avenue, Detroit, Michigan, and COLUMBIA CABLE OF MICHIGAN a Michigan Co-Partnership ~~XXXXXXXX~~ of P. O. Box 998 Ann Arbor, Michigan 48106 hereinafter referred to collectively as "GRANTEE," the right to construct, reconstruct, modify, add to, operate and maintain underground line facilities consisting of poles, conduits, wires, cables, manholes, transformers and accessories required to provide electric and communication services in, under, upon and across property located in the Township of Ann Arbor County of Washtenaw State of Michigan, further described as follows:

Commencing at the South 1/4 corner of Section 24, T2S, R6E, Ann Arbor Township, Washtenaw County, Michigan; thence N 00°26'40" W 169.31 feet along the North-South 1/4 line of Section 24 to the Point of Beginning; thence N 76°03'30" W 151.40 feet; thence North-westerly 1342.81 feet along the arc of a 1102.92 foot radius curve to the right, the long chord of which bears N 41°10'47" W 1261.39 feet; thence N 89°33'20" E 969.79 feet; thence S 00°26'40" E 993.41 feet along the North-South 1/4 line back to the Point of Beginning. Containing 16.211 acres of land, more or less and being subject to a 40 foot wide easement for public utilities along the East side of the described parcel.

RECORDED
WASHTENAW COUNTY, MI
Dec 19 11 15 AM '89
ROBERT M. HARRISON
COUNTY CLERK/REGISTRAR

TIME RECORDED 11:15AM.
DATE Dec 19 19 89
ROBERT M. HARRISON
WASHTENAW COUNTY CLERK/REGISTRAR

RECORDED RIGHT OF WAY NO. 40025

The route of underground line facilities is as shown on the attached drawing AS-6749 which is made a part hereof.

The right of way is Twelve (12) feet in width.

The rights hereby granted include the right of access to and from the right of way and the right to trim, cut down or otherwise control trees, brush or roots of any kind either within the right of way or on property adjoining the right of way which in the opinion of the GRANTEE interferes with the construction or operation of the line facilities. It is expressly understood and agreed that the GRANTEE shall, at no time, trim or cut down any trees unless, in the GRANTEE'S opinion, it is absolutely necessary to do so. The GRANTEE shall restore premises to its original condition or as near as can be in the event of damages caused by its employes, contractors, vehicles and equipment entering premises for the purposes set forth herein.

No buildings or structures are to be placed within said right of way herein granted without the written consent of the GRANTEE.

This grant is declared to be binding upon the heirs, successors, lessees, licensees and assigns of the parties hereto.

IN WITNESS WHEREOF, the undersigned have hereunto set their hand(s) on the date of this agreement.

Witnesses:

Grantors:

Jeiji Okuyama
Jeiji Okuyama
Mitsutaka Nakamura
MITSUTAKA NAKAMURA

AISIN SEIKI COMPANY, LTD.,
A Japanese Corporation
Toshihiro Sugie
TOSHIHIRO SUGIE
Director + General Manager

Prepared by: Curtis G. Noles
2000 Second Avenue
Detroit, MI 48226

Address: 1 Asahi-Machi 2-Chome
Kariya-City, Aichi Pref., Japan

--OVER--

APPROVED AS TO FORM 11/29/89 DATE
LEGAL DEPARTMENT

Acknowledgment-Corporation

STATE OF MICHIGAN

County of Wayne)SS

On this 4th day of August, 19 89, the foregoing instrument was acknowledged before me, a notary public in and for said county, by Toshihiro Sugiura

whose title(s) is /are Director and General Manager
of AISIN SEIKI COMPANY LTD., a JAPANESE corporation, on behalf of the corporation.

Holly N. Barrows
Notary Public, Wayne County, Michigan

My commission expires 2/24/93

HOLLY N. BARROWS
NOTARY PUBLIC STATE OF MICHIGAN
WAYNE COUNTY
MY COMMISSION EXP. FEB. 24, 1993

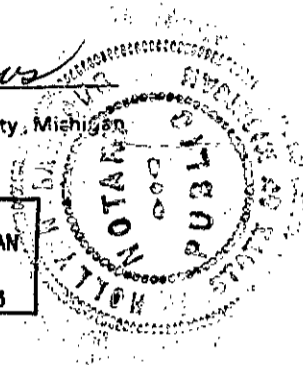

RECORDED
INDEXED
MICHIGAN
STATE ARCHIVES

STATE OF MICHIGAN
RECORDS DEPARTMENT

To (Supervisor, RE & R/W) DICK LONBUISH	For RE & R/W Dept. Use	Date Received	DE/Bell/C.P. No.
Division ANN ARBOR	Date 7-13-89	Application No. AS-6749	

We have included the following necessary material and information:

Material:

A. Proposed Subdivision

- 1. Copy of complete final proposed plat - All pages

or

B. Other than proposed subdivision (condo., apts. mobile home park — other)

- 1. Property description.
- 2. Site plan.
- 3. title information (deed, title commitment, contract with title commitment, or title search).

Note: Do not submit application for URD easements until all above material has been acquired.

REPORT OF PROPERTIES AND RIGHTS OF WAY DEPARTMENT PLAT SECURED AS INDICATED ON THIS SKETCH BY <u>CURTIS & NOLES</u> DATE <u>8/4/89</u> DATE WANTED _____ DISTRICT <u>Richard Torquist</u> FIELDMAN _____	PERMITS TO: RECORD CENTER <u>1</u> R/W FILES <u>1</u> MBT <u>1</u> ORIGINATOR <u>1</u> TOTAL <u>1</u>
---	--

Information

1. Project Name AISIN SEIKI CO.	County WASHTENAW
City/Township/Village ANN ARBOR	Section No. 24
Type of Development <input type="checkbox"/> Proposed Subdivision <input type="checkbox"/> Apartment Complex <input type="checkbox"/> Condominium <input type="checkbox"/> Subdivision <input type="checkbox"/> Mobile Home Park <input checked="" type="checkbox"/> Other	
2. Name of Owner AISIN SEIKI CO.	Phone No. 523-1800
Address 14109 FARMINGTON RD. - LIVONIA MI - 48154	
Owner's Representative DAYLE PAYNE (PAYNE - HICKEY INC.)	Phone No. 261-6550
Date Service is Wanted	

4. Entire Project will be developed at one time Yes No
5. Joint easements required — Michigan Bell Telephone Yes No
 — Consumers Power Yes No

a. Name of Other Utilities If Not Michigan Bell Telephone or Consumers Power COLUMBIA CABLE OF MICHIGAN SYSETEM	
b. Other Utility Engineer Names JIM BOWEN	Phone Numbers 973-0977
Addresses R.D. BOX 998 ANN ARBOR - MI - 48106	

6. Additional Information or Comments

Note: Trenching letter attached will be submitted later

Service Planner Jerry L. Smart	Signed (Service Planning Supervisor) JUL 13 1989
Phone No.	Address L. C. BAILEY

RECORDED RIGHT OF WAY NO. 40026

(RMS)

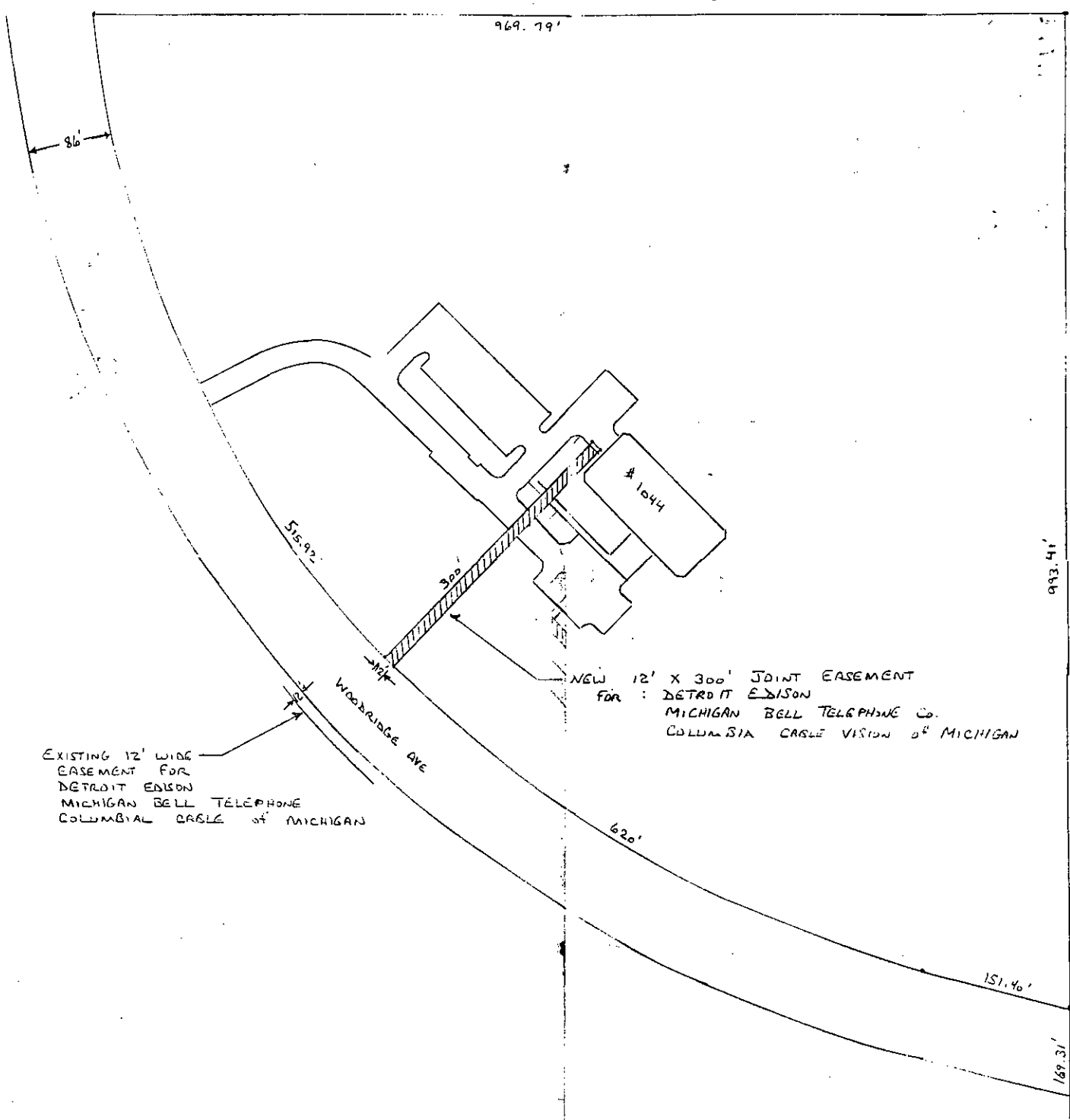
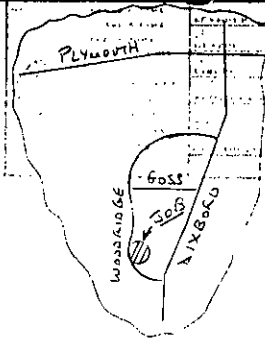

EXISTING 12' WIDE EASEMENT FOR DETROIT EDISON MICHIGAN BELL TELEPHONE COLUMBIA CABLE OF MICHIGAN

NEW 12' X 300' JOINT EASEMENT FOR : DETROIT EDISON MICHIGAN BELL TELEPHONE CO. COLUMBIA CABLE VISION OF MICHIGAN

FUTURE JOINT USE MEMO A-557-9 TO COLUMBIA CABLE
 FUTURE JOINT USE MEMO A-558-9 TO MICHIGAN BELL TELEPHONE

S. 1/4 COR. SEC. 24 T 2S R 6E

RECORDED RIGHT OF WAY NO. 40025

LEGEND		THE DETROIT EDISON COMPANY - SERVICE PLANNING DEPARTMENT			
○	FOREIGN POLE	CORPORATE TWP.	COUNTY	QTR. & TWP. SECT. NO.	DEPT. ORDER NO.
○	EXIST. D.E. CO. POLE	ANN ARBOR	WASHTENAW	24	
●	PROPOSED POLE	MAP SHEET	TOWN	RANGE	JOINT R/W REQUIRED
○	EXIST. ANCHOR	1-178-288	2S	6E	YES NO
○	PROPOSED ANCHOR	PROJECT NAME	TEL. ENGR. & DIST.	PROJ. OR PART NO.	R/W NO.
○	TREE	ATSIK SEIKI Co.			6749
—	150/250 V LINE	CIRCUIT			O.P.W. L.O. OR P.E. NO.
—	6000 V LINE	8248	WOLVERINE (13KV)		BUDGET ITEM NO.
—	15,000 V LINE	REASON			
—	40,000 V LINE	PROVIDE	NEW SERVICE TO 1044 WOODRIDGE		DATE
		PLANNER			1-13-89
		TERRY SMART	SCALE		

