

Detroit Edison

Real Estate and Rights of Way

Joint Underground Residential Distribution Right of Way Agreement

88 40810

LIBER 10347 PAGE 512

NOVEMBER 11, 19 87

For good and valuable consideration of system betterment, the undersigned hereby grant and convey to THE DETROIT EDISON COMPANY, a Michigan corporation of 2000 Second Avenue, Detroit, Michigan and Greater Michigan Cablevision, Inc. a Michigan corporation of 3166 Martin RD, Walled Lake, MI 48088 hereinafter referred to collectively as "GRANTEE", the right to erect, lay, maintain, reconstruct, add to and replace underground facilities consisting of wires, cables, conduits, fixtures and appurtenances including the necessary above ground equipment, connections, poles and accessories required in, under, upon, over and across the property located in the City of Walled Lake, County of Oakland, State of Michigan, and more particularly described on the attached Appendix "A"; with the full right to the GRANTEE of ingress and egress upon said property for the purposes of this grant, and the further right to trim, cut down or otherwise control brush and trees within the right of way herein described.

Said right of way shall be Ten (10) feet in width unless otherwise indicated and the route is described as follows:

The exact location of said easements shall be shown on a drawing to be recorded within 90 days after construction.

REG. DEEDS PAID 0001 MAR. 23 '88 11:56AM 9917 MISC 13.00

~~REG. DEEDS PAID 0001 DEC. 04 '87 12:39PM 1009 MISC 9.00~~

REG. DEEDS PAID 0001 MAR. 23 '88 11:54AM

RECORDED RIGHT OF WAY NO. 38129

20

ENT

In order to provide for the proper maintenance and protection of GRANTEE, the undersigned covenant and agree that:

- 1. The right of way will be graded to within four inches of final grade before the GRANTEE'S lines are installed and this ground elevation must be maintained after installation of utilities to avoid the pooling of water in, on or around GRANTEE'S above ground equipment.
2. No buildings or structures other than GRANTEE'S equipment are to be placed within the right of way herein granted. No excavation is to be permitted within said right of way without approval of GRANTEE
3. No shrubs or foliage shall be planted or grown within eight feet of the front door of transformers or switching cabinet enclosures. GRANTEE shall not be responsible to owners for damages to or removal of trees or plant life planted in front of said door or within the right of way causing an interference with GRANTEE'S maintenance of their equipment.
4. If the lines or facilities of GRANTEE are damaged by the acts of owners, their agents, employes or contractors, repairs shall be made by the granting company so damaged at the cost and expense of owners. Owners are defined as those persons owning the property at the time the damage occurred.

THIS GRANT is declared to be binding upon the heirs, successors, lessees, licensees and assigns of the parties hereto

IN WITNESS WHEREOF, the undersigned have hereunto set their hand(s) on the date of this agreement.

Witnesses:

Grantors:

Witness signature lines

See next page Grantor signature lines with handwritten amounts 9.00 and 13.00

Prepared by: Omer V. Racine The Detroit Edison Company 30400 Telegraph Road Suite 264 Birmingham, MI 48010

Address: P.O. Box 565 Walled Lake, MI 48088

This easement is re-recorded for purposes of showing the planned "as installed" centerlines of easements granted as shown on drawing attached hereto.

WITNESSES:

Susan M. Zucal
Susan M. Zucal

Bethany L. Payton
Bethany L. Payton

Harry L. Lapham, Jr., Successor
Trustee of The Benjamin Bundo,
Trust Dated 11-26-85
32523 Grand River Ave.
Farmington, MI 48024

[Signature]
Harry L. Lapham, Jr., Trustee
AS LAND CONTRACT VENDOR
ONLY -

STATE OF MICHIGAN)
) SS:
COUNTY OF ~~OAKLAND~~)

Personally came before me this 11th day of November, 1987,
Harry L. Lapham, Jr., trustee of the above named trust, to me known to be the
person who executed the foregoing instrument and to me known to be such Trustee
of said trust, and acknowledged that he executed the foregoing instrument as
Trustee as the free act and deed of said trust, by its authority.

* THE BENJAMIN BUNDO TRUST DATED 11-26-85

My Commission Expires: 6 6-88

Susan M. Zucal
Notary Public Oakland County, Michigan
Susan M. Zucal

RECORDED RIGHT OF WAY NO. 38129

WITNESSES:

G.R.P. Investments, Inc.
a Michigan Corporation
P.O. Box 565
Walled Lake, MI 48088

Edna Profitt
EDNA PROFITT

Paul Profitt
Paul Profitt, President

Karen Rzesutek
KAREN RZESUTEK

Gary Boyd
Gary Boyd, Vice President

STATE OF MICHIGAN)
) SS:
COUNTY OF OAKLAND)

Personally came before me this 19 day of Nov 1987,
Paul Profitt, President, and Gary Boyd, Vice President of the above named
corporation, to me known to be the persons who executed the foregoing instrument
and to me known to be such President and Vice President of said corporation, and
acknowledged that they executed the foregoing instrument as such officers as the
free act and deed of said corporation, by its authority.

Glenda Dee Agius
Notary Public OAKLAND County, Michigan
GLENDA DEE AGIUS

My Commission Expires: 2/24/92

APPENDIX "A"

Lots 4 through 32, inclusive, of PHILIPSKI'S WALLED LAKE SUBDIVISION, part of
the East 1/2 of the S.W. 1/4 of Sec. 34 T.2N., R.8E., City of Walled Lake, Oakland
Co. MI, as recorded in Liber 28, of plats page 12, Oakland Co. records, containing
3.686 acres. Subject to an easement and right of way granted to the City of Walled
Lake for public sidewalk purposes as set forth more fully in easement recorded
May 27, 1981 in Liber 8011, of plats page 767, as to lots 4 to 17 inclusive;
also subject to an easement for highway purposes over that part of lot 4 described
as: all that part of lot 4 of PHILIPSKI'S WALLED LAKE SUBDIVISION, described as:
beginning at the Southwesterly corner of said lot 4, thence Northeasterly along
the Southerly line of said lot 4, a distance of 118.5 ft. to a point; thence
Southwesterly 112 ft. to a point of the Westerly line of said lot 4, which is
Northerly along said Westerly line of said lot 4, a distance of 15 ft. from the
Southwesterly corner of said lot 4, thence Southerly along the Westerly line
of said lot 4, a distance of 15 ft. to the point of beginning; also subject to
other easements and restrictions of record, if any.

Sidwell Numbers:

- 17-34-329-014
- 17-34-329-013
- 17-34-329-012
- 17-34-329-011
- 17-34-329-010
- 17-34-329-009
- 17-34-329-008
- 17-34-329-023
- 17-34-329-024
- 17-34-329-025
- 17-34-329-026
- 17-34-329-027
- 17-34-329-028
- 17-34-329-029

NOW 17-34-329-030 - ²⁸⁰² Part of Lots
8-27

Ent 17-34-329-000 - Lake winds
North Condo
9020489 OCCP# 489
(formerly being all or part of Lots
4-10 and 26-32)

RECORDED RIGHT OF WAY NO. 38129

MEMORANDUM ORDER
FOR GENERAL USE
DE FORM MS 77 12-59

TO Records Center

DATE 4-13-88 TIME

RECORDED
INDEXED
FILED

Please set up P/W file for: LAKE WINDS NORTH CONDO

Being a part of E 1/2 OF SW 1/4 of Section 34, CITY OF WALKER
Oakland County, Michigan

COPIES TO:

SIGNED

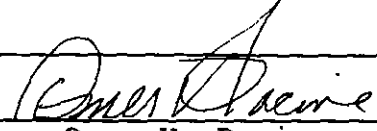

Omer V. Racine
264 Oakland Div. Hqtrs.

REPORT

COMMENCE TOL
SEC. 34

DATE RETURNED

TIME

To (Supervisor RL & RW) <u>JAMES McDONALD</u>	For RL & RW Or Use	Date Received <u>10-27-87</u>	DL/Br/CP No. <u>CE 87-41J</u>
Division <u>OAKLAND</u>	Date	Application No.	

We have included the following necessary material and information

Material:

- A Proposed Subdivision
 - 1 copy of complete final proposed plat - All pages
- or
- B Other than proposed subdivision (condo, apts, mobile home park - other)
 - 1 Property description
 - 2. Site plan
 - 3. title information (deed, title commitment, contract with title commitment, or title search).

Note: Do not submit application for URD easements until all above material has been acquired

Information

1 Project Name <u>LAKEWINDS NORTH CONDOS</u>	County <u>OAKLAND</u>
City/Township/Village <u>WALLED LAKE, COMMERCE TWP.</u>	Section No. <u>34</u>

Type of Development

- | | | |
|---|--|---|
| <input type="checkbox"/> Proposed Subdivision | <input type="checkbox"/> Apartment Complex | <input checked="" type="checkbox"/> Condominium |
| <input type="checkbox"/> Subdivision | <input type="checkbox"/> Mobile Home Park | <input type="checkbox"/> Other |

2 Name of Owner

<u>G. R. P. INVESTMENTS, INC.</u>	Phone No. <u>624-3616</u>
-----------------------------------	------------------------------

Address

P.O. BOX 565, WALLED LAKE, MI 48088

Owner's Representative

<u>GARY BOYD</u>	Phone No. <u>624-3616</u>
------------------	------------------------------

Date Service is Wanted

12-15-87

4. Entire Project will be developed at one time Yes No

5. Joint easements required -- Michigan Bell Telephone Yes No
 -- Consumers Power Yes No

a Name of Other Utilities If Not Michigan Bell Telephone or Consumers Power

GREATER MICH. CABLEVISION

b Other Utility Engineer Names

<u>LISA STEEDMAN</u>	Phone Number <u>669-2288</u>
----------------------	---------------------------------

Addresses

3166 MARTIN RD.

WALLED LAKE, MI. 48088

6 Additional Information or Comments

Note. Trenching letter attached will be submitted later

Service Planner

JOE WALLACE

Signature (Service Planning Supervisor)

R. Maury

Phone No.

645-4371

Address

RECORDED RIGHT OF WAY NO. 381029

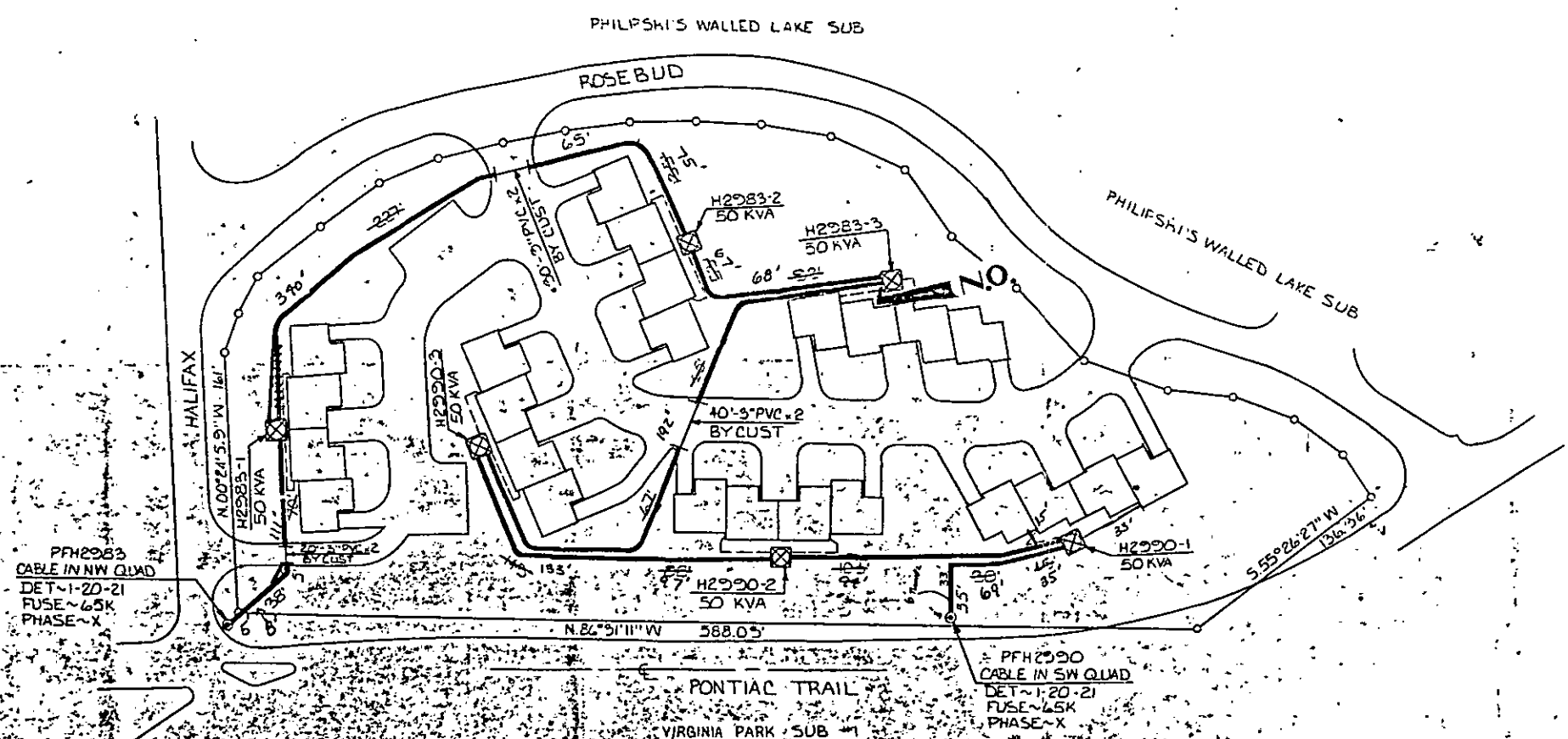
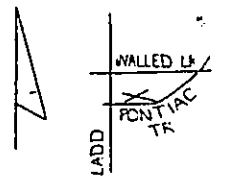

TRANSFORMER DATA

U.D.T. NO.	SIZE	ED. STK. NO.
H2983-1	50 KVA	
H2983-2	50 KVA	
H2983-3	50 KVA	
H2990-1	50 KVA	
H2990-2	50 KVA	

TRANSFORMER SPECS 1-17-261
 PEDESTAL SPEC.
 NO. OF PEDESTALS
 NO. OF TEMPORARY CABLE MARKERS
 TEMPORARY CABLE MARKER SPEC.
 SECONDARY CONNECTION BOX SPEC.

- CODE —**
- ⊙ TEMPORARY SECONDARY PEDESTAL/TEMPORARY CABLE MARKER
 - ⊠ DFT (DEAD FRONT TYPE)
 - UOT (NON-SWITCHING—LIVE FRONT TYPE)
 - ⊞ UOT (SWITCHING—LIVE FRONT TYPE)
 - DIRECTION OF TRANSFORMER DOOR OPENING
 - SECONDARY PEDESTAL
 - ⊞ SECONDARY CONNECTION BOX
 - CABLE POLE
 - ⊞ PRIMARY SWITCH CABINET
 - BURIED PRIMARY CABLE—ALL VOLTAGES
 - BURIED SECONDARY CABLE
 - BURIED SECONDARY SERVICE CABLE
 - DETROIT EDISON TRENCH ONLY
 - TELEPHONE TRENCH ONLY
 - SEWER
 - WATER
 - GAS
 - PROPOSED CONDUIT
 - ⊞ SEP DOWN CABINET

CABLE SUMMARY

ITEM #	DESCRIPTION	QUANTITY	UNIT PRICE	TOTAL
1	#2X1/2PC X 1 1/2 KV	523	1800	9414
2	AP2-350M & 1-40 600 V.	713	0537	3839
3	AP2-20 & 1-41 600 V.	713	0814	5804

TRENCH SUMMARY

JOINT USE	LENGTH	UNIT PRICE	TOTAL
E+T+IV	4286'	1322	5670
D.E. ONLY	2 TV	48	96
TEL ONLY			
GAS ONLY			
OTHERS			
TOTAL	4286'	1370	5766

SITE SUPT. GARY BOYD PHONE NO.

NOTICE

Locations of underground facilities on this drawing are only approximates. Exact locations must be determined by the UTILITY COMPANIES. For exact location, telephone MISS DIO on 800-462-7171 as required by Public Act 53 of 1974 before doing any power excavating.

— GENERAL NOTES —

TRENCHING TO BE DONE BY DECO
 TRENCH AND CABLE LENGTHS ARE APPROXIMATE
 SEE SECTION 50 UG LINE CONSTRUCTION STANDARDS FOR TRANS. MAT. DETAILS.
 SEE PAGE 3-2-11 S.I.M. DETAIL " " FOR ENTRANCE POINT DETAILS (APTS. ONLY)
 SEE SECTION 43 UG LINE CONSTRUCTION STANDARDS FOR PLACEMENT OF CABLES.
 TRANSFORMERS AND PEDESTALS (SUBDS ONLY)
 D.E. SERVICE PLANNER JOE WALLACE 645-4371
 TEL. CO. BARRY GARNER 540-0201
 GAS CO.
 OTHERS: CATV LISA STEEDMAN 645-2288
 CONTACT "MISS DIO" (800-462-7171) BEFORE DOING ANY EXCAVATION.
 EASEMENTS INDICATED BY OUR CENTERLINE ARE
 IN WIDTH UNLESS OTHERWISE NOTED.

PERMITS REQUIRED

CITY OF _____ COUNTY, NOTIFICATION ONLY ✓
 STATE YES NO

D	C	B	A	REFERENCE
			AS INSTALLED	
			D.O. A 64369	
			W.O. 36784 J 930	
			START 1-8-88	
			FINISH 1-11-88	
			LABOR: COARBY ENERGY	
			ENG: RZ-23-88 (304)	

NAME	DATE	JOB TITLE
RALPH MWINCEL	11-3-87	
for [Signature]	11-16-87	
R J. HUEY/3D	11-17-87	
J. [Signature]	11-17-87	

START DATE -12-1-87

LAKEWINDS NORTH
 PART OF E 1/2 OF SW 1/4 SEC 34
 T.2N., R.8E.

CITY OF WALLED LAKE OAKLAND CO. 87A-64369

THE DETROIT EDISON COMPANY
 SERVICE PLANNING

SCALE	NUMBER OF UNITS	WORK ORDER NUMBER
1"=50'	24	36784 J930

LATEST REVISION: 8239 WIXOM

DEPT. ORDER NUMBER: 87A-64369