

**Detroit
Edison**

Right of Way Agreement

NOVEMBER 4, 19 82

3-9
/ 81

For valuable consideration, the receipt of which is hereby acknowledged, the undersigned hereby grant and convey to THE DETROIT EDISON COMPANY, a corporation organized and existing concurrently under the laws of the States of Michigan and New York, of 2000 Second Avenue, Detroit, Michigan 48226 and the MICHIGAN BELL TELEPHONE COMPANY, a Michigan corporation, of 444 Michigan Avenue, Detroit, Michigan 48226 hereinafter referred to as "UTILITIES", the easement and right to erect, lay, maintain, reconstruct and replace underground facilities consisting of wires, cables, conduits, fixtures and appurtenances including the necessary above ground equipment, connections, poles and accessories which may from time to time be required in, under, upon, over and across the land located in the Township of Waterford, Oakland County, Michigan, and more particularly described on the attached Appendix "A", with the full right to the UTILITIES of ingress and egress upon said land for the purposes of this grant, and the further right to trim, cut down or otherwise control brush and trees within the easements herein described.

Said easements shall be Ten (10) feet in width unless otherwise indicated and their route is described as follows: The exact location of said easements will be shown on a drawing to be recorded within 90 days after construction.

In order to provide for the proper maintenance and protection of UTILITIES, the undersigned covenant and agree that:

1. The easements will be graded to within four (4) inches of final grade before the UTILITIES lines are installed and this ground elevation must be maintained after installation of utilities to avoid the pooling of water in, on or around above ground UTILITIES' equipment.
2. No buildings or structures other than UTILITIES equipment are to be placed within the easements herein granted. No excavation is to be permitted within said easement without approval of UTILITIES.
3. No shrubs of foliage shall be planted or grown within five (5) feet of the front door of transformers or switching cabinet enclosures. UTILITIES shall not be responsible to Owners for damages to or removal of trees or plant life planted in front of said door or within the easement causing an interference with UTILITIES maintenance of their equipment.
4. If the lines of facilities of UTILITIES are damaged by the acts of Owners, their agents, employes or contractors, repairs shall be made by the Utility company so damaged at the cost and expense of Owners. Owners are defined as those persons owning the land at the time the damage occurred.

THIS GRANT is declared to be binding upon the heirs, successors, lessees, licenses and assigns of the parties hereto.

IN WITNESS WHEREOF, the undersigned have hereunto set their hand and seal on this date.

Witnesses:

Grantors: HIGHLAND VILLA CORPORATION,
A Michigan Corporation

* Patricia A. Gross
PATRICIA A. GROSS

* Cindy A. Booth
CINDY A. BOOTH

Joseph L. Cook
Joseph L. Cook, President

RECORDED RIGHT OF WAY NO. 36182

Prepared By: James McDonald
The Detroit Edison Company
30400 Telegraph Road
Birmingham, Michigan 48010

Address: 3921 Kirkland Court
Bloomfield Hills, Michigan 48012

RECORDED
OAKLAND COUNTY
REGISTERED
82 NOV -9 1 42
LYNN J. ALLEN
CLERK-REGISTRAR

500
dy

STATE OF MICHIGAN)
COUNTY OF OAKLAND) SS:

On this 4th day of November 1982, before me, the subscriber, a notary public in and for said County, appeared Joseph L. Cook and HE IS to me personally known, who being by me duly sworn did say that ~~they are~~ the President of Highland Villa Corporation and said instrument was signed and sealed in behalf of said corporation by authority of its board of directors and JOSEPH L. COOK and acknowledged said instrument to be the free act and deed of said corporation.

Betty J. Augello
Betty J. Augello
Notary Public, County, Michigan

My Commission Expires: Jan 27, 1985

BETTY J. AUGELLO
Notary Public, Oakland County, Michigan
My Commission Expires January 27, 1985

APPENDIX "A"

The East 677.20 feet of Lot 4, Keith Acres a replat of Lots 4 and 5 and part of Lot 10 of Supervisor's plat No. 54, and part of the East 1/2 of the Southeast 1/4 of Section 31, Town 3 North, Range 9 East, Waterford Township, Oakland County, Michigan, according to the Plat thereof as recorded in Liber 77 of Plats, Page 30, Oakland County Records.

77030

(2)

The East 730 feet of Lot 3, Keith Acres, a replat of Lots 4 and 5 and part of Lot 10 of Supervisor's Plat No. 54, and part of the East 1/2 of the southeast 1/4 of Section 31, Town 3 North, Range 9 East, Waterford Township, Oakland County, Michigan, according to the Plat thereof as recorded in Liber 77 of Plats, Page 30, Oakland County Records.

PART OF 13-31-476-004 JK
010 JK

RECORDED RIGHT OF WAY NO.

36182

Striaver

800-441-0758

APPROVED		DATE
BLDG. & PROP. DEPT.		
DIV. ORG.	<i>J. Robertson</i>	11/9/82
INS. DEPT.		
LEGAL DEPT.		
RE & RIW DEPT.		
SYSTEM ENG. DEPT.		
TAX DEPT.		

7
RETURN TO
J. A. ROBERTSON
THE DETROIT EDISON COMPANY
30400 TELEGRAPH ROAD, 272 OAKDE
BIRMINGHAM, MICHIGAN 48010

39/31

Affidavit

LIBER 9306 PAGE 654

STATE OF MICHIGAN

County of Oakland) SS

Leonard P. Lucas, Director Division Engineering & Planning, of The Detroit Edison Company Detroit, Michigan, being duly sworn deposes and says:

THAT Highland Villa Corporation granted an easement to The Detroit Edison Company and the Michigan Bell Telephone Company dated the 4th day of November, 19 82. Said easement was recorded in the office of the Register of Deed of Oakland County, Michigan on the 9th day of November, 19 82 in Liber 8270 Page 507, and being more particularly described as: Township of Waterford, County of Oakland, State of Michigan.

29
OC The East 677.20 ft. of Lot 4, Keith Acres a replat of Lots 4 and 5 and part of Lot 10 of Supervisor's plat No. 54, and part of the East 1/2 of the Southeast 1/4 of Section 31, Town 3 North, Range 9 East, Waterford Township, Oakland County, Michigan, according to the Plat thereof as recorded in Liber 77 of Plats, Page 30, Oakland County Records.

The East 730 ft. of Lot 3, Keith Acres, a replat of Lots 4 and 5 and part of Lot 10 of Supervisor's Plat No. 54, and part of the East 1/2 of the southeast 1/4 of Section 31, Town 3 North, Range 9 East, Waterford Township, Oakland County, Michigan, according to the Plat thereof as recorded in Liber 77 of Plats, Page 30, Oakland County Records.

Also includes part of the villas on the Hill Condo.

Sidwell #13-31-476-004
#13-31-476-010
070 lots OCCP# 283
3and4
77030

Ent 13-31-476-000
9000283

LYNN D. HALLIN
CLERK REGISTER OF DEEDS

OAKLAND COUNTY REGISTER OF DEEDS
86 MAR 14 15:05

RECORDED RIGHT OF WAY NO.

Deponent further states that on behalf of The Detroit Edison Company and the Michigan Bell Telephone Company the underground easement locations, as in said grant provided, are established by a drawing dated November 19, 19 82 and attached hereto, as required in said grant. Public Act 53 of 1974 requires anyone, prior to any power excavating, to telephone Miss Dig on 1-800-482-7171 for exact location of underground equipment.

Further Deponent sayeth not.

The Detroit Edison Company

Witness:

Omer V. Racine
Omer V. Racine
James D. McDonald
James D. McDonald

Leonard P. Lucas (L.S.)
Leonard P. Lucas, Director
Division Engineering & Planning

STATE OF MICHIGAN

SS

COUNTY OF Oakland

The foregoing instrument was acknowledged before me this 27th day of February, 1986, by Leonard P. Lucas, Director Division Engineering and Planning, Detroit Edison Company

Prepared By: Omer V. Racine DEC02
The Detroit Edison Company
30400 Telegraph Rd., 264 ODHq.
Birmingham, MI 48010

Omer V. Racine
Notary Public, _____ County, MI
My Commission Expires: _____

OMER V. RACINE
Notary Public, Oakland County, MI
My Commission Expires May 21, 1986

11.00

MEMORANDUM ORDER
FOR GENERAL USE
DE FORM MS 77 12-53

TO Records Center

DATE 4-2-86 TIME _____

Please set up P/W file for: ROLLING HILLS Coach House Phase 2
Being a part of Southeast 1/2 of Section 31, Waterford Twp
Oakland County, Michigan

COPIES TO: _____

SIGNED

Omer V. Racine

Omer V. Racine
272 Oakland Div. Hqtrs.

REPORT _____

DATE RETURNED _____

TIME _____

SIGNED _____

RECORDED
INDEXED
MAY NO.

3682

To (Supervisor, RE & R/W) J. ROBERTSON	For RE & R/W Dept. Use	Date Received	DE/Bell/C.P. No.
Division OAKLAND	Date 4-29-82	Application No. OE-82-2J	

We have included the following necessary material and information:

Material:

- A. Proposed Subdivision
 - 1. copy of complete final proposed plat - All pages
- or
- B. Other than proposed subdivision (condo., apts. mobile home park — other)
 - 1. Property description.
 - 2. Site plan.
 - 3. title information (deed, title commitment, contract with title commitment, or title search).

Note: Do not submit application for URD easements until all above material has been acquired.

Information

1. Project Name ROLLING HILLS COACH HOUSES	County OAKLAND
City/Township/Village WATERFORD TWP.	Section No. 31
Type of Development <input type="checkbox"/> Proposed Subdivision <input type="checkbox"/> Apartment Complex <input checked="" type="checkbox"/> Condominium <input type="checkbox"/> Subdivision <input type="checkbox"/> Mobile Home Park <input type="checkbox"/> Other	Phone No.
2. Name of Owner JOSEPH L. COOK	Phone No.
Address 3921 KIRKLAND CT. - BLOOMFIELD HILLS, MICH 48013	
Owner's Representative	Phone No. 626-1269
Date Service is Wanted 7-1-82	
4. Entire Project will be developed at one time <input type="checkbox"/> Yes <input checked="" type="checkbox"/> No	
5. Joint easements required — Michigan Bell Telephone <input checked="" type="checkbox"/> Yes <input type="checkbox"/> No — Consumers Power <input type="checkbox"/> Yes <input type="checkbox"/> No	
a. Name of Other Utilities If Not Michigan Bell Telephone or Consumers Power	
b. Other Utility Engineer Names	Phone Numbers
Addresses	

RECORDED RIGHT OF WAY NO. 36192

6. Additional Information or Comments

TAKE BLANKET EASEMENT BUILDING 2A-2B AT THIS TIME

Note: Trenching letter attached will be submitted later

Service Planner THOMAS E. WILSON	Signed (Service Planning Supervisor)
Phone No. 645-4131	Address PM 240 OAKLAND DIV. H.Q.

**Detroit
Edison**

Oakland Division
30400 Telegraph Road
Birmingham, Michigan 48010
(313) 645-4000

Phone 645-4378

August 25, 1982

Joseph Cook
3921 Kirkland Court
Bloomfield Hills, MI 48013

Gentlemen:

RE: Rolling Hills Coach Houses - Phase 2

Pursuant to our letter of May 7, 1982, we have not received, as yet, the executed easement necessary to proceed with your underground service for the aforementioned project.

Prompt return of these instruments, fully completed, will assist in prompt scheduling of our work to be completed in your project. Please return all documents addressed to: The Detroit Edison Company, 30400 Telegraph Road, Birmingham, Michigan, 48010, Attn: James McDonald, Room 272.

Sincerely,

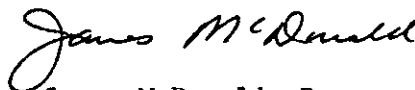

James McDonald, Representative
Real Estate, Rights of Way & Claims

JM:klm

RECORDED RIGHT OF WAY NO.

36182

MEMORANDUM ORDER
FOR GENERAL USE
OF FORM WS 77 12-82

TO TOM WILSON DATE 11-5-82 TIME _____

Re: Underground Service - Rolling Hills Coach House Phase II
Agreement and Easements obtained - OK to proceed with construction.

COPIES TO: _____
REPORT _____

SIGNED John C Greenlee
Emer V. Racine, Representative
Real Estate, Rights of Way & Claims
272 Oakland Division Headquarters

DATE RETURNED _____ TIME _____ SIGNED _____

RECORDED RIGHT OF WAY NO.

136182

KNOW ALL MEN BY THESE PRESENTS: That **Marion E. Locklin**
2140 Loehaven Road, Union Lake, Michigan

9
3/3

Conveys and Warrants to **Highland Villa Corporation, a Michigan Corporation.**

whose Street Number and Post Office address is **3921 Kirkland Court, Bloomfield Hills, Mich.**

the following described premises situated in the **Township of Waterford** County of **Oakland**
and State of Michigan, to-wit:

The East 677.20' of Lot 4, Keith Acres, a replat of Lots 4 and 5 and part of Lot 10 of Supervisor's plat No. 54, and part of the East 1/2 of the Southeast 1/4 of Section 31, Town 3 North, Range 9 East, Waterford Township, Oakland County, Michigan, according to the Plat thereof as recorded in Liber 77 of Plats, page 30, Oakland County Records.

together with all and singular the tenements, hereditaments and appurtenances thereunto belonging or in anywise appertaining
for the sum of **the sum of One Dollar.** One Dollar(s)

and other valuable considerations, **8.75.**

subject to

Dated this **29th** day of **June** A. D. 19 **72**
Signed, Sealed and Delivered in Presence of:

Francis M. Asha
FRANCIS M. ASHTA
Eva Piskowski
EVA PISKOWSKI

Marion E. Locklin
Marion E. Locklin

RECORDED
OAKLAND COUNTY REGISTER
1972 MAR 10 PM 4:45
CLERK-RICHARD B. BROWN

In the STATE OF MICHIGAN, COUNTY OF **Oakland**
On this **29th** day of **June** A. D. 19 **72**
appeared **Marion E. Locklin** before me personally

to me known to be the person described in and who executed the foregoing instrument and acknowledged that she executed the same as **her** free act and deed.

My commission expires **A. D. 19**

Instrument
Drafted by **Joseph L. Cook**

Rosemary A. Mayer
ROSEMARY A. MAYER
Notary Public, Oakland County, Michigan
My Commission Expires August 18, 1972

3921 KIRKLAND COURT, Bloomfield Hills, Mich.
County Treasurer's Certificate
No. **3110** 19 **77**
I HEREBY CERTIFY that there are no TAX LAINS or TILES held by the State or any Individual against the within described in, or all TAXES on same are paid for five years previous to the date of this instrument, as appears by the records in this office except as stated.
048222
R. Hugh S. ... OLA

Recording Fee **5.00**

When recorded return to **Gtee**
3921 Kirkland Court Bl. Hills, Mich.

U. S. Revenue Stamps
Part of: 13-31-476-004

TITLE INSURANCE... ABSTRACTS... ESCROWS

TITLE INSURANCE... ABSTRACTS... ESCROWS

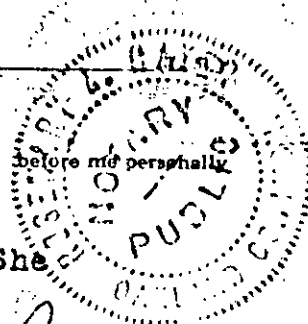

RECORDED RIGHT OF WAY NO. 36192

F-561-7-62

3-9
31

KNOW ALL MEN BY THESE PRESENTS: That Marion E. Locklin
2140 Lochaven Road, Union Lake, Michigan

Conveys and Warrants to Highland Villa Corporation, a Michigan Corporation.

whose Street Number and Post Office address is 3921 Kirkland Court, Bloomfield Hills, Michigan
48013.

the following described premises situated in the Township of Waterford County of Oakland
and State of Michigan, to-wit:

The East 730' of Lot 3, Keith Acres, a replat of Lots 4 and 5 and part of Lot 10 of Supervisor's Plat No. 54, and part of the East 1/2 of the Southeast 1/4 of Section 31, Town 3 North, Range 9 East, Waterford Township, Oakland County, Michigan, according to the Plat thereof as recorded in Liber 77 of Plats, Page 30, Oakland County Records.

together with all and singular the tenements, hereditaments and appurtenances thereunto belonging or in anywise appertaining
for the sum of the Sum of One Dollar. One Dollar (s)

and other valuable considerations, 92c.

subject to

Dated this 29th day of June A. D. 1972
Signed, Sealed and Delivered in Presence of:

Signed and Sealed Marion E. Locklin

FRANCES M. ASHTA
EVA PISKOWSKI

Marion E. Locklin (L.S.)
(L.S.)

In the STATE OF MICHIGAN, COUNTY OF Oakland ss.
On this 29th day of June A. D. 1972
appeared Marion E. Locklin

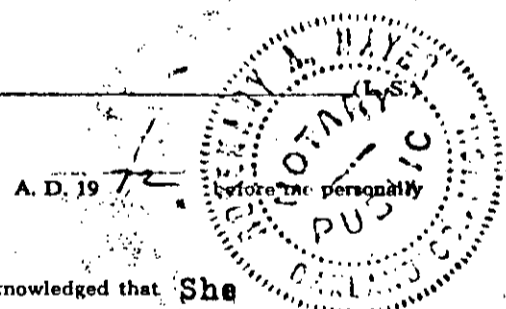

to me known to be the person described in and who executed the foregoing instrument and acknowledged that She
executed the same as her free act and deed.

My commission expires A. D. 19

ROSEMARY A. MAYER
Notary Public, Oakland County, Michigan
My Commission Expires August 10, 1972

Instrument
Drafted by- Joseph L. Cook
3921 KIRKLAND COURT, Bloomfield Hills
Oakland County, Michigan

City Treasurer's Certificate

No. 3720 1972
I HEREBY CERTIFY that there are no TAX
LEINS or TITLES held by the State or any
individual against the within described land, and
all TAXES on same are paid for 3 years
previous to the date of this instrument, as
appears by the records in this office except
as stated.
100
D4821
E.A.S. DLA

Recording Fee C. HUGH DEBANY, County Treasurer 3.00
U. S. Revenue Stamps

When recorded return to Gtee
3921 Kirkland Court
Bloomfield Hills, Michigan 48013

13-31-476-003

TITLE INSURANCE... ABSTRACTS... ESCROWS

TITLE INSURANCE... ABSTRACTS... ESCROWS

RECORDED RIGHT OF WAY NO. 36192

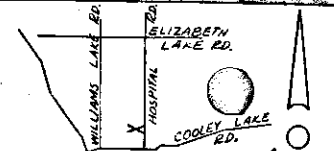

LOCATION SKETCH
MAP SEC. NO.

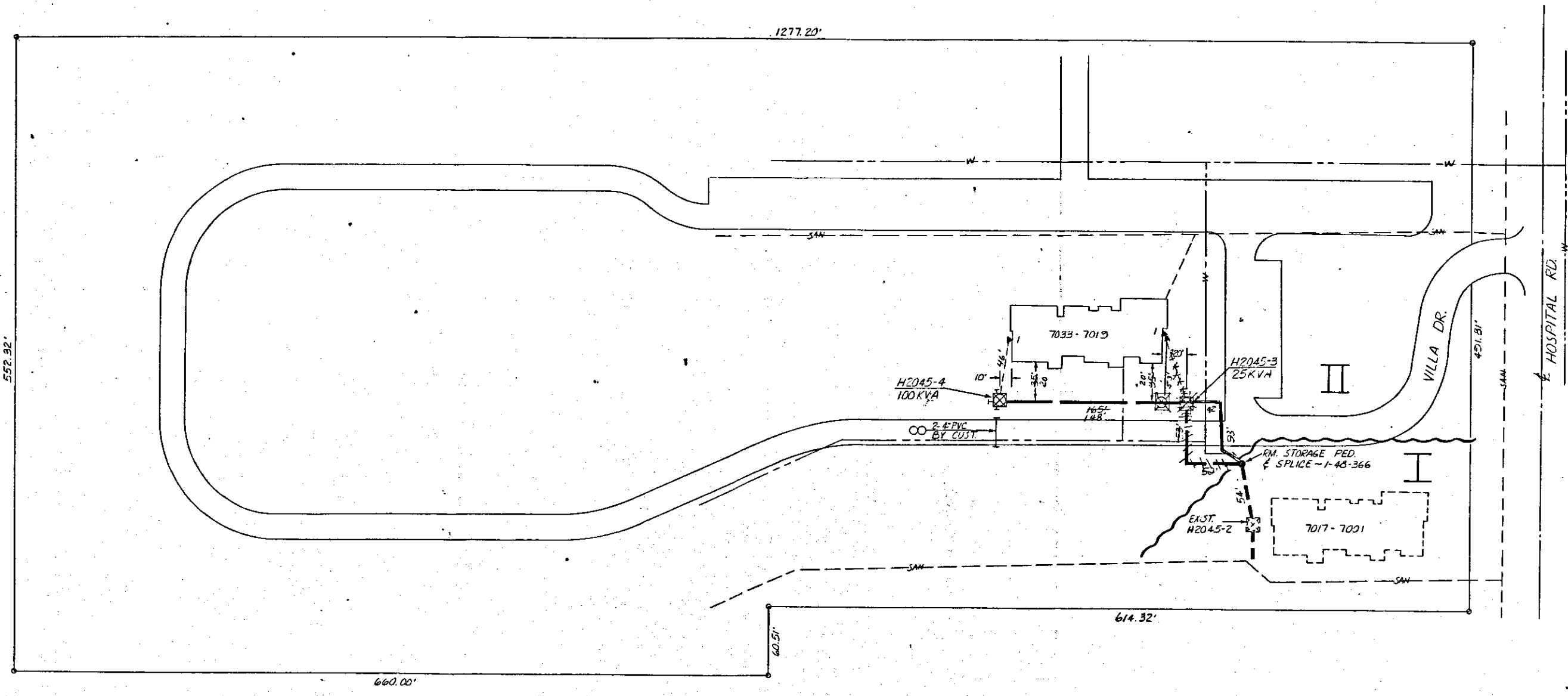

TRANSFORMER DATA

U.D.T. NO.	SIZE	ED. STK. NO.
H2045-3	25 KVA	
-4	100 KVA	

TRANSFORMER SPECS 1-17-261
 PEDESTAL SPEC. _____
 NO. OF PEDESTALS _____
 NO. OF TEMPORARY CABLE MARKERS _____
 TEMPORARY CABLE MARKER SPEC. _____
 SECONDARY CONNECTION BOX SPEC. _____

- CODE —**
- ⊕ TEMPORARY SECONDARY PEDESTAL/TEMPORARY CABLE MARKER
 - ⊞ DFT (DEAD FRONT TYPE)
 - ⊞ LOT (NON-SWITCHING—LIVE FRONT TYPE)
 - ⊞ LOT (SWITCHING—LIVE FRONT TYPE)
 - ⊞ DIRECTION OF TRANSFORMER DOOR OPENING
 - ⊞ SECONDARY PEDESTAL
 - ⊞ SECONDARY CONNECTION BOX
 - ⊞ CABLE POLE
 - ⊞ PRIMARY SWITCH CABINET
 - ⊞ BURIED PRIMARY CABLE—ALL VOLTAGES
 - ⊞ BURIED SECONDARY CABLE
 - ⊞ BURIED SECONDARY SERVICE CABLE
 - ⊞ DETROIT EDISON TRENCH ONLY
 - ⊞ TELEPHONE TRENCH ONLY
 - ⊞ SEWER
 - ⊞ WATER
 - ⊞ GAS
 - ⊞ PROPOSED CONDUIT
 - ⊞ SEP CONN CABINET

CABLE SUMMARY

ITEM #	DESCRIPTION	LENGTH	ITEM #	DESCRIPTION	LENGTH
713002	AP2300 & 1-40 800 V.	283'	713003	AP2300 & 1-41 800 V.	99'
713014	AP2300 & 1-41 800 V.	382'			

TRENCH SUMMARY

JOINT USE	LENGTH
D.E. ONLY	283'
TEL. ONLY	99'
GAS ONLY	
OTHERS	
TOTAL	382'

SITE SUIPT: JOSEPH COOK PHONE NO. 626-1262

RECORDED RIGHT OF WAY
36182

— GENERAL NOTES —

TRENCHING TO BE DONE BY D.E. CO.
 TRENCH AND CABLE LENGTHS ARE APPROXIMATE.
 SEE SECTION 56 UG LINE CONSTRUCTION STANDARDS FOR TRANS. MAT. DETAILS.
 SEE PAGE 32-11 (S.I.M.) DETAIL " " FOR ENTRANCE POINT DETAILS (APTS. ONLY)
 SEE SECTION 43 UG LINE CONSTRUCTION STANDARDS FOR PLACEMENT OF CABLES.
 (TRANSFORMERS AND PEDESTALS (SUB'DS) ONLY)
 D.E. SERVICE PLANNER: T. WILSON - 645-4131
 TEL. CO.: W. BERTOLET - 540-0201
 GAS CO.: _____
 OTHERS: _____

CONTACT "MISS DIG" (800-487-1719) BEFORE DOING ANY EXCAVATION.
 EASEMENTS INDICATED BY OUR CENTERLINE ARE IN WIDTH UNLESS OTHERWISE NOTED.

PERMITS REQUIRED

CITY OF _____ COUNTY NOTIFICATION ONLY YES

RETURN TO
 J. D. McDONALD
 THE DETROIT EDISON COMPANY
 30400 TELEGRAPH ROAD, 264 OAKDH
 BIRMINGHAM, MICHIGAN 48010

REVISION	REVISION	REVISION	REVISION	REVISION	NAME	DATE	JOB TITLE
D							
C							
B							
A							

AS INSTALLED
 DO A-64743
 NO 367843679
 START 11-11-82
 FINISH 11-11-82
 NOTES BY CAMERON
 ENG CREW #3031 11-19-82

REFERENCE
 PHASE I - NOA-6333
 SKD WFL-55

DRAWN BY: L. ST. HAK
 CHECKED BY: [Signature]
 APPROVED BY: [Signature] 6-15-82

START DATE: 6-25-82

ROLLING HILLS COACH HOUSES
 A REPEAT OF LOTS 485 & PART OF LOT 10
 OF SUBDIVISIONS PLAT No. 54
 E 1/2 OF S.E. 1/4 SEC. 31
 L. 77 P. 30

THE DETROIT EDISON COMPANY
 SERVICE PLANNING

SCALE: 1" = 50'
 NUMBER OF UNITS: 3
 WORK ORDER NUMBER: 367843679

LATEST REVISION: DISTRIBUTION CIRCUIT 13.2 KV
 (16.75 (MIN) IN L.A. (1310-11P))

DEPT. ORDER NUMBER: 82A-64743
 SHEET: 1 OF 1 SHEETS

36182

RECORDED RIGHT OF WAY NO. 36182

TO THEIR OWNERS