

RE-RECORDED

PLYMOUTH TRAIL CONDOMINIUMS

G919129

G829583

LI 22001 PA 299

LI 22354 PA 028

Detroit Edison

Right of Way Agreement

RECORDED MAY 8 1984 AT 1:08 P.M. O'CLOCK

FOREST E. YOUNGBLOOD, Register of Deeds WAYNE COUNTY, MICHIGAN 48226

APRIL 30TH, 19 84

For valuable consideration, the receipt of which is hereby acknowledged, the undersigned hereby grant and convey to CONSUMERS POWER COMPANY, a Michigan corporation of 212 Michigan Avenue, Jackson, Michigan, THE DETROIT EDISON COMPANY, a corporation organized and existing concurrently under the laws of the States of Michigan and New York, of 2000 Second Avenue, Detroit, Michigan 48226 and the MICHIGAN BELL TELEPHONE COMPANY, a Michigan corporation, of 444 Michigan Avenue, Detroit, Michigan 48226 hereinafter referred to as "UTILITIES", the easement and right to erect, lay, maintain, reconstruct and replace underground facilities consisting of wires, cables, conduits, fixtures, piping, venting, gas facilities and appurtenances including the necessary above ground equipment, connections, poles and accessories which may from time to time be required for transmitting and distributing electricity, providing communication services and gas facilities with the usual services connections and accessories in, under, upon, over and across the land located in the City of Plymouth, Wayne County, Michigan, and more particularly described on the attached Appendix "A"; with the full right to the UTILITIES of ingress and egress upon said land for the purposes of this grant, and the further right to trim, cut down or otherwise control brush and trees within the easements herein described.

Said easements shall be 6' (six) feet in width unless otherwise indicated and their route is described as follows:

4(b) The exact location of said easements will be shown on a drawing to be recorded within 90 days after construction.

In order to provide for the proper maintenance and protection of UTILITIES, the undersigned covenant and agree that:

1. The easements will be graded to within four (4) inches of final grade before the UTILITIES lines are installed and this ground elevation must be maintained after installation of utilities to avoid the pooling of water in, on or around above ground UTILITIES equipment.

2. No buildings or structures other than UTILITIES equipment are to be placed within the easements herein granted. No excavation is to be permitted within said easement without approval of UTILITIES.

3. If the lines or facilities of UTILITIES' are damaged by the acts of Owners, their agents, employes or contractors, repairs shall be made by the Utility company so damaged at the cost and expense of Owners. Owners are defined as those persons owning the land at the time the damage occurred.

4. No shrubs or foliage shall be planted or grown within five (5) feet of the front door of transformers or switching cabinet enclosures. UTILITIES shall not be responsible to Owners for damages to or removal of trees or plant life planted in front of said door or within the easement causing an interference with UTILITIES maintenance of their equipment.

THIS GRANT is declared to be binding upon the heirs, successors, lessees, licenses and assigns of the parties hereto.

IN WITNESS WHEREOF, the undersigned have hereunto set their hand and seal on this date:

Witnesses:

Grantors:

PLYMOUTH TRAIL INVESTMENT COMPANY A Michigan Co-Partnership

RECORDED APR 30 1985 AT 10:01 P.M. O'CLOCK FOREST E. YOUNGBLOOD, Register of Deeds WAYNE COUNTY, MICHIGAN 48226

Isabelle Rose Eathorne

Allen Menuck - PARTNER Arthur Gerish - PARTNER

RICHARD J. SMITH

Prepared By: C. George Williams

Address: 25950 Five Mile Road

8001 Haggerty Rd. S., Belleville, MI., 48111

Detroit, Michigan, 48239

THIS EASEMENT IS RE-RECORDED FOR PURPOSES OF SHOWING THE PLANNED "AS INSTALLED" CENTERLINES OF EASEMENTS GRANTED AS SHOWN ON DRAWING ATTACHED HERETO.

RECORDED RIGHT OF WAY NO. 35004 G919129 G829583

RECORDED

RECEIVED
MAY 10 1964
U.S. DEPARTMENT OF JUSTICE
FEDERAL BUREAU OF INVESTIGATION

RETURN TO: *Det. Carson*
Real Estate, R/W & Claims
8001 Haggerty Rd. South *Rm 139*
Belleville, Michigan 48111

CROSS REFERENCE

NAME OR SUBJECT RECORDED RIGHT-OF-WAY NO. 35004

FILE NO.

REGARDING Indenture of Release (2597/14), Bankers
Trust Company to The Detroit Edison
Company, covering the release of real
estate in the West half of the Northwest
quarter of the Southwest quarter of Section
6, Ypsilanti Township.

DATE December 26, 1991

SEE

MORTGAGES - GENERAL AND REFUNDING

NAME OR SUBJECT Release from Lien of Mortgage

FILE NO.

Release No. 462

LI 22001 PA 300

LI 22354 PA 029

State of Michigan)
County of Wayne)SS

On this 30th day of April, 1984, before me, a Notary Public in and for said County, personally appeared, Allen Menuck and Arthur Gerish, partners doing business as PLYMOUTH TRAIL INVESTMENT COMPANY, a Michigan Co-partnership, to me known and who executed the within instrument and acknowledged the same to be their free act and deed for the Co-partnership.

My Commission expires:

7/7/86

Isabelle Rose Eathorne
Isabelle Rose Eathorne
Notary Public, Oakland County, Michigan
Acting in Wayne County Michigan

RECORDED RIGHT OF WAY NO. 35004

APPENDIX "A"

Part of the SW 1/4 of Section 26, T.1S., R.8E., described as:

Lots 692, 693, 694, 695, and the Northerly 1/2 of Lots 691, 696, & 697, Assessor's Plymouth Plat No. 19, as recorded in Liber 67, Page 26, of plats, Wayne County Records. Subject to easement of record.

8-8 24 4390 25/ A 0015

RECEIVED
WAYNE COUNTY, MICH.

1984 MAY 8 PM 1 08

RE-RECORD

FOREST E. YOUNGBLOOD
REGISTER OF DEEDS

500

RE-RECORD

RETURN TO: *Met. Edison*
Real Estate, R/W & Claims
8001 Haggerty Rd. South *Rm 134*
Belleville, Michigan 48114



13.2KV ISO-UP

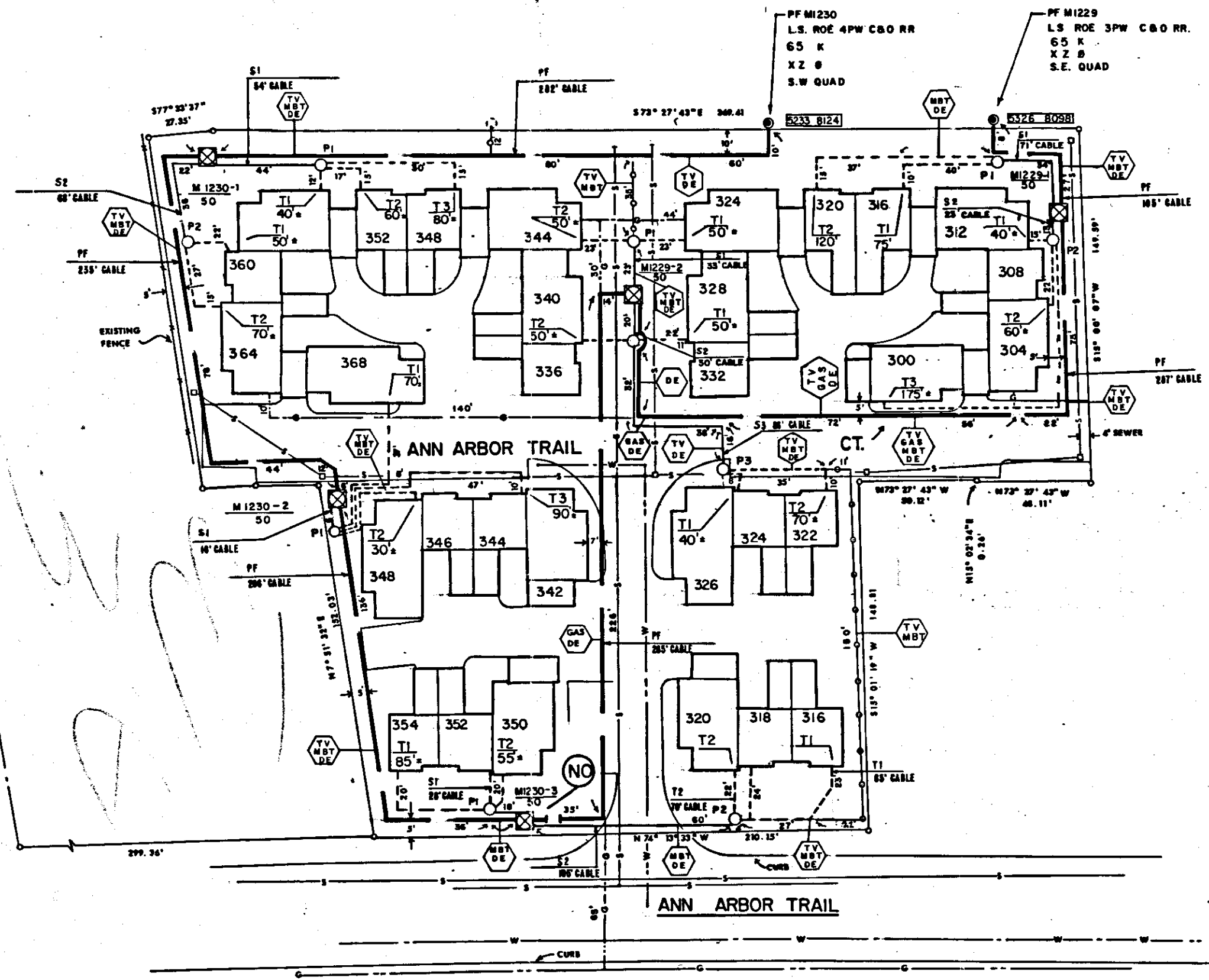

LOCATION SKETCH

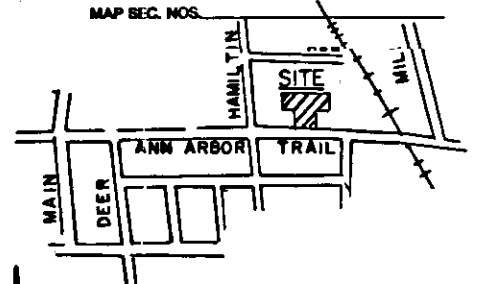

TRANSFORMER DATA

U.D.T. NO.	SIZE	ED. STK. NO.
M 1229-1	50 KVA	661-1152
-2		
M 1230-1	50 KVA	661-1152
-2		
-3		

TRANSFORMER SPEC.	1-17-261
PEDESTAL SPEC.	1-9-231
NO. OF PEDESTALS	10
NO. OF TEMPORARY CABLE MARKERS	
TEMPORARY CABLE MARKER SPEC.	
SECONDARY CONNECTION BOX SPEC.	

CODE

- ⊕ TEMPORARY SECONDARY PEDESTAL/TEMPORARY CABLE MARKER
- ⊞ DFT (DEAD FRONT TYPE)
- ⊞ UOT (NON-SWITCHING-LIVE FRONT TYPE)
- ⊞ UOT (SWITCHING-LIVE FRONT TYPE)
- ↔ DIRECTION OF TRANSFORMER DOOR OPENING
- SECONDARY PEDESTAL
- ⊞ SECONDARY CONNECTION BOX
- ⊞ CABLE POLE
- ⊞ PRIMARY SWITCH CABINET
- BURIED PRIMARY CABLE—ALL VOLTAGES
- BURIED SECONDARY CABLE
- BURIED SECONDARY SERVICE CABLE
- DETROIT EDISON TRENCH ONLY
- TELEPHONE TRENCH ONLY
- SEWER
- WATER
- GAS
- PROPOSED CONDUIT
- SEP CONN CABINET

RECORDED RIGHT OF WAY NO. 35004

TRENCH SUMMARY SERVICE TRENCH

TV, GAS, MBT & DE	0'	65'
TV, MBT & DE	679'	298'
TV & DE	86'	
TV & MBT	208'	77'
MBT & DE	106'	
GAS	289'	
GAS & DE	262'	
MBT	12'	
DE	50'	437'
TV, GAS & DE	70'	
TOTAL	1816' ±	867' ±

CABLE SUMMARY

ITEM # 435	6X1/2" x 2 1/2" 13.2 KV	713-3064 = 1500' ±
ITEM # 437	AP2-300M & 1-40 800 V.	713-0537 = 600' ±
ITEM # 399	AP2-20 & 1-41 800 V.	713-0614 = 1255' ±

TOTAL SITE SUPT. PHONE NO.

GENERAL NOTES

TRENCHING TO BE DONE BY MBT

TRENCH AND CABLE LENGTHS ARE APPROXIMATE.

SEE SECTION 58 UG LINE CONSTRUCTION STANDARDS FOR TRANS. MAT. DETAILS.

SEE PAGE 3-11 S.I.M. DETAIL " " FOR ENTRANCE POINT DETAILS (APTS. ONLY)

SEE SECTION 43 UG LINE CONSTRUCTION STANDARDS FOR PLACEMENT OF CABLES, TRANSFORMERS AND PEDESTALS (SUBDS ONLY)

D.E. SERVICE PLANNER: A. GERHARDT 397-4079

TEL. CO.: D. SKINNER 459-9935

GAS CO.: B. VERESAN 427-5100

OTHERS: OMNICON C. MAES 459-7300

CONTACT "MISS DIG" (800-482-7171) BEFORE DOING ANY EXCAVATION.

EASEMENTS INDICATED BY OUR CENTERLINE ARE IN WIDTH UNLESS OTHERWISE NOTED.

PERMITS REQUIRED

CITY OF STATE YES NO COUNTY, NOTIFICATION ONLY

REAR DRIVE TO DET. 13212000
REGISTERED FOR
FOR ESTATE OF
PLANNING

HAMILTON AVE.

TITLE BLOCK

D.O. A-34086

W.O. 367B13J925

START 7-16-84

FINISH 7-19-84

LABOR CORBY ENERGY

RECORDS L. MEEKER

R 35004

D	C	B	A	REFERENCE	NAME	DATE	JOB TITLE	THE DETROIT EDISON COMPANY SERVICE PLANNING		
		AS INSTALLED IN FIELD FOR RECORDING	ADD CABLE TV	1-232-318 WRD PLY-50	R. KULL	3-21-84	PLYMOUTH TRAIL CONDOMINIUMS PART OF THE S.W. 1/4 SEC. 26, T.15., R.8E. LOTS 692 THRU 695 AND N.1/2 OF LOTS 691, 696 AND 697 PLY. PLAT NO. 19, L. 67, PG. 26 CITY OF PLYMOUTH	SCALE 1" = 30'	NUMBER OF UNITS 31	WORK ORDER NUMBER 367B13J925
					CHECKED BY <u>A. GERHARDT</u>	3-21-84		LATEST REVISION "B"	DISTRIBUTION CIRCUIT 306 PLYMO-ISO-UP	DEPT. ORDER NUMBER A-34086
					APPROVED BY <u>R. FRANK</u>	4-11-84				
					DRAWN BY <u>B. WILDE</u>	3-28-84				
					CHECKED BY <u>G.R.R.</u>	5-4-84				
					APPROVED BY <u>G.R.R.</u>	6-5-84				

RETURN TO: *DET. EASON*
Real Estate, R/W & Claims - *133*
8001 Haggerty Rd. South
Belleville, Michigan 48114

RETURN TO: *DET. EASON*
Real Estate, R/W & Claims
8001 Haggerty Rd. South
Belleville, Michigan 48114
RM-4894

FOREST E. YOUNGBLOOD
REGISTER OF DEEDS
WAYNE COUNTY, MI.

85 APR 30 10:07

1985 133