

# GRAND TRUNK WESTERN RAILROAD COMPANY

DETROIT DIVISION

RIGHTS OF WAY  
DEPARTMENT  
*JRP*

V. C. PALMER  
SUPERINTENDENT

7350 ORLEANS STREET,  
DETROIT 11, MICH

1952 AUG 7 AM 10 04

August 6, 1952

File: 4730-4-67

Mr. R. H. Taylor, Right of Way Agent  
The Detroit Edison Company  
2000 Second Avenue  
Detroit 26, Michigan

Dear Sir:

Kindly refer to your letter of July 17, plan  
RX-674A, asking for a waiver of hearing in connection with your  
desire to construct an overhead crossing of our tracks 1400 ft.  
west of New Haven Road, S.W. quarter, Section 33, Lenox Township,  
Macomb County, Michigan, at our Mile Post 31.88, Mt. Clemens  
Subdivision.

Inasmuch as we have no objections to this installation  
as proposed and as you have stated that all work will be done in  
accordance with the rules and regulations of the Commission, I hereby  
grant you waiver of hearing.

A new license will not be required as the license  
dated February 1st, 1928 adequately covers.

Yours very truly,

*V. C. Palmer*  
Superintendent

A/1

*Large agreement  
on permit  
under B/W 9064  
2-1-28*

RECORDED RIGHT OF WAY NO.

*34636  
P89*

STATE OF MICHIGAN  
BEFORE MICHIGAN PUBLIC SERVICE COMMISSION

Standard Railroad Wire-Crossing Permit No. RD2-8-3069

In Re Application of **Detroit Edison Company**  
**Detroit, Michigan**

Pursuant to Act No. 171 of the Session Laws of 1893, as amended, application having been made to Michigan Public Service Commission by said

**Detroit Edison Company**

for permission to string wires across the tracks of the

**Grand Trunk Western Railroad**

and said

**Detroit Edison Company**

having conformed to the Commission's rules governing the filing of notices and issuing of permits for the construction of electrical lines and said railroad company having waived the right of notice and hearing provided for in said act

THEREFORE, It is ordered that said

**Detroit Edison Company**

be permitted to string the following described wires across the tracks of said railroad at the following described place:

Township of Lenex  
County of Macomb  
State of Michigan

Crossing of St. Clair-Northeast 3-4 120 kv steel tower line, at a point 600' south of mile post #32 & approx. 3180' north of 26 mile rd., & 1400' west of New Haven Rd. 2 - 120,000 volt, 60 cycle, 3-phase 6 - 795 mm ACER, 1- 3/8" Beth. Steel grd. wire.

as indicated on the attached plans, when, as and if approved.

At the point of crossing said wires shall be constructed in accordance with this Commission's rules and regulations.

(SEAL)

Given under our hands and the Official Seal of this Commission at the City of Lansing, State of Michigan, this **eighth** day of **August** A. D. 19**52**.

MICHIGAN PUBLIC SERVICE COMMISSION  
By

**J. H. McCarthy**

Chairman,

**M. K. Hunt**

Commissioner,

**J. M. Veale**

Commissioner.

Countersigned

**S. A. Lund**

Secretary

RECORDED RIGHT OF WAY NO. 34636  
1989

RIGHTS OF WAY  
DEPARTMENT

1952 AUG 18 PM 12 32

STATE OF MICHIGAN  
Office of the Michigan Public Service Commission } ss.

I, **S. A. Lund**, Secretary of the Michigan Public Service Commission

Do Hereby Certify, That I have compared the annexed copy of **a wire crossing**  
**Permit No. ED2-8-3069**

RIGHTS OF WAY  
DEPARTMENT

1952 AUG 18 PM 12 30

with the original **Permit**

recorded in **ED2-8-3069**

and that it is a true and correct transcript therefrom, and of the whole of such original.

In Testimony Whereof, I have hereunto set my hand and affixed

the seal of the Commission, at Lansing, this **eighth**

day of **August** in the year of our Lord

one thousand nine hundred **fifty-two.**

Secretary Michigan Public Service Commission

RECORDED RIGHT OF WAY NO.

34636  
189

DATA SHEET TO ACCOMPANY DRAWING RX-674A

Revision of RX 674 Permit U-4172

Name of Company

The Detroit Edison Company

Name and Location of Crossing

Crossing of the St. Clair-Northeast 3-4 120 Kv steel tower line over the Grand Trunk Western Railroad at a point 640' south of mile post #32 and approximately 3180' north of 26 Mile Road and 1400' west of New Haven Road in Lenox Township, Macomb County, Michigan.

Circuits

Two 120,000 volt 60 cycle, 3-wire, 3-phase transmission circuits with one ground wire.

Conductors

Six conductors of 795 Mcm 26 al/7st ACSR and one 3/8" Bethanized steel ground wire.

Towers and Crossarms

Steel towers and crossarms as per photostats T-2955 and T-8415.

Pins, Insulators and Ties

Suspension details as shown on RX-674A.

Guy and Guy Attachments

None

Guy Clamps and Insulators

None

Guy Anchors

None

Anchor Rods

None

Electrical Engineering Division  
Engineering Department  
JSW:dc

July 15, 1952

RECORDED RIGHT OF WAY NO. 34636  
P89

RECORDED RIGHT OF WAY NO. 34636

P89

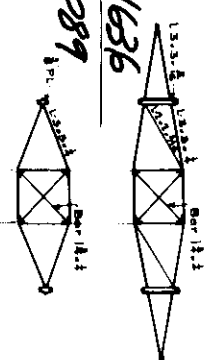

DETAIL AT END OF CROSSARM

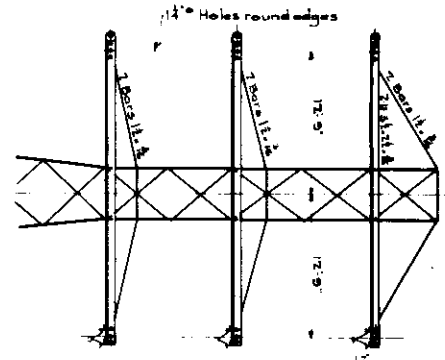

CROSSARM ARRANGEMENT FOR ANGLES IN LINE UP TO 10°

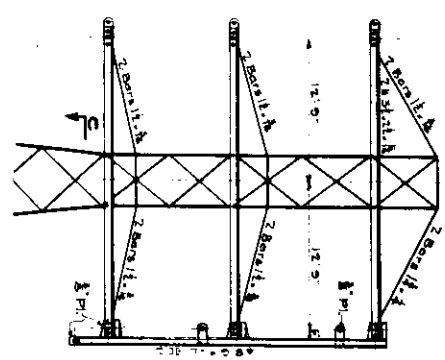

CROSSARM ARRANGEMENT FOR ANGLES IN LINE UP TO 45°

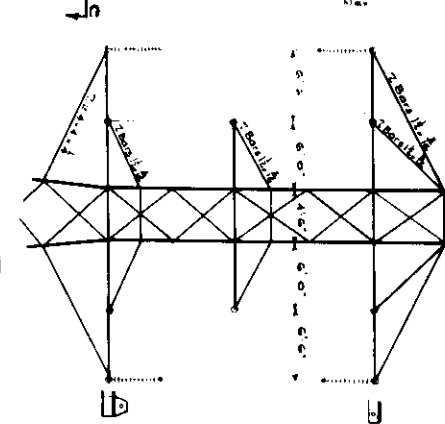

TRANSITION TOWER PATTERN FOR SPAN BETWEEN BARS AS TOWER EA

No.	Max Stress	Section
1	10.1	L 4 x 4 x 1/2
2	4.8	L 5 x 5 x 3/8
3	4.1	L 6 x 6 x 3/8
4	4.5	L 6 x 6 x 3/8
5	14.9	L 6 x 6 x 3/8
6	14.9	L 6 x 6 x 3/8
7	14.9	L 6 x 6 x 3/8
8	14.9	L 6 x 6 x 3/8
9	14.9	L 6 x 6 x 3/8
10	14.9	L 6 x 6 x 3/8
11	10.2	L 6 x 6 x 3/8
12	11.3	L 6 x 6 x 3/8
13	5.7	L 6 x 6 x 3/8
14	2.8	L 6 x 6 x 3/8
15	11.3	L 6 x 6 x 3/8
16	6.0	L 6 x 6 x 3/8
17	7.8	L 6 x 6 x 3/8
18	8.0	L 6 x 6 x 3/8
19	8.1	L 6 x 6 x 3/8
20	9.1	L 6 x 6 x 3/8
21	3.4	L 6 x 6 x 3/8
22	2.0	L 6 x 6 x 3/8
23	11.1	L 6 x 6 x 3/8
24	14.6	L 6 x 6 x 3/8
25	4.1	L 6 x 6 x 3/8
26	2.2	L 6 x 6 x 3/8
27	4.1	L 6 x 6 x 3/8
28	13.4	L 6 x 6 x 3/8
29	15.1	L 6 x 6 x 3/8
30	17.4	L 6 x 6 x 3/8
31	5.4	L 6 x 6 x 3/8

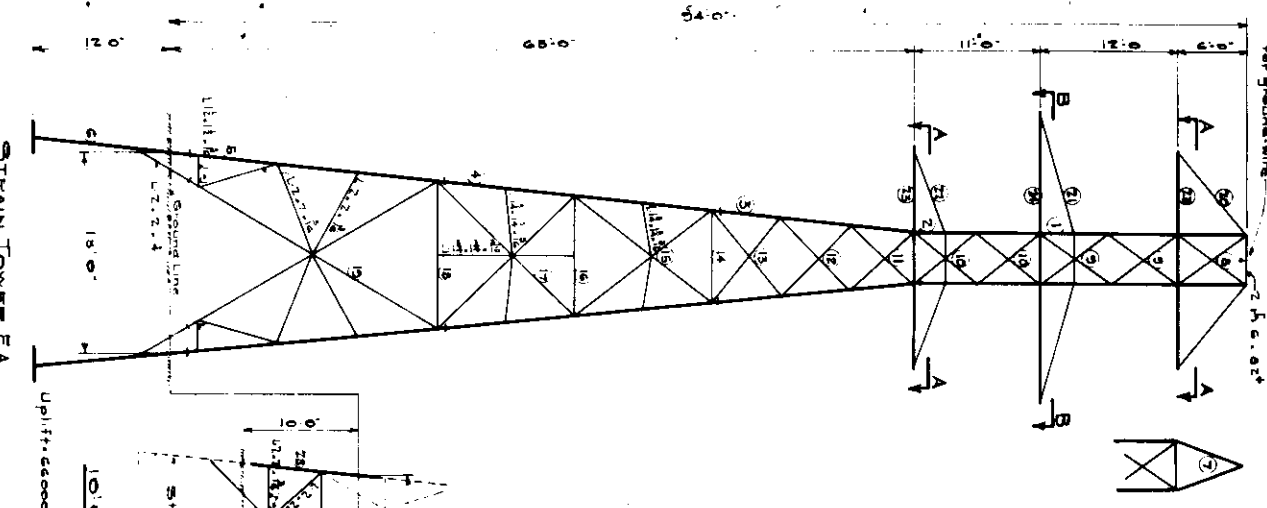

STRAIN TOWER EA

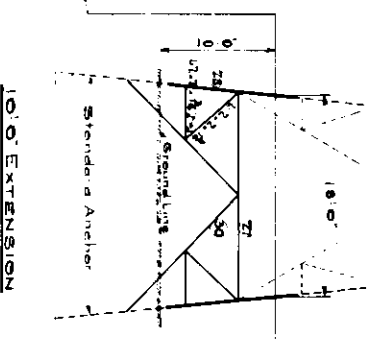

10' 0" EXTENSION

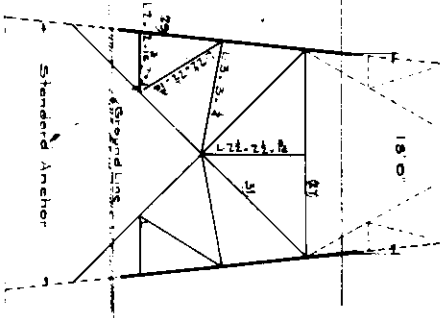

20' 0" EXTENSION

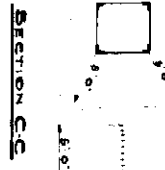

SECTION CC

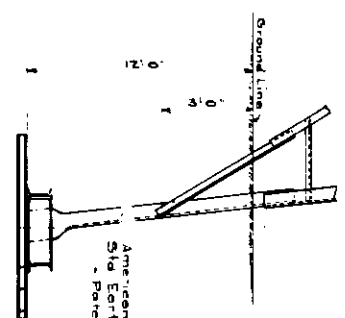

American Bridge Co. Standard Earth Anchor - Patented

SEALING MATERIAL  
 2 1/2" x 10" x 1/2" - 16.5' - 7.5'  
 1 1/2" x 10" x 1/2" - 20' - 6.0'  
 1 1/2" x 7" x 1/2" - 1.4' - 7.0'  
 1 1/2" x 7" x 1/2" - 1.4' - 7.0'  
 1 1/2" x 7" x 1/2" - 1.4' - 7.0'

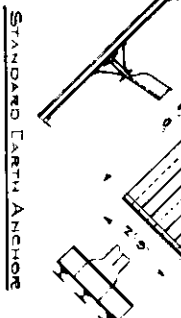

STANDARD EARTH ANCHOR

- LOADS**
1. Vertical load at each cable support of 1500' total size
  2. A horizontal load normal to the line of each cable support of 600' total size
  3. A horizontal load in the direction of the line of 3500' at each cable support, total 74500' or 4100' at any one cable support
  4. Wind on tower of 30' per lin. ft. of height
  5. Dead load of tower
  6. A torsional load in the direction of the line of 3500' at each of 5 cables on one side of the tower, total 10500'

**NOTE:**  
 For unit stresses and specifications for conductors and span lengths see drawing T-2954.

**TRANSMISSION TOWERS**  
 DETROIT EDISON CO.

**STRAIN TOWER EA**

**AMERICAN BRIDGE CO.**  
 PITTSBURGH, PA.

INQUIRY No. P1645  
 ORDER No. DRAWING T-2955  
 DATE 12-1-1921

RECORDED RIGHT OF WAY NO.

34636  
P89

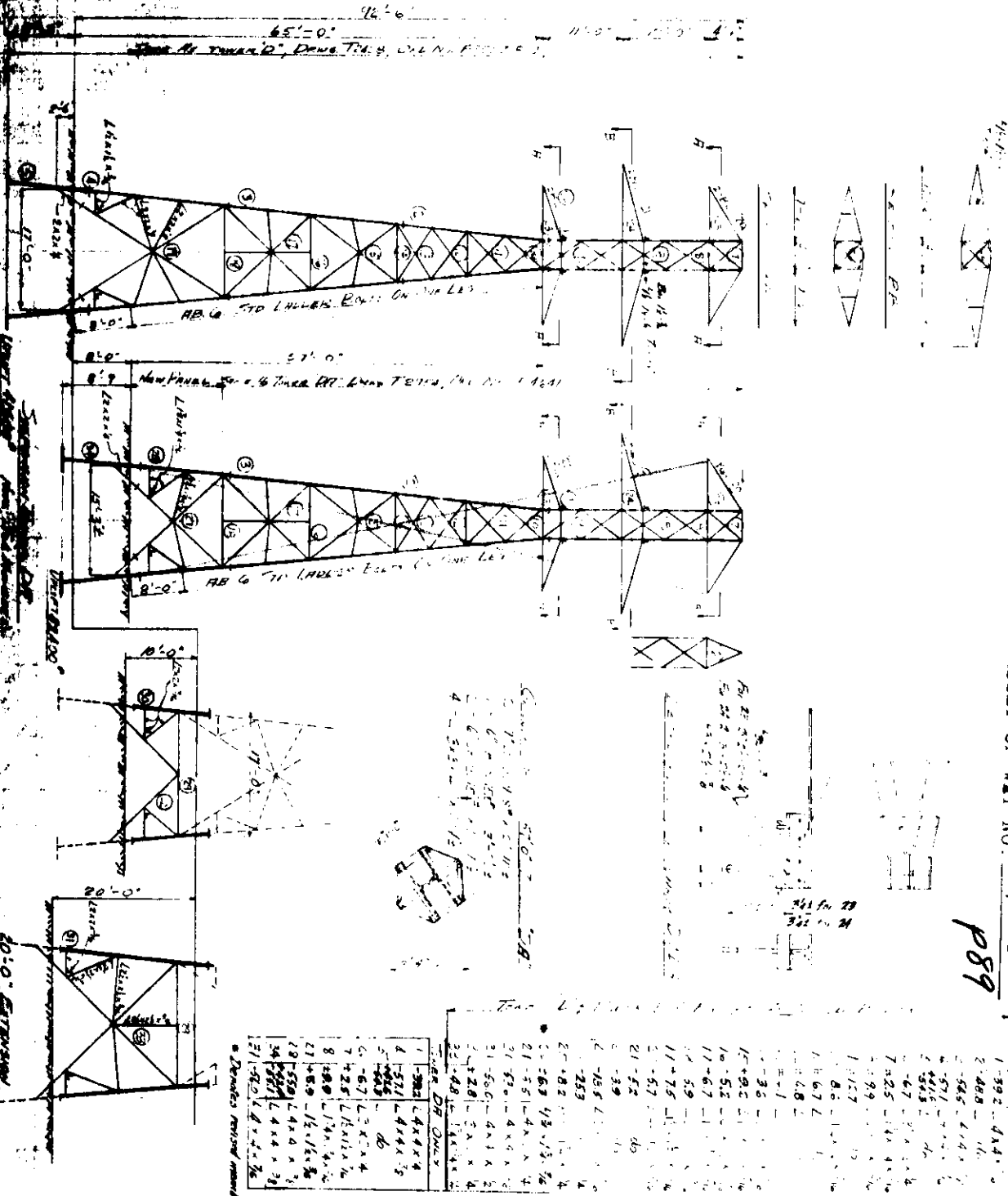

65'-0" SUSPENSION TOWER D' & DA  
57'-0" SUSPENSION TOWER D'A

THE DETROIT EDISON CO.  
DETROIT MICH.

AMERICAN BRIDGE COMPANY  
DETROIT MICH.

1-2-24

1-3-24

1-4-24

1-5-24

1-6-24

1-7-24

1-8-24

1-9-24

1-10-24

1-11-24

1-12-24

1-13-24

1-14-24

1-15-24

1-16-24

1-17-24

1-18-24

1-19-24

1-20-24

1-21-24

1-22-24

1-23-24

1-24-24

1-25-24

1-26-24

1-27-24

1-28-24

1-29-24

1-30-24

1-31-24

1-32-24

1-33-24

1-34-24

1-35-24

1-36-24

1-37-24

1-38-24

1-39-24

1-40-24

1-41-24

1-42-24

1-43-24

1-44-24

1-45-24

1-46-24

1-47-24

1-48-24

1-49-24

1-50-24

1-51-24

1-52-24

1-53-24

1-54-24

1-55-24

1-56-24

1-57-24

1-58-24

1-59-24

1-60-24

1-61-24

1-62-24

1-63-24

1-64-24

1-65-24

1-66-24

1-67-24

1-68-24

1-69-24

1-70-24

1-71-24

1-72-24

1-73-24

1-74-24

1-75-24

1-76-24

1-77-24

1-78-24

1-79-24

1-80-24

1-81-24

1-82-24

1-83-24

1-84-24

1-85-24

1-86-24

1-87-24

1-88-24

1-89-24

1-90-24

1-91-24

1-92-24

1-93-24

1-94-24

1-95-24

1-96-24

1-97-24

1-98-24

1-99-24

1-100-24

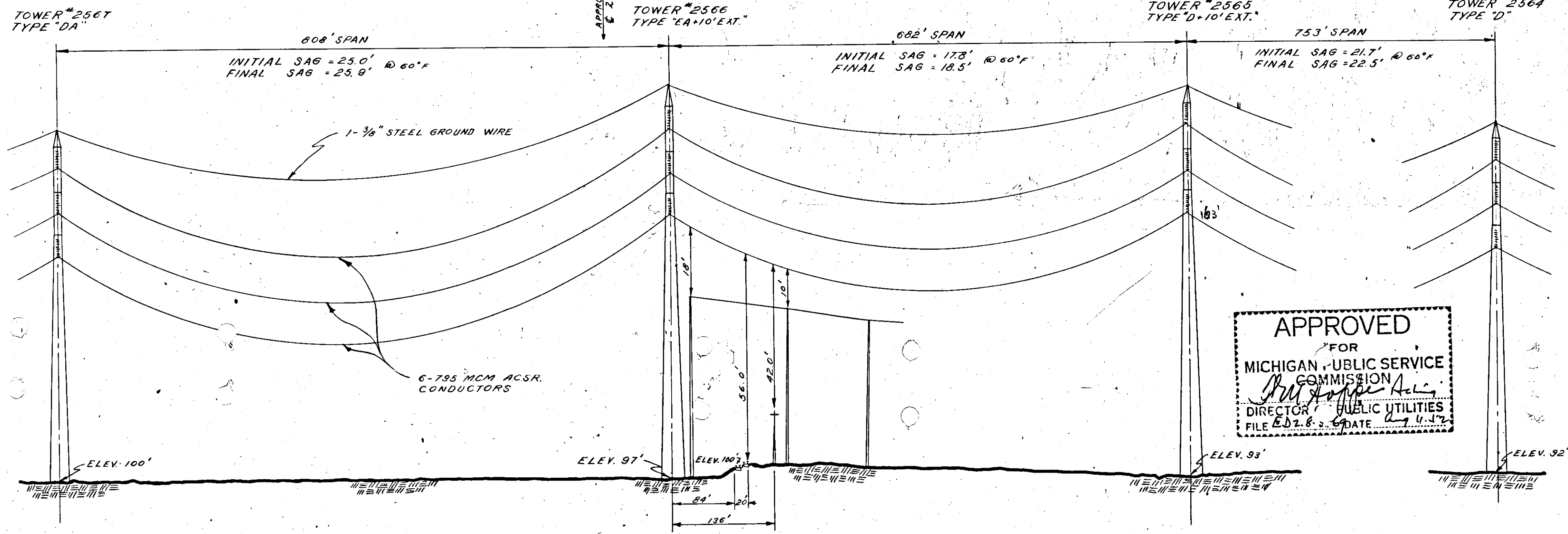
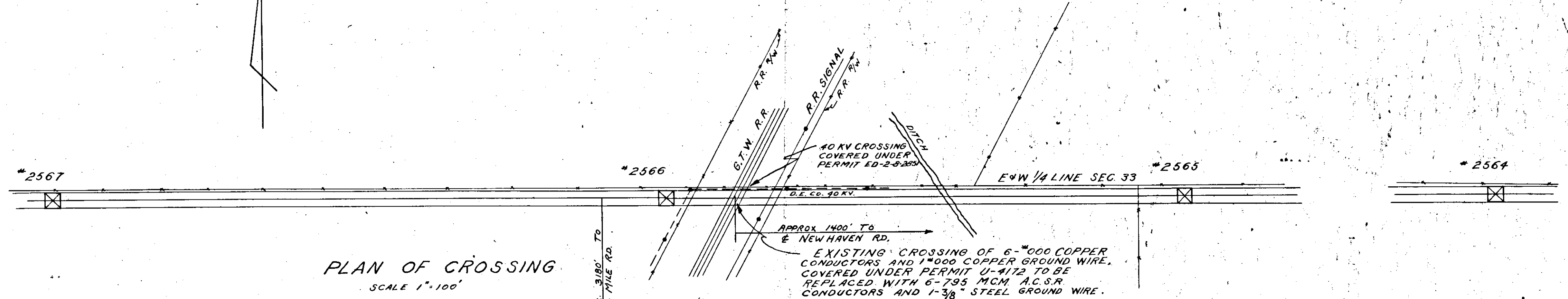

**APPROVED**  
FOR  
MICHIGAN PUBLIC SERVICE  
COMMISSION  
*Paul Apperley*  
DIRECTOR PUBLIC UTILITIES  
FILE ED 2836 DATE Aug 11, 52

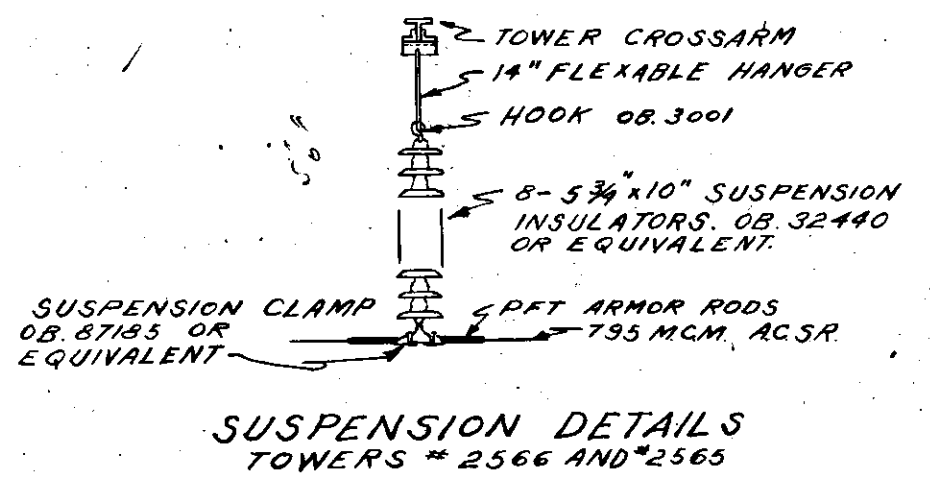

**ST. CLAIR - NORTHEAST 3-4**  
120 KV STEEL TOWER LINE

CITY SOUTH LIMITS OF NEW HAVEN  
COUNTY MACOMB  
TOWNSHIP LENOX  
SURVEY No. TAN  
RANGE No. R14E  
SECTION No. 33 S.W. 1/4

THE DETROIT EDISON COMPANY  
PLAN SUBMITTED TO MICHIGAN  
PUBLIC UTILITIES COMMISSION  
FOR 120,000 VOLT CROSSING  
OVER GRAND TRUNK WESTERN R.R.  
DRAWN BY J.S.W. DATE 7/11/52  
CHECKED BY J.L.M. DATE 7/11/52  
REVISED  
PERMIT No. RX-674A

RECORDED RIGHT OF WAY NO. 34636  
P89

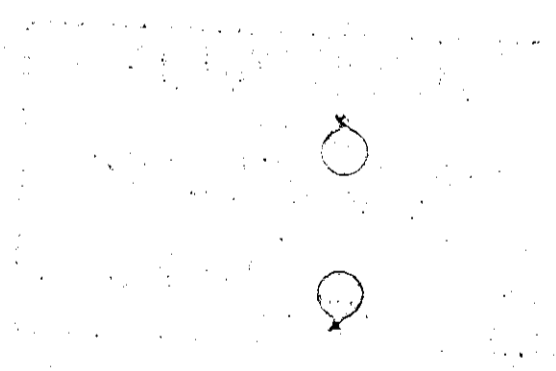

*Green*  
2-1-28