

STATE OF MICHIGAN

Office of the Michigan Public Utilities Commission, } ss.

I, Peter Fagan, Secretary of the Michigan Public Utilities Commission,

Do Hereby Certify, That I have compared the annexed copy of Permit No. U-1558

with the original copy

recorded in

and that it is a true and correct transcript therefrom, and of the whole of such original.

In Testimony Whereof, I have hereunto set my hand and affixed the seal of the Commission, at Lansing, this twenty-ninth day of December in the year of our Lord one thousand nine hundred twenty-three

Peter Fagan Secretary, Michigan Public Utilities Commission

RECORDED RIGHT OF WAY NO.

34636

19264

file # 1588

file # 1588

STATE OF MICHIGAN

BEFORE MICHIGAN PUBLIC UTILITIES COMMISSION

Wire Crossing Permit No. U-1558

In Re Application of Detroit Edison Company (Detroit)

Pursuant to Act No. 171 of the Session Laws of 1893, as amended, application having been made to Michigan Public Utilities Commission by said

Detroit Edison Company

for permission to string wires over the tracks of the

Grand Trunk Railway Co.

and said rail way company having waived the right of notice and hearing provided for in said act (Michigan Air Line) THEREFORE, It is ordered that said

Detroit Edison Company

be permitted to string the following described wires over and across the tracks of said railroad at the following described place:

West Bloomfield Twp., Oakland County, Mich.: - Crossing in Section 15 T 2 N, R 9 E, with 6 - #3/0 copper wires carrying 120,000 volts.

At the point of crossing said wires shall be constructed in accordance with this Commission's rules and regulations, which are hereby made a part of this order.

Given under our hands and the Official Seal of this Commission at the City of Lansing, State of Michigan, this 29th day of December A. D. 19 23.

MICHIGAN PUBLIC UTILITIES COMMISSION By

- WILLIAM W. POTTER Chairman. SHERMAN T. HANDY Commissioner. SAMUEL ODELL Commissioner. SAMUEL D. PEPPER Commissioner. ROLPH DUFF Commissioner.

RECORDED RIGHT OF WAY NO. 34636 70264

FILE No. 1588

.....ON TAN TO THOSE MEMBERS

GRAND TRUNK RAILWAY SYSTEM

WESTERN LINES

OFFICE OF SUPERINTENDENT

T. KING
SUPERINTENDENT

DURAND, MICH., Dec., 26th, 1923

FILE 312.22-101

Rx 325-188

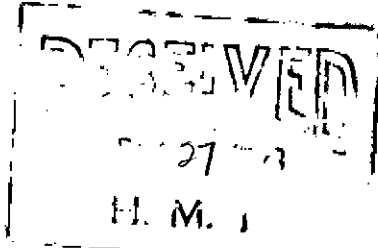

Mr. T. L. Hinks,
Asst. Right of Way Agent,
Detroit Edison Company,
Detroit, Michigan.

Dear Sir:

Referring to your favor of the 15th ulto., requesting permission to cross the tracks and right of way of the Michigan Air Line Railway Company in Section 15, West Bloomfield Township, Oakland County, Michigan with a steel tower transmission line consisting of six No. 3/0 bare copper wires carrying 120,000 volts.

We have no objections to the construction of this new crossing providing all work is done in accordance with rules and regulations of the Michigan Public Utilities Commission and with this understanding you may accept this letter as our waiver of formal hearing before the Commission. I am

Yours truly,

[Signature]
Superintendent

U-158

WH'mh

P.S.

Our Management have approved your application with the understanding that our standard license will be signed on presentation. Please advise by letter if this is satisfactory.

I note on blue print plan R-325-188 enclosed with your letter above date is shown Section 27. Should this read Section 22 instead?

RECORDED RIGHT OF WAY NO.

34636

2367

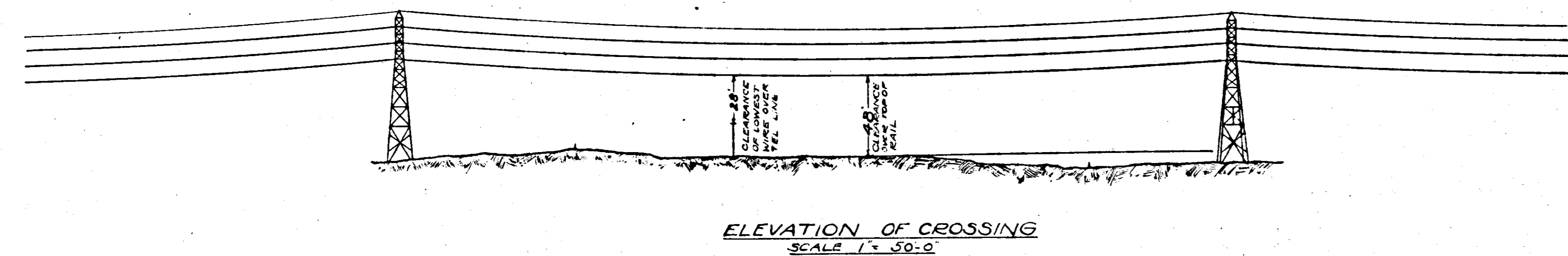
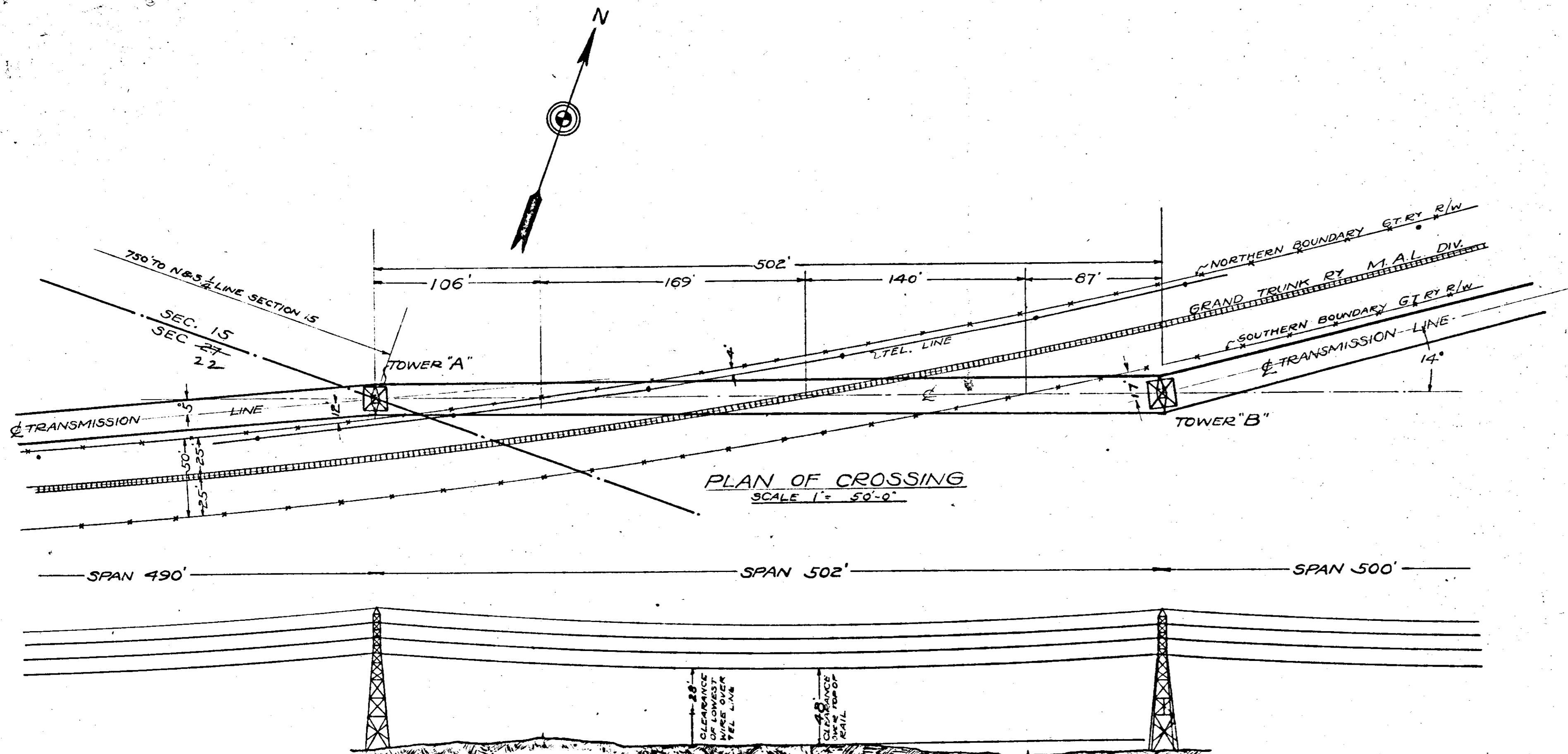

TOWER LOADS

- TOWER "A"**
- ① VERTICAL LOAD AT EACH CABLE SUPPORT OF 1300' TOTAL 9100*
 - ② HORIZONTAL LOAD TRANSVERSE TO LINE OF 1000' AT EACH CABLE SUPPORT TOTAL 7000*
 - ③ HORIZONTAL LOAD IN DIRECTION OF LINE OF 3500' AT ANY ONE CONDUCTOR SUPPORT
 - ④ WIND ON TOWER OF 30' PER LIN. FT. OF TOWER HEIGHT DEAD LOAD OF TOWER
- TOWER "B"**
- ① VERTICAL LOAD AT EACH CABLE SUPPORT OF 1300' TOTAL 9100*
 - ② HORIZONTAL LOAD NORMAL TO LINE AT EACH CABLE SUPPORT OF 600' TOTAL 4200*
 - ③ HORIZONTAL LOAD IN THE DIRECTION OF LINE OF 3500' AT EACH CABLE SUPPORT TOTAL 24500* OR 4700' AT ANY ONE CONDUCTOR SUPPORT
 - ④ WIND ON TOWER OF 30' PER LIN. FT. OF TOWER HEIGHT.
 - ⑤ DEAD LOAD OF TOWER.

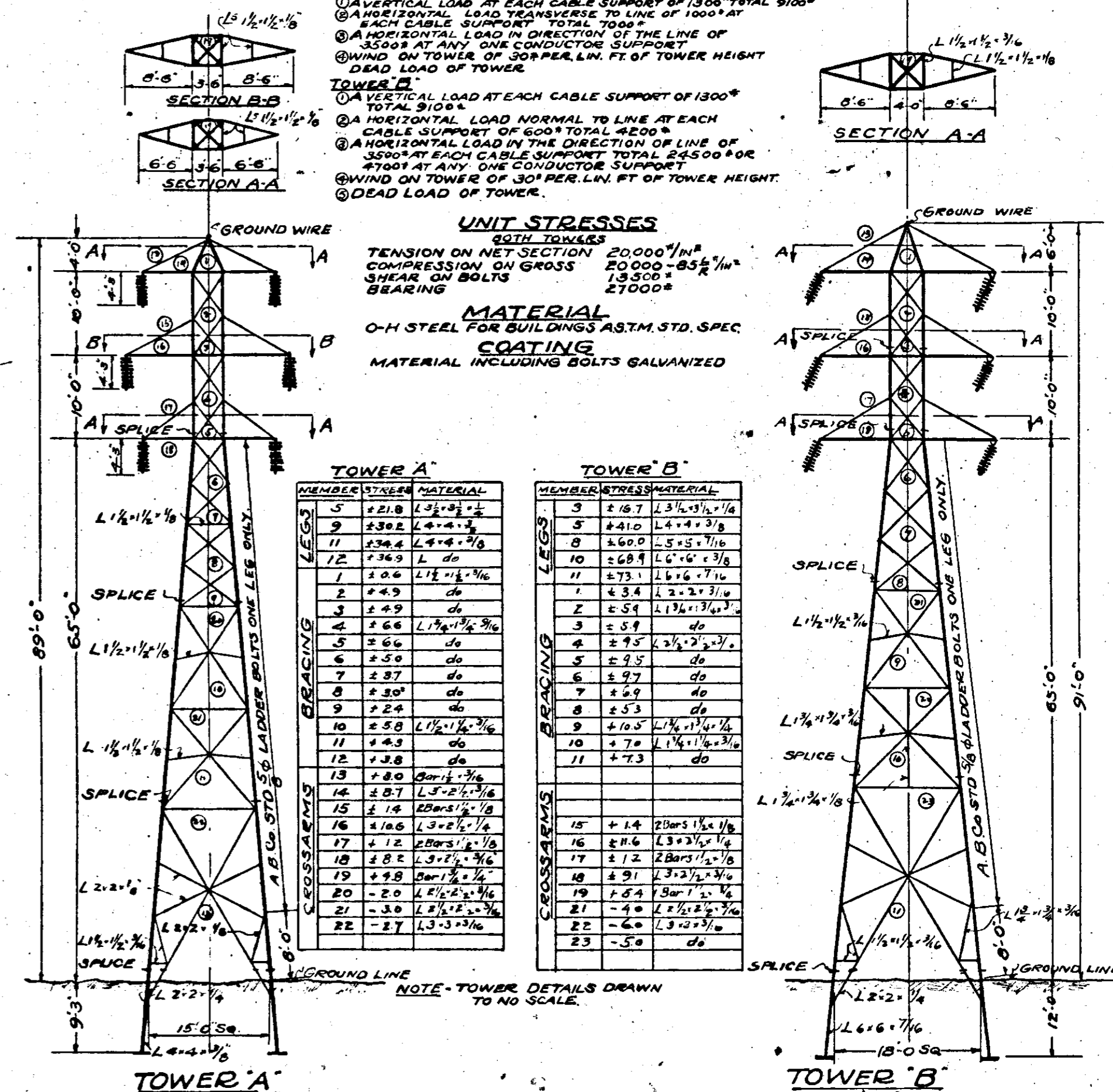

RECORDED R/W FILE NO. 34636 P 264

TRANSMISSION LINE DATA

PURPOSE OF LINE - TRANSMISSION OF POWER	HARD OR SOFT DRAWN	HARD DRAWN
DURATION OF SERVICE - CONTINUOUS	MAX. STRESS ON WIRES	3950*
MAX. VOLTAGE BETWEEN WIRES 120000 VOLTS	TYPE OF INSULATORS	OHIO BRASS CO SUSPENSION
MAX. CURRENT TRANSMITTED 600 AMPS.	FLASH OVER TEST (DEVT) FOR 3 INS.	± 50000 VOLTS
FREQUENCY 60 CYCLES	FLASH OVER TEST (WLT) FOR 3 INS.	± 35000 VOLTS
NO. AND GAUGE OF WIRE 3/0 7 WIRE STRAND	CATALOGUE NO. OF INSULATORS	O.B. Co. 25620
MATERIAL OF WIRE - COPPER	NO. AND SIZE OF CROSS ARMS	SEE SKETCH
INSULATION BARE	TYPE OF CONDUCTOR ATTACHMENT	SEE SKETCH
	NO. OF WIRES TO BE ERECTED	6
	MAX. NO. OF WIRES	6

CLEARANCE OF LOWEST WIRE AT MAX. SAG OVER TRACK 48'

CLEARANCE OF LOWEST WIRE AT MAX. SAG OVER EXISTING WIRES 28'

NO. OF INSULATORS SUPPORTING CONDUCTORS OVER CROSSING 2

AMERICAN BRIDGE CO. STD. EARTH ANCHOR PATENTED - UPLIFT 22000*

MATERIAL FOR GRILLAGE
2 CHANNELS 8" 13.75" x 2.6" LONG
3 TIES 1 3/2" 30" x 6.0" LONG
3 LS 1 1/2" x 1/2" x 3/16" x 2.6" LONG

A.B. Co. STD. EARTH ANCHOR (PATENTED) UPLIFT 65000*

MATERIAL FOR GRILLAGE
2 CHANNELS 8" 13.75" x 2.6" LONG
3 TIES 1 3/2" 30" x 6.0" LONG
3 LS 1 1/2" x 1/2" x 3/16" x 2.6" LONG

THE DETROIT EDISON CO.
FROM THE OFFICE OF THE
DISTRIBUTION ENGINEER
DETROIT MICHIGAN

BLOOMFIELD-SUPERIOR TRANSMISSION LINE
CROSSING OF THE GRAND TRUNK RAILWAY IN SEC 15 W. BLOOMFIELD TWP OAKLAND CO MICHIGAN.

RAILROAD PERMIT NO. DRG. NO. R. 325-188

RECORDED RIGHT OF WAY NO. 34636
p264