

STATE OF MICHIGAN

Office of the Michigan Public Utilities Commission, } ss.

I, J. Carl Sheil, Secretary of the Michigan Public Utilities Commission,

Do Hereby Certify, That I have compared the annexed copy of Permit No. U-4834

with the original permit

recorded in file No. U-4834

and that it is a true and correct transcript therefrom, and of the whole of such original.

In Testimony Whereof, I have hereunto set my hand and affixed

the seal of the Commission, at Lansing, this 27th

day of August in the year of our Lord

one thousand nine hundred twenty-eight

J. Carl Sheil
Secretary, Michigan Public Utilities Commission.

RECORDED RIGHT OF WAY NO. 34636 8/28

Vertical text or markings, possibly bleed-through from the reverse side of the page.



STATE OF MICHIGAN  
BEFORE MICHIGAN PUBLIC UTILITIES COMMISSION

Standard Railroad Wire-Crossing Permit No. U-4834

In Re Application of **Detroit Edison Company (Detroit)**

Pursuant to Act No. 171 of the Session Laws of 1893, as amended, application having been made to Michigan Public Utilities Commission by said **Detroit Edison Company**

for permission to string wires across the tracks of the **Grand Trunk Railway System**

and said **Detroit Edison Company**

having conformed to the Commission's rules governing the filing of notices and issuing of permits for the construction of electrical lines and said rail **way** company having waived the right of notice and hearing provided for in said act

THEREFORE, It is ordered that said **Detroit Edison Company**

be permitted to string the following described wires across the tracks of said railroad at the following described place:

City of Port Huron, St. Clair County, Michigan:-	) ) )	On private property of Port Huron Sulphite & Paper Company, 450 ft. South of Washington Street and 800 ft. West of Twelfth Street, with:
--	-------------	--

**4 - 5/16" galvanized steel guy wires.**

as indicated on the attached plans, when, as and if approved.

At the point of crossing said wires shall be constructed in accordance with this Commission's rules and regulations.

Given under our hands and the Official Seal of this Commission at the City of Lansing, State of Michigan, this **27th** day of **August** A. D. **1928**.

MICHIGAN PUBLIC UTILITIES COMMISSION  
By

.....**SIDNEY B. DOYLE**.....  
Chairman,

.....**JAMES BICE**.....  
Commissioner,

.....**BYRON P. HICKS**.....  
Commissioner,

Countersigned

.....**J. Carl Sheil**.....  
Secretary

.....**ROBERT H. DUNN**.....  
Commissioner,

.....**SAMUEL ODELL**.....  
Commissioner.

2678  
34636  
9/168

DATA SHEET TO ACCOMPANY  
DRAWING #RX-823

Name of Company

The Detroit Edison Company.

Name and Location of Crossing

Over the Grand Trunk R.R. Siding on private property of Port Huron Sulphite and Paper Company, of Washington Street, and 800' west of 12th St., City of Port Huron in the S.W.  $\frac{1}{4}$  of Section 13, Town 6 North, Range 17 East, Port Huron Twp., St. Clair County, Michigan.

Circuits

Proposed four galvanized steel guy wires.

Poles

Poles (B) & (D) 50' Idaho Cedar, 28" top circumference, 44" butt circumference at ground line set 7' in clay soil.  
Pole (C) 50' Idaho Cedar, 28" top circumference, 50" butt circumference at ground line set 7' in clay soil.  
Poles (A) & (E) 35' Michigan Cedar, 28" top circumference, 38" butt circumference at ground line set 6' in clay soil.

Guys and Guy Attachments

One 5/16" Arm Guy from pole (B) 41' above ground to stub (A) 28' above ground.  
One 5/16" Head Guy from pole (B) 40' above ground to stub (A) 28' above ground.  
One 3/8" Guy from stub (A) 28' above ground to anchor (F) 15' from butt of stub (A).  
One 5/16" Guy from pole (D) 41' above ground to wall strap.  
One 5/16" Arm Guy from pole (B) 41' above ground to stub (E), 28' above ground.  
One 5/16" Guy from pole (B) 40' above ground to stub (E) 28' above ground.  
All guy wire double galvanized stranded steel with a minimum ultimate strength of 55,000 pounds per square inch.

Cross Arms

Existing two 3 $\frac{1}{4}$ " x 4 $\frac{1}{4}$ " x 96" Douglas fir double side arms on pole (B).

Conductors

None.

DATA SHEET TO ACCOMPANY  
RAILROAD CROSSING DRAWINGS

Guy Clamps

One 1 5/8" x 6" three bolts galvanized steel clamp at each end, for 3/8" and 5/16" guys.  
Two 1/2" Crosby guy clamps at each end, for 1/2" guys.

Guy Insulators

Two O.B. #26500 - 3 1/2" porcelain interlocking strain type insulators on 3/8" and 5/16" guys for 24,000 volt circuits and one per guy for lower voltages.  
Two O.B. #25009 - 4" porcelain interlocking strain type insulators on 1/2" guys for 24,000 volt circuits and one per guy for lower voltages.

Guy Anchors

Four Blade "Everstick" on 1/2" Guys buried 7' deep.  
8" Cone ON 3/8" and 5/16" guys buried 6' deep.

Anchor Rods

3/4" x 8' round galvanized steel rods on "Everstick" anchors.  
5/8" x 6' round galvanized steel rods on 8" Cone anchors.

Cross Arms Attachments

5/8" Galvanized steel center bolts.  
5/8" Galvanized steel spacer bolts.  
4" x 4" treated pine space blocks.  
1/4" x 1 1/2" x 28" flat galvanized steel braces.  
3/8" galvanized steel bolts at arm end of braces.  
1/2" x 5" galvanized steel lag screws at pole end of braces.

Pins

1 1/2" x 14" x 1 3/8" locust pins for 24,000 volt circuits.  
1 1/2" x 10-1/8" x 1" locust pins for all other circuits.

Insulators

One O.B. #11623 pin type and four Locke #8049 disc type insulators per wire, per crossing pole on 24,000 volt circuits.  
(One O.B. #11623 and two Locke #8049 for dead ends).  
Two O.B. #12847 porcelain pin type insulators per wire, per crossing pole for 4800 volt, 2400 volt, series, lighting, and private telephone circuits.  
Two #20 Hemingray glass insulators per wire, per crossing pole for 120/240 volt secondary circuits.  
One O.B. #12847 pin type and two Colonial #11940 disc type insulators per wire for #0000 primary circuits and one #20 Hemingray glass pin type and two #25009 strain type insulators per wire for #0000 secondary circuits per crossing pole.

Ties

Standard top groove tie on 24,000 volt, 4,800 volt, 2,400 volt, series lighting and private telephone circuits.  
Standard side groove tie on 120/240 volt secondary circuits.  
#8 soft, solid, bare copper tie wire for 24,000 volt circuits.  
#6 soft, solid, weatherproof copper tie wires on all other circuits.

Checked by... *D. Burns* .....

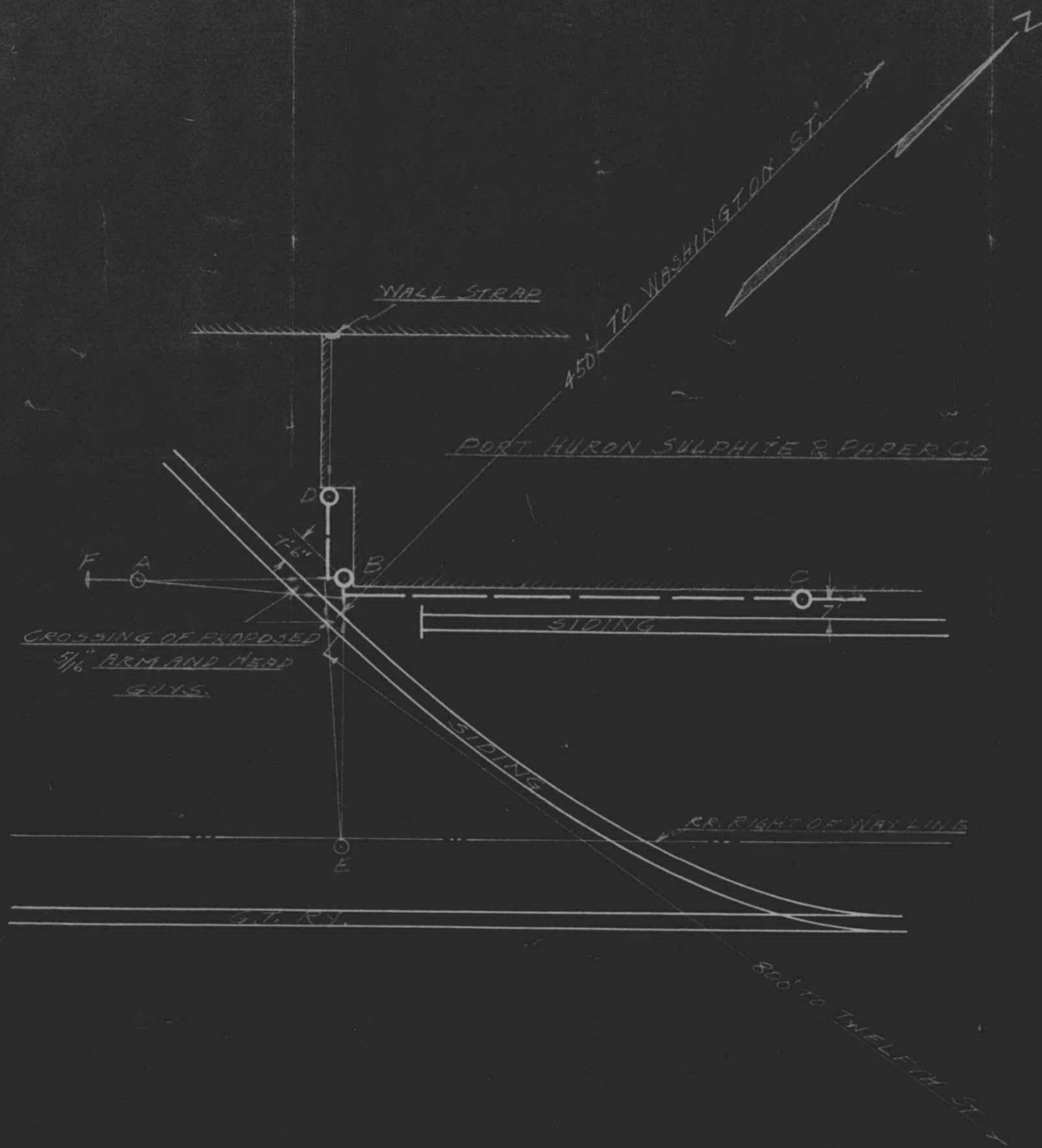

PLAN OF CROSSING



ELEVATION LOOKING SOUTH WEST

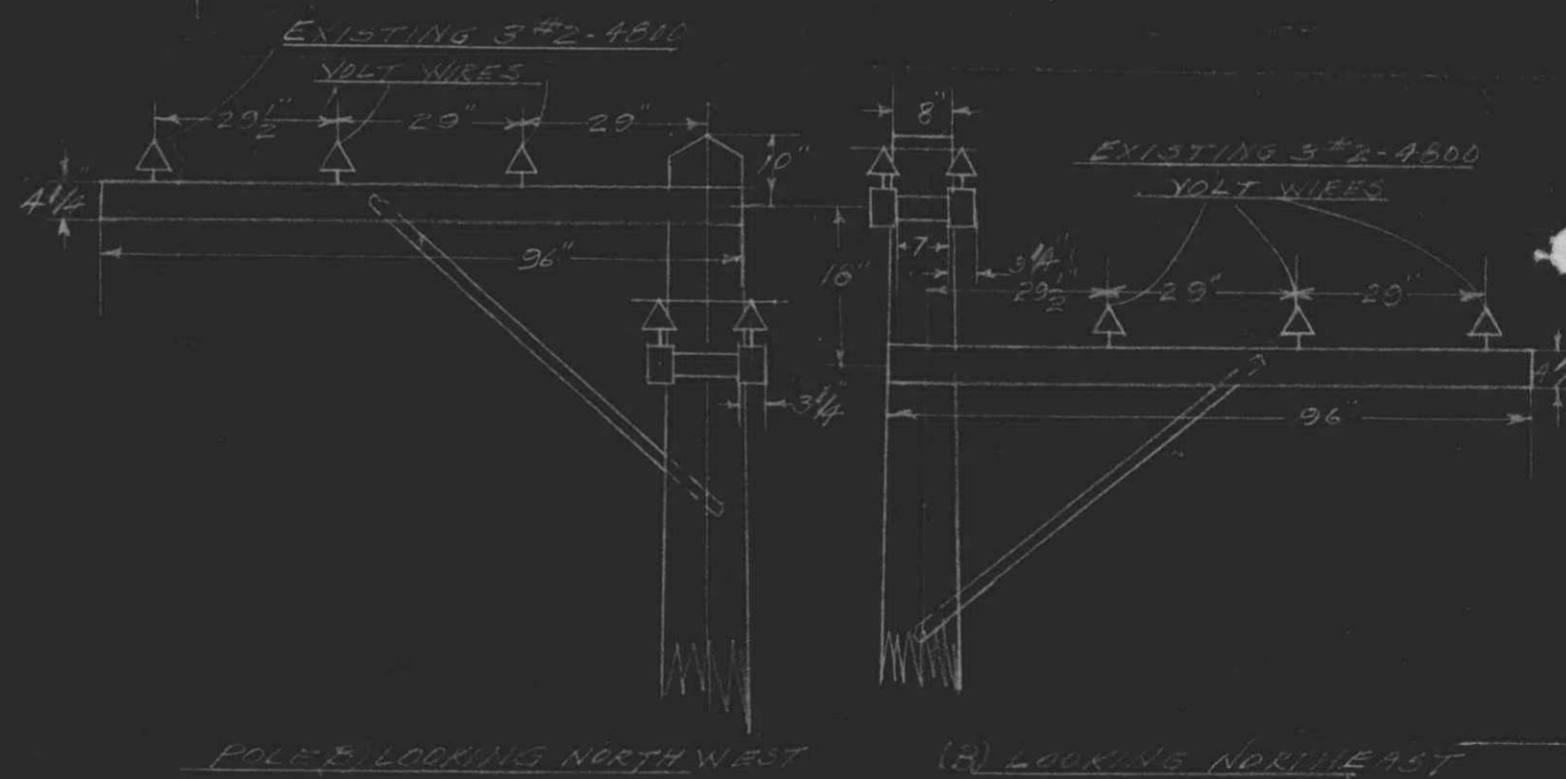

(A) LOOKING NORTH WEST

(B) LOOKING NORTHEAST

PURPOSE OF LINE  
GUY WIRES TO SUPPORT CHIMNEY POLE

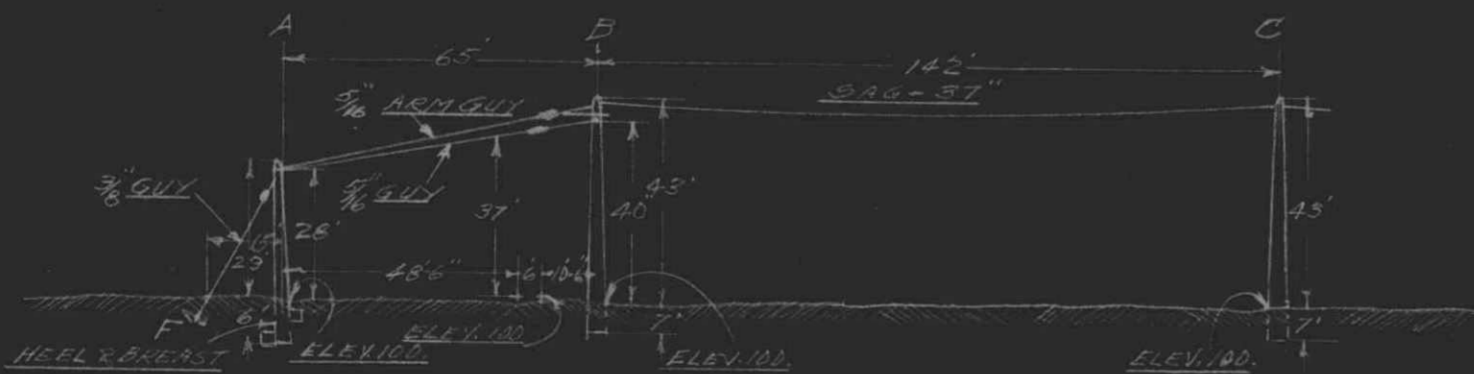

ELEVATION OF CROSSING LOOKING NORTH WEST

APPROVED  
FOR  
MICHIGAN PUBLIC UTILITIES  
COMMISSION  
*J. J. [Signature]*  
CHIEF ENGINEER  
FILE 4834 DATE AUG 10 1928

CITY PORT HURON  
COUNTY ST. CLAIR  
TOWNSHIP PORT HURON  
SURVEY NO. OF TWP. 241274  
RANGE NO. 17 EAST  
SECTION NO. SW 1/4

THE DETROIT EDISON CO.  
PLAN SUBMITTED TO MICH.  
PUBLIC UTILITIES COMMISSION  
FOR 3/16 PORT HURON GUY CROSSING  
OVER ST. RAILROAD  
DRAWN BY A.P. DATE 5-3-28  
CHECKED BY A.P. DATE 5-3-28

RECORDED RIGHT OF WAY NO. 34636  
p/68

ANS'D  
AUG 10 1968  
RECEIVED  
MISSISSIPPI PUBLIC UTILITIES  
COMMISION

484