

CORPORATE REAL ESTATE SERVICES

Project No.: BWS9900194
Job No.:
RFW No.: 204932
R/W No.: RX183A

Date: March 12, 1999
To: Brenda Golson
Records Center
From: Tom Wilson, SR/WA *TW*
Subject: Wire Crossing of Railroad Tracks

Attached are papers related to the notification, dated March 5, 1999, to CSX Transportation, Inc., to revise the above mentioned crossing in the SE ¼ of Section 11, Village of Salem, Salem Township, Washtenaw County, Michigan.

The Service Center is notified to revise the crossing as requested. **Note: All construction work associated with aerial crossings of railroad tracks requires that you notify the operating railroad as to the actual date of construction, in advance of any work.**

Please incorporate these papers into railroad recorded Record Center ROW File No. R33222P69.

Attachments

cc: EJ Beckman (Ann Arbor SC)

RECORDED R/W FILE NO. 33222-P69



2000 Second Avenue
Detroit, Michigan 48226
(313) 237-8000

CORPORATE REAL ESTATE SERVICES

March 5, 1999

Mr. T. F. Tippy
Senior Project Engineer
CSX Transportation
12780 Levan Road
Livonia, Michigan 48150

Re: Wire Crossing Reconstruction Notification

Dear Mr. Tippy:

This letter is your notice of the planned reconstruction of an overhead wire crossing over your railroad tracks, within the Main Street Road Right-of-Way, by the Detroit Edison Company, in the SE¼ of Section 11, Village of Salem, Salem Township, Washtenaw County, Michigan, as described on the enclosed drawings and information forms.

1. Location: The north side of Main Street (Six Mile), just south of MP 31, east of Dickerson.
2. Detroit Edison Project and Crossing Nos.: BWS9900194, RX183A
3. This is a reconstruction of an existing crossing (Previous MPSC Permit No. U2174 /Date: ?. Information on this crossing is retained in Edison ROW File No. R33222P69.
4. Please indicate your:
 - R.R. Valuation Station No. 1399+20
 - R.R. Mile Post No. 30.88
 - Will a Flagman or Inspection be required? A FLAGMAN WILL BE REQUIRED IF AT ANY TIME DURING THE

INSTALLATION, THE WIRES WILL BE AT LESS THAN STANDARD OVERHEAD CLEARANCE.
All construction will be done in accordance with specification of the Michigan Public Service Commission and all applicable codes and laws.

Michigan law requires you to respond within 30 calendar days of the receipt of this notification. In the event you do not respond within 45 days of the receipt of this letter, our crews will be instructed to begin work.

Please contact me on (313) 235-8314 if you have any questions.

Sincerely,

Thomas Wilson, SR/WA
Real Estate Associate II
Room 2310 WCB

cc: E.J. Beckman (Ann Arbor SC)
Attachments

RECORDED R/W FILE NO.

33222 P 69

Tom Tippi
3/10/99

Railroad Name C. & O. R.R.			Department Order RFW # 204932-55		
Row No. (Information on existing rights of way available from Record Center) 24239		New or existing RX No. RX-183A		Encroachment (Length in Feet) 320'	
Location City/Township(s) VILLAGE OF SALEM		Town(s) T-15	Range(s) R-7E	County(s) WASHTENAW	1/4 Section(s) SE 1/4
Section(s) 11					
Location Description of Encroachment REBUILD EXISTING R.R. CROSSING					
Check appropriate box <input checked="" type="checkbox"/> Crosses tracks within the public road right-of-way <input type="checkbox"/> Crosses railroad land <input type="checkbox"/> Is longitudinally on or over railroad land, <input type="checkbox"/> Provides service to the railroad					

Facility Data (also detailed on attached drawing)

Nature of required tree rights

Existing State Permit No.	Date	Railroad Mile Post (Number) D-31 GR 121	Distance to Crossing from Mile Post (in feet) 22' Ft.
---------------------------	------	---	---

Existing				Proposed			
Type of Structure <input checked="" type="checkbox"/> Wood <input type="checkbox"/> Steel				Type of Structure <input checked="" type="checkbox"/> Wood <input type="checkbox"/> Steel			

Existing Conductors				Existing Poles			Existing Cross-Arms	Proposed Conductors				Proposed Poles			Proposed Cross-Arms
Span.	No./Size	Kind	Voltage	Loc.	Height	Class	Size	Span.	No./Size	Kind	Voltage	Loc.	Height	Class	Size
B-C	3-4	BC	4.8	A	50	4	96"	B-C	1-3/6	ACSR	4.8	A	55	1	120"
				B	50	4	96"	B-C	3-336	ACSR	4.8	B	55	1	120"
				C	50	4	96"					C	55	1	120"
				D	50	4	96"					D	55	1	120"

Explanation of Line Changes (continue on separate sheet if necessary)
REBUILD EXISTING CROSSING TO SHIELD WIRE CONSTRUCTION

RECORDED R/W REF. NO. 33222 P67

Clearances		
Tolerance	Clearances	Height
Nearest 0.1 foot with lowest conductor or wire at 60° final sag. (If different indicate on drawing)	From Top of Rail to Final Sag	41' 9" Ft.
	From Detroit Edison wire to Railroad Communication or Signal Lines	Ft.

* Materials and clearances shall be as noted in the current revision of Detroit Edison's Overhead Lines Construction Standards Manual at Railroad Crossings. Due to field conditions actual dimension may vary from those indicated.

Designed By E. J. BECKMAN	Date 02-17-99	Checked By E. J. Beckman	Date 02-17-99
Company Location ANN ARBOR SERVICE CTR	Phone No. 734 332-3116	SERVICE PLANNER-ANN ARBOR DIV.	

STATE OF MICHIGAN
Office of the Michigan Public Utilities Commission, } ss.

I, Peter Fagan, Secretary of the Michigan Public Utilities Commission,

Do Hereby Certify, That I have compared the annexed copy of Permit No. U-2174

with the original permit

~~recorded in~~

and that it is a true and correct transcript therefrom, and of the whole of such original.

In Testimony Whereof, I have hereunto set my hand and affixed

the seal of the Commission, at Lansing, this twenty-seventh

day of March in the year of our Lord

one thousand nine hundred twenty-five

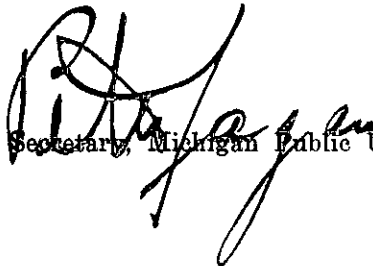

Secretary, Michigan Public Utilities Commission.

MEW

File # 1818

File # 1818

RECORDED RIGHT OF WAY NO.

33222

P69

DATA SHEET TO ACCOMPANY
DRAWING #RX-183

Name of Company

The Detroit Edison Company

Name and Location of Crossing

Over the Pere Marquette R.R. in Main Street, 25' Southeast of the Mile Post D31 - G.R.121, S.E. 1/4 of Section 11, Town 1, South, Range 7 East, Salem Township, Washtenaw County, Unincorporated Village of Salem.

Circuits

Existing one 4600 volt, 60 cycle, 3 wire, 3 phase, primary distribution circuit.

Proposed one 5,000 volt, 60 cycle, 2 wire, single phase, series street lighting circuit.

Proposed one 5,000 volt, 60 cycle, 2 wire, single phase, series street lighting circuit.

Poles

Pole (A) Idaho Cedar, 28" top circumference, 56" butt circumference, at ground line, set 6'-6" in clay soil.

Pole (B) 45' Idaho Cedar, 28" top circumference, 48" butt circumference at ground line, set 6'-6" in clay soil.

Pole (C) 45' Idaho Cedar, 28" top circumference 54" butt circumference at ground line, set 6'-6" in clay soil.

Pole (D) 40' Idaho Cedar, 28" top circumference, 41" butt circumference at ground line, set 6' in clay soil.

Pole (E) 35' Michigan Cedar, 22" top circumference, 42" butt circumference at ground, line, set 5'-6" in clay soil.

Guys and Guy Attachments

One 3/8" overhead guy from pole (B) 37' above ground to pole (A) 16' above ground.

One 3/8" overhead guy from pole (C) 37' above ground to pole (D) 20' above ground.

One 5/16" guy from pole (E) 28' above ground to anchor (F) 15' from butt of pole (E).

All guy wire double galvanized steel with a minimum ultimate strength of 50,000 pounds per square inch.

Guy Clamps

Two 5/8" x 6" three bolt galvanized steel clamps per guy.

Guy Insulators

One O.B. #26500 - 3 1/2" porcelain interlocking strain type insulator per guy.

Guy Anchors

"Bierce Cone" buried 6' deep.

RECORDED RIGHT OF WAY NO. 221

DATA SHEET TO ACCOMPANY
DRAWING #RX-183

Anchor Rods

5/8" x 6' round galvanized steel rods.

Cross Arms

Existing one 3 $\frac{3}{4}$ " x 4 $\frac{3}{4}$ " x 96" Douglas fir double cross arms for 5,000, and 4600 volt circuits.
No proposed cross arms.

Cross Arm Attachments

5/8" galvanized steel center bolts
5/8" galvanized steel spacer bolts
4" x 4" treated pine spacer blocks
5/16" x 1 $\frac{1}{2}$ " x 28" flat galvanized steel braces
3/8" galvanized steel bolts at arm end of braces
1/2" galvanized steel lag screws at pole end of braces

Pins

1 3/8" x 10 1/8" x 1" locust steel bolted (not galvanized) pins on 4600, and 5,000 volt circuits.

Insulators

Two O.B. #12847 porcelain pin type insulators per wire, per crossing pole for 4600 and 5,000 volt circuits.

Conductors

Existing 3 #4 medium hard drawn, stranded, triple braid, weatherproof, copper wires.
Proposed 2 #4 medium hard drawn, stranded, triple braid, weatherproof, copper wires.

Ties

Standard top groove tie on 4600 and 5,000 volt circuits.
#6 soft, solid, weatherproof, copper tie wire on 4600 and 5,000 volt circuits.

STATE OF MICHIGAN
BEFORE MICHIGAN PUBLIC UTILITIES COMMISSION

Standard Railroad Wire-Crossing Permit No.....J-2174

In Re Application of Detroit Edison Company (Detroit)

Pursuant to Act No. 171 of the Session Laws of 1898, as amended, application having been made to Michigan Public Utilities Commission by said Detroit Edison Company

for permission to string wires across the tracks of the Pere Marquette Railway Co.

and said Detroit Edison Company

having conformed to the Commission's rules governing the filing of notices and issuing of permits for the construction of electrical lines and said rail way company having waived the right of notice and hearing provided for in said act

THEREFORE, It is ordered that said Detroit Edison Company

be permitted to string the following described wires across the tracks of said railroad at the following described place:

In Village of Salem,) In Main street, 25 ft. S.E. of mile
Washtenaw County,) post D-31-GR-121, S.E. 1/4 of Sec.11,
Michigan:-) T I S, R 7 E, with:

Two No. 4 copper wires for 5000 volts series Street Lighting.

as indicated on the attached plans, when, as and if approved.

At the point of crossing said wires shall be constructed in accordance with this Commission's rules and regulations.

Given under our hands and the Official Seal of this Commission at the City of Lansing, State of Michigan, this 27th day of March A. D. 19 25.

MICHIGAN PUBLIC UTILITIES COMMISSION
By

.....SHERMAN T. HENDY.....
Chairman,

.....SAMUEL ODWELL.....
Commissioner,

.....SAMUEL D. PAPPAR.....
Commissioner,

.....ROLPH DUFF.....
Commissioner,

.....WILLIAM W. POTTER.....
Commissioner.

RECORDED RIGHT OF WAY NO. 33222
p64

CONTRACT NO.

DATE

BY

MICHIGAN PUBLIC UTILITIES COMMISSION

IN RE: APPLICATION OF THE CITY OF ...

Whereas the ... and the ... in ...

That the ... of the ...

That the ... of the ...

That the ... of the ...

That the ... of the ...

That the ... of the ...

That the ... of the ...

That the ... of the ...

BEFORE MICHIGAN PUBLIC UTILITIES COMMISSION STATE OF MICHIGAN

DETROIT EDISON O.H. RAILROAD CROSSING PERMIT DE 963-3866 6-85 X (SE 32)

DD 204932-55 RX 183-A
 STATE PERMIT NUMBER P.M.RR. U-2174
 JPL _____
 R/W 24239
 PROPOSED LINE CROSSING OVER C. & O. RR. & MAIN ST. (6 MILE)
 IN VILLIAGE OF SALEM, SALEM TWP CITY OF _____
 SECTION 11 QUARTER SE TOWNSHIP SALEM T. 1S R. 7E COUNTY WASHTENAW

REFER TO SECTION 12 OF OVERHEAD LINES CONSTRUCTION STANDARDS FOR MINIMUM CLEARANCE CHART. THE RAILROAD PERMIT APPLICATION (DE 963-6064) SHALL BE SUBMITTED ALONG WITH THIS VELIUM.

SPAN	SPAN LENGTH	LOWEST CONDUCTOR OVER R.R. TRACKS	STRINGING SAG AT 60° F	SAG TABLE	RULE SPAN	FINAL SAG RATION
A-B	120'		8"	SAG TAB I	150'	1.50
B-C	90'6"	336.4 ACSR	5"	SAG TAB I	150'	1.63
C-D	118'		8"	SAG TAB I	150'	1.50

DESIGNED BY E. J. BECKMAN DIVISION ANN ARBOR
 CHECKED BY E. J. BECKMAN DATE 02-17-1999

ALL CONSTRUCTION WORK ASSOCIATED WITH AERIAL CROSSINGS OF RAILROAD TRACKS REQUIRES THAT YOU NOTIFY THE OPERATING RAILROAD OF THE ACTUAL DATE OF CONSTRUCTION, IN ADVANCE OF ANY WORK.

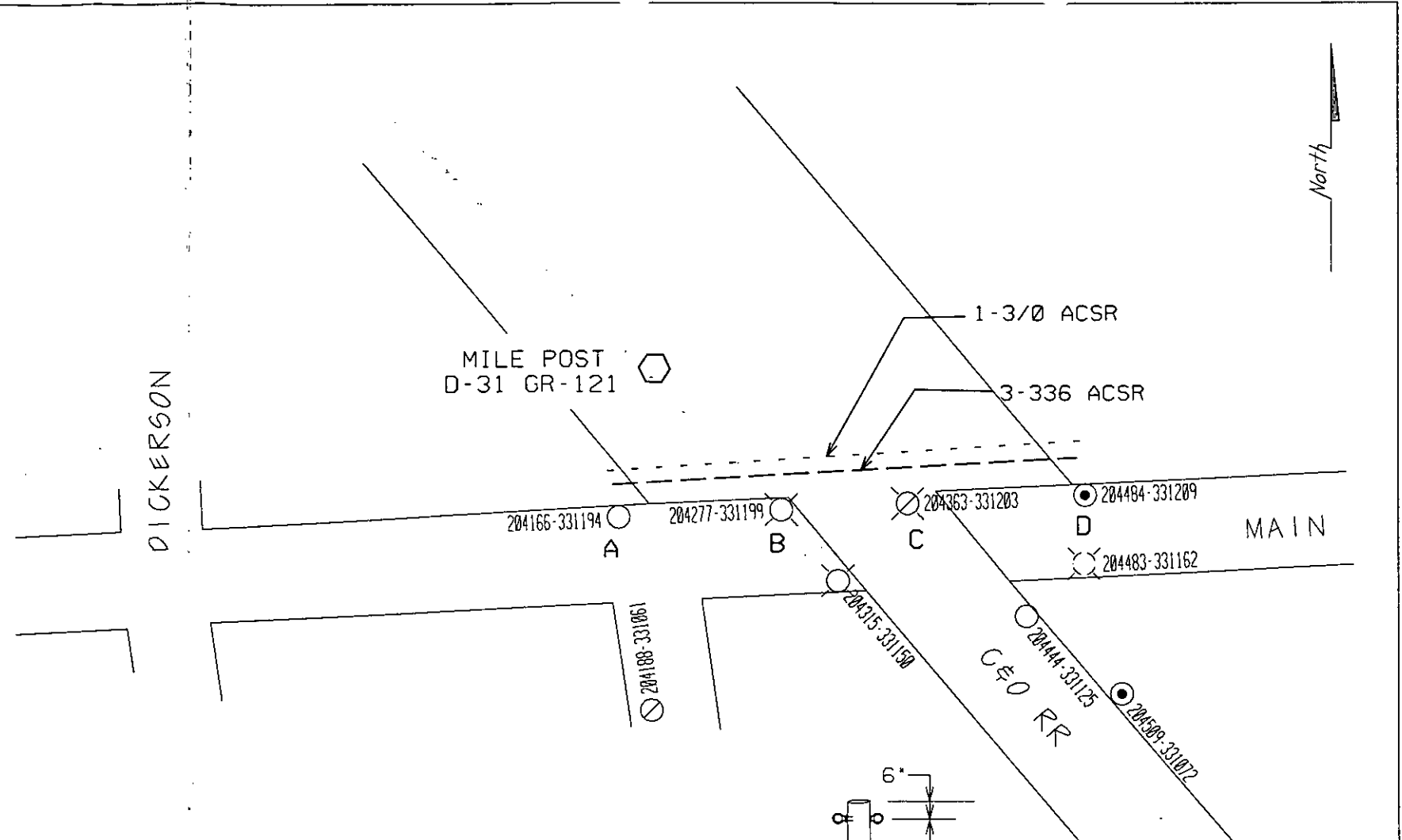

ELEVATIONS LOOKING NORTH

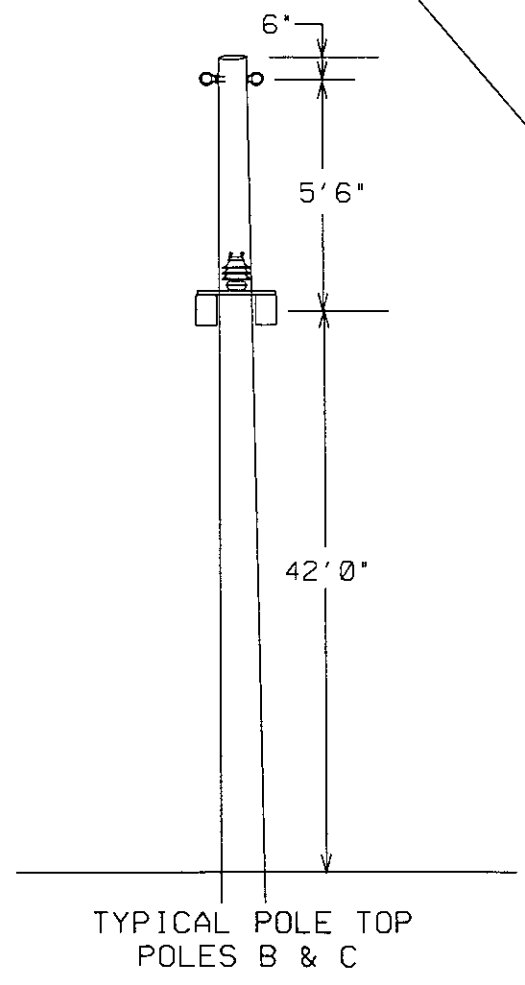
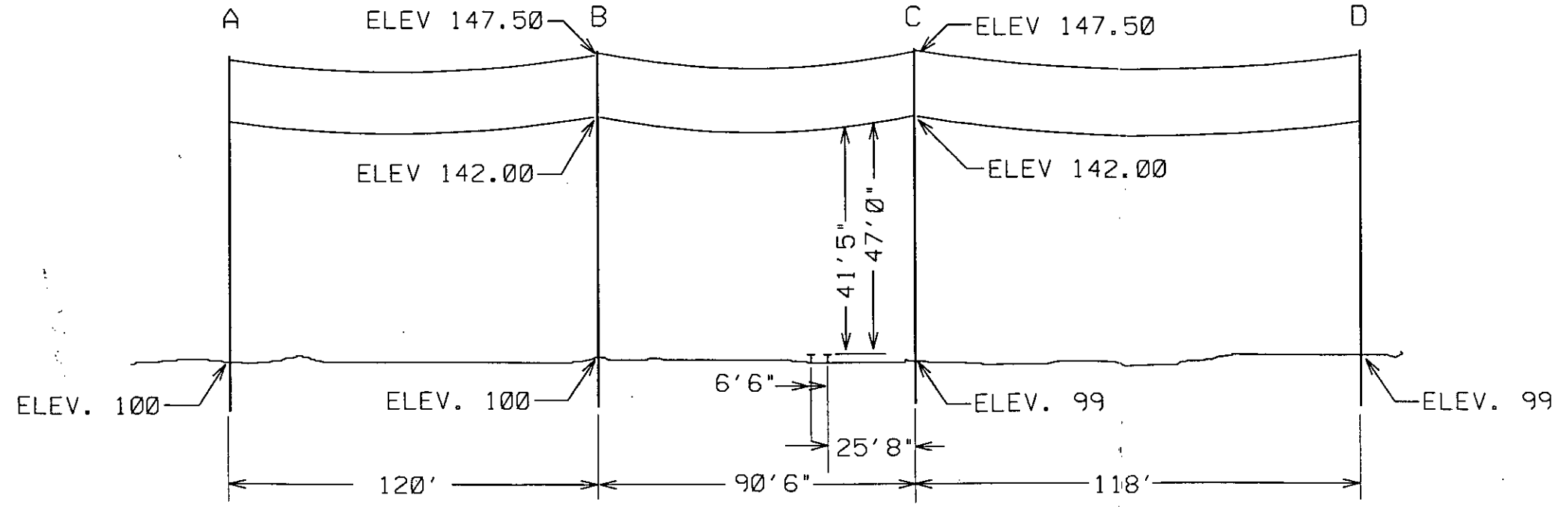

RECORDED R/W FILE NO. 33222 P69

PROPOSED 2"4
5000 VOLT ST LTG WIRES

EXISTING 3"4
4600 VOLT WIRES

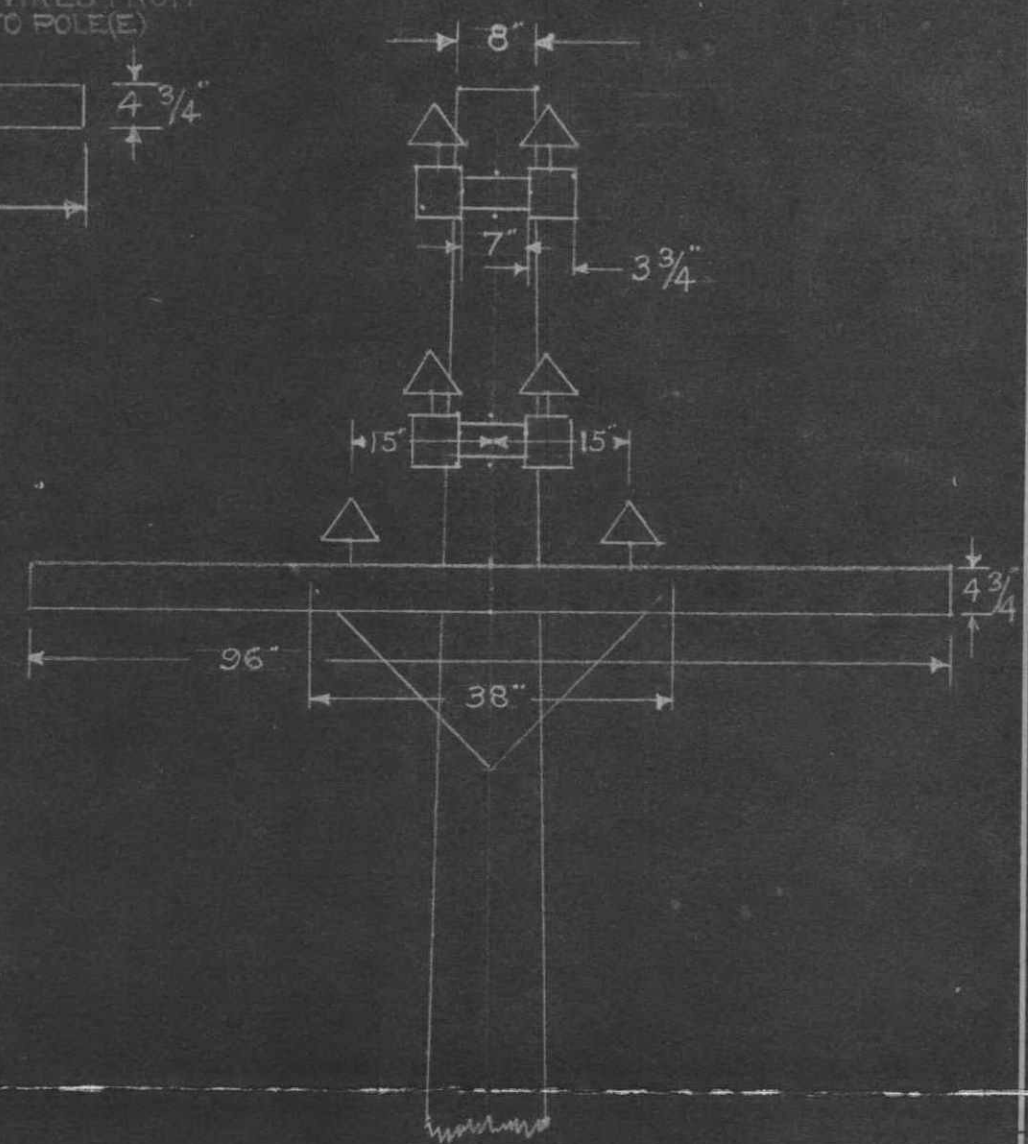
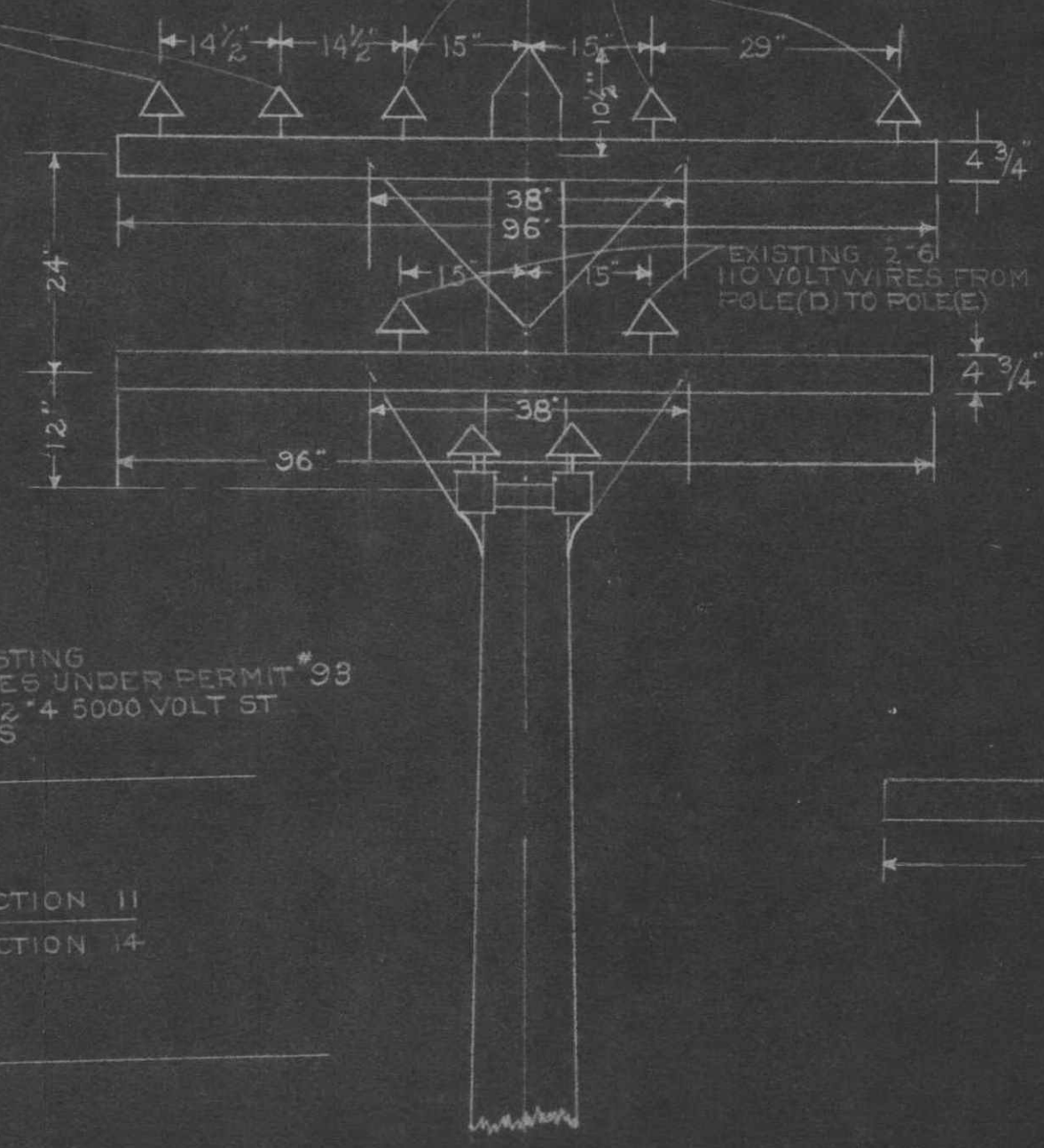
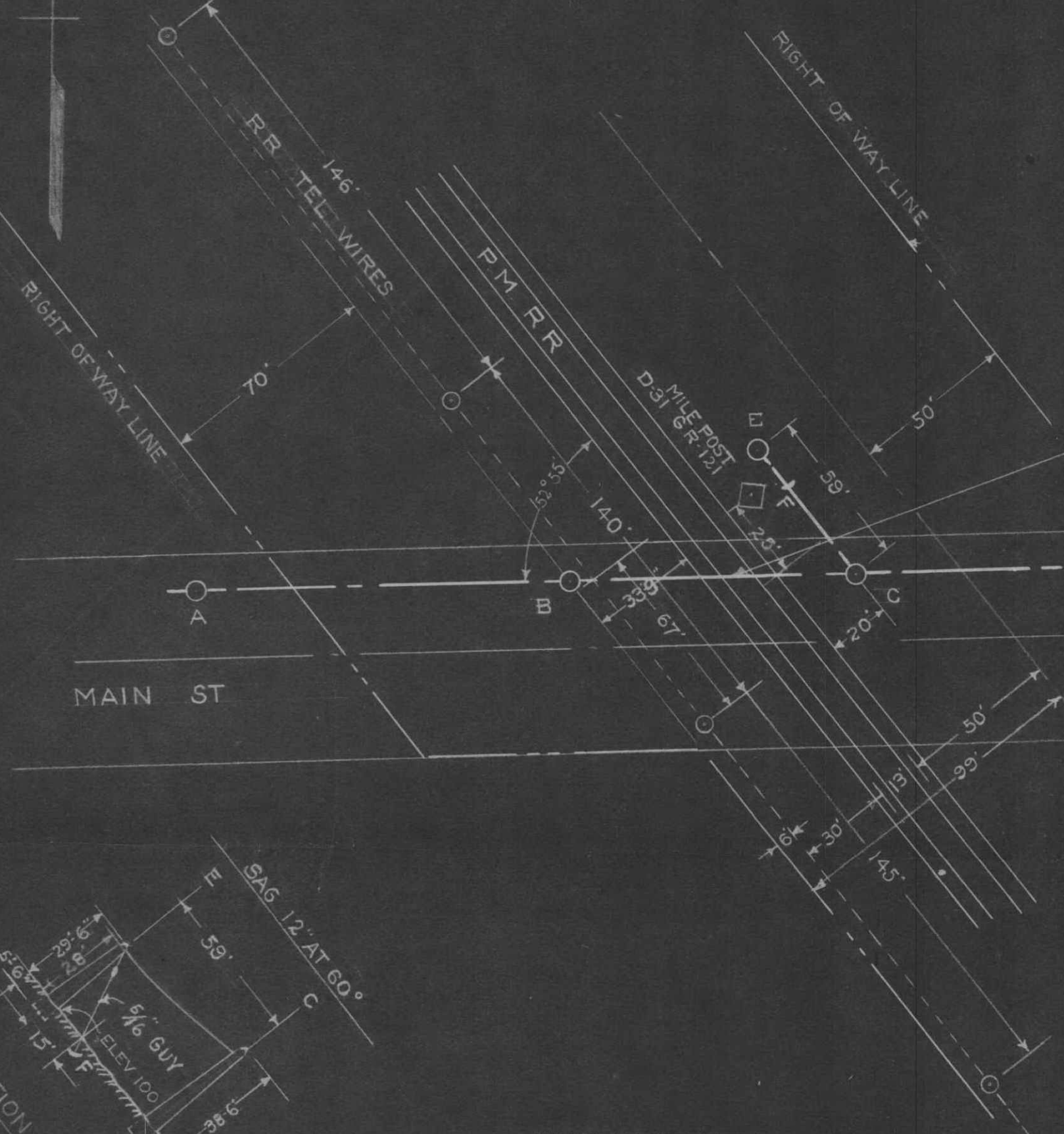

POLE (C) LOOKING WEST

POLE (C) LOOKING NORTH

PLAN OF CROSSING

TYPICAL POLE TOP CONSTRUCTION

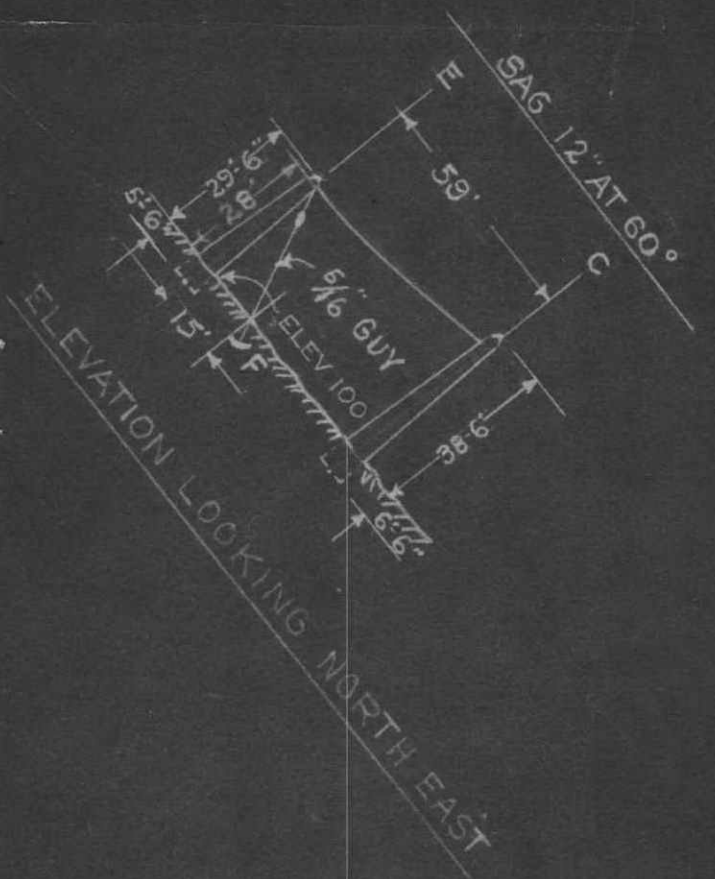

PURPOSE OF LINE
TO SERVE NEW ST LIGHTS
IN UNINCORPORATED VILLAGE
OF SALEM

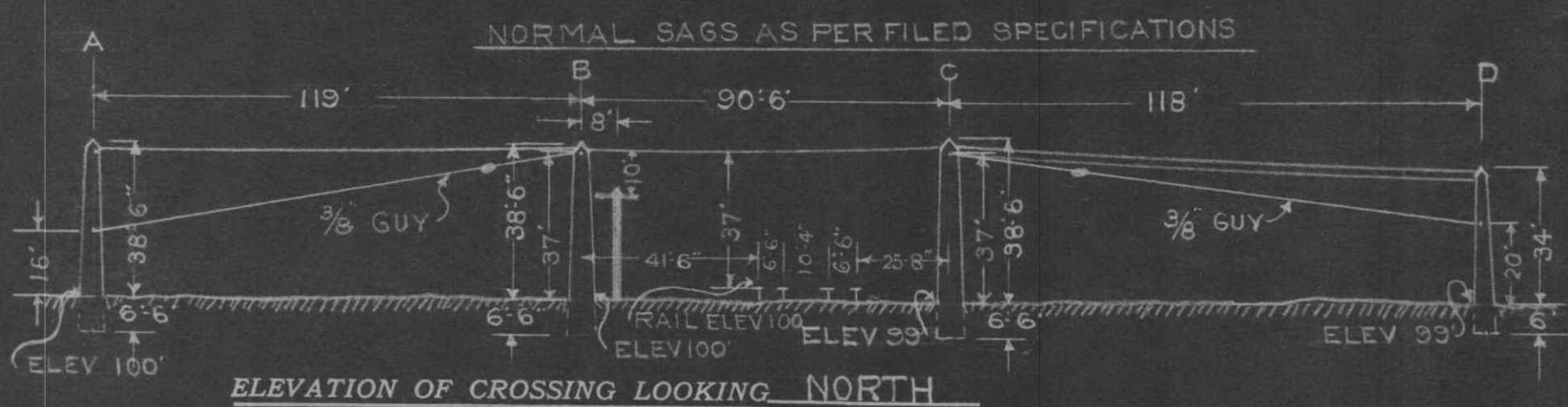

ELEVATION OF CROSSING LOOKING NORTH

RECORDED ROW FILE #
33222P69

APPROVED

VILLAGE _____
CITY SALEM
COUNTY WASHTENAW
TOWNSHIP SALEM
SURVEY NO. OF TWP. 1 SOUTH
RANGE NO. 7 EAST
SECTION NO. SE 1/4 SECTION 11

THE DETROIT EDISON CO.
PLAN SUBMITTED TO MICH.
PUBLIC UTILITIES COMMISSION
FOR 5000 VOLT CROSSING
OVER PERE MARQUETTE RR
DRAWN BY FFH DATE 3-19-25
CHECKED BY D.B. DATE 3-20-25

RECORDED RIGHT OF WAY NO. 33222
p. 69

RECEIVED
MICHIGAN PUBLIC UTILITIES
COMMISSION
MAR 25 1925
U-2174

Blanchard

APPROVED *14m*
FOR
MICHIGAN PUBLIC UTILITIES
COMMISSION
J. G. McRee
ASST CHIEF ENGINEER
FILE U-2174 DATE *3-26-1925*