

STATE OF MICHIGAN
Office of the Michigan Public Utilities Commission, } ss.

I, J. Carl Sheil, Secretary of the Michigan Public Utilities Commission,

Do Hereby Certify, That I have compared the annexed copy of permit No. U-5198

with the original permit

recorded in

and that it is a true and correct transcript therefrom, and of the whole of such original.

In Testimony Whereof, I have hereunto set my hand and affixed

the seal of the Commission, at Lansing, this 6th

day of December in the year of our Lord

one thousand nine hundred twenty-eight

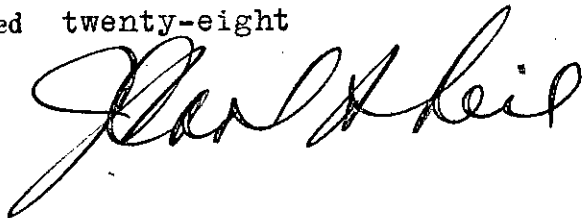

Secretary, Michigan Public Utilities Commission.

MEW

RECORDED RIGHT OF WAY NO.

33222
p 59
3758

2758

STATE OF MICHIGAN
BEFORE MICHIGAN PUBLIC UTILITIES COMMISSION

Standard Railroad Wire-Crossing Permit No. U-5198

In Re Application of **Detroit Edison Company (Detroit)**

Pursuant to Act No. 171 of the Session Laws of 1893, as amended, application having been made to Michigan Public Utilities Commission by said **Detroit Edison Company**

for permission to string wires across the tracks of the **Pere Marquette Railway Co.**

and said **Detroit Edison Company**

having conformed to the Commission's rules governing the filing of notices and issuing of permits for the construction of electrical lines and said rail way company having waived the right of notice and hearing provided for in said act

THEREFORE, It is ordered that said **Detroit Edison Company**

be permitted to string the following described wires across the tracks of said railroad at the following described place:

Village of Memphis,)	In Main Street, with:
St. Clair County,)	
Michigan:-)	3 - #8 copper fire alarm wires;
	6 - #2 copper wires, 4800 volts, 3-phase;
	2 - #6 " " , series street lighting.

as indicated on the attached plans, when, as and if approved.

At the point of crossing said wires shall be constructed in accordance with this Commission's rules and regulations.

Given under our hands and the Official Seal of this Commission at the City of Lansing, State of Michigan, this 6th day of December A. D. 19 28.

MICHIGAN PUBLIC UTILITIES COMMISSION
By

SIDNEY E. DOYLE

Chairman,

JAMES BICE

Commissioner,

BYRON P. HICKS

Commissioner,

ROBERT H. DUNN

Commissioner,

SAMUEL ODELL

Commissioner.

Countersigned

J. Carl Shell

Secretary

RECORDED RIGHT OF WAY NO. 3322
159

*Blanket
warrant
4-16-73
Done and filed
[Signature]*

Name of Company
The Detroit Edison Company.

Name and Location of Crossing
Over the Pere Marquette R.R. in Main Street, approx. 1320' north of the county line between St. Clair and Macomb County, S.W. $\frac{1}{4}$ of section 35, Town 6 north, Range 14 East, Village of Memphis, Riley Twp., St. Clair County, Michigan.

Circuits
Proposed 3 wire fire alarm circuit.
Proposed two 4800 volt, 60 cycle, 3 wire, 3 phase distribution circuits.
Proposed one 2 wire, 60 cycle, series street lighting circuit.

Poles
Poles (E) 35' Idaho Cedar, 22" top circumference, 40" butt circumference at ground line set 6' in clay soil.
Poles (A) & (D) 45' Idaho Cedar, 28" top circumference, 45" butt circumference at ground line set 6'-6" in clay soil.
Poles (B) & (C) 50' Idaho Cedar, 28" top circumference, 47" butt circumference at ground line set 7' in clay soil.
Pole (F) 40' Idaho Cedar, 28" top circumference, 43" butt circumference at ground line set 6' in clay soil.

Guys and Guy Attachments
One 1/2" Guy from pole (A) 35' above ground to anchor (M) 40' from butt of pole (A).
One 5/16" Guy from pole (A) 35' above ground to pole (B) 12' above ground.
One 1/2" Guy from pole (C) 40' above ground to anchor (L) 45' from butt of pole (C).
One 5/16" Guy from pole (D) 36' above ground to anchor (K) 10' from butt of pole (D).
One 5/16" Guy from pole (F) 32' above ground to anchor (N) 10' from butt of pole (F).
One 5/16" Guy from pole (C) 36' above ground to stub (G) 22' above ground.
One 5/16" Guy from pole (E) 28' above ground to anchor (H) 10' from butt of pole (E).
All Guy wire double galvanized stranded steel with a minimum ultimate strength of 55,000 pounds per square inch.

Cross Arms
Existing four 3 $\frac{3}{4}$ " x 4 $\frac{3}{4}$ " x 120" Douglas Fir double cross arm on crossing pole (B).
Existing three 3 $\frac{3}{4}$ " x 4 $\frac{3}{4}$ " x 120" Douglas Fir double buck arms on pole (B).
Existing three 3 $\frac{3}{4}$ " x 4 $\frac{3}{4}$ " x 120" Douglas Fir double cross arms and one 3 $\frac{3}{4}$ " x 4 $\frac{3}{4}$ " x 120" Douglas Fir double Buck arm on Pole (C).

Conductors
Proposed 3 #8 Medium hard drawn solid T.B.W.P. copper fire alarm wires.
Proposed 6 #2 Medium hard drawn solid T.B.W.P. copper wires.
Proposed 2 #6 Medium hard drawn solid T.B.W.P. copper wires.
Removing 3 #8, 3 #6 and 3 #4 wires which were strung under permit U-3303.

RECORDED RIGHT OF WAY NO. 3322
P59

Guy Clamps

One 1 5/8" x 6" three bolts galvanized steel clamp at each end,
for 3/8" and 5/16" guys.

Two 1/2" Crosby guy clamps at each end, for 1/2" guys.

Guy Insulators

Two C.B. #26500 - 3 1/2" porcelain interlocking strain type insulators on
3/8" and 5/16" guys for 24,000 volt circuits and one per guy for lower
voltages.

Two C.B. #25009 - 4" porcelain interlocking strain type insulators on 1/2"
guys for 24,000 volt circuits and one per guy for lower voltages.

Guy Anchor

Four Blade "Everstick" on 1/2" Guys buried 7' deep.

8" Cone on 3/8" and 5/16" guys buried 6' deep.

Anchor Rods

3/4" x 8' round galvanized steel rods on "Everstick" anchors.

5/8" x 6' round galvanized steel rods on 8" Cone anchors.

Cross Arms Attachments

5/8" Galvanized steel center bolts.

5/8" Galvanized steel spacer bolts.

4" x 4" treated pine space blocks.

1/4" x 1" x 28" flat galvanized steel braces.

3/8" galvanized steel bolts at arm end of braces.

1/2" x 5" galvanized steel lag screws at pole end of braces.

Pins

1 1/2" x 14" x 1 3/8" locust pins for 24,000 volt circuits.

1 1/2" x 10-1/8" x 1" locust pins for all other circuits.

Insulators

One C.B. #11623 pin type and four Locke #8049 disc type insulators per
wire, per crossing pole on 24,000 volt circuits.

(One C.B. #11623 and two Locke #8049 for dead ends).

Two C.B. #12847 porcelain pin type insulators per wire, per crossing
pole for 4,800 volt, 2,400 volt, series lighting and private
telephone circuits.

Two #20 Hemingray glass insulators per wire, per crossing pole for
120/240 volt secondary circuits.

One C.B. #12847 pin type and two Colonial #11940 disc type insulators
per wire for 20,000 primary circuits and one #20 Hemingray glass pin
type and two #25009 strain type insulators per wire for 20,000
secondary circuits per crossing pole.

Ties

Standard top groove tie on 24,000 volt, 4,800 volt, 2,400 volt,
series lighting and private telephone circuits.

Standard side groove tie on 120/240 volt secondary circuits.

#8 soft, solid, bare copper tie wire for 24,000 volt circuits.

#6 soft, solid, weatherproof copper tie wires on all other circuits.



FIREPROOF
moving information forward

REPLACE

OVERSIZE

HERE

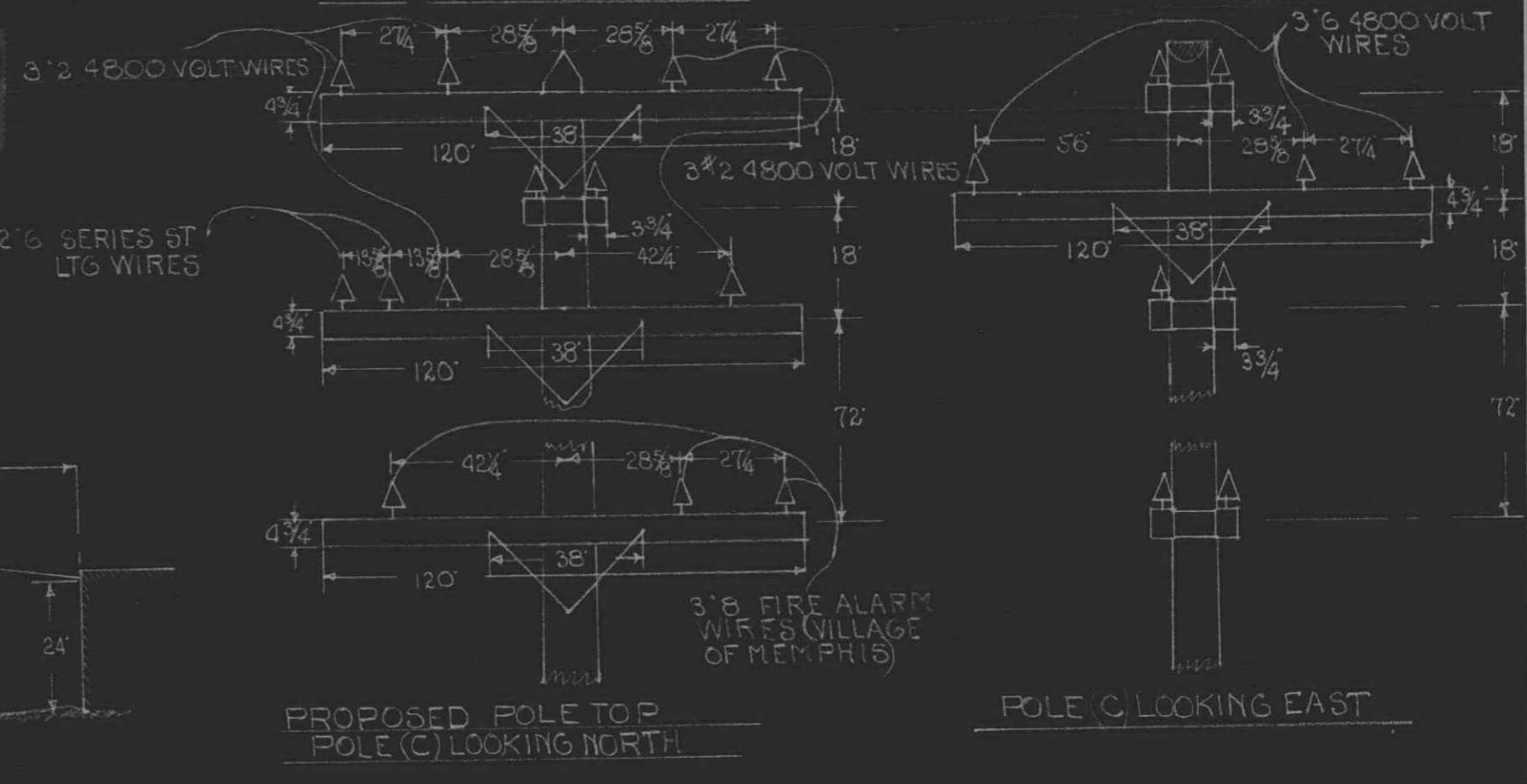
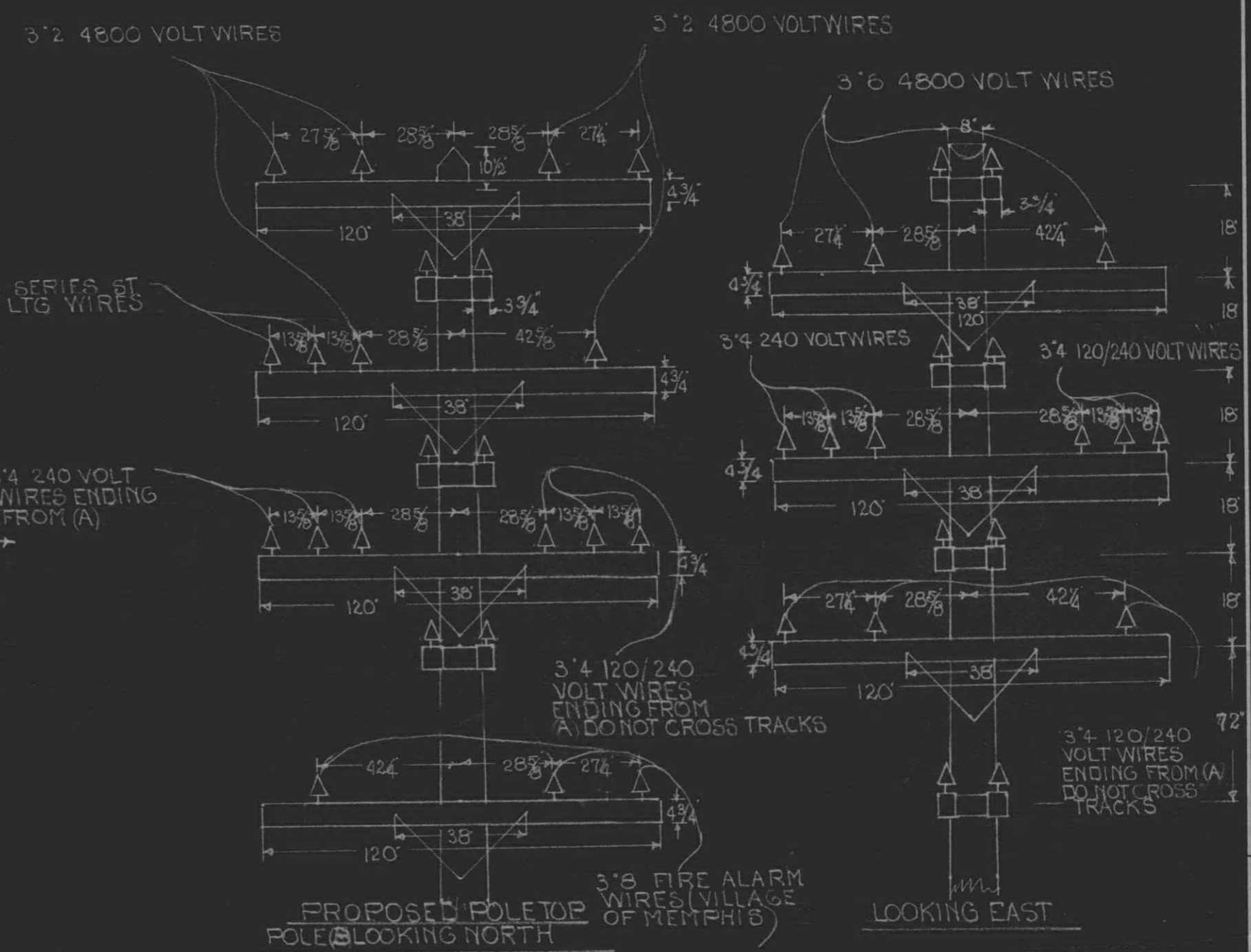
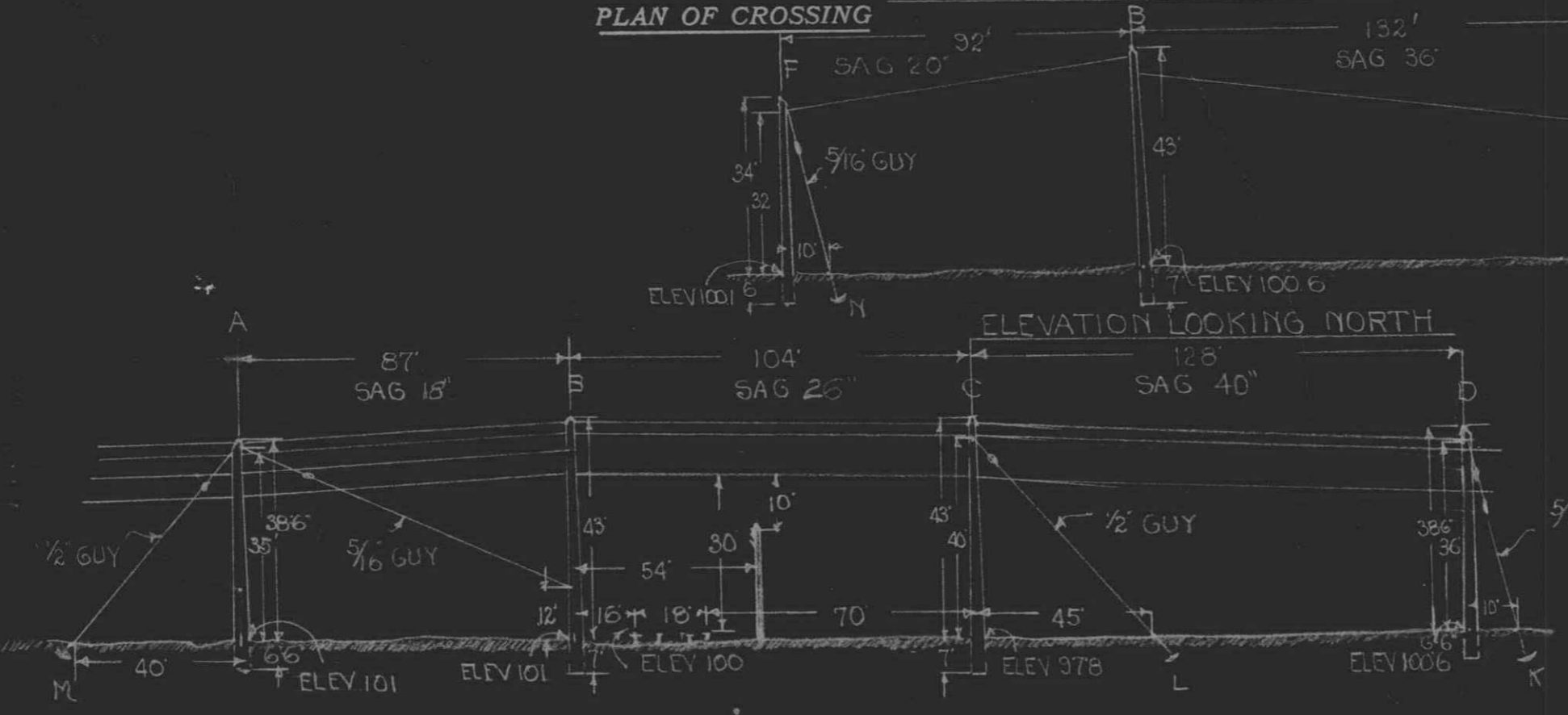
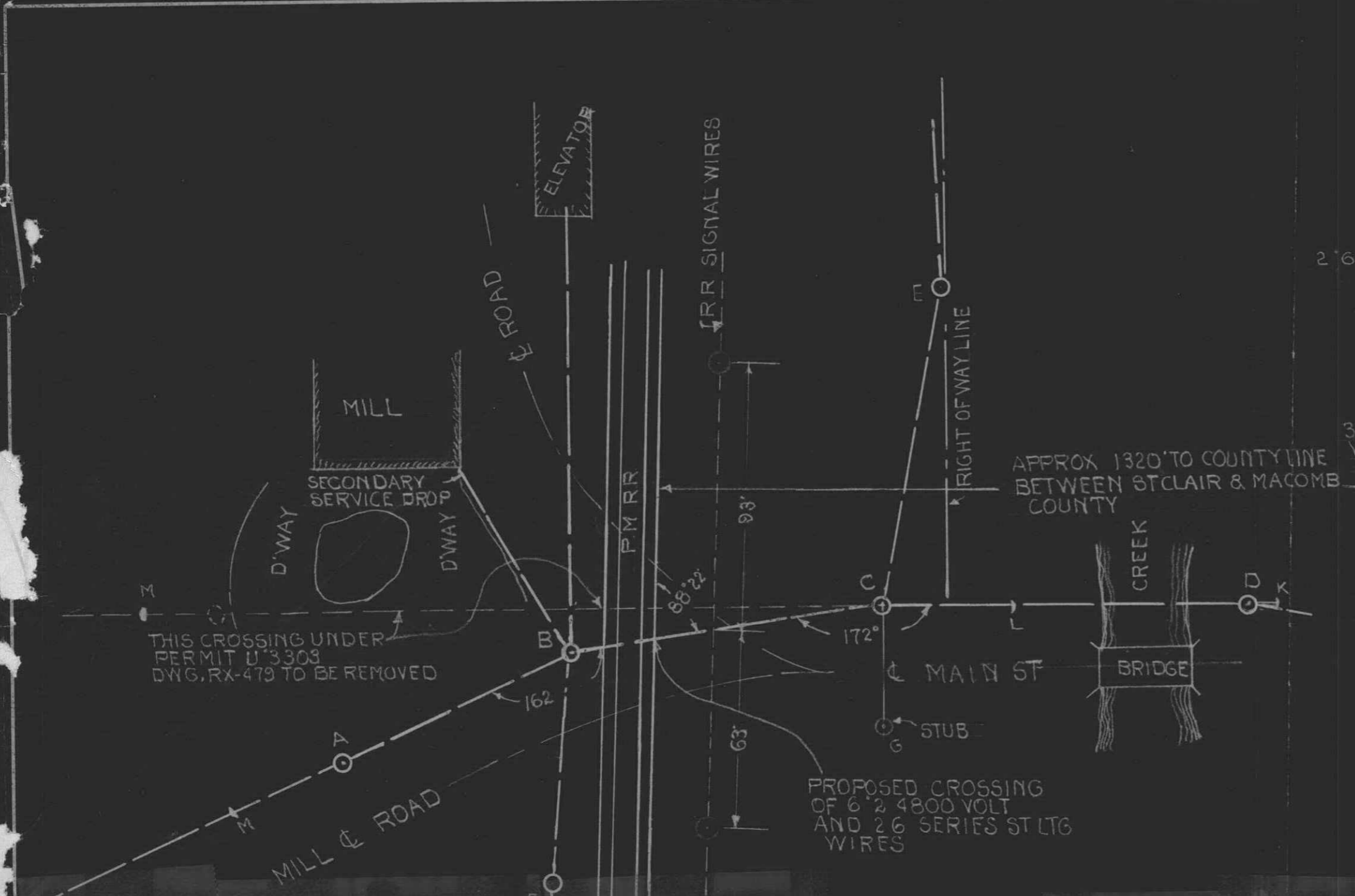

PURPOSE OF LINE
 RELOCATING LEAD
 ON MILL ROAD (MAIN ST)
 VILLAGE OF MEMPHIS
 THIS CROSSING REPLACES
 THAT UNDER PERMIT U 3303
 DWG RX 429

APPROVED *ARB*
 FOR
 MICHIGAN PUBLIC UTILITIES
 COMMISSION
Robert [Signature]
 U-3198 DATE DEC-5-1928
 FILE []

CITY MEMPHIS
 COUNTY ST CLAIR
 TOWNSHIP RILEY
 SURVEY NO. OF TWP. 6 NORTH
 RANGE NO. 14 EAST
 SECTION NO. SW 4 SEC 35

THE DETROIT EDISON CO.
 PLAN SUBMITTED TO MICH.
 PUBLIC UTILITIES COMMISSION
 FOR 4800 VOLT CROSSING
 OVER PERE MARQUETTE RR
 DRAWN BY FEH DATE 11-20-28
 CHECKED BY [] DATE 12-1-28

**RECORDED ROW FILE #
 R33222P59**

RECORDED RIGHT OF WAY NO. 33220
159

DEC 5 1928

ANSIP

DEC 5

RECORDED
MICROFILMED
CO. 111111