

G493394

LI20827PA344

MOBIL HOME PARK

AGREEMENT - EASEMENT - RESTRICTIONS

This instrument made this 11TH day of SEPTEMBER, 1979, by and between the undersigned Owners of land and THE DETROIT EDISON COMPANY, a corporation organized and existing concurrently under the laws of Michigan and New York, of 2000 Second Avenue, Detroit, Michigan, 48226, hereinafter called "EDISON", and MICHIGAN BELL TELEPHONE COMPANY, a Michigan corporation of 1365 Cass Avenue, Detroit, Michigan 48226, hereinafter called "BELL."

W I T N E S S E T H:

Owners are developing a mobile home park in the Township of Canton, County of Wayne, State of Michigan, and described in Appendix "A", attached hereto and made a part hereof, and EDISON and BELL will install their electric and communication facilities underground except necessary above ground equipment.

NOW, THEREFORE, in consideration of the mutual promises and covenants for the installation of underground utility services made by the parties hereto, it is mutually agreed:

(1) The installation, ownership and maintenance of electric services and the charges to be made therefor shall be subject to and in accordance with the Orders and Rules and Regulations adopted from time to time by the Michigan Public Service Commission.

(2) Owners must certify to EDISON and BELL that easements are graded to within four (4") inches of final grade before the underground facilities are installed.

(3) Owners to place survey stakes before trenching to properly indicate perimeter property lines, trailer lots and route of EDISON and BELL lines.

(4) Owners to provide for clearing the easements of trees, stumps, and obstructions sufficiently to allow trenching equipment to operate.

(5) Owners agree to provide adequate cabinet space or meter pedestal for a communications terminating facility of a type approved by BELL.

(6) Owners further agree that if subsequent to the installation of the utility facilities of EDISON and BELL, it is necessary to repair, move, modify, rearrange or relocate any of their facilities to conform to a new plot plan or change of grade or for any cause or changes attributable to public authority having jurisdiction or to Owners action or request, Owners will pay the cost and expense of repairing, moving, rearrangement or relocating said facilities to EDISON or BELL upon receipt of a statement therefor. Further, if the lines or facilities of EDISON and BELL are damaged by acts of negligence on the part of the Owners or by contractors engaged by Owners, repairs shall be made by the utilities named herein at the cost and expense of the Owners and shall be paid to EDISON or BELL upon receiving a statement therefor. Owners are defined as those persons owning the land at the time damage occurred.

(7) Owners hereby grant to EDISON and BELL easements satisfactory to the utilities for electric and communication services in land herein described. When utility lines are installed, this instrument shall be ~~re~~-recorded with an "as installed" drawing, showing the location of said facilities and indicating the easements by their centerlines. Easements shall be six (6') feet in width unless otherwise indicated on said drawing. However, secondary electric service and communication entrance locations, as shown on "as installed" drawings are not guaranteed. Actual locations can be determined after contact with utilities.

* DRAWINGS ATTACHED

-1-

RECORDED
APR 2 1980
FOREST E. YOUNGBLOOD
REGISTER OF DEEDS
WAYNE COUNTY, MICHIGAN

G493394
RECORDED RIGHT OF WAY NO. 33055

PFMI16
L.E. HAGGERTY, 16 PS. OLD MICHIGAN AVE.
65K FUSE, X0
DUCT IN N.E. QUAD

PFMI17
L.E. HAGGERTY, 12PS OLD MICHIGAN AVE.
65K FUSE, X0
DUCT IN N.E. QUAD

PFMI15
L.E. HAGGERTY, 16 PS. OLD MICHIGAN AVE.
65K FUSE, X0
DUCT IN N.E. QUAD

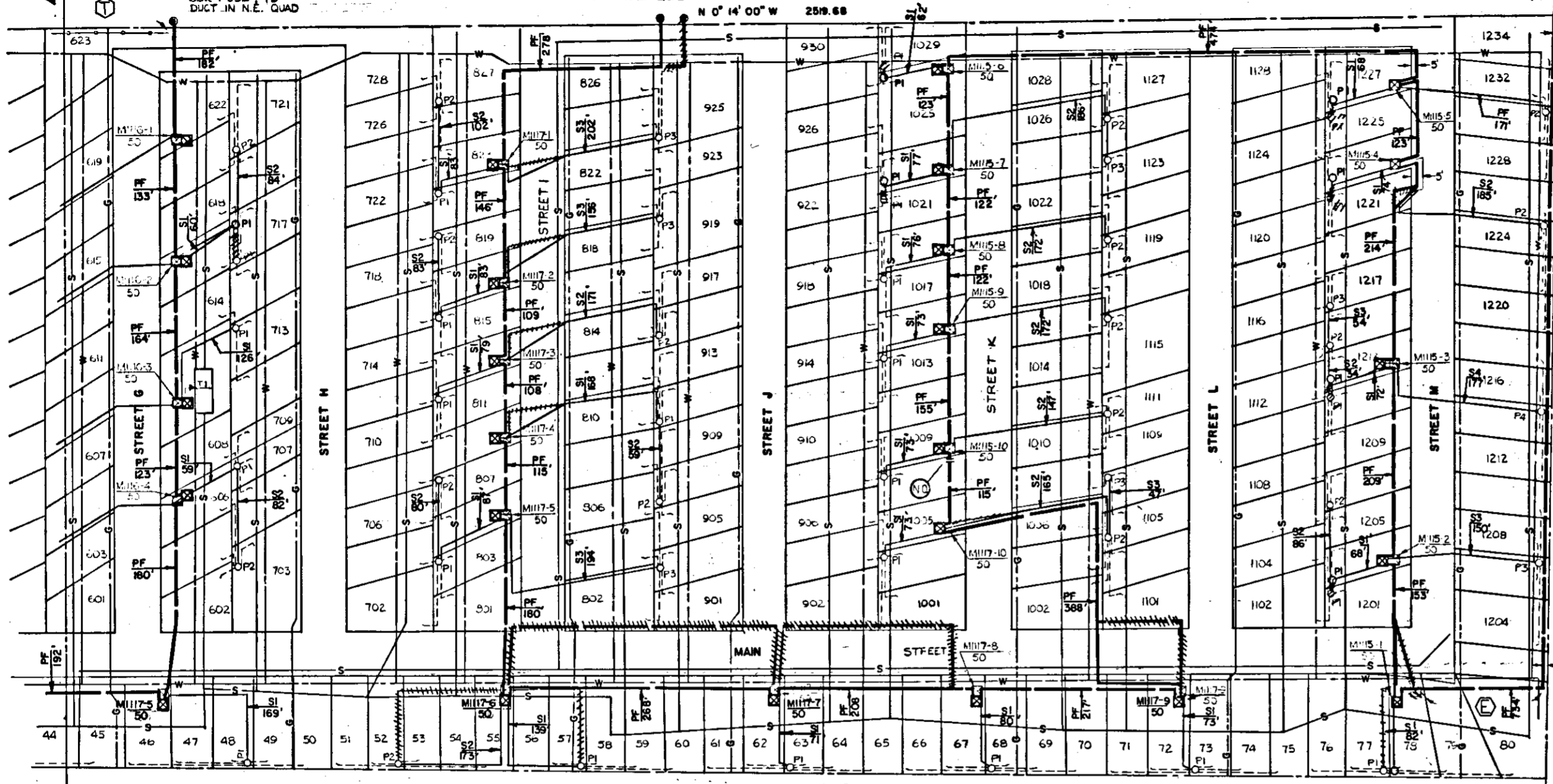

TRANSFORMER DATA

U.D.T. NO.	SIZE	ED. STK. NO.
MI15-1	50	661-1152
MI16-		
MI17-		
	50	661-1152

TRANSFORMER SPECS.
PEDESTAL SPEC.-R13
NO. OF PEDESTALS

- CODE -

- ⊙ TEMPORARY SECONDARY PEDESTAL
- DFT (DEAD FRONT TYPE)
- ⊠ UDT (NON-SWITCHING-LIVE FRONT TYPE)
- ⊞ UDT (SWITCHING-LIVE FRONT TYPE)
- DIRECTION OF TRANSFORMER DOOR OPENING
- SECONDARY PEDESTAL
- △ SECONDARY TERMINAL
- ⊙ CABLE POLE
- PRIMARY SWITCH CABINET
- BURIED PRIMARY CABLE-ALL VOLTAGES
- BURIED SECONDARY CABLE
- BURIED SECONDARY SERVICE CABLE
- DETROIT EDISON TRENCH ONLY
- TELEPHONE TRENCH ONLY
- SEWER
- WATER
- GAS
- PROPOSED CONDUIT

HAGGERTY ROAD 120 R/W

NOTE:
① ALL TRANSFORMERS ARE SET BACK 15' FROM FRONT LOT LINE.

WEST 1/4 CORNER SEC. 36 T2S. R.8E CANTON TWP

② M.B.T. JOINT ON ALL ROAD CROSSINGS
NO CONDUIT SQUEEZE BORE

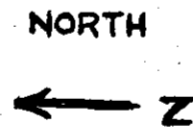

NOTICE

Locations of underground facilities on this drawing are only approximate. Exact locations must be determined by the UTILITY COMPANIES. For exact locations, telephone MISS DIG on 800-482-7171 as required by Public Act 53 of 1974 before doing any power excavating.

CABLE SUMMARY

ITEM#	#2APC X 1 13.2 KV	713-3029
ITEM#	AP2-350M & 1-4/0 600 V.	713-0537
ITEM#	AP2-2/0 & 1-#1 600 V.	713-0514

TRENCH SUMMARY

JOINT USE	
D. E. ONLY	
TEL ONLY	
TOTAL	

SITE SUPT. JIM FOLGER
PHONE NO. 397-0303

- GENERAL NOTES -

TRENCHING TO BE DONE BY HEATH CO.
TRENCH AND CABLE LENGTHS ARE APPROXIMATE.
SEE DRAWING UI-1-2369 FOR TRANS. MAT. DETAILS.
SEE PAGE 3-2-11 (S.I.M.) DETAIL " " FOR ENTRANCE POINT DETAILS (APTS. ONLY)
SEE DRAWING UI-4-2263 FOR PLACEMENT OF CABLES, TRANSFORMERS AND PEDESTALS (SUBS'DS ONLY).
D.E. SERVICE PLANNER: AL CASSELL 295-1650
TEL. CO.: BOB MCGUIGAN 277-2833

CONTACT "MISS DIG" 800-482-7171 BEFORE DOING ANY EXCAVATION.
EASEMENTS INDICATED BY OUR CENTERLINES ARE (6') SIX FEET IN WIDTH UNLESS OTHERWISE NOTED.

PERMITS REQUIRED

DEPT. ORDER: 79A-34404
WORK ORDER 367BJ501
START: 9-24-79
FINISH: 12-7-79
LABOR: HEATH ENERGY INC.

D REVISION			C REVISION			B REVISION			A REVISION			REFERENCE	NAME	DATE	JOB TITLE	THE DETROIT EDISON COMPANY SERVICE PLANNING DEPARTMENT							
									AS INSTALLED IN FIELD FOR RECORDING			DRAWN BY	L SEVERO	6-5-79	SHERWOOD MOBILE HOME PARK	SCALE	1" = 50'	NUMBER OF UNITS	398	WORK ORDER NUMBER	367BJ3J501		
												CHECKED BY	AL CASSELL	9-4-79	PART OF THE WEST 1/4 SECTION 36, T2S, R8E								
												APPROVED BY	<i>[Signature]</i>	9-13-79	CANTON TWP.								
															DISTRIBUTION CIRCUIT			8185 SHELDON 13.2KV					
															DEPT. ORDER NUMBER			79A-34404			SHEET 2 OF 2 SHEETS		
															WAYNE CO.			MICH.					

RETURN TO:
Real Estate, R/W & Claims
8750 Telegraph (Rm. 225)
Taylor, MI 48180

RECORDED RIGHT OF WAY NO. _____

2/c

RETURN TO:
Real Estate, R/W & Claims
8750 Telegraph (Rm. 225)
Taylor, MI 48180

REGISTER OF DEEDS
STATE OF MICHIGAN

APR 2 AM 10 13

REGISTERED
WASHTENAW COUNTY MICH.

5-2-00 URB1-000096 0 1111 0021

PFMI14
L.E. HAGGERTY, 2PS OLD MICHIGAN AVE.
590 E. W. S. 1000

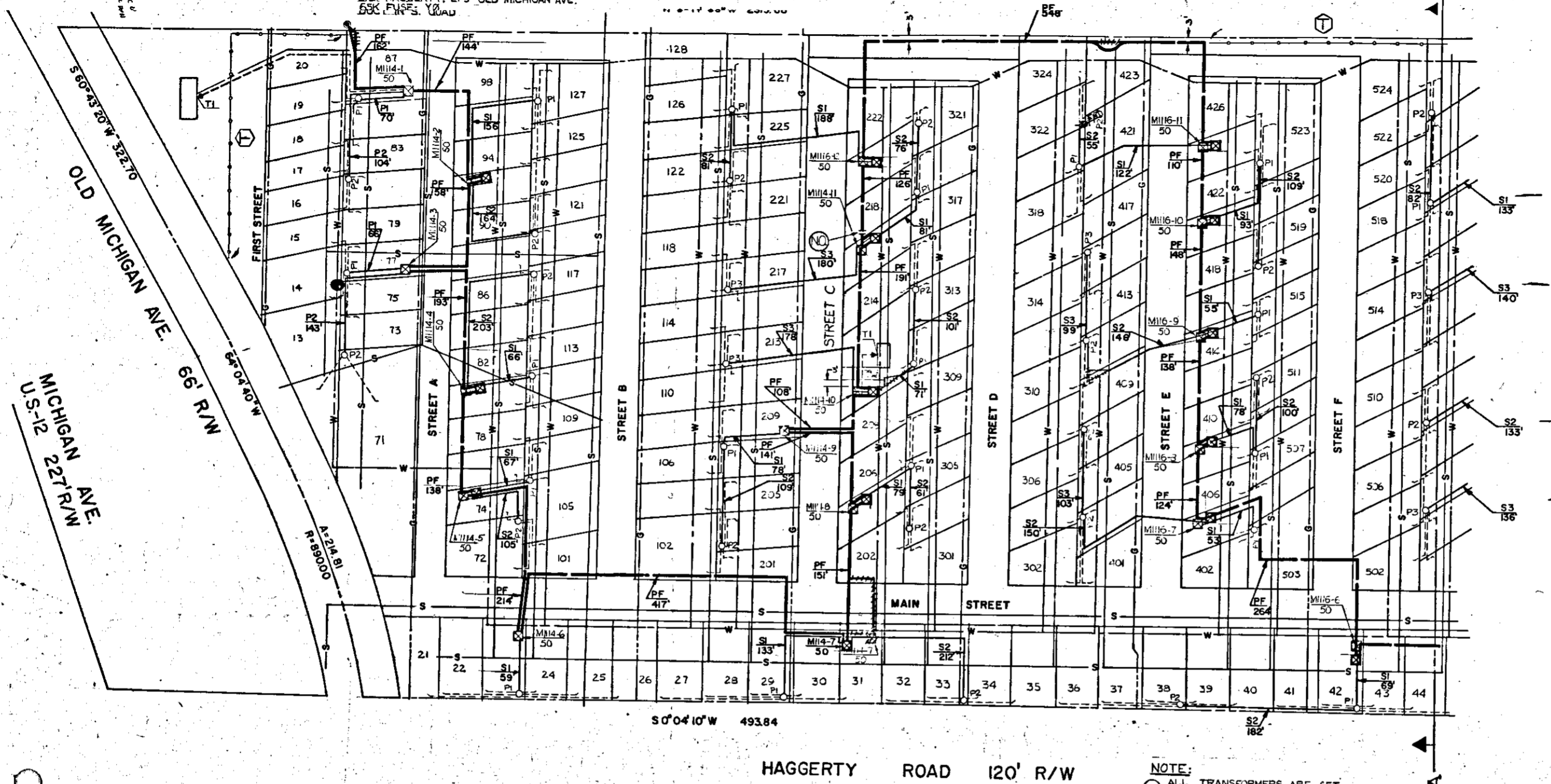

TRANSFORMER DATA

U.D.T. NO.	SIZE	ED. STK. NO.
MII14-1	50	661-1152
MII14-2		
MII14-3		
MII14-4		
MII14-5		
MII14-6		
MII14-7		
MII14-8		
MII14-9		
MII14-10		
MII14-11		
MII14-12	50	661-1152

* TRANSFORMER DATA CONTINUED ON SHEET 2

TRANSFORMER SPECS. 1-17-261
PEDESTAL SPEC.-R13
NO. OF PEDESTALS 93

- CODE -**
- ⊙ TEMPORARY SECONDARY PEDESTAL
 - ⊠ DFT (DEAD FRONT TYPE)
 - ⊡ UDT (NON-SWITCHING-LIVE FRONT TYPE)
 - ⊣ UDT (SWITCHING-LIVE FRONT TYPE)
 - ← DIRECTION OF TRANSFORMER DOOR OPENING
 - SECONDARY PEDESTAL
 - ▲ SECONDARY TERMINAL
 - ⊙ CABLE POLE
 - ⊠ PRIMARY SWITCH CABINET
 - BURIED PRIMARY CABLE-ALL VOLTAGES
 - BURIED SECONDARY CABLE
 - BURIED SECONDARY SERVICE CABLE
 - DETROIT EDISON TRENCH ONLY
 - TELEPHONE TRENCH ONLY
 - SEWER
 - WATER
 - GAS
 - PROPOSED CONDUIT

NOTE:
① ALL TRANSFORMERS ARE SET 15' BACK FROM FRONT LOT LINE.
② MBT JOINT ON ALL ROAD CROSSINGS NO CONDUIT, SQUEEZE BORE

ACTUAL CABLE SUMMARY CABLE SUMMARY

ITEM #	DESCRIPTION	QUANTITY	UNIT
9,010	ITEM# 455 #2A/GALX 1 13.2 KV	713-3062-	9100'
10,122	ITEM# 437 AP2-350M & 1-4/0 800 V.	713-0537-	11,400'
23,699	ITEM# AP2-2/0 & 1-#1 800 V.	713-0814-	23,000'

TRENCH SUMMARY BORE TOTAL

JOINT USE	BORE	TOTAL
D. E. ONLY	13,490'	1,760'
TEL. ONLY	725'	
TOTAL	14,265'	1,760'

SITE SUPT. JIM FOLGER
PHONE NO. 397-0303

- GENERAL NOTES -

TRENCHING TO BE DONE BY HEATH CO.
TRENCH AND CABLE LENGTHS ARE APPROXIMATE.
SEE DRAWING UI-4-2269 FOR TRANS. MAT. DETAILS.
SEE PAGE 3-211 (S.I.M.) DETAIL " " FOR ENTRANCE POINT DETAILS (APTS. ONLY)
SEE DRAWING UI-4-2263 FOR PLACEMENT OF CABLES, TRANSFORMERS AND PEDESTALS (SUBS. ONLY).
D.E. SERVICE PLANNER: A. CASSELL 295-1630 ext. 249
TEL. CO.: B. MCGUIGAN 277-9923

CONTACT "MISS DIG" 800-482-7171 BEFORE DOING ANY EXCAVATION.
EASEMENTS INDICATED BY OUR CENTERLINES ARE (6') SIX FEET IN WIDTH UNLESS OTHERWISE NOTED.

PERMITS REQUIRED

NOTICE

Locations of underground facilities on this drawing are only approximate. Exact locations must be determined by the UTILITY COMPANIES. For exact locations, telephone MISS DIG on 800-482-7171 as required by Public Act 53 of 1974 before doing any power excavating.

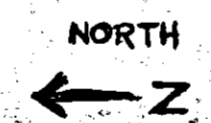

33055
RECORDED R/W FILE NO.

DEPT. ORDER: 79A-34404
WORK ORDER: 367813J501
START: 9-24-79
FINISH: 12-7-79
LABOR: HEATH ENERGY, INC.

D	C	B	A	REFERENCE	NAME	DATE	JOB TITLE	THE DETROIT EDISON COMPANY		
					M.R. L. SEVERO	8-8-79	SHERWOOD MOBILE HOME PARK	SCALE	NUMBER OF UNITS	WORK ORDER NUMBER
					A.L. CASSELL	9-4-79	PART OF THE WEST 1/4 SECTION 36, T2S, R8E	1" = 50'	398	367813J501
						9-4-79	CANTON TWP.	LATEST REVISION	DISTRIBUTION CIRCUIT	
						9-23-79	WAYNE CO.		8195 SHELDON	13.2KV
							MICH.	DEPT. ORDER NUMBER		
								79A-34404		
									SHEET 1 OF 2 SHEETS	

RECORDED RIGHT OF WAY NO. 33055

33055

RETURN TO:
Real Estate, R/W & Claims
8750 Telegraph (Rm. 225)
Taylor, MI 48180

RETURN TO:
Real Estate, R/W & Claims
8750 Telegraph (Rm. 225)
Taylor, MI 48180