

11-30-79

To: Records Center

From: Sharon L. Sounart  
Real Estate and Rights of Way Department

Subject: In private property, 205 ft. east of Meridian & 4,000 ft. south of Turner Rd., approx. 3 miles west of Williamston, SW $\frac{1}{4}$  of Section 32, Williamston Township, T4N, R1E, Ingham County, Michigan

The attached papers are for records center storage. Information about the completed transaction is shown in the following summary.

*et ORR*

R.R. 1	R.R. INVOICE NO. M.P.S.C. NO. OR R.E. & R/W NO. 9	Update 10 Type	D.E.C.O. RECORDS CENTER FILE NO. 15	R.X. NO. OR MAP NO. 20	Facility 21	Agreement 22 Date 27
02		1		3235B	1	1101679
Payment Frequency 23	Rental 21 33	OH-UG 34 Code	Division 35	County 36	City or Township 38	Section 45
A	00075	1	1	02	WILLIAM	32

Location									
47									50
PP205FT E OF MERIDIAN AND 4000 FT S TURNER									

Update Type Codes  
 1 = New Agreement  
 2 = Revised Agreement  
 3 = Terminated Agreement

The Accounts Payable Department is requested to start or change the rental payment effective

Approved: *S. L. Sounart*

- cc:  Accounts Payable  
 Service Planning  
 System Engineering  
 Transmission & Distribution

RECORDED DATE OF FAX NO. 32843

11-30-79

To: Records Center

From: Sharon L. Sounart  
Real Estate and Rights of Way Department

Subject: In private property, 205 ft. east of Meridian & 4,000 ft. south of Turner Rd., approx. 3 miles west of Williamston, SW $\frac{1}{4}$  of Section 32, Williamston Township, T4N, R1E, Ingham County, Michigan

The attached papers are for records center storage. Information about the completed transaction is shown in the following summary.

R.R. 1	R.R. INVOICE NO. M.P.S.C. NO. OR R.E. & R/W NO. 9	Update 10 Type	D.E.C.O. RECORDS CENTER FILE NO. 15	R.X. NO. OR MAP NO. 20	Facility 21	Agreement 22 Date 23
02		1		3235B	1	1101679
Payment Frequency 24	Rental 25 33	OH-UG 34 Code	Division 35	County 36	City or Township 38 44	Section 45
A	00075	1	1	02	WILLIAM	32

*copy*

RECORDED RIGHT OF WAY NO. 32843

Location															
41															80
PP205FT E OF MERIDIAN AND 4000 FT S TURNER															

- Update Type Codes  
 1 = New Agreement  
 2 = Revised Agreement  
 3 = Terminated Agreement

The Accounts Payable Department is requested to start or change the rental payment effective

Approved: *S. L. Sounart*

- cc:  Accounts Payable  
 Service Planning  
 System Engineering  
 Transmission & Distribution



6737 Southpoint Drive, South Suite 100  
Jacksonville, Florida 32216  
(904) 279-4515  
FAX (904) 279-4586  
or (904) 279-4581

T. R. Jackson  
Assistant Vice President

DUPLICATE ORIGINAL

March 19, 1992

Mr. Thomas Wilson  
Detroit Edison Company  
2000 Second Avenue  
Detroit, MI 48226

Dear Mr. Wilson:

This letter will confirm our understanding and agreement that for One Dollar and Other Valuable Consideration paid by the Detroit Edison Company (DE) effective as of April 1, 1992, CSX Transportation, Inc., hereby waives future rental requirements (provided there shall be no refunds of any prepaid rentals) and termination rights for the now existing aerial and underground wireline and pipeline crossing agreements identified on the attached Exhibit A. Except as described in the preceding sentence, the terms of all such agreements remain unaltered and in full force and effect.

Please indicate your understanding and acceptance of the foregoing by having the duplicate original of this letter executed on your behalf and return to the undersigned. No further revision of the individual license agreements will be necessary to effect the changes set forth in the first sentence of the first paragraph other than this letter exchange, which will constitute a supplement to each agreement.

By: CSX TRANSPORTATION, INC.  
CSX Real Property, Inc.  
Its Attorney-in-Fact

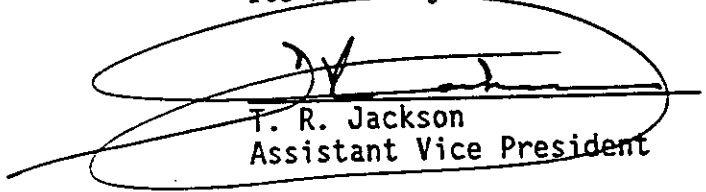
  
T. R. Jackson  
Assistant Vice President

TRJ:hkm

THE FOREGOING IS UNDERSTOOD AND AGREED THIS 19th DAY OF MARCH, 1992.

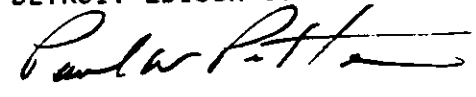
DETROIT EDISON COMPANY  

BY: \_\_\_\_\_  
Title: Paul W. Potter, Director -  
Corporate Real Estate

RECORDED RIGHT OF WAY NO. 32843

SEE:  
RECORDED RIGHT OF WAY NO. 43790



2000 Second Avenue  
Detroit, Michigan 48226  
(313) 237-8000

November 13, 1979

Mr. Lonskey  
Dept. of Transportation  
2 North Plaza  
Jackson, MI 49202

Gentlemen:

The Detroit Edison Company plans to construct, operate,  
and maintain an overhead line in City of Williamston,  
Township of Williamston, Ingham County, Michigan.

The line will cross the tracks of the Chesapeake and  
Ohio Railway Co. The wires to be installed  
are:

SPAN B - D

Two - 1/0 ACSR 13,200 Volts  
One - 1/4 EHS Guy 0 Volts

RECEIVED

NOV 15 1979

JACKSON DISTRICT #8

Michigan State Highway Department

The railroad has given the following waiver of hearing.

- Waiver dated 10-11-79 enclosed
- Blanket Waiver on file with the MPSC.

The proposed crossing is shown on drawing No. RX-3235B

- This is a new crossing.
- This is a re-construction.

Please grant a State Highway Permit to the Detroit Edison  
Company for the proposed crossing.

APP # 33000-137-79 R  
Permit No. JA-712-79

Date 11-16-79

No fee

APPROVED

NOV 16 1979  
*John Lonskey*

DISTRICT UTILITIES ENG.  
M.D.S.H. & T.

Very truly yours,

*Leslie G. Sundstrom*

Leslie G. Sundstrom  
Office Supervisor  
Real Estate & Rights of Way  
630 WCB

RECORDED RIGHT OF WAY NO. 32843

October 3, 1979

**Detroit Edison**

2000 Second Avenue  
Detroit, Michigan 48226  
313/237-8000

Mr. E. Q. Johnson, Chief Engineer  
The Chesapeake and Ohio Railway Company  
P. O. Box 1800  
Huntington, West Virginia 25718

**Proposed Overhead Wire Crossing:**

SPAN B - D

Two - 1/0 ACSR 13,200 Volts  
One - 1/4 EHS Guy 0 Volts

3860+40

Location: \_\_\_\_\_  
Sub-Division: Plymouth  
Division: Michigan  
P.S.C. Hearing ~~Waived~~ October 11, 1979  
The Chesapeake and Ohio Railway Company

Chief Engineer-System

Your File \_\_\_\_\_  
C.O. File 131-4-3375

**Specific Location**

In private property, 204 ft. east of Meridian & 4,000 ft. south of Turner Rd., approx. 3 miles west of Williamston, SW $\frac{1}{4}$  of Section 32, Williamston Township, T4N, R1E, Ingham County, Michigan.

RECORDED RIGHT OF WAY NO. 33843

R.R. Valuation Station \_\_\_\_\_ R.R. Mile Post D-77  
City/Village Williamston Township Williamston  
County Ingham Detroit Edison Plan Attached RX 3235B  
This is a New Crossing \_\_\_\_\_ This is a Reconstruction of Existing Crossing XX  
Previous Agreement Information (if any) Date 11/9/66 (R.R. Plan) 131-4-8555  
#9158

Blanket Waiver of Hearing Covers \_\_\_\_\_ Waiver of Hearing Requested In Duplicate  
(Waiver of Hearing to be mailed to applicant listed below)

All construction will be done in accordance with the rules and regulations of the Michigan Public Service Commission.

*Leslie G. Surdstrom*  
Leslie G. Surdstrom  
Office Supervisor  
Real Estate & Rights of  
Way Department

PROPOSED LINE CROSSING OVER CHEAS. PEAKE OHIO R.R.  
IN P.R. PRO 204' E MERIDIAN RD. 4000' S. TURNER RD.

EXISTING PERMIT NUMBER ED2-8-5917  
CITY OF APPROX. 3 MILES W. OF WILLIAMSTON

SECTION 32 S.W. 1/4 TOWNSHIP WILLIAMSTON T 4N R 1E COUNTY INGHAM

CONDUCTORS		POLES					
NUMBER	SIZE	KIND	VOLTAGE	LOCATION	LENGTH	CLASS	SET
2	0	ACSR	13,200	B	45	3	
1	1/4"	E.H.S.	-0-	C & E	35	5	
				D	50	4	
				F	45	3	

MINIMUM CLEARANCES		
NEAREST POLE TO RAIL	SIDING	7 FT
	MAIN LINE	12 FT
WIRES OVER TRACKS	0 - 750 VOLTS	27 FT
	750 - 15,000 VOLTS	28 FT
	15,000 - 50,000 VOLTS	30 FT
	50,000 - 120,000 VOLTS	33 FT
WIRES OVER R R SIGNAL	0 - 750 VOLTS	2 FT
	750 - 8,700 VOLTS	4 FT
	8,700 - 50,000 VOLTS	6 FT
	50,000 - 120,000 VOLTS	9 FT

DESIGNED BY M. J. MARVIN		DIVISION ANN ARBOR	
CHECKED BY E.M. HOFFMAN		SYSTEM ENGINEERING DEPT.	
		DATE 9-21-79	

SPAN	SPAN LENGTH	LOWEST CONDUCTOR OVER R. R. TRACKS	STRINGING SAG AT 60° F	HEIGHT OF LOWEST CONDUCTOR OVER	
				R. R. TRACKS	R. R. SIGNAL WIRE
B - D	166'	1/4" E.H.S. - GUY	NO SAG	34.6'	15.1'

SAG TABLE NO SAG - GUY  
RULING SPAN \_\_\_\_\_  
FINAL SAG RATIO \_\_\_\_\_

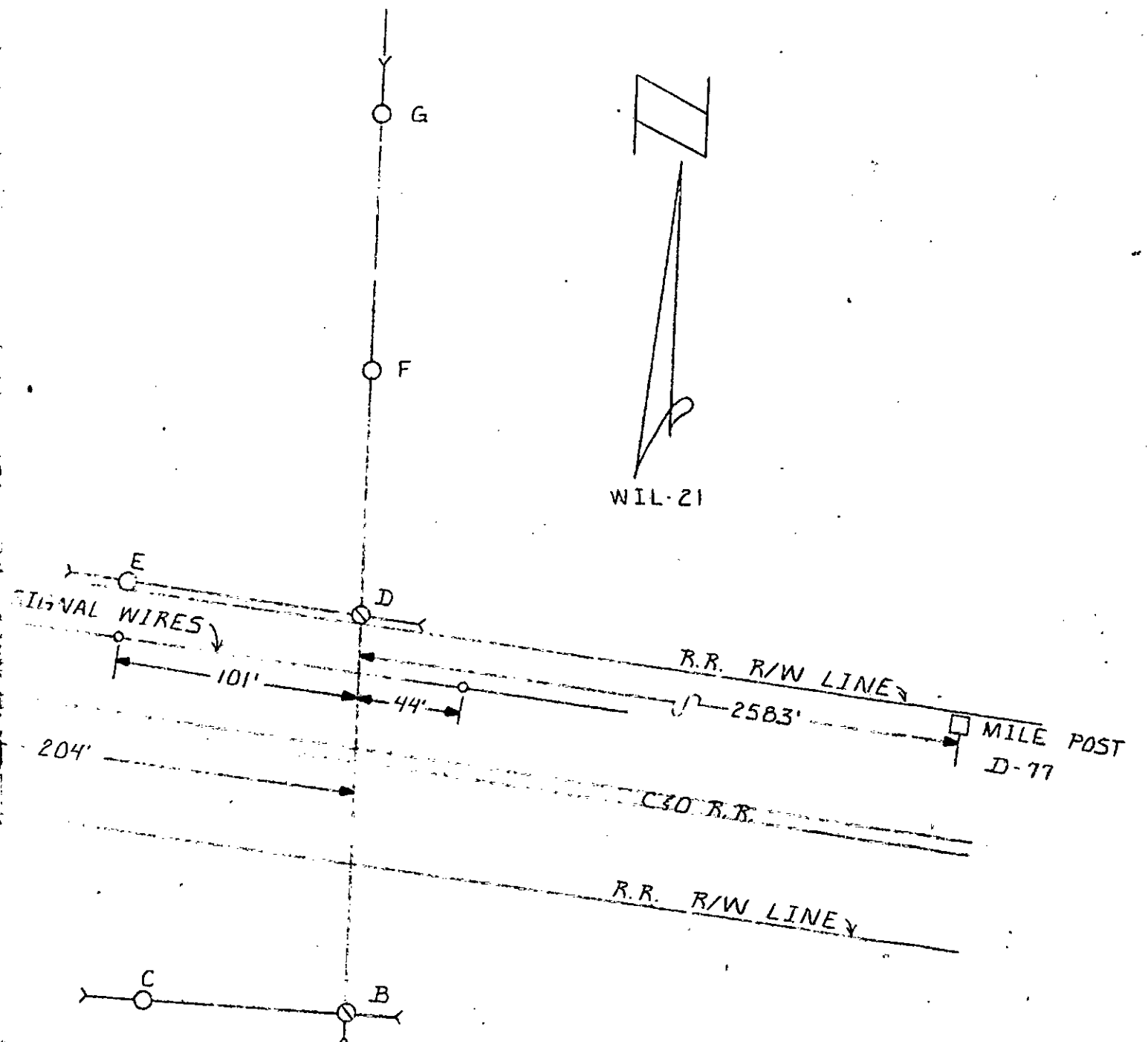
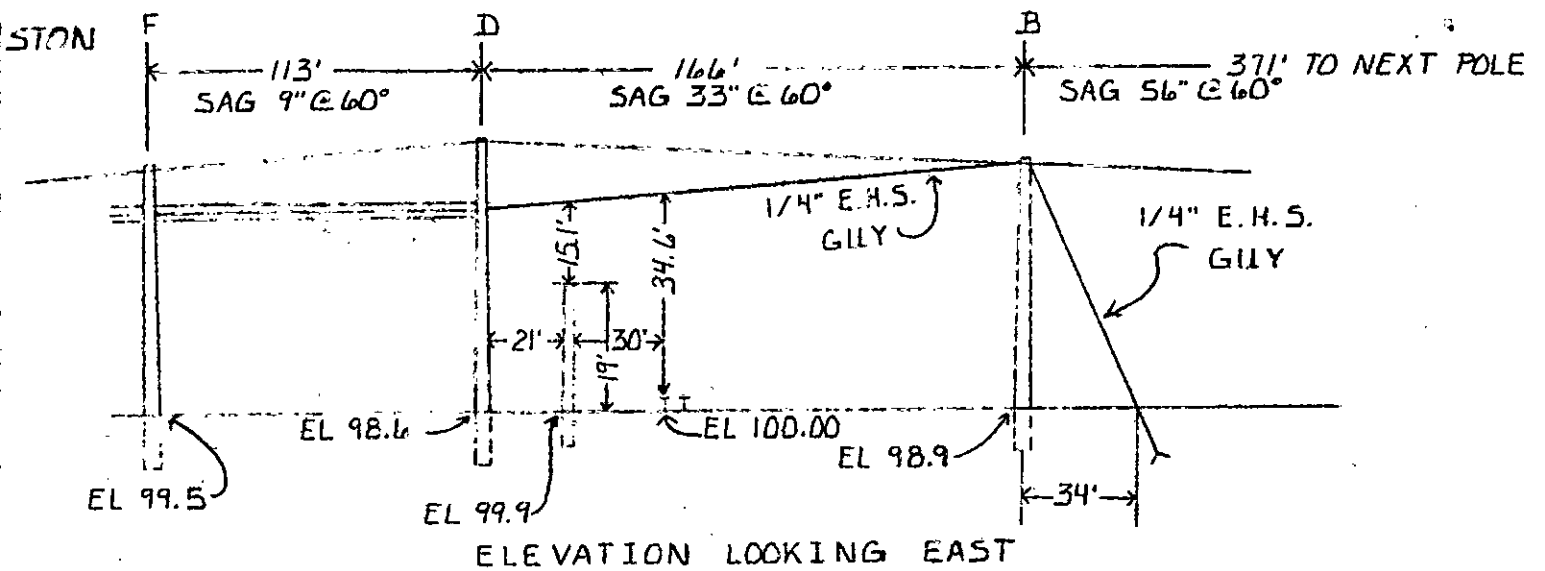
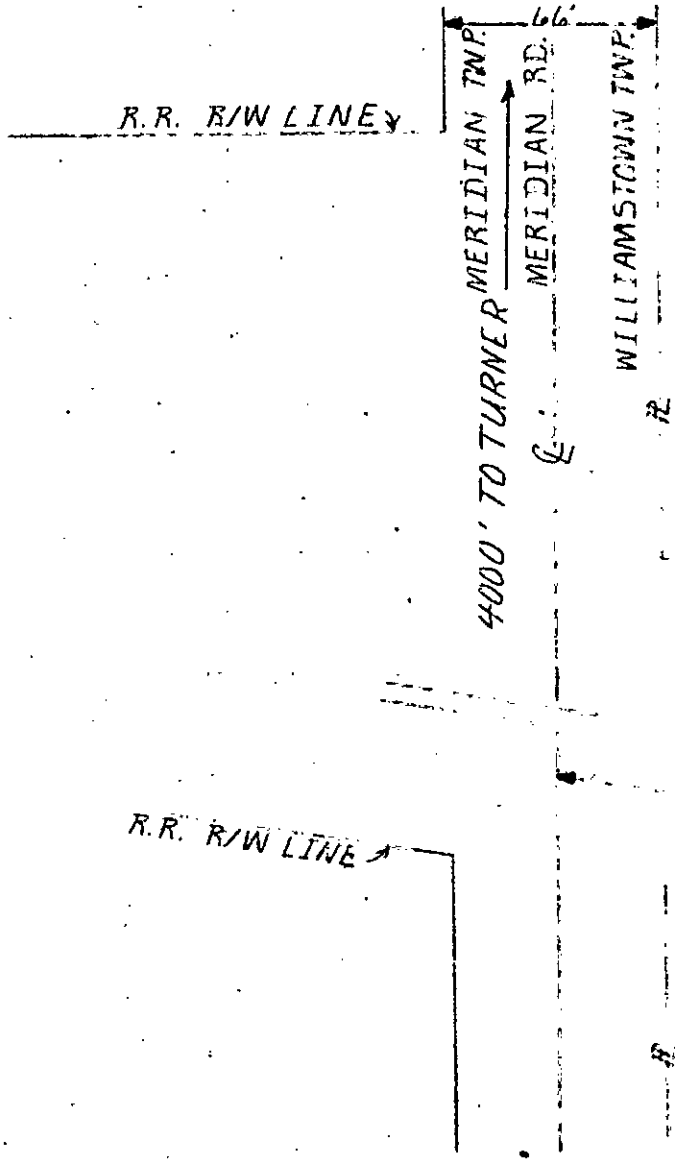

RECORDED RIGHT OF WAY NO. 32843

October 3, 1979

**Detroit Edison**

2000 Second Avenue  
Detroit, Michigan 48226  
(313) 237-8000

Mr. E. Q. Johnson, Chief Engineer  
The Chesapeake and Ohio Railway Company  
P. O. Box 1800  
Huntington, West Virginia 25718

**Proposed Overhead Wire Crossing:**

SPAN B - D

Two - 1/0 ACSR 13,200 Volts  
One - 1/4 EHS Guy 0 Volts

3860+40

Location: \_\_\_\_\_  
Sub-Division: Plymouth  
Division: Michigan  
P.S.C. Hearing ~~Waived~~ October 11, 1979  
The Chesapeake and Ohio Railway Company

\_\_\_\_\_  
Chief Engineer-System

Your File \_\_\_\_\_  
O. File 131-4-3375

**Specific Location**

In private property, 204 ft. east of Meridian & 4,000 ft. south of Turner Rd., approx. 3 miles west of Williamston, SW $\frac{1}{4}$  of Section 32, Williamston Township, T4N, R1E, Ingham County, Michigan.

R. R. Valuation Station \_\_\_\_\_ R. R. Mile Post D-77

City/Village Williamston Township Williamston

County Ingham Detroit Edison Plan Attached RX 3235B

This is a New Crossing \_\_\_\_\_ This is a Reconstruction of Existing Crossing XX

Previous Agreement Information (if any) Date 11/9/66 (R. R. Plan) 131-4-8555  
#9158

Blanket Waiver of Hearing Covers \_\_\_\_\_ Waiver of Hearing Requested In Duplicate  
(Waiver of Hearing to be mailed to applicant listed below)

All construction will be done in accordance with the rules and regulations of the Michigan Public Service Commission.

Leslie G. Sundstrom  
Leslie G. Sundstrom  
Office Supervisor  
Real Estate & Rights of  
Way Department

RECORDED RIGHT OF WAY NO. 32843



Engineering Department

November 8, 1979

File: 131-2-3375



Operating Headquarters Building  
P. O. Box 1800  
Huntington, W. Va. 25718

The Detroit Edison Company  
2000 Second Avenue  
Detroit, Michigan 48226

Attention: Ms. V. L. Sinnott  
Railroad Coordinator  
Real Estate & R/W Dept.

Gentlemen:

This refers to your letter of October 25, 1979, returning proposed agreement dated October 16, 1979, covering two (2) #OACSR-13.2 KV cond. and one (1) 1/4-inch EHS overhead guy crossing our tracks and right of way at Station 3860 plus 40, on our Plymouth Subdivision, Michigan Division, near Williamston, Ingham County, Michigan.

Enclosed is one fully executed copy of the above agreement for your records.

Yours very truly,

THE CHESAPEAKE AND OHIO RAILWAY COMPANY

A handwritten signature in black ink, appearing to read "EQ Johnson".

E. Q. Johnson  
Chief Engineer

RECORDED RIGHT OF WAY NO. 338413



**Detroit  
Edison**

2000 Second Avenue  
Detroit, Michigan 48226  
(313) 237-8000

October 25, 1979

Mr. E. Q. Johnson, Chief Engineer  
The Chesapeake and Ohio Railway Co.  
P. O. Box 1800  
Huntington, West Virginia 25718

We are returning agreement/permit, in duplicate, covering our facilities  
over your tracks and/or right of way as shown on our Plan RX 3235B  
and located as follows:

In private property, 204 ft. east of Meridian & 4,000 ft.  
south of Turner Rd., approx. 3 miles west of Williamston,  
SW $\frac{1}{4}$  of Section 32, Williamston Township, T4N, R1E, Ingham  
County, Michigan.

City/Village Williamston Township, Williamston  
County Ingham. The agreement/permit has been signed for  
our Company.

Will you please return one fully executed copy of this agreement/per-  
mit to us for our records.

Yours very truly,



Virginia L. Sinnott  
Railroad Coordinator  
Real Estate & Rights  
of Way Department

406.G.C.

RIGHT OF WAY NO. 32843

Submit One (1) Copy for each Span to  
Real Estate and Rights of Way Dept.

D.O. No. B-47515

Date 9-21-79

THE DETROIT EDISON COMPANY

RAILROAD CROSSING DATA SHEET

RX 3235B

Span B-D

Revision of RX 3235A

M.P.S.C. Permit and Date ED 2-8-5917

Railroad: CHESAPEAKE & OHIO

Facilities: 2 - 1/0 ALER 13,200 VOLTS  
1 - 1/4 EHS GUY 0 VOLTS

RECORDED RIGHT OF WAY NO. 32845

Location: IN PPTY 204' E OF MERIDIAN & 400' S OF TURNER RD.,  
APPROX. 3 MI. W. WILLIAMSTON, SW 1/4 OF SECTION 32, TOWNSHIP  
OF WILLIAMSTON, TYN, RIE, COUNTY OF INGHAM.

System Engineering Dept.

Date 9-28-79

By F.M. Hoffman

# The Chesapeake and Ohio Railway Company

AGREEMENT NO. 18399

## WIRE AND/OR CABLE LINE CROSSINGS

THIS AGREEMENT, made as of this 16th day of October, 1979, between THE CHESAPEAKE AND OHIO RAILWAY COMPANY, a Virginia Corporation, hereinafter called "Railway", and THE DETROIT EDISON COMPANY, 2000 Second Avenue, Detroit, Mich. 48226

hereinafter called "Licensee" (all words herein referring to Licensee to be taken of such number and gender as the context may require):

WITNESSETH THAT:

WHEREAS, Licensee desires to construct, operate and maintain a wire and/or cable line over

and across the right of way, tracks and wires of Railway, consisting of two (2) #0 ACSR-13.2 KV Cond.,  
and one (1) 1/4-inch EHS overhead guy

at a point located at Station 3860 plus 40

Mile Post \_\_\_\_\_ Feet, Plymouth

Subdivision, Michigan Division, at/near Williamston

County of Ingham, State of Michigan

said crossing, together with the necessary poles, towers, conduits, fixtures, and appurtenances thereto, being in accordance with attached Licensee's Drawing No. RX-3235B, dated September 21, 1979

marked for identification "Exhibit A"

\_\_\_\_\_ which are made a part of this agreement and said Exhibit "A" and its standards of construction on file with and approved by The

Michigan Public Service Commission which are incorporated herein and made a part hereof by reference; said crossing and the aforesaid facilities and appurtenances thereto being hereinafter referred to collectively as "Crossing"; and

WHEREAS, Railway is willing for said Crossing so to be constructed, operated and maintained, upon the following terms, covenants, conditions and limitations;

NOW, THEREFORE, in consideration of the premises and the observance by Licensee of the terms, covenants, conditions and limitations hereinafter set forth, it is agreed by and between the parties hereto as follows:

1. Railway hereby licenses and permits Licensee, at its sole risk, cost and expense, to construct, operate, maintain and renew said Crossing across the right of way, tracks, wires and any other facilities of Railway

\_\_\_\_\_ and of any other person, firm, corporation or association which now or may hereafter have any such facilities on Railway's right of way at or in the vicinity

RECORDED RIGHT OF WAY NO. 32843

of said Crossing, all such facilities (other than said Crossing) as set forth and contemplated in this Section 1, being hereinafter referred to collectively as "OTHER FACILITIES".

2. Before constructing said Crossing, Licensee shall, at its sole cost and expense, obtain all necessary authority therefor from any public authority or authorities having jurisdiction in the premises, and shall thereafter observe and comply with the requirements of such public authority or authorities and all applicable laws and regulations.

3. Licensee shall construct, operate, maintain and renew said Crossing in accordance with ~~said~~

Exhibit "A" and its standards of construction on file with and approved by The Michigan

Public Service Commission

and in such manner as not to interfere in any way with the facilities, business or operations of Railway, or of any OTHER FACILITIES, and use material and workmanship satisfactory to the Chief Engineer—System, or other authorized officer of Railway.

4. In the event the construction, operation or maintenance of said Crossing shall, in the judgment of Railway, necessitate any changes or alterations in any OTHER FACILITIES, then Railway may make or cause to be made all such changes and alterations at the sole risk, cost and expense of Licensee, and Licensee shall reimburse Railway therefor promptly upon receipt of Railway's bill for such work.

5. If, in the judgment of Railway, the operation, existence or maintenance of said Crossing shall at any time cause interference, including but not limited to physical interference, interference from electromagnetic induction, from electrostatic induction, or from stray or other currents, with OTHER FACILITIES, or shall, in any manner, interfere with the operation, maintenance or use by Railway of its right of way, tracks, structures, pole lines, devices, other property or any appurtenances thereto, then and in any such event, Licensee, upon receipt of written notice from Railway of any such interference, shall promptly, at its own risk, cost and expense, make such changes in its Crossing as, in the judgment of Railway, may be required to eliminate all such interference.

6. In the event that Licensee shall at any time desire to make changes in the physical or operational characteristics of said Crossing, it shall first secure in writing the consent and approval of Railway, and Licensee agrees that such changes shall be made at its sole risk, cost and expense, and subject to all the terms, covenants, conditions and limitations of this agreement.

7. In the event Railway shall at any time deem it necessary or advisable to change the grade or location of its track or tracks, to construct any additional track or tracks, to make any other additions and betterments, or otherwise improve, change or relocate its structures, pole lines, devices or facilities at or in the vicinity of said Crossing, which rights Railway hereby expressly reserves unto itself, Licensee, within thirty (30) days after receiving written notice from Railway so to do, shall promptly, at its own risk, cost and expense, relocate, raise, alter or otherwise change its Crossing to a location and in a manner and in conformity with such applicable specifications, which, in the judgment of Railway, will enable Railway to make any of the aforesaid changes which it may deem necessary or desirable.

8. Licensee shall and will at all times hereafter release Railway from, and indemnify and save harmless Railway from and against any and all liability, claims, demands, loss, detriments, costs, damages, charges or expenses which Railway may incur, suffer, sustain, be put to, or be in any way subjected to, on account of injury to or death of any persons and loss or destruction of or damage to any property, including but not limited to, OTHER FACILITIES, caused by, resulting from, arising out of, or in any manner connected with the negligence of Licensee in the construction, installation, maintenance, existence, use, renewal or removal of said Crossing.

9. Licensee hereby assumes all risk of loss, destruction or damage of any nature to said Crossing howsoever caused, and Licensee hereby releases Railway from all liability on account thereof.

10. Licensee shall promptly pay and discharge all taxes, assessments and other governmental and/or municipal charges upon said Crossing and shall promptly comply with all governmental and/or municipal rules and regulations covering the operation of said Crossing.

11. Licensee shall pay to Railway upon the execution of this agreement a license fee of ONE HUNDRED DOLLARS (\$100.00) toward the cost of preparation of this agreement and supervision expense. Licensee shall also pay to Railway as a rental charge for the use of its premises the sum of SEVENTY-FIVE DOLLARS (\$75.00) per annum in advance for each and every year or fraction thereof during which this agreement shall remain in force and effect.

12. This agreement shall continue in force and effect until terminated by ninety (90) days' notice in writing from either party to the other of its intention to terminate the same, except that termination of this agreement shall not relieve or release Licensee from any liability or obligation which may have been incurred or assumed by Licensee hereunder prior to the termination hereof.

13. In the event this agreement shall be at any time terminated as herein provided, or Licensee, in the judgment of Railway, shall have abandoned said Crossing, said Licensee shall, at its sole risk, cost and expense, forthwith upon request of Railway so to do, remove said Crossing from and across the right of way and premises aforesaid, and in the event of the failure or refusal of Licensee, within thirty (30) days after receipt of such request, to remove said Crossing and restore and leave said right of way and premises in as good condition as before the installation of said Crossing, then and in that event Railway, without incurring any liability to Licensee, may, at its option, remove said Crossing. Licensee shall reimburse Railway for the entire cost and expense of such removal and restoration upon receipt of Railway's bill therefor.

14. The terms and provisions of this agreement shall inure to the benefit of and be binding upon the successors and assigns of Railway, \_\_\_\_\_ and any other person, firm, corporation or association now or hereafter having facilities on Railway's right of way at or in the vicinity of the Crossing, and the successors, heirs, personal representatives and assigns of Licensee. No assignment by Licensee of this agreement or of any rights hereunder shall be made without the prior written consent of Railway.

15. This agreement covers same privilege granted The Detroit Edison Company under agreement dated November 9, 1966, which is being cancelled as of the effective date hereof.

IN TESTIMONY WHEREOF, the parties hereto have caused these presents to be duly executed.

Approved as to form:

THE CHESAPEAKE AND OHIO RAILWAY COMPANY

By \_\_\_\_\_

*E. O. Johnson*  
Chief Engineer

THE DETROIT EDISON COMPANY

Licensee

By \_\_\_\_\_

*R. R. Jewksbury*  
R.R. Jewksbury, Director Real Estate and Rights of Way Dept.

131-2-3375 BI/91

32843

PROPOSED LINE CROSSING OVER CHEAS. EAKE OHIO R.R.  
IN PRI PRO 204'E MERIDIAN RD. 4000' S. TURNER RD.  
CITY OF APPROX. 3 MILES W. OF WILLIAMSTON

SECTION 32 S.W. 1/4 TOWNSHIP WILLIAMSTON T 4N R 1E COUNTY INGHAM

**NOTES**  
MATERIALS SHALL BE AS NOTED IN THE CURRENT REVISION OF DETROIT EDISON COMPANY'S GENERAL SPECIFICATIONS FOR OVERHEAD LINE CONSTRUCTION AT RAILROAD CROSSINGS.  
ACTUAL FIELD DIMENSIONS MAY VARY SOMEWHAT FROM THOSE SHOWN, BUT THE REQUIREMENTS OF THE CURRENT REVISIONS OF ORDER NO'S. 1679 AND 1888 OF MICHIGAN PUBLIC SERVICE COMMISSION WILL BE COMPLIED WITH.

**MINIMUM CLEARANCES**

NEAREST POLE TO RAIL	SIDING	7 FT
	MAIN LINE	12 FT
WIRES OVER TRACKS	0 - 750 VOLTS	27 FT
	750 - 15,000 VOLTS	28 FT
	15,000 - 50,000 VOLTS	30 FT
	50,000 - 120,000 VOLTS	33 FT
WIRES OVER R R SIGNAL	0 - 750 VOLTS	2 FT
	750 - 8,700 VOLTS	4 FT
	8,700 - 50,000 VOLTS	6 FT
	50,000 - 120,000 VOLTS	9 FT

CONDUCTORS				POLES			
NUMBER	SIZE	KIND	VOLTAGE	LOCATION	LENGTH	CLASS	SET
2	0	ACSR	13,200	B	45	3	
1	1/4"	E.H.S.	-0-	C & E	35	5	
				D	50	4	
				F	45	3	

DESIGNED BY M. J. MARVIN DIVISION ANN ARBOR  
SYSTEM ENGINEERING  
CHECKED BY E.M. HOFFMAN DEPT. DATE 9-21-79

SPAN	SPAN LENGTH	LOWEST CONDUCTOR OVER R. R. TRACKS	STRINGING SAG AT 60° F	HEIGHT OF LOWEST CONDUCTOR OVER	
				R. R. TRACKS	R. R. SIGNAL WIRE
B - D	166'	1/4" E.H.S. - GUY	NO SAG	34.6'	15.1'

SAG TABLE NO SAG - GUY  
RULING SPAN \_\_\_\_\_  
FINAL SAG RATIO \_\_\_\_\_

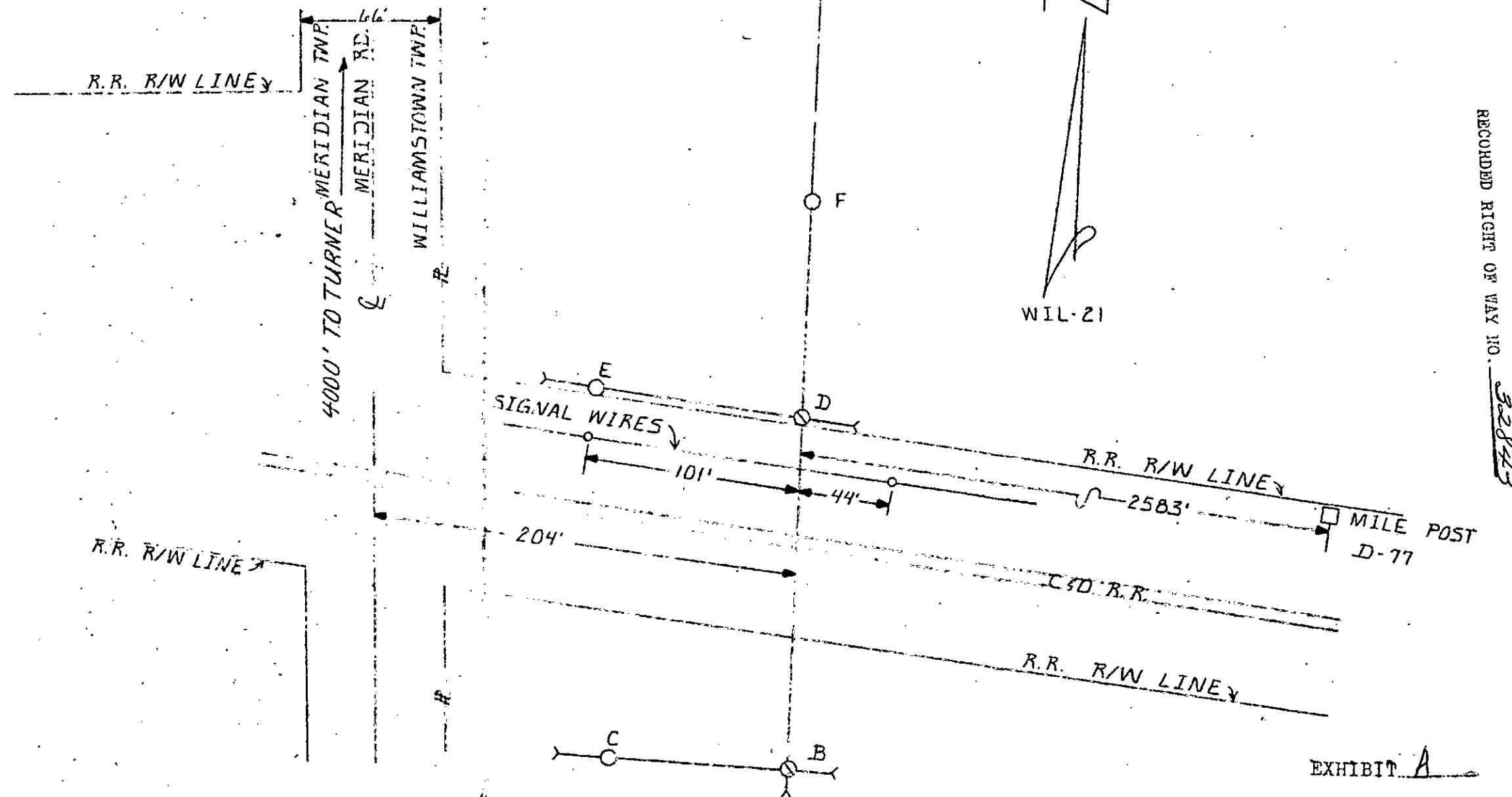
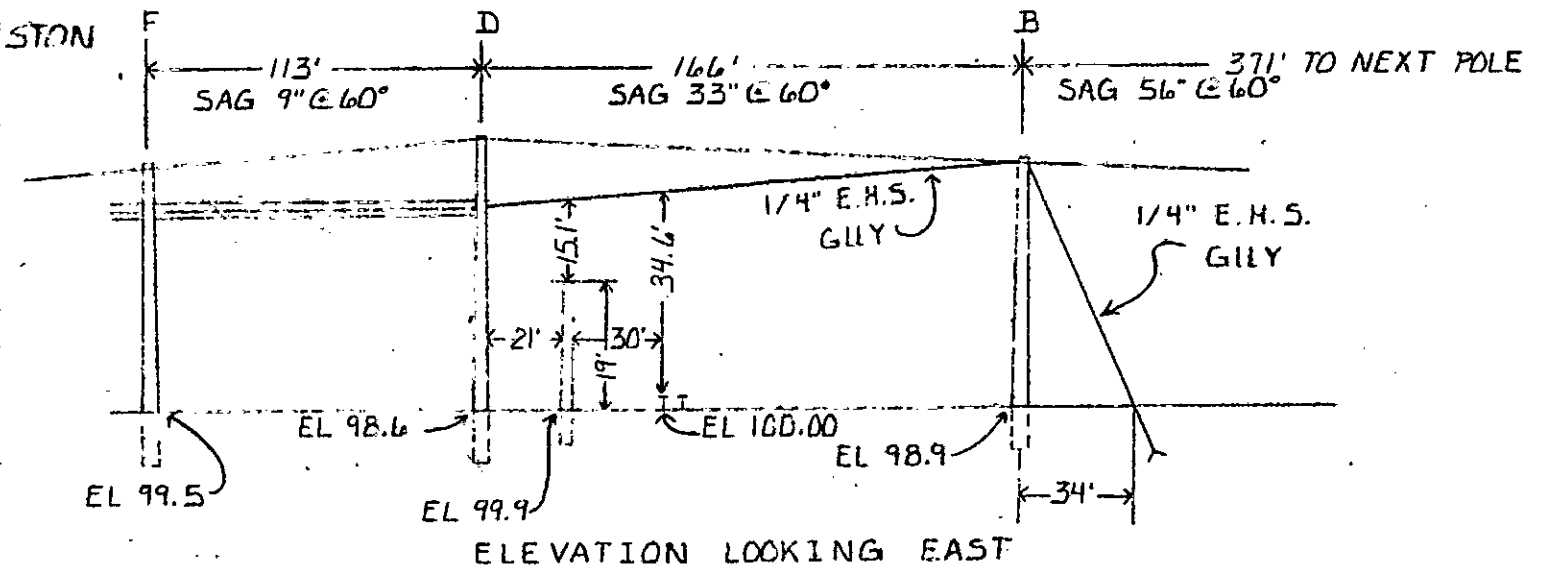

RECORDED RIGHT OF WAY NO. 32843

Overhead Lines Department  
Ann Arbor  
February 13, 1967

MICHIGAN PUBLIC SERVICE COMM.	
PUBLIC UTILITIES DIVISION	
Tel. _____	Gas _____
Elec. _____	R & S _____
FEB 20 1967	
Adm. _____	_____
File _____	_____

Permit No. ED2-8-5917

Michigan Public Service Commission  
Lansing 13, Michigan

Gentlemen:

I, Robert Laubengayer, Line Design Supervisor  
of The Detroit Edison Company, Detroit, Michigan, hereby certify that the  
wire crossing, covered by Wire Crossing Permit No. ED2-8-5917,  
issued 11-17-66, has been constructed in accordance with  
specifications of the Michigan Public Service Commission and construction  
standards of The Detroit Edison Company, approved by Michigan Public Service  
Commission on July 19, 1939, file ED 2-9.01, and that this crossing will be  
maintained as provided in such specifications and construction standards.

Yours very truly,

*R. H. Laubengayer*

RX No. 3235A  
Location City of Williamstown  
Ingham County  
Railroad Chesapeake and Ohio  
File: 131-4-8555

Subscribed and sworn to before me this  
13 day of February, 19 67.  
*Lyman G. Hedden*  
Lyman G. Hedden  
Notary Public, Oakland  
County, Michigan.  
My Commission expires 8-19-70

RECORDED RIGHT OF WAY NO. 32843



THE CHESAPEAKE AND OHIO RAILWAY COMPANY  
THE BALTIMORE AND OHIO RAILROAD COMPANY

ENGINEERING DEPARTMENT  
CHESAPEAKE AND OHIO BUILDING  
HUNTINGTON, W. VA.

R. C. TENCH  
CHIEF ENGINEER—SYSTEM

February 16, 1967 ID/44  
File: 131-4-8555

I. W. GAMBLE  
*IG*  
FEB 20 1967  
*WJ*  
PROP. & R/W DEPT.

Mr. I. W. Gamble, Supervisor  
The Detroit Edison Company  
2000 Second Avenue  
Detroit, Michigan 48226

Dear Mr. Gamble:

This refers to your letter of January 30, 1967, Plan RX-3235A, returning proposed agreement dated November 9, 1967, covering an aerial power line crossing our tracks and right of way at Station 3860 plus 40 on our Detroit Subdivision, Grand Rapids Division, near Williamston, Ingham County, Michigan.

Enclosed is one fully executed copy of the above agreement for your records.

Yours very truly,

*R. C. Tench*  
R. C. Tench,  
Chief Engineer-System

RECORDED RIGHT OF WAY NO. 32813

# THE DETROIT EDISON COMPANY

2000 SECOND AVENUE  
DETROIT 26, MICHIGAN

January 30, 1967

Railroad File No. 131-4-8555

Mr. R. C. Tench, Chief Engineer - System  
Engineering Department  
The Chesapeake and Ohio Railway Company  
C & O Building, 405 Eleventh Avenue  
P.O. Box 1800  
Huntington, West Virginia 25712

Dear Mr. Tench:

We are returning agreement/~~permit~~, in duplicate, covering our facilities over your tracks and/or right of way as shown on our Plan RX-3235A (Span B-D), and located as follows:

On railroad property at a point 204' E. of the c/l of Meridian Rd. approx. 4000' S. of Turner Rd. and 2583' W. of Mile Post D-77 and approx. 3 miles W. of the City of Williamstown.

City/Village \_\_\_\_\_ Township, Williamstown, SW 1/4 Sec. 32  
County Ingham. The agreement/~~permit~~ has been signed for our Company.

Will you please return one fully executed copy of this agreement/~~permit~~ to us for our records.

Yours very truly,



I. W. Gamble  
Supervisor of Rights of Way  
Properties and Rights of Way Dept.

JVS/jft  
Enclosures

RECORDED RIGHT OF WAY NO. 32845

THE CHESAPEAKE AND OHIO RAILWAY COMPANY  
THE BALTIMORE AND OHIO RAILROAD COMPANY

ENGINEERING DEPARTMENT  
CHESAPEAKE AND OHIO BUILDING  
HUNTINGTON, W. VA.

R. C. TENCH  
CHIEF ENGINEER—SYSTEM

January 18, 1967 IE/44  
File: 131-4-8555

I. W. GAMBLE

*IW*  
JAN 23 1967

PROP. & R/W DEPT.

Mr. I. W. Gamble  
Supervisor of Right of Way  
Properties and Right of Way Department  
The Detroit Edison Company  
2000 Second Avenue  
Detroit, Michigan 48226

Dear Mr. Gamble:

This refers to your letter of September 30, 1966, File Plan RX-3235-A, covering a proposed aerial wire line crossing our tracks and Right of Way at Station 3860 plus 40 on our Detroit Subdivision, Grand Rapids Division.

Enclosed is proposed agreement with the request that you kindly have executed on behalf of the Power Company.

Yours very truly,

*R. C. Tench*  
R. C. Tench  
Chief Engineer-System

RECORDED RIGHT OF WAY NO. 32873

# THE DETROIT EDISON COMPANY

2000 SECOND AVENUE  
DETROIT 26, MICHIGAN

November 15, 1966

MICHIGAN PUBLIC SERVICE COMM.  
PUBLIC UTILITIES DIVISION  
Tel. \_\_\_\_\_ Gas \_\_\_\_\_  
Elec. \_\_\_\_\_ R & S \_\_\_\_\_  
NOV 16 1966  
Adm. \_\_\_\_\_  
File \_\_\_\_\_

Michigan Public Service Commission  
Lansing 13, Michigan

Gentlemen:

The Detroit Edison Company, Detroit, Michigan, hereby makes application for authority to string the following wires over the tracks of the Chesapeake and Ohio Railroad approximately 3 miles west of the City of Williamstown in the S.W. 1/4 Section 32, Williamstown Township, T-4W, R-1E, Ingham County, Michigan.

Span B - D

Two #0 ACSR - 13,200 volt wires and three #0 AAX - 120/240 volt wires over the tracks of the C. & O. Railroad located on railroad property at a point 204' east of the centerline of Meridian Road approximately 4000' south of Turner Road and 2583' west of Mile post D-77.

Note: New permit requested to convert existing two #0 ACSR-4800V wires to 13,200 volts.

The proposed wire crossing will be constructed in accordance with specifications of the Michigan Public Service Commission and the construction standards of The Detroit Edison Company, approved by the Michigan Public Service Commission on July 19, 1939, File ED 2-9.01.

- Enclosed is a waiver of hearing granted by the Railroad Company.
- Waiver of hearing by the Railroad Company is covered by blanket waiver.
- This application covers reconstruction of existing crossing and will cancel and supersede wire crossing permit No. ED 2-8-4076 dated 10-9-56
- This is a new crossing.

Reference number of construction drawing is RX-3235A

Waiver dated 11-9-66 attached.  
Railroad File: 131-4-8555

Yours very truly,

Permit No. ED2-8-5917  
Date 11-17-66  
By J. M. Doppe

*I. W. Gamble*  
I. W. Gamble  
Supervisor of Rights of Way  
Properties and Rights of Way Dept.

Check in circle indicates statement applicable.

RECORDED RIGHTS OF WAY NO. 3-28-66

THE CHESAPEAKE AND OHIO RAILWAY COMPANY  
THE BALTIMORE AND OHIO RAILROAD COMPANY

ENGINEERING DEPARTMENT  
CHESAPEAKE AND OHIO BUILDING  
HUNTINGTON, W. VA.

R. C. TENCH  
CHIEF ENGINEER—SYSTEM

November 9, 1966 JF/42

File: 131-4-8555

I. W. GAMBLE

*I. W. Gamble*  
NOV 14 1966

The Detroit Edison Company  
2000 Second Avenue  
Detroit, Michigan 48226

PROP. & R/W DEPT.

Attention: Mr. I. W. Gamble  
Supervisor of Right of Way

Gentlemen:

Reference is made to your letter dated September 30, 1966, Plan RX-3235-A, requesting a waiver of hearing before the Michigan Public Service Commission to permit reconstruction of an aerial power line crossing over our tracks and right of way at Station 3860 plus 40 of the Detroit Subdivision, at a point 204 feet East of the center line of Meridian Road, approximately 4000 feet south of Turner Road and 2583 feet West of Mile Post D-77 in Section 32 SW 1/4, Town 4-N, Range 1-E, approximately 3 miles west of Williamstown Township, Ingham County, Michigan.

The crossing will consist of two (2) #0 ACSR 13,200 volt wires and three (3) #0 AAX 120/240 volt wires span B-D, 28.9 feet above top of rails.

The Chesapeake and Ohio Railway Company hereby waives hearing before the Michigan Public Service Commission for permission to construct the above wire line crossing, with the provision that construction shall conform to the specifications of the Michigan Public Service Commission for such wire line crossings.

Very truly yours,

R. C. Tench  
Chief Engineer-System

RECORDED  
11  
OF  
MAY 110.

*32843*

# THE DETROIT EDISON COMPANY

2000 SECOND AVENUE

DETROIT, MICHIGAN 48226

TO:

September 30, 1966

Mr. R. C. Tench, Chief Engineer  
The Chesapeake and Ohio Railway Company  
Signals and Communications Department  
C & O Building, 405 Eleventh Avenue  
Huntington, West Virginia 25701

Proposed Overhead Wire Crossing: Two #0 ACSR - 13,200 volt wires and three #0 AAX - 120/240 volt wires. Span B-D

NOTE: New permit requested to convert existing two #0 ACSR 4800 V wires to 13,200 volts.

Specific Location On railroad property at a point 204 feet East of the center line of Meridian Road approximately 4000 feet South of Turner Road and 2583 feet West of Mile Post D-77 and approximately 3 miles West of the City of Williamstown.

R. R. Valuation Station \_\_\_\_\_ R. R. Mile Post \_\_\_\_\_

City/Village \_\_\_\_\_ Township Williamstown, SW 1/4 Section 32

County Ingham Detroit Edison Plan Attached BX-3235A

This is a New Crossing \_\_\_\_\_ This is a Reconstruction of Existing Crossing X

Previous Agreement Information (if any) Date 9-24-56 (R. R. Plan) \_\_\_\_\_

Blanket Waiver of Hearing Covers \_\_\_\_\_ Waiver of Hearing Requested In Duplicate  
(Waiver of Hearing to be mailed to applicant listed below)

All construction will be done in accordance with the rules and regulations of the Michigan Public Service Commission.

*I. W. Gamble*  
I. W. Gamble, Supervisor of Rights of Way  
Properties and Rights of Way Department

RECORDED INDEXED BY WAX NO. 32843

THE DETROIT EDISON COMPANY  
 PROPOSED LINE CROSSING OVER CH. SAREAKE & OHIO F.R. E. RING PERMIT NUMBER ED-8-4076  
 IN DEL. PLO. 204 E. OF MERIDIAN RD. APPROX. 3 MILES WEST OF THE CITY OF WILLIAMSTON  
 SECTION 32 S.W. 7E TOWNSHIP WILLIAMSTON T. 4 N. R. 1 E. COUNTY INGHAM

NOTES		CONDUCTORS				POLES			
MATERIALS SHALL BE AS NOTED IN THE DETROIT EDISON COMPANY'S STANDARD SPECIFICATIONS FOR OVERHEAD LINE CONSTRUCTION AT RAILROAD CROSSINGS DATED MARCH 1947.		NUMBER	SIZE	KIND	VOLTAGE	LOCATION	LENGTH	CLASS	TYPE
ACTUAL FIELD DIMENSIONS MAY VARY SOMEWHAT FROM THOSE SHOWN BUT THE REQUIREMENTS OF ORDER NO. 1879 OF MICHIGAN PUBLIC SERVICE COMMISSION, AS REVISED JAN. 1, 1944, WILL BE COMPLIED WITH.		2	0	ACSR	13,200	A	40	5	PILE
MINIMUM CLEARANCES		3	0	AAX	120/240	B	45	3	"
NEAREST POLE TO RAIL	BIDING MAIN LINE					C&E	35	5	"
						D	50	4	"
						F	45	3	"
WIRES OVER TRACKS	0 - 800 VOLTS								
	800 - 7500 VOLTS								
	24000 VOLTS								
WIRES OVER R. R. SIGNAL	0 - 800 VOLTS								
	800 - 7500 VOLTS								
	24000 VOLTS								

DRAWN BY J.W. HANE PEKA-HGG ENGINEERING DIVISION DATE 6/11/56  
 ESTIMATOR J. SWICK OVERHEAD LINES DEPT. HOWELL

NOTE:  
 EXISTING 2#0 ACSR 4800V.  
 WIRES TO BE CONVERTED  
 TO 13,200 V.

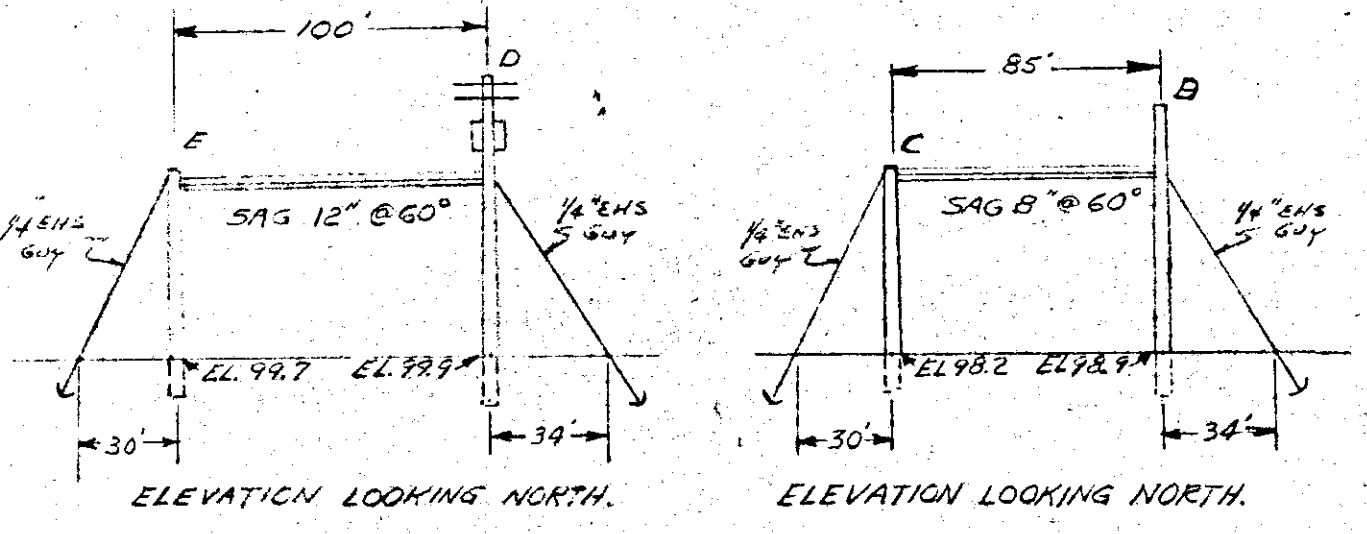
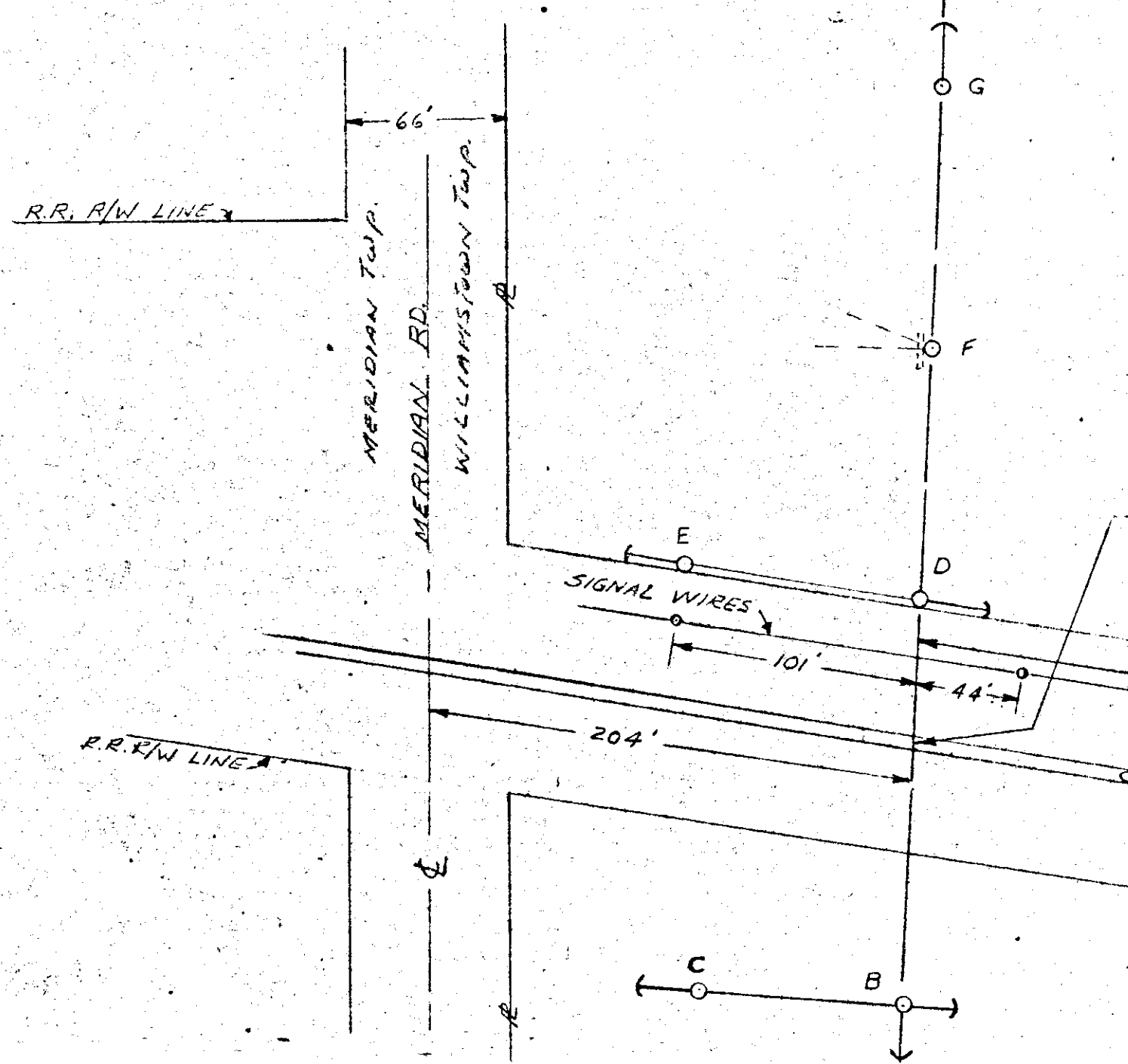
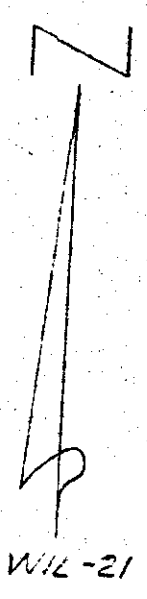

EXISTING CROSSING OF 2#0 ACSR-13,200 V. WIRES  
 AND 3#0 AAX-120/240 V. WIRES

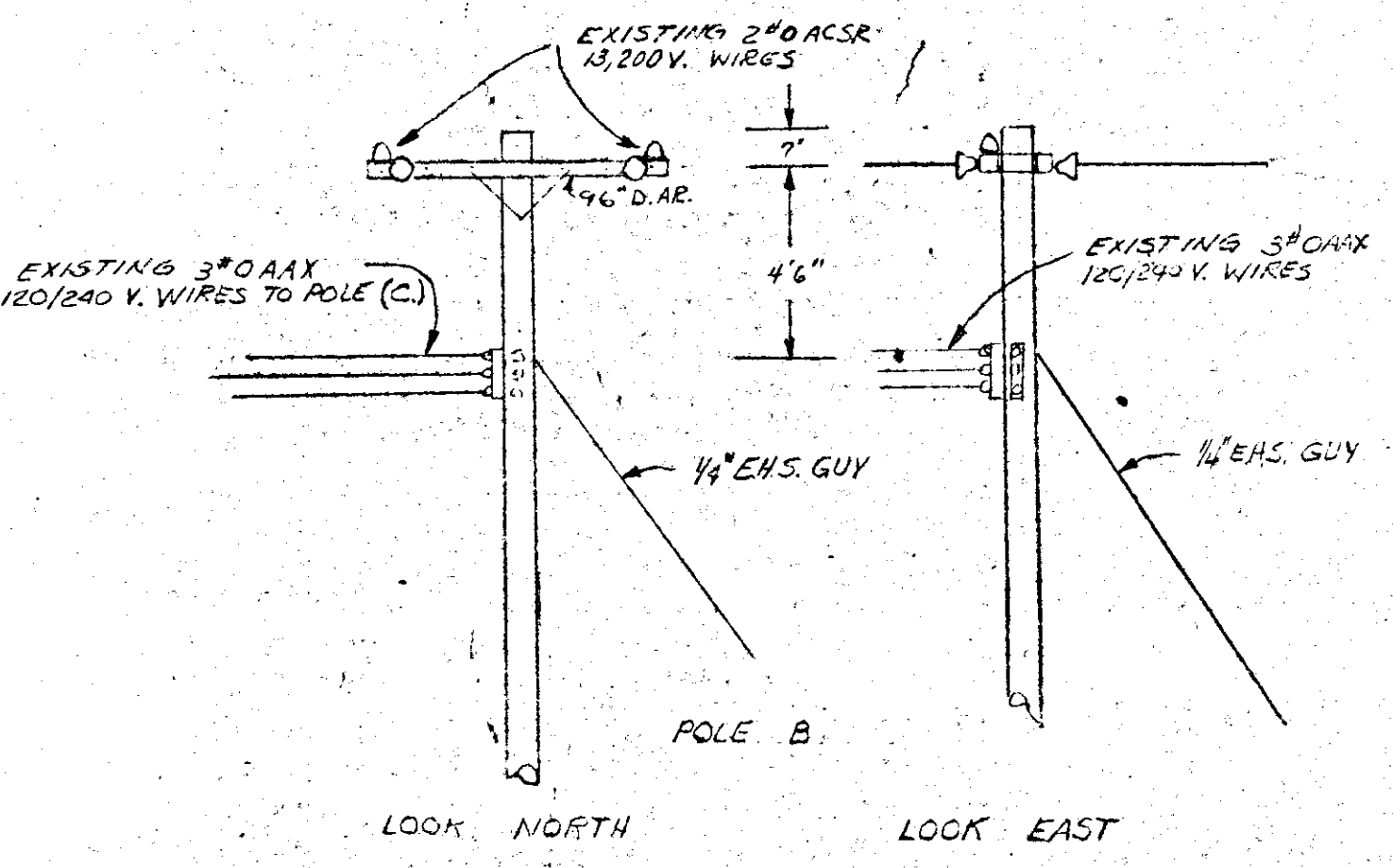
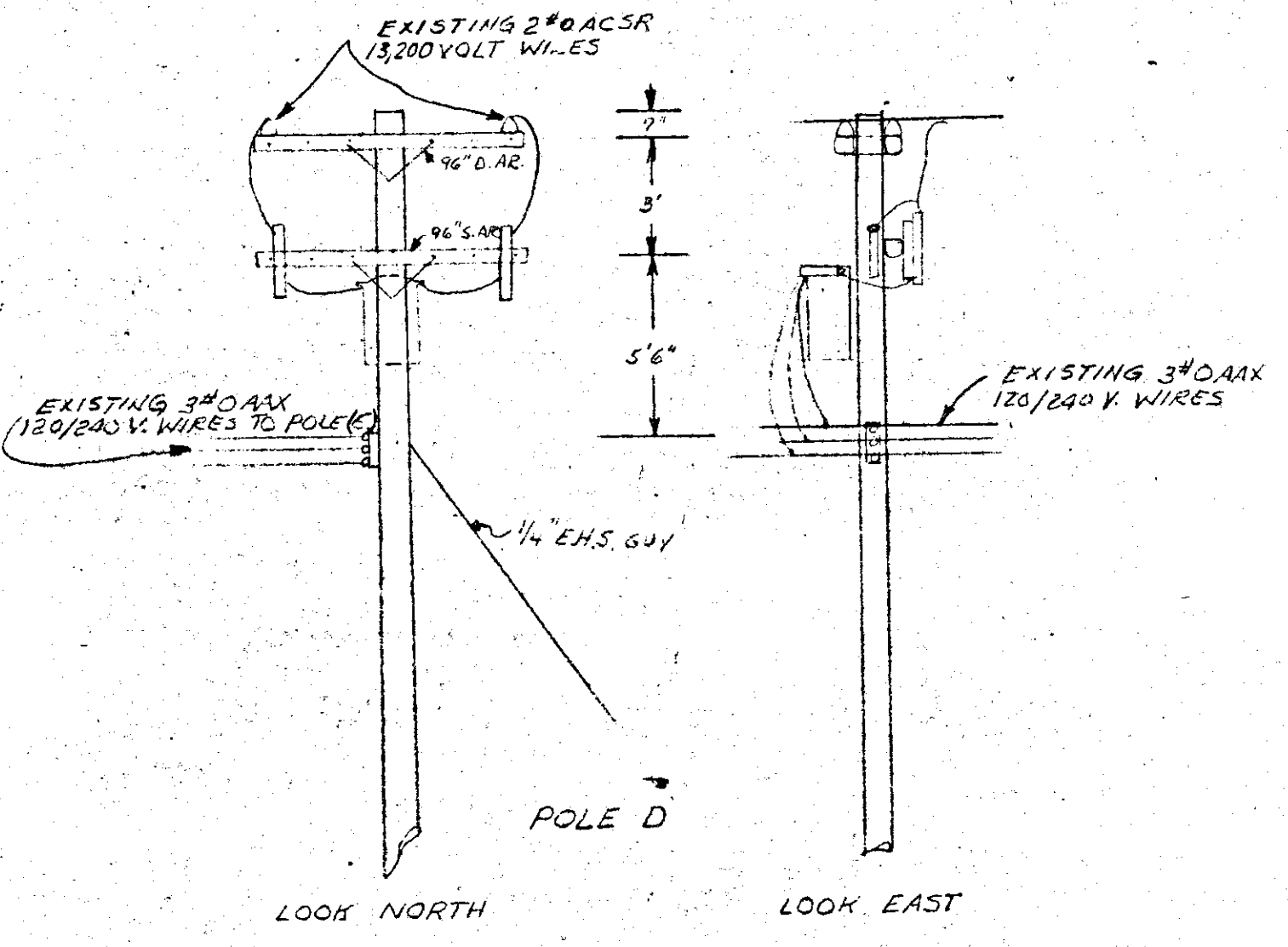
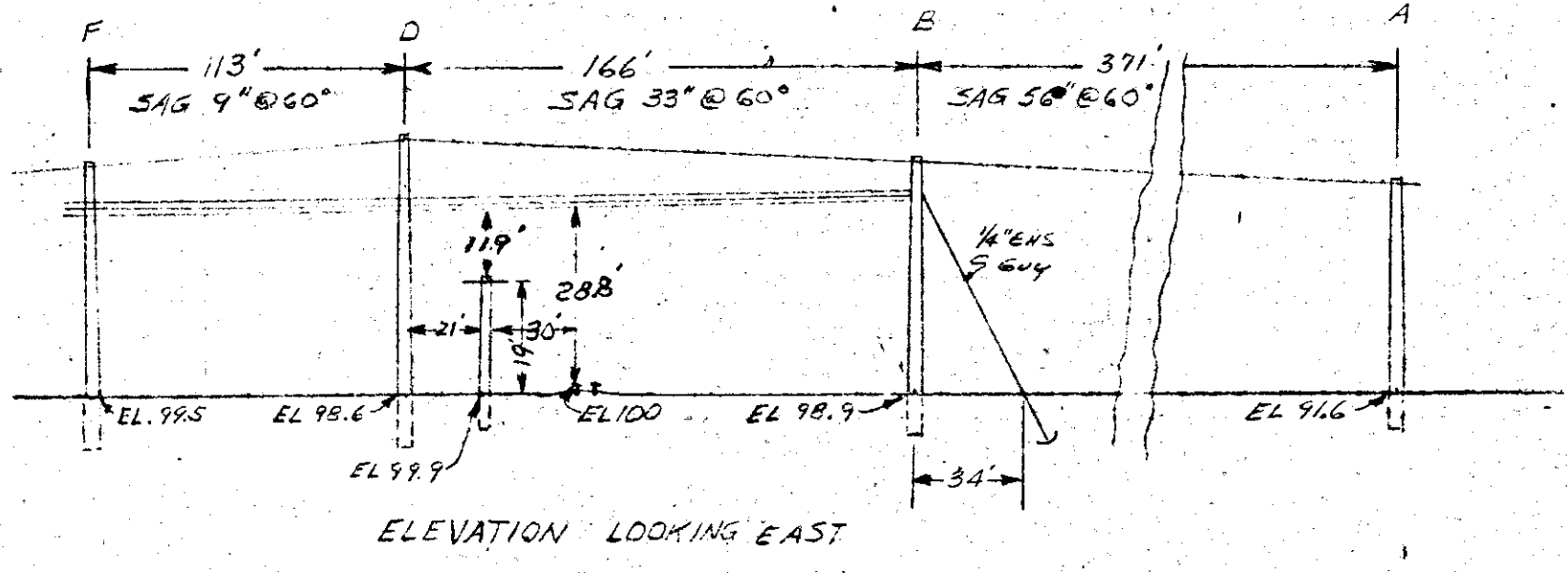

32843  
 RECORDED RIGHT OF WAY NO. 32843

32843 RECORDED INDEX OF WAY NO.