

RE-RECORD

L120455 PA 466

EASEMENT FOR ELECTRIC AND GAS LINES

For valuable consideration, the receipt of which is hereby acknowledged, the undersigned hereby grant and convey to CONSUMERS POWER COMPANY, a Michigan Corporation, 212 Michigan Avenue, Jackson, Michigan, THE DETROIT EDISON COMPANY, a corporation organized and existing concurrently under the laws of the states of Michigan and New York, 2000 Second Avenue, Detroit, Michigan, hereinafter called "UTILITIES", the EASEMENT and right to erect, lay, maintain, reconstruct and replace underground facilities consisting of wires, cables, conduits, gas mains, fixtures and appurtenances including the necessary above ground equipment, connections, poles and accessories which may from time to time be required in, under, upon, over, and across the land located in The City of Plymouth, Wayne County, Michigan, and more particularly described as follows:

L120679 PA 367

A parcel of land being a part of the S.W. 1/4 of Section 25, T. 1 S., R. 8 E., City of Plymouth, Wayne County, Michigan more particularly described as:

Commencing at the West 1/4 corner of said Section 25, T. 1 S., R. 8 E., thence S. 88°21'00" East 80.00 feet to a point; thence S. 1°39'00" West, parallel to the West line of said Section 25, 724.86 feet to a point; thence S. 89°51'50" East 400.14 feet to a point, said point being the S.W. corner and the point of beginning of the parcel herein described; thence N. 1°39'00" East 235.92 feet to a point; thence S. 88°39'10" East 405.72 feet to a point; thence S. 1°20'50" West 227.31 feet to a point; thence N. 89°51'50" West 407.05 feet to a point of beginning, except the westerly 30 feet thereof, said westerly 30 feet being the easterly 1/2 of Industrial Road (60 ft. wide) the parcel as above described contains 1.9982 acres of land, except mineral rights lying within the Black River Strata and above Black River Strata as set in deed to Consumers Power Company recorded December 1, 1965 in Liber 15858, Page 34, Register No. F-53055, Wayne County Records. Subject to all easements of record.

G392865

With the full right to the Utilities of ingress and egress upon the said land for the purposes of this grant. And the further right to trim, cut down, or otherwise control brush and trees within the easements herein described.

SAID EASEMENTS shall be 6 feet in width unless otherwise indicated and their route is described as follows; (As shown on attached drawings).

G454632

It is agreed that the attached drawing No. 78A-34182 is preliminary and is part of the easement grant. Upon completion of a construction drawing, this preliminary drawing shall be replaced by said construction drawing and recorded to locate the easements granted in said easement grant.

RECORDED MAR 23 1979 AT 12:38 O'CLOCK P.M.  
FOREST E. YOUNGBLOOD, Register of Deeds  
WAYNE COUNTY, MICHIGAN 48226

RECORDED RIGHT OF WAY NO. 32300

In order to provide for the proper maintenance and protection of the Utilities facilities, the undersigned covenant and agree that:

1. The easements are graded to within 4 inches of final grade before the utilities lines are installed and this ground elevation will be maintained after installation of utilities to avoid the pooling of water in, on, or around above ground utilities equipment.
2. No buildings or structures other than Utilities equipment are to be placed within the easements herein granted.
3. No shrubs or foliage shall be planted or grown within (5) five feet of the front door of transformers or switching cabinet enclosures.

"THIS EASEMENT IS RE-RECORDED FOR PURPOSES OF SHOWING THE PLANNED "AS INSTALLED" CENTERLINES OF EASEMENTS GRANTED AS SHOWN ON DRAWING ATTACHED HERETO".

RECORDED OCT 17 1979 AT 11:30 O'CLOCK A.M.  
FOREST E. YOUNGBLOOD, Register of Deeds  
WAYNE COUNTY, MICHIGAN 48226

120455466

PLYMOUTH THE APARTMENTS 6335882

RECORD

EASEMENT FOR ELECTRIC AND GAS LINES

For valuable consideration, the receipt of which is hereby acknowledged, the undersigned hereby grant and convey to CONSUMERS POWER COMPANY, a Michigan Corporation, 212 Michigan Avenue, Jackson, Michigan, THE DETROIT EDISON COMPANY, a corporation organized and existing concurrently under the laws of the state of Michigan and New York, 3000 Second Avenue, Detroit, Michigan, hereinafter called "UTILITIES", the BASEMENT and right to erect, lay, maintain, reconstruct and replace underground facilities consisting of wires, cables, conduits, gas mains, fixtures and apparatuses including the necessary above ground equipment, connections, poles and accessories which may from time to time be required in, under, over, over and across the land located in the City of Plymouth, Wayne County, Michigan, and more particularly described as follows:

A parcel of land being a part of the S.W. 1/4 of Section 25, T. 8 S., R. 8 E., City of Plymouth, Wayne County, Michigan more particularly described as:

Commencing at the West 1/4 corner of said Section 25, T. 8 S., R. 8 E., thence S. 88°21'00" East 80.00 feet to a point; thence S. 1°39'00" West, parallel to the West line of said Section 25, 724.86 feet to a point; thence S. 89°51'50" East 400.14 feet to a point, said point being the S.W. corner and the point of beginning of the parcel herein described; thence N. 1°39'00" East 235.92 feet to a point; thence S. 88°39'10" East 405.72 feet to a point; thence S. 1°20'50" West 227.31 feet to a point; thence N. 89°51'50" West 407.05 feet to a point of beginning, except the westerly 30 feet thereof, said westerly 30 feet being the easterly 1/2 of Industrial Road (60 ft. wide) the parcel as above described contains 1.9982 acres of land, except mineral rights lying within the Black River Strata and above Black River Strata as set in deed to Consumers Power Company recorded December 1, 1965 in Index 15858, Page 34, Register No. T-25052, Wayne County Records, Subject to all easements of record.

With the full right to the Utilities of ingress and egress upon the said land for the purpose of this grant. And the further right to trim, cut down, or otherwise control brush and trees within the easements herein described.

SAID EASEMENTS shall be 6 feet in width unless otherwise indicated and their route is described as follows; (As shown on attached drawings).

It is agreed that the attached drawing No. 78A-34182 is preliminary and is part of the easement grant. Upon completion of a construction drawing, this preliminary drawing shall be replaced by said construction drawing and recorded to locate the easements granted in said easement grant.

RECORDED  
MAR 23 1978 AT 10:58  
FOREST E. YOUNGBLOOD, Register of Deeds  
WAYNE COUNTY, MICHIGAN 48226

In order to provide for the proper maintenance and protection of the Utilities facilities, the undersigned covenant and agree that:

1. The easements are graded to within 4 inches of final grade before the utilities lines are installed and this ground elevation will be maintained after installation of utilities to avoid the pooling of water in, on, or around above ground utilities equipment.
2. No buildings or structures other than Utilities equipment are to be placed within the easements herein granted.
3. No shrubs or foliage shall be planted or grown within (5) five feet of the front door of transformers or switching cabinet enclosures.

"THIS EASEMENT IS RE-RECORDED FOR PURPOSES OF SHOWING THE PLANNED "AS TO CENTRALINES OF EASEMENTS GRANTED BY TOWN ON DRAWING ATTACHED TO THIS RECORD."  
RETURN TO:  
Real Estate, R/W & Claims  
8750 Telegraph (Rm. 225)  
Taylor, MI 48184

RECORDED OCT 17 1978 AT 11:30  
FOREST E. YOUNGBLOOD, Register of Deeds  
WAYNE COUNTY, MICHIGAN 48226

6335882

RECORDED FROM 35330

RECORD

LI20679PA36

LI20455PA467

THIS GRANT is declared to be binding upon the heirs, successors, lessees, licensees and assigns of the parties hereto.

IN WITNESS WHEREOF, the undersigned have hereunto set our hands and seal this 15th day of Feb., 1979.

PLYMOUTH TOWNE APARTMENTS  
A Michigan Co-Partnership  
105 Haggerty Road  
Plymouth, Michigan, 48170

Witnesses:

Lynn S. Shipway  
Lynn S. Shipway  
Viola M. Sullivan  
Viola M. Sullivan

GRANTORS:

By: John F. Hendry  
John F. Hendry - PARTNER  
By: Charles F. Herbert  
Charles F. Herbert - PARTNER

STATE OF MICHIGAN )  
COUNTY OF Wayne ) ss.

On this 15th day of February, 1979 before me, a Notary Public in and for said County, personally appeared John C. Hendry and Charles F. Herbert, partners doing business as PLYMOUTH TOWNE APARTMENTS, a Michigan Co-partnership, to me known and who executed the within instrument and acknowledged the same to be their free act and deed for the Co-partnership.

My commission expires:

January 9, 1982

Viola M. Sullivan  
Viola M. Sullivan  
Notary Public, Wayne County,  
Michigan

Prepared by:

C. George Williams  
8750 Telegraph Road  
Taylor, Michigan, 48180

RETURN TO:  
Real Estate B/W & Claims  
8750 Telegraph Road (Rm 225)  
Taylor, MI 48180

RECORDED RIGHT OF WAY NO.

32300

REGISTRY OF DEEDS  
1015 BROADWAY  
ANN ARBOR MI 48106

FEB 15 1979

JOHN C. HENDRY  
CHARLES F. HERBERT

07800-1250-RT-118

1188

120455467

RE-RECORD

THIS GRANT is declared to be binding upon the heirs, successors, lessees, licensees and assigns of the parties hereto.

IN WITNESS WHEREOF, the undersigned have hereunto set our hands and seal this day of February, 1979.

PLYMOUTH TOWNE APARTMENTS  
A Michigan Co-Partnership  
105 Haggerty Road  
Plymouth, Michigan, 48170

RECEIVED  
WAYNE COUNTY MICH.

1979 OCT 17 AM 11 30

FOREST E. YOUNGBLOOD  
REGISTER OF DEEDS

GRANTORS:

Witnesses:

By: John G. Hendry  
By: Charles F. Herbert

Viola M. Sullivan  
John S. Shipway

STATE OF MICHIGAN  
COUNTY OF Wayne

On this 15th day of February, 1979 before me, a Notary Public in and for said County, personally appeared John G. Hendry and Charles F. Herbert partners doing business as PLYMOUTH TOWNE APARTMENTS, a Michigan Co-Partnership, to me known and who executed the within instrument and acknowledged the same to be their free act and deed for the Co-partnership.

RE-RECORD

Viola M. Sullivan  
Notary Public, Wayne County, Michigan

My commission expires: January 9, 1982

RE-RECORD

RECEIVED  
WAYNE COUNTY MICH.

1979 MAR 23 PM 12 38

FOREST E. YOUNGBLOOD  
REGISTER OF DEEDS

Handwritten signatures and initials.

317-79-0257-000870

RETURN TO:  
Real Estate, R/W & Claims  
6750 Telegraph (Rm. 225)  
Taylor, MI 48180

George Williams  
8750 Telegraph Road  
Taylor, Michigan, 48180

223-79-0734-000253  
B  
0309.00

West 1/4 Corner  
Section 25  
S 88° 21' 05" W  
800'

LI20679PA369

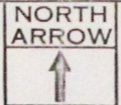

LI20679PA370

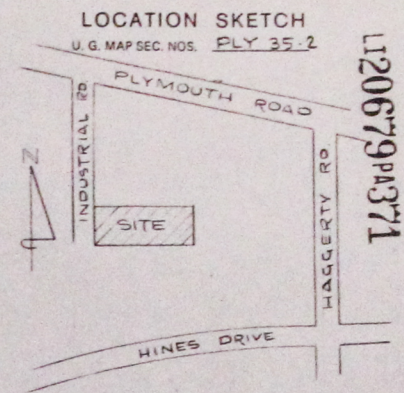

LI20679PA371

TRANSFORMER SPECS. 1-17 261 & R 351E  
PEDESTAL SPEC.-R13  
NO. OF PEDESTALS 8

- CODE -

- ⊕ TEMPORARY SECONDARY PEDESTAL
- ⊞ DFT (DEAD FRONT TYPE)
- UDT (NON-SWITCHING-LIVE FRONT TYPE)
- ⊞ UDT (SWITCHING-LIVE FRONT TYPE)
- ↔ DIRECTION OF TRANSFORMER DOOR OPENING
- SECONDARY PEDESTAL
- ▲ SECONDARY TERMINAL
- ⊙ CABLE POLE
- ⊞ PRIMARY SWITCH CABINET
- BURIED PRIMARY CABLE-ALL VOLTAGES
- BURIED SECONDARY CABLE
- BURIED SECONDARY SERVICE CABLE
- DETROIT EDISON TRENCH ONLY
- TELEPHONE TRENCH ONLY
- SEWER
- WATER
- GAS
- PROPOSED CONDUIT

CABLE SUMMARY

ITEM# 455	#2A Ws Al xl, 13.2 KV	713-3062-	900'
ITEM# 437	AP2-350M & 1-4/0 600 V.	713-0637-	680'
ITEM#	AP2 2/0 & 1-#1 600 V.	713-0614-	1300'

TRENCH SUMMARY

JOINT USE	700'
D. E. ONLY	190'
GAS ONLY	
<b>TOTAL</b>	<b>890'</b>

SITE SUPT. CHUCK HERBERT  
PHONE NO.

- GENERAL NOTES -

TRENCHING TO BE DONE BY C.P. Co.  
TRENCH AND CABLE LENGTHS ARE APPROXIMATE.  
SEE DRAWING UI-1-2369 FOR TRANS. MAT. DETAILS.  
SEE PAGE 32.11 (S.I.M.) DETAIL " " FOR ENTRANCE POINT DETAILS (APTS. ONLY)  
SEE DRAWING UI-4-2263 FOR PLACEMENT OF CABLE, TRANSFORMERS AND PEDESTALS (SUB'DS ONLY).  
D.E. SERVICE PLANNER: Tom Sullivan 235-1650 x343  
GAS CO.: JOHN NAJAR 427-5700 x554

CONTACT "MISS DIG" 800-422-1776 BEFORE DOING ANY EXCAVATION.  
EASEMENTS INDICATED BY OUR CENTERLINES ARE (6') SIX FEET IN WIDTH UNLESS OTHERWISE NOTED.

TRANSFORMER DATA

U.D.T. NO.	SIZE	ED. STK. NO.
M1007-1	100	661-1153
2	100	-1153
M1008-1	100	-1153

RECORDED RIGHT OF WAY NO. 32300

PERMITS REQUIRED

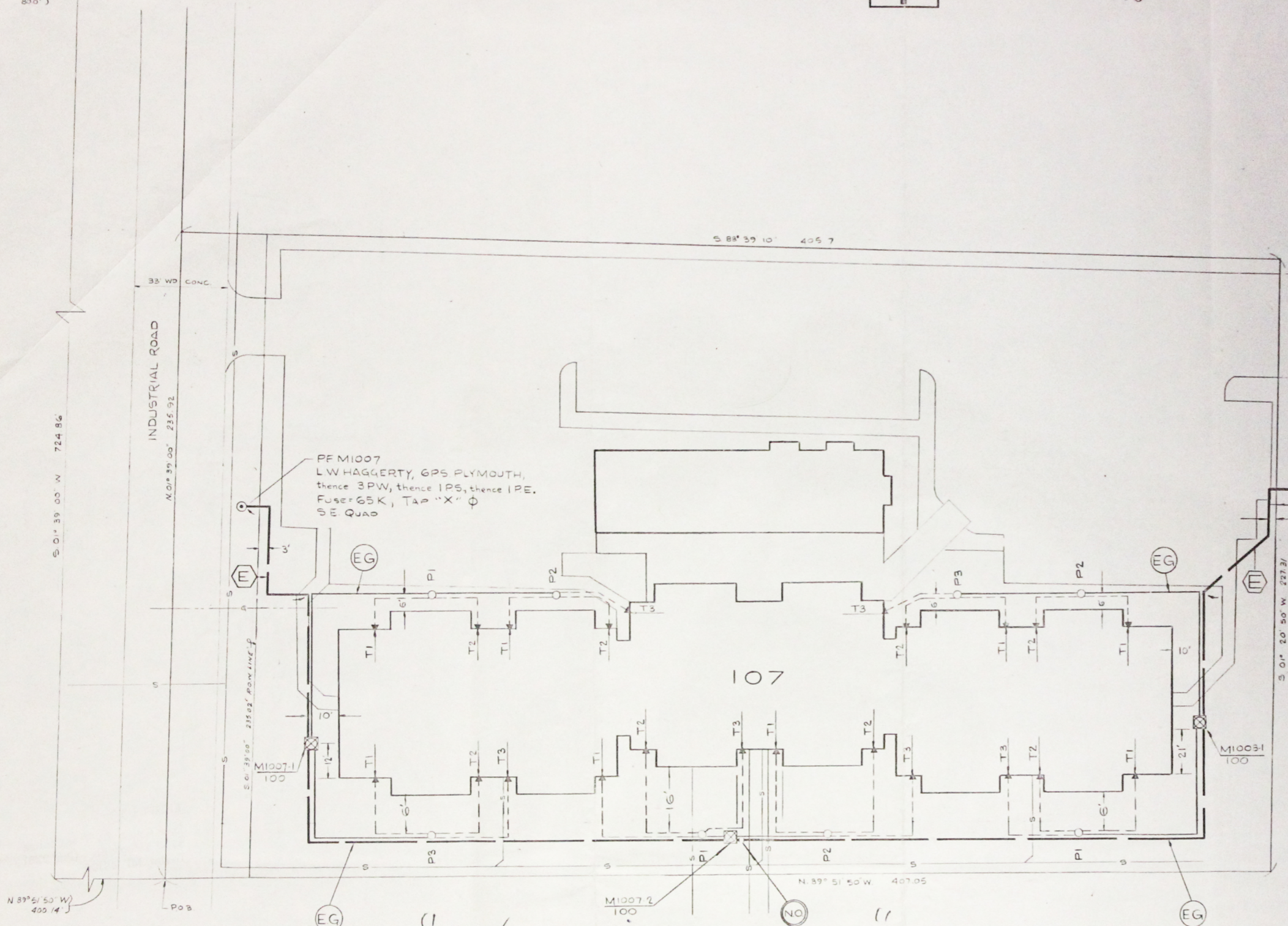

"CONSTRUCTION DRAWING"

REVISION			REVISION			REVISION			REVISION			REFERENCE			NAME			DATE			JOB TITLE			THE DETROIT EDISON COMPANY		
D	C	B	A																							
		RELOCATE UDT M1007-2 RELOCATE TRENCH ON SOUTH SIDE OF BLDG TO 6'	CHANGE TRANS SIZE FROM 50 KVA TO 100 KVA Also: REROUTE PRIMARY CABLE ADJUST TRENCH SUMMARY.																							
DRAWN BY	CHECKED BY	APPROVED BY	DRAWN BY	CHECKED BY	APPROVED BY	DRAWN BY	CHECKED BY	APPROVED BY	DRAWN BY	CHECKED BY	APPROVED BY															
SFZ	8-23-79		SFZ	8-23-79		SFZ	8-23-79																			