

RAILROAD RIGHT OF WAY

DOCUMENT(S) WILL BE SCANNED
AT A LATER TIME

RECORDED RIGHT OF WAY NO R3189X5

**Detroit
Edison**

2000 Second Avenue
Detroit, Michigan 48226
(313) 237-8000

March 20, 1979

Mr. David Wilson, Chief Engineer
Dept. of State Highways & Transportation
P.O. Box 1226
18101 Nine Mile Road
Southfield, MI 48075

Send to Jackson Dist

Gentlemen:

The Detroit Edison Company plans to construct, operate,
and maintain an overhead line in Ypsilanti Township,
Washtenaw County.

The line will cross the tracks of the Consolidated
Rail Corporation. The wires to be installed
are:

Span A-B and B-C

Three #0 ACSR, 4800 volts
One #42AT, 120 volts

The railroad has given the following waiver of hearing:

 Waiver dated enclosed
 XX Blanket Waiver on file with the MPSC.

The proposed crossing is shown on drawing No. RX- 4389A.

 This is a new crossing.
 XX This is a re-construction.

Please grant a State Highway Permit to the Detroit Edison
Company for the proposed crossing.

APPLICATION NO. 81000-16-79R
Permit No. JN-115-79

Date 4-4-79
By John Donohue
Dist. Utility Permits Engineer

RECEIVED

MAR 29 1979

JACKSON DISTRICT #8
Michigan State Highway Department
Very truly yours,

Leslie G. Sundstrom
Leslie G. Sundstrom
Office Supervisor
Real Estate & Rights of Way
630 WCB

RECORDED RIGHT OF WAY NO. 31895

Detroit Edison

2000 Second Avenue
Detroit, Michigan 48226
(313) 237-6000

December 19, 1978

DE-304
NO RENT
Waiver
hearing

Mr. R. W. Orr, Asst. Vice President-Contracts
Consolidated Rail Corporation
Room 601 - Six Penn Center Plaza
Philadelphia, Pennsylvania 19104

Proposed Overhead Wire Crossing:

Span A-B and B-C

Three #0 ACSR, 4800 volts
One #42AT, 120 volts

no
rent

Specific Location

In Factory Street approximately 650' W of Grove Street,
City of Ypsilanti, SE ¼ of Section 9, Ypsilanti Township,
T3S, R7E, Washtenaw County

R. R. Valuation Station 44+00+ and 44+40+ R. R. Mile Post _____
City/Village Ypsilanti Township Ypsilanti
County Washtenaw Detroit Edison Plan Attached RX-4389A
This is a New Crossing _____ This is a Reconstruction of Existing Crossing XX
Previous Agreement Information (if any) Date 11/1/78 (R. R. Plan) DE-292

Blanket Waiver of Hearing Covers _____ Waiver of Hearing Requested In Duplicate
(Waiver of Hearing to be mailed to applicant listed below)

All construction will be done in accordance with the rules and regulations of the Michigan Public Service Commission.

John A. Haddow /BAS

RECORDED RIGHT OF WAY NO. 3/895

JOHN A. HADDOW
Public Agency Coordinator

Detroit
Edison

2000 Second Avenue
Detroit, Michigan 48226
(313) 237-8000

December 19, 1978

Mr. R. W. Orr, Asst. Vice President-Contracts
Consolidated Rail Corporation
Room 601 - Six Penn Center Plaza
Philadelphia, Pennsylvania 19104

Proposed Overhead Wire Crossing:

Span A-B and B-C

Three #0 ACSR, 4800 volts
One #42AT, 120 volts

Specific Location

In Factory Street approximately 650' W of Grove Street,
City of Ypsilanti, SE 1/4 of Section 9, Ypsilanti Township,
T3S, R7E, Washtenaw County

R. R. Valuation Station 44+00+ and 44+40+ R. R. Mile Post _____

City/Village Ypsilanti Township Ypsilanti

County Washtenaw Detroit Edison Plan Attached RX-4389A

This is a New Crossing _____ This is a Reconstruction of Existing Crossing XX

Previous Agreement Information (if any) Date 10-25-78 (R. R. Plan) DE-292

Blanket Waiver of Hearing Covers _____ Waiver of Hearing Requested In Duplicate
(Waiver of Hearing to be mailed to applicant listed below)

All construction will be done in accordance with the rules and regulations of the Michigan Public Service Commission.

John A. Haddow /BAS

PROPOSED LINE CROSSING OVER MICHIGAN CONSOLIDATED RR. EXISTING PERMIT NUMBER NEW
IN FACTORY ST. APPROX. 650' WEST OF GROVE ST. CITY OF YPSILANTI

SECTION A S.E. 1/4 TOWNSHIP YPSILANTI T 35 R 7E COUNTY WASHTENAW

NUMBER	CONDUCTORS			POLES			
	SIZE	KIND	VOLTAGE	LOCATION	LENGTH	CLASS	SET
3	0	ACSR	4.8 KV	A	45	4	6.5'
1	4A2T		120 VLT.	B	50	3	7'
				C	75	4	8.5'
				D	45	4	6.5'

↑
EXISTING AGREEMENT
10-25-78
REG# 227409
(SEE CLOSED FILE# DE-292)

DESIGNED BY TERRY SMART DIVISION AND ARBOR
CHECKED BY JONNA PHILLIPS SYSTEM ENGINEERING DEPT. DATE 12-13-72

NOTES
MATERIALS SHALL BE AS NOTED IN THE CURRENT REVISION OF DETROIT EDISON COMPANY'S GENERAL SPECIFICATIONS FOR OVERHEAD LINE CONSTRUCTION AT RAILROAD CROSSINGS.
ACTUAL FIELD DIMENSIONS MAY VARY SOMEWHAT FROM THOSE SHOWN, BUT THE REQUIREMENTS OF THE CURRENT REVISIONS OF ORDER NO'S. 1679 AND 1868 OF MICHIGAN PUBLIC SERVICE COMMISSION WILL BE COMPLIED WITH.

MINIMUM CLEARANCES

NEAREST POLE TO RAIL	SIDING	7 FT
	MAIN LINE	12 FT
WIRES OVER TRACKS	0 - 750 VOLTS	27 FT
	750 - 15,000 VOLTS	28 FT
	15,000 - 50,000 VOLTS	30 FT
	50,000 - 120,000 VOLTS	33 FT
WIRES OVER R R SIGNAL	0 - 750 VOLTS	2 FT
	750 - 8,700 VOLTS	4 FT
	8,700 - 50,000 VOLTS	6 FT
	50,000 - 120,000 VOLTS	9 FT

SPAN	SPAN LENGTH	LOWEST CONDUCTOR OVER R. R. TRACKS	STRINGING SAG AT 60° F	HEIGHT OF LOWEST CONDUCTOR OVER	
				R. R. TRACKS	R. R. SIGNAL WIRE
A - B	171' 9"	4A2T 120 VLT. SEC.	34"	32.2'	
B - C	170'	1/4" E.H.S. R. 604	— D —	33'	

SAG TABLE ST. I AL. & ACSR
RULING SPAN ST. I - 175 AA
FINAL SAG RATIO 1.24

** 45' Pole removed & 50' Pole with transformer installed (to service crossing signals)*

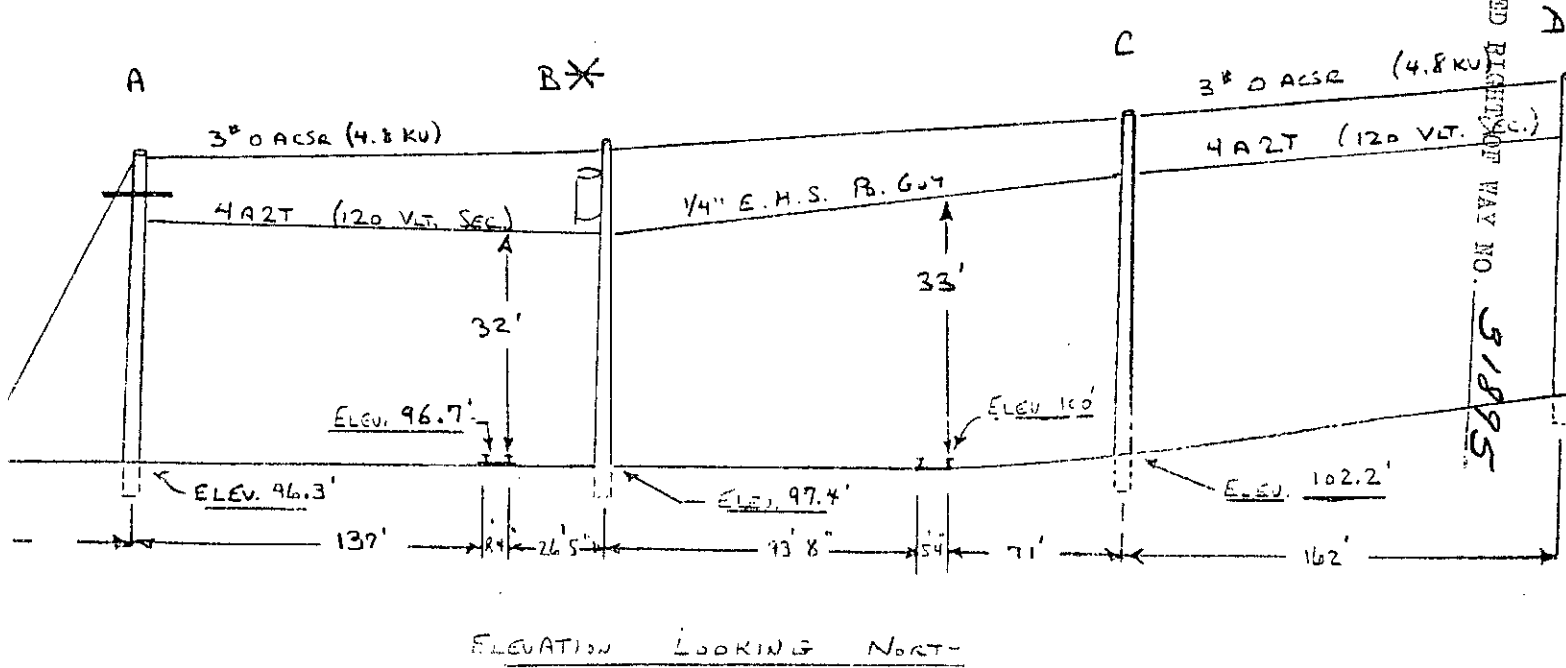

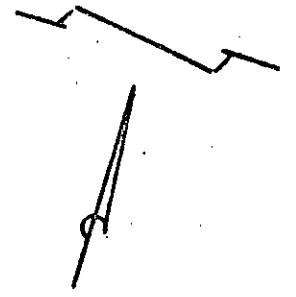

MICHIGAN CONSOLIDATED RR.
 (SPUR TRACKS TO FORD MOTOR)

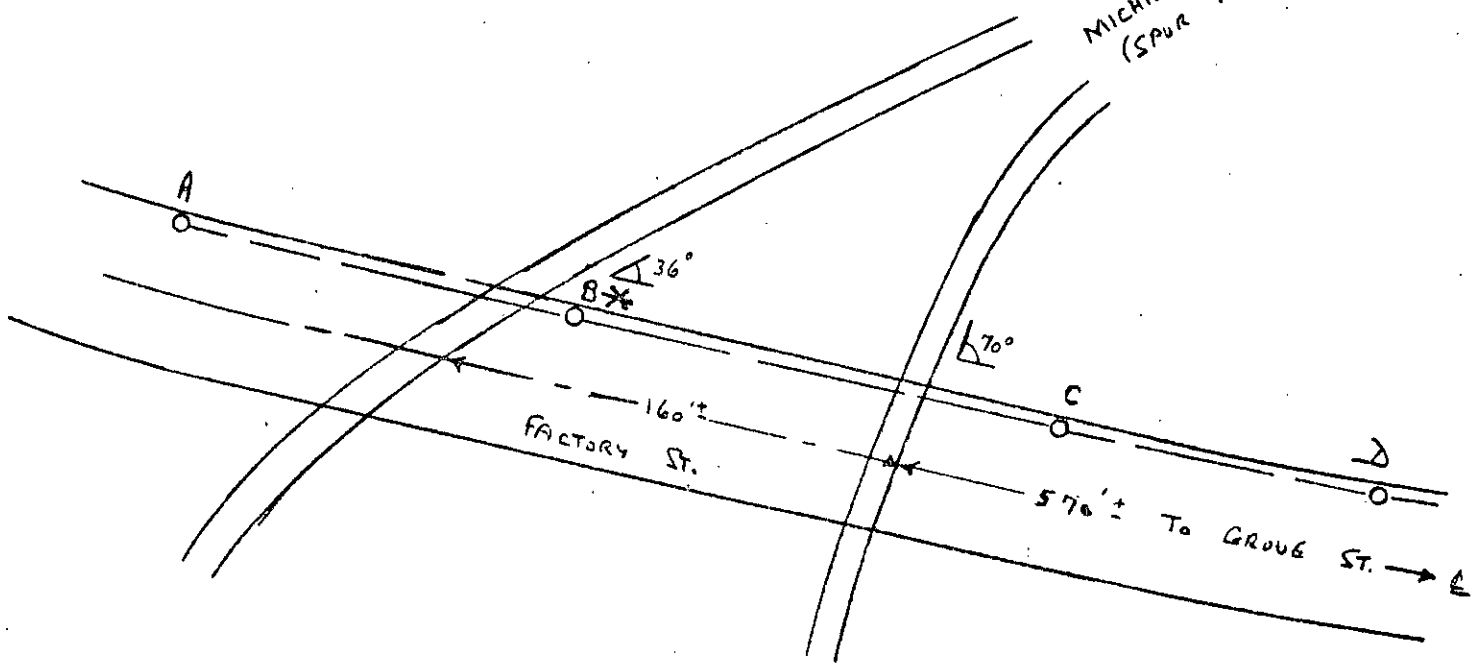

FORD MOTOR CO.

PLAN No. 38

RECORDED RIGHT OF WAY NO. 31895

Submit One (1) Copy for each Span to
Real Estate and Rights of Way Dept.

D.O. No. B-37309

Date 12-14-78

THE DETROIT EDISON COMPANY

RAILROAD CROSSING DATA SHEET

RX 4389 A

Span A-B, B-C

Revision of RX 4389

M.P.S.C. Permit and Date _____

Railroad: Michigan Consolidated Railroad

Facilities: Three # 0 ACSR, 4800 Volts
One # 4A2T, 120 Volts

Location: In Factory Street approximately 650' W. of
Grove Street. City of Ypsilanti, Section 9
S.E. 1/4, Ypsilanti Township, T 35 R 7E,
Washtenaw County

System Engineering Dept.

Date 12-14-78

By Donna Phillips

Separate from RX 4388.

2-27-79

Discussion with Terry Smart, an
Arbor Service Planning -

RX-4389A, DE-304

The only change made concerning this
crossing was the removal of a 45' Class 4
pole, which was replaced with a
50' Class 3 pole. A transformer was
added to serve crossing signals on
Factory street.

I notified Conrail in Pennsylvania
of the above stated information.
The crossing # 4389A will be placed in
their "rust" bin and processed in the
near future.

E. J.

RX 4389A

CONRAIL



March 12, 1979
File: DE-304

Detroit Edison Company
2000 Second Avenue
Detroit, Michigan 48226

Attention: Mr. Edward Jansen
Public Agency Coordinator

Gentlemen:

Reference is made to your letter dated December 19, 1978, attaching copies of Drawing RX-4389A dated December 13, 1978, in connection with revision of existing facilities at Ford Spur Track at Valuation Station 44+40+ located in the City of Ypsilanti, Washtenaw County, MI, within the confines of Factory Street which are covered by agreement dated October 25, 1978, between the Consolidated Rail Corporation and your Company, our Registry Number 227409.

It is our understanding that the proposed revision consists of removing a 45 foot pole and placing a 50 foot pole with a transformer to service crossing signals at location "B", as shown on the abovementioned drawing, which is hereto attached and hereby made a part of this agreement.

Formal consent of Consolidated Rail Corporation is hereby given to the above described changes with the understanding that all the terms and conditions of the aforementioned agreement of October 25, 1978, will apply with full force and effect.

Consolidated Rail Corporation hereby waives hearing in regard to your Company making the abovementioned construction provided the work is done in a safe and satisfactory manner and subject to the rules and regulations of the Michigan Public Service Commission.

It is further understood that you will notify Mr. R. D. Lowery, Engineer of Construction, Chicago, Illinois, Telephone: 312-236-7200 x2400 at least seven (7) working days prior to start of work.

Very truly yours,

R. W. Orr
R. W. Orr
Assistant Vice President -
Contracts

RGM/c

RECORDED RIGHT OF WAY NO. 31895

CONRAIL

March 12, 1979
File: DE-304

Detroit Edison Company
2000 Second Avenue
Detroit, Michigan 48226

Attention: Mr. Edward Jansen
Public Agency Coordinator

Gentlemen:

Reference is made to your letter dated December 19, 1978, attaching copies of Drawing RX-4389A dated December 13, 1978, in connection with revision of existing facilities at Ford Spur Track at Valuation Station 44+40+ located in the City of Ypsilanti, Washtenaw County, MI, within the confines of Factory Street which are covered by agreement dated October 25, 1978, between the Consolidated Rail Corporation and your Company, our Registry Number 227409.

It is our understanding that the proposed revision consists of removing a 45 foot pole and placing a 50 foot pole with a transformer to service crossing signals at location "B", as shown on the abovementioned drawing, which is hereto attached and hereby made a part of this agreement.

Formal consent of Consolidated Rail Corporation is hereby given to the above described changes with the understanding that all the terms and conditions of the aforementioned agreement of October 25, 1978, will apply with full force and effect.

Consolidated Rail Corporation hereby waives hearing in regard to your Company making the abovementioned construction provided the work is done in a safe and satisfactory manner and subject to the rules and regulations of the Michigan Public Service Commission.

It is further understood that you will notify Mr. R. D. Lowery, Engineer of Construction, Chicago, Illinois, Telephone: 312-236-7200 x2400 at least seven (7) working days prior to start of work.

Very truly yours,

R. W. Orr
Assistant Vice President -
Contracts

RGM/c

**Detroit
Edison**

To: Records Center

From: Barbara Schmidt
Real Estate and Rights of Way Department

Subject: Distribution and Subtransmission R/W crossing over
the Consolidated Rail Corporation, City of Ypsilanti,
Section 9, T3S, R7E; RX-4389

The attached papers are for records center storage. Information
about the completed transaction is shown in the following summary.

R.R. 1	R.R. INVOICE NO. M.P.S.C. NO. OR R.E. & R/W NO. 4	Update 10 Type	D.E.C.O. RECORDS CENTER FILE NO. 15	R.X. NO. OR MAP NO. 20	Facility 21	Agreement 22 Date 27
09	000E292	1		04389	3	110178

Payment Frequency 28	Rental 29 33	OH-UG 34 Code	Division 35	County 36	City or Township 38 44	Section 46
		1	1	12	YPSILAN	09

Location 47 50									
INFACTORY ST 650' W OF GROVE ST									

Update Type Codes
1 = New Agreement
2 = Revised Agreement
3 = Terminated Agreement

The Accounts Payable Department is requested to start or change
the rental payment effective

Approved: *Barbara Schmidt*

- cc: Accounts Payable
 Service Planning - T. Smart
 System Engineering
 Transmission & Distribution

RECORDED RIGHT OF WAY NO. 31895

Detroit
Edison

2000 Second Avenue
Detroit, Michigan 48226
(313) 237-6000

November 2, 1978

Mr. John Lonskey
Utilities-Permits Engineer
Michigan Department of State
Highways & Transportation
Two North Plaza
Jackson, Michigan 49202

Gentlemen:

The Detroit Edison Company plans to construct, operate, and maintain an overhead line in the City of Ypsilanti, Ypsilanti Township, Washtenaw County.

The line will cross the tracks of the Consolidated Rail Corporation. The wires to be installed are:

Span A-B and B-C

Three 1/0 ACSR 4,800 volts
One 4A2T 120 volts

RECEIVED

NOV - 3 1978

JACKSON DISTRICT #8
Michigan State Highway Department

The railroad has given the following waiver of hearing:

- Waiver dated 11/1/78 enclosed
- Blanket Waiver on file with the MPSC.

The proposed crossing is shown on drawing No. RX-

- This is a new crossing.
- This is a re-construction.

Please grant a State Highway Permit to the Detroit Edison Company for the proposed crossing.

APPLICATION 81000-80-78R
Permit No. JN-646-78

Date 11-7-78

By _____

APPROVED

NOV - 7 1978

John Lonskey
DISTRICT UTILITIES ENG.
M.D.S.H. & T.

Very truly yours,

John A. Haddow

John A. Haddow
Public Agency Coordinator
Real Estate & Rights of Way

RECORDED RIGHT OF WAY NO. 31895

CONSOLIDATED RAIL CORPORATION

528 Walnut Street

PHILADELPHIA, PENNSYLVANIA 19106

Telephone: 215-993-6386

Assistant Vice President

Detroit Edison Company
2000 Second Avenue
Detroit, Michigan 48226

October 25, 1978
File: DE-292

Attention: John A. Haddow
Public Agency

Gentlemen:

Reference is made to your letter dated June 8, 1978, attaching copies of your drawing RE-4389 indicating your proposed installation of one (1) circuit, 4,800 volts, consisting of three (3) conductors and one (1) circuit, 120 volts, consisting of one (1) conductor, crossing over Ford Spur tracks at Valuation Stations 44-001 and 44-407, located in City of Ypsilanti, Washtenaw County, Michigan, within the confines of Factory Street.

We have no objections to the installation as mentioned above with the understanding that the above-mentioned facilities will be installed in a safe and satisfactory manner and in accordance with the "General Conditions" hereto attached and made a part hereof. You will be required to notify E. D. Lowery, Engineer of Construction, Chicago, Illinois, Tele: 312-236- at least seven (7) working days prior to start of work. 7200 x2400

It is to be understood that this installation must be made in accordance with the approved plans and will conform with current Consolidated Rail Corporation construction requirements.

Consolidated Rail Corporation hereby waives hearing in regard to your Company making the above-mentioned construction provided the work is done in a safe and satisfactory manner and subject to the rules and regulations of the Michigan Public Service Commission.

To confirm your acceptance of these conditions, please have an authorized official of your Company indicate acceptance in the space provided on the duplicate of this letter and return it to this office. It is to be further understood that no work can be started until the signed copy of this letter is received in this office and the notification procedures as stated above have been accomplished.

RLS/c

CONSOLIDATED RAIL CORPORATION

ACCEPTED

(signed) R. W. CRR

By 

R. W. Crr
Assistant Vice President
Contracts

Title Date 11/1/78

ROBERT R. TEWKSBURY, DIRECTOR
Real Estate and Rights of Way Dept.

RECORDED RIGHT OF WAY NO. 31895

CONSOLIDATED RAIL CORPORATION

1918 Walnut Street

PHILADELPHIA, PENNSYLVANIA 19103

GENERAL CONDITIONS

1. Facilities must conform with all Federal, State and local laws, rules and regulations and will not be attached to any Railroad structure or appurtenance and will not otherwise be located on any private property of the Railroad.
2. In the event of any revision, renewal, addition or alteration of said facilities, prior approval of the Railroad must be secured.
3. Facilities will be installed, maintained, repaired and renewed by and at the sole risk, cost and expense of the OWNER.
4. If the Railroad deems it advisable during the progress of any work of construction, maintenance, repairs and renewals, alterations, adjustments or removal of the facilities and appurtenances of the OWNER, or in the event of emergency, to place watchmen, flagmen, inspectors or any other employees deemed necessary by Railroad for the protection of the property owned or in possession or control of the Railroad, or its employees, patrons, or licensees, the Railroad shall have the right to do so. The OWNER agrees to pay to Railroad the actual cost of material plus the current applicable overhead percentages for storage, handling, transportation, purchasing and other related material management expenses and the actual cost of labor plus the current applicable overhead percentages as developed and published by the Accounting Department of Railroad for fringe benefits, payroll taxes, administration, supervision, use of tools, machinery and other equipment, supplies, employers' liability insurance, public liability insurance, and other insurance, taxes and all other indirect expenses. It is to be understood that the aforementioned material and labor overhead charges are to be applied at the rates which are effective at the time of the performance of any work by employees of the Railroad on the said facilities. The OWNER agrees to pay such bills within thirty (30) days of the presentation thereof by Railroad. Failure of the Railroad to provide such watchmen, flagmen, inspectors or any other employees of Railroad, shall in no event be construed as in any manner or degree affecting any obligations of the OWNER as provided for elsewhere in these conditions.
5. All cost or expense resulting from any and all loss of life or property, or injury or damage to the person or property of any person, firm or corporation (including the parties hereto and their respective officers, agents and employees) and any and all claims, demands or actions for such loss, injury or damage, caused by or growing out of the presence or use, or the construction, maintenance, renewal, change or relocation and subsequent removal of said facilities and appurtenances herein referred to, caused by or from the joint or concurring negligence of both parties hereto shall be borne by them equally; if, however, any such loss, injury or damage shall be attributed to the negligence of one of the parties hereto, where solely or combined with the negligence of any other person or corporation not a party hereto, and without the concurring fault or negligence of the other party hereto, then such party hereto which by its fault, or negligence contributed thereto shall indemnify, protect and save harmless the other party hereto therefrom.
6. Upon abandonment of the facilities, the same shall be removed and the property of the Railroad shall be restored to good condition and this instrument shall become null and void, save and except only as to any liability accrued prior thereto.
7. All rights and obligations conferred hereby shall extend to the successors and assigns of the parties hereto, provided that the owner shall in no event transfer or assign its rights hereunder without the written consent of Railroad".

3895

Detroit Edison

2000 Second Avenue
Detroit, Michigan 48226
(313) 237-8006

November 2, 1978

Mr. John Lonskey
Utilities-Permits Engineer
Michigan Department of State
Highways & Transportation
Two North Plaza
Jackson, Michigan 49202

Gentlemen:

The Detroit Edison Company plans to construct, operate, and maintain an overhead line in the City of Ypsilanti, Ypsilanti Township, Washtenaw County.

The line will cross the tracks of the Consolidated Rail Corporation. The wires to be installed are:

Span A-B and B-C

Three 1/0 ACSR 4,800 volts
One 4A2T 120 volts

The railroad has given the following waiver of hearing:

- Waiver dated 11/1/78 enclosed
- Blanket Waiver on file with the MPSC.

The proposed crossing is shown on drawing No. RX-

- This is a new crossing.
- This is a re-construction.

Please grant a State Highway Permit to the Detroit Edison Company for the proposed crossing.

Permit No. _____

Date _____

By _____

Very truly yours,

John A. Haddow

John A. Haddow
Public Agency Coordinator
Real Estate & Rights of Way

RECORDED RIGHT OF WAY NO. 31895

CONSOLIDATED RAIL CORPORATION

528 Walnut Street

PHILADELPHIA, PENNSYLVANIA 19102

Telephone: 215-895-4386

Assistant Vice President

Detroit Edison Company
2000 Second Avenue
Detroit, Michigan 48226

October 25, 1978
File: DE-292

Attention: John A. Haddock
Public Agency

Gentlemen:

Reference is made to your letter dated June 4, 1978, attaching copies of your drawing 100-4389 indicating your proposed installation of one (1) circuit, 4,800 volts, consisting of three (3) conductors and one (1) circuit, 120 volts, consisting of one (1) conductor, crossing over Fern Spur tracks at Valuation Stations 44-101 and 44-102, located in City of Ypsilanti, Washtenaw County, Michigan, within the confines of Factory Street.

We have no objections to the installation as mentioned above with the understanding that the abovementioned facilities will be installed in a safe and satisfactory manner and in accordance with the "General Conditions" hereto attached and made a part hereof. You will be required to notify H. D. Lowery, Engineer of Construction, Chicago, Illinois, Tele: 312-236- at least seven (7) working days prior to start of work. 7200 x2400

It is to be understood that this installation must be made in accordance with the approved plans and will conform with current Consolidated Rail Corporation construction requirements.

Consolidated Rail Corporation hereby waives hearing in regard to your Company making the abovementioned construction provided the work is done in a safe and satisfactory manner and subject to the rules and regulations of the Michigan Public Service Commission.

To confirm your acceptance of these conditions, please have an authorized official of your Company indicate acceptance in the space provided on the duplicate of this letter and return it to this office. It is to be further understood that no work can be started until the signed copy of this letter is received in this office and the notification procedures as stated above have been accomplished.

RLS/c

CONSOLIDATED RAIL CORPORATION

ACCEPTED

(signed) R. W. CRR

By 

R. W. Crr
Assistant Vice President
Contracts

Title Date 11/1/78
ROBERT R. NEWBURY, DIRECTOR
Real Estate and Rights of Way Dept.

RECORDED RIGHT OF WAY NO. 31895

CONSOLIDATED RAIL CORPORATION

1775 Walnut Street

PHILADELPHIA, PENNSYLVANIA 19103

GENERAL CONDITIONS

1. Facilities must conform with all Federal, State and local laws, rules and regulations and will not be attached to any Railroad structure or appurtenance and will not otherwise be located on any private property of the Railroad.
2. In the event of any revision, renewal, addition or alteration of said facilities, prior approval of the Railroad must be secured.
3. Facilities will be installed, maintained, repaired and renewed by and at the sole risk, cost and expense of the OWNER.
4. If the Railroad deems it advisable during the progress of any work of construction, maintenance, repairs and renewals, alterations, adjustments or removal of the facilities and appurtenances of the OWNER, or in the event of emergency, to place watchmen, flagmen, inspectors or any other employees deemed necessary by Railroad for the protection of the property owned or in possession or control of the Railroad, or its employees, patrons, or licensees, the Railroad shall have the right to do so. The OWNER agrees to pay to Railroad the actual cost of material plus the current applicable overhead percentages for storage, handling, transportation, purchasing and other related material management expenses and the actual cost of labor plus the current applicable overhead percentages as developed and published by the Accounting Department of Railroad for fringe benefits, payroll taxes, administration, supervision, use of tools, machinery and other equipment, supplies, employers' liability insurance, public liability insurance, and other insurance, taxes and all other indirect expenses. It is to be understood that the aforementioned material and labor overhead charges are to be applied at the rates which are effective at the time of the performance of any work by employees of the Railroad on the said facilities. The OWNER agrees to pay such bills within thirty (30) days of the presentation thereof by Railroad. Failure of the Railroad to provide such watchmen, flagmen, inspectors or any other employees of Railroad, shall in no event be construed as in any manner or degree affecting any obligations of the OWNER as provided for elsewhere in these conditions.
5. All cost or expense resulting from any and all loss of life or property, or injury or damage to the person or property of any person, firm or corporation (including the parties hereto and their respective officers, agents and employees) and any and all claims, demands or actions for such loss, injury or damage, caused by or growing out of the presence or use, or the construction, maintenance, renewal, change or relocation and subsequent removal of said facilities and appurtenances herein referred to, caused by or from the joint or concurring negligence of both parties hereto shall be borne by them equally; if, however, any such loss, injury or damage shall be attributed to the negligence of one of the parties hereto, where solely or combined with the negligence of any other person or corporation not a party hereto, and without the concurring fault or negligence of the other party hereto, then such party hereto which by its fault, or negligence contributed thereto shall indemnify, protect and save harmless the other party hereto therefrom.
6. Upon abandonment of the facilities, the same shall be removed and the property of the Railroad shall be restored to good condition and this instrument shall become null and void, save and except only as to any liability accrued prior thereto.
7. All rights and obligations conferred hereby shall extend to the successors and assigns of the parties hereto, provided that the owner shall in no event transfer or assign its rights hereunder without the written consent of Railroad".

3/8/95

**Detroit
Edison**

2000 Second Avenue
Detroit, Michigan 48226
(313) 237-8000

November 2, 1978

Mr. R. W. Orr
Assistant Vice President-Contracts
Consolidated Rail Corporation
Room 601 - Six Penn Center Plaza
Philadelphia, Pennsylvania 19104

Re: Your File DE-292

Dear Mr. Orr:

Enclosed please find the executed copy of your letter dated October 25, 1978, with attached General Conditions, regarding the above file.

Very truly yours,

John A. Haddow
Public Agency Coordinator

JAH:bas
Enc.

RECORDED FROM OP FILE NO. 31895

CONSOLIDATED RAIL CORPORATION

1528 Walnut Street

PHILADELPHIA, PENNSYLVANIA 19104

Telephone: 215-893-6386

Assistant Vice President

Detroit Edison Company
2000 Second Avenue
Detroit, Michigan 48226

October 25, 1978
File: DE-292

Attention: John A. Hadow
Public Agency

Gentlemen:

Reference is made to your letter dated June 4, 1978, attaching copies of your drawing RX-4389 indicating your proposed installation of one (1) circuit, 4,800 volts, consisting of three (3) conductors and one (1) circuit, 120 volts, consisting of one (1) conductor, crossing over Ford Spur tracks at Valuation Stations 44+00+ and 44+40+, located in City of Ypsilanti, Washtenaw County, Michigan, within the confines of Factory Street.

We have no objections to the installation as mentioned above with the understanding that the abovementioned facilities will be installed in a safe and satisfactory manner and in accordance with the "General Conditions" hereto attached and made a part hereof. You will be required to notify R. D. Lowery, Engineer of Construction, Chicago, Illinois, Tele: 312-236- at least seven (7) working days prior to start of work. 7200 x2400

It is to be understood that this installation must be made in accordance with the approved plans and will conform with current Consolidated Rail Corporation construction requirements.

Consolidated Rail Corporation hereby waives hearing in regard to your Company making the abovementioned construction provided the work is done in a safe and satisfactory manner and subject to the rules and regulations of the Michigan Public Service Commission.

To confirm your acceptance of these conditions, please have an authorized official of your Company indicate acceptance in the space provided on the duplicate of this letter and return it to this office. It is to be further understood that no work can be started until the signed copy of this letter is received in this office and the notification procedures as stated above have been accomplished.

RLS/c

CONSOLIDATED RAIL CORPORATION

ACCEPTED

(signed) R. W. ORR

By [Signature]

R. W. Orr
Assistant Vice President
Contracts

Title Date 11/1/78

ROBERT R. TEWKSBURY, DIRECTOR
Real Estate and Rights of Way Dept.

RECORDED RIGHT OF WAY NO. 31895

CONSOLIDATED RAIL CORPORATION

1528 Walnut Street

PHILADELPHIA, PENNSYLVANIA 19104

Telephone: 215-893-6386

Assistant Vice President

Detroit Edison Company
2000 Second Avenue
Detroit, Michigan 48226

October 25, 1978
File: DE-292

Attention: John A. Haddow
Public Agency

Gentlemen:

Reference is made to your letter dated June 4, 1978, attaching copies of your drawing RX-4389 indicating your proposed installation of one (1) circuit, 4,800 volts, consisting of three (3) conductors and one (1) circuit, 120 volts, consisting of one (1) conductor, crossing over Ford Spur tracks at Valuation Stations 44+00+ and 44+40+, located in City of Ypsilanti, Washtenaw County, Michigan, within the confines of Factory Street.

We have no objections to the installation as mentioned above with the understanding that the abovementioned facilities will be installed in a safe and satisfactory manner and in accordance with the "General Conditions" hereto attached and made a part hereof. You will be required to notify R. D. Lowery, Engineer of Construction, Chicago, Illinois, Tele: 312-236-at least seven (7) working days prior to start of work. 7200 x2400

It is to be understood that this installation must be made in accordance with the approved plans and will conform with current Consolidated Rail Corporation construction requirements.

Consolidated Rail Corporation hereby waives hearing in regard to your Company making the abovementioned construction provided the work is done in a safe and satisfactory manner and subject to the rules and regulations of the Michigan Public Service Commission.

To confirm your acceptance of these conditions, please have an authorized official of your Company indicate acceptance in the space provided on the duplicate of this letter and return it to this office. It is to be further understood that no work can be started until the signed copy of this letter is received in this office and the notification procedures as stated above have been accomplished.

RLS/c

CONSOLIDATED RAIL CORPORATION

R W Orr
R. W. Orr
Assistant Vice President
Contracts

RECORDED RIGHT OF WAY NO. 31895

11/22/76

CONSOLIDATED RAIL CORPORATION
1528 Walnut Street

PHILADELPHIA, PENNSYLVANIA 19104

GENERAL CONDITIONS

1. Facilities must conform with all Federal, State and local laws, rules and regulations and will not be attached to any Railroad structure or appurtenance and will not otherwise be located on any private property of the Railroad.
2. In the event of any revision, renewal, addition or alteration of said facilities, prior approval of the Railroad must be secured.
3. Facilities will be installed, maintained, repaired and renewed by and at the sole risk, cost and expense of the OWNER.
4. If the Railroad deems it advisable during the progress of any work of construction, maintenance, repairs and renewals, alterations, adjustments or removal of the facilities and appurtenances of the OWNER, or in the event of emergency, to place watchmen, flagmen, inspectors or any other employees deemed necessary by Railroad for the protection of the property owned or in possession or control of the Railroad, or its employees, patrons, or licensees, the Railroad shall have the right to do so. The OWNER agrees to pay to Railroad the actual cost of material plus the current applicable overhead percentages for storage, handling, transportation, purchasing and other related material management expenses and the actual cost of labor plus the current applicable overhead percentages as developed and published by the Accounting Department of Railroad for fringe benefits, payroll taxes, administration, supervision, use of tools, machinery and other equipment, supplies, employers' liability insurance, public liability insurance, and other insurance, taxes and all other indirect expenses. It is to be understood that the aforementioned material and labor overhead charges are to be applied at the rates which are effective at the time of the performance of any work by employees of the Railroad on the said facilities. The OWNER agrees to pay such bills within thirty (30) days of the presentation thereof by Railroad. Failure of the Railroad to provide such watchmen, flagmen, inspectors or any other employees of Railroad, shall in no event be construed as in any manner or degree affecting any obligations of the OWNER as provided for elsewhere in these conditions.
5. All cost or expense resulting from any and all loss of life or property, or injury or damage to the person or property of any person, firm or corporation (including the parties hereto and their respective officers, agents and employees) and any and all claims, demands or actions for such loss, injury or damage, caused by or growing out of the presence or use, or the construction, maintenance, renewal, change or relocation and subsequent removal of said facilities and appurtenances herein referred to, caused by or from the joint or concurring negligence of both parties hereto shall be borne by them equally; if, however, any such loss, injury or damage shall be attributed to the negligence of one of the parties hereto, where solely or combined with the negligence of any other person or corporation not a party hereto, and without the concurring fault or negligence of the other party hereto, then such party hereto which by its fault, or negligence contributed thereto shall indemnify, protect and save harmless the other party hereto therefrom.
6. Upon abandonment of the facilities, the same shall be removed and the property of the Railroad shall be restored to good condition and this instrument shall become null and void, save and except only as to any liability accrued prior thereto.
7. All rights and obligations conferred hereby shall extend to the successors and assigns of the parties hereto, provided that the owner shall in no event transfer or assign its rights hereunder without the written consent of Railroad".

CONRAIL

September 22, 1978
File: DE-292, 293

Detroit Edison Company
2000 Second Avenue
Detroit, Michigan 48226

Attention: Mr. John A. Haddow
Public Agency Coordinator

Gentlemen:

Please refer to your phone conversation on September 21, 1978, with Mr. Bottino, of my staff, regarding your plans RX-4388 and RX-4389. Attached is a copy of our Valuation Map for the tracks in question. Please indicate to scale the location of Factory street and your proposed crossings.

In reply, please refer to our file numbers DE-292 & DE-293.

Very truly yours,

R. W. Orr

R. W. Orr
Assistant Vice President-
Contracts

JSB/c

9/27/78

RAIL ROAD VALUATION MAP
Sent to F. Hoffman.

RECORDED RIGHT OF WAY NO. 31895

TERRY SMART

WHERE ARE THESE
TRACKS IN RELATION TO
MAINE LINE.

R.R HAS SEVERAL LOCATIONS
FOR FACTORY STREET
WHERE IS IT?

CAN YOU TIE THESE
LOCATION TO THE SWITCH
AT THE MAINE LINE
HADDON

RECORDED COPY OF FILE

9-29-78

JOHN,

THESE ARE THE MARKED UP DRAWINGS YOU ASKED
FOR SHOWING THE DISTANCES OF THE RAILROAD
CROSSINGS FROM THE LAST SWITCH ON THIS
PARTICULAR SECTION OF TRACK. I HAVE
ATTACHED DEPT. ORDER B-36135. ^{THIS} SHOULD HELP
TO IDENTIFY THE CROSSINGS.

TERRY SMART
185-233
AA. SERU. PLAN.
2925 PLYMOUTH RD.
RM. 210

JOHN A. HADDON
Notary Public, Oakland County, Mich.
My Commission Expires 2-28-79

Detroit
Edison

2000 Second Avenue
Detroit, Michigan 48226
(313) 237-8000

June 4, 1978

Mr. R. W. Orr
Assistant Vice President-Contracts
Consolidated Rail Corporation
Philadelphia, PA 19104

Proposed Overhead Wire Crossing:

Span A-B and B-C

Three 1/0 ACSR 4,800 volts
One 4A2T 120 volts

*See
4388*

Specific Location

In Factory Street, approximately 650' west of Grove St.,
City of Ypsilanti, SE 1/4 of Section 9, T3S, R7E

RECORDED RIGHT OF WAY NO. 31895

R. R. Valuation Station _____ R. R. Mile Post _____

City/Village Ypsilanti Township Ypsilanti

County Washtenaw Detroit Edison Plan Attached RX-4389

This is a New Crossing XX This is a Reconstruction of Existing Crossing _____

Previous Agreement Information (if any) Date _____ (R. R. Plan) _____

Blanket Waiver of Hearing Covers _____ Waiver of Hearing Requested (in duplicate)
(Waiver of Hearing to be mailed to applicant listed below)

All construction will be done in accordance with the rules and regulations of the Michigan Public Service Commission.

John A. Haddow
John A. Haddow
Public Agency Coordinator

Submit One (1) Copy for each Span to
Real Estate and Rights of Way Dept.

D.O. No. B-36135

Date 6-5-78

THE DETROIT EDISON COMPANY

RAILROAD CROSSING DATA SHEET

RX 4389

Span A-B & B-C

Revision of RX NEW

M.P.S.C. Permit and Date _____

Railroad: ~~MICHIGAN~~ CONSOLIDATED

Facilities: 3 1/0 ALSR 4800 VOLTS
1 4A2T 120 VOLTS

Location: IN FACTORY ST. APPROX 650' W OF GROVE ST, CITY
OF YPSILANTI, SE 1/4 OF SECTION 9, TOWNSHIP OF YPSILANTI,
T35 RTE, COUNTY OF WASHTEENAW

System Engineering Dept.

Date 6-5-78

By F.M. Johnson

RECORDED RIGHT OF WAY NO. 31895

THE DETROIT EDISON COMPANY

DE FORM SE 32 8-75X

DC 36135 RX 4389

PROPOSED LINE CROSSING OVER ~~AMERICAN~~ CONSOLIDATED RR. EXISTING PERMIT NUMBER NEW
 IN FACTORY ST. APPROX. 650' WEST OF GROVE ST. CITY OF YPSILANTI

SECTION 9 S.E. 1/4 TOWNSHIP YPSILANTI T 35 R 7E COUNTY WASHTENAW

NOTES
 MATERIALS SHALL BE AS NOTED IN THE CURRENT REVISION OF DETROIT EDISON COMPANY'S GENERAL SPECIFICATIONS FOR OVERHEAD LINE CONSTRUCTION AT RAILROAD CROSSINGS.
 ACTUAL FIELD DIMENSIONS MAY VARY SOMEWHAT FROM THOSE SHOWN, BUT THE REQUIREMENTS OF THE CURRENT REVISIONS OF ORDER NO'S. 1679 AND 1868 OF MICHIGAN PUBLIC SERVICE COMMISSION WILL BE COMPLIED WITH.

CONDUCTORS				POLES			
NUMBER	SIZE	KIND	VOLTAGE	LOCATION	LENGTH	CLASS	SET
3	0	ACSR	4.8 KV	A	45	4	6.5'
1	4A2T		120 VLT.	B	45	4	6.5'
				C	45	4	6.5'
				D	45	4	6.5'

MINIMUM CLEARANCES

NEAREST POLE TO RAIL	SIDING	7 FT
	MAIN LINE	12 FT
WIRES OVER TRACKS	0 - 750 VOLTS	27 FT
	750 - 15,000 VOLTS	28 FT
	15,000 - 50,000 VOLTS	30 FT
	50,000 - 120,000 VOLTS	33 FT
WIRES OVER R R SIGNAL	0 - 750 VOLTS	2 FT
	750 - 8,700 VOLTS	4 FT
	8,700 - 50,000 VOLTS	6 FT
	50,000 - 120,000 VOLTS	9 FT

DESIGNED BY TERRY SMART DIVISION ANN ARBOR
 CHECKED BY F.M. HOFFMAN SYSTEM ENGINEERING DEPT. DATE 5-22-78

SPAN	SPAN LENGTH	LOWEST CONDUCTOR OVER R. R. TRACKS	STRINGING SAG AT 60° F	HEIGHT OF LOWEST CONDUCTOR OVER	
				R. R. TRACKS	R. R. SIGNAL WIRE
A - B	171' 9"	4A2T 120 VLT. SEC.	34"	31' 7"	
B - C	170'	4A2T 120 VLT. SEC.	34"	30' 1"	

SAG TABLE ST. I AL 3 ACSR
 RULING SPAN ST. I - 175 AA
 FINAL SAG RATIO 1.24

RECORDED RIGHT OF WAY NO.

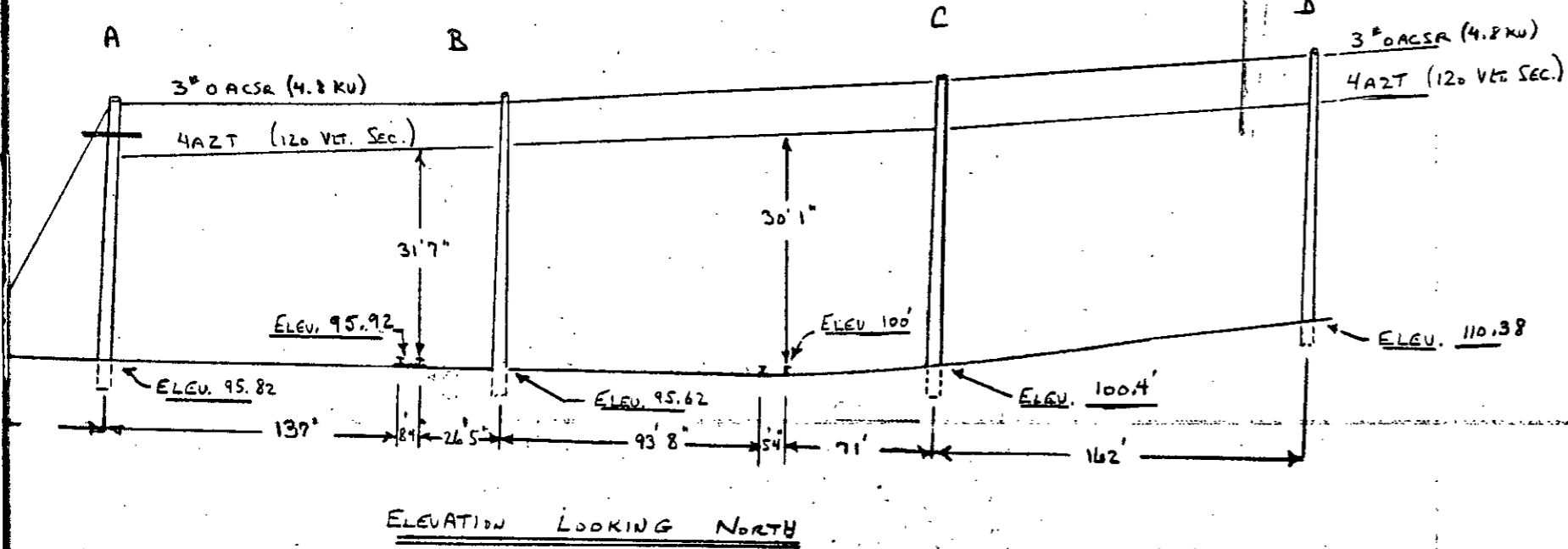
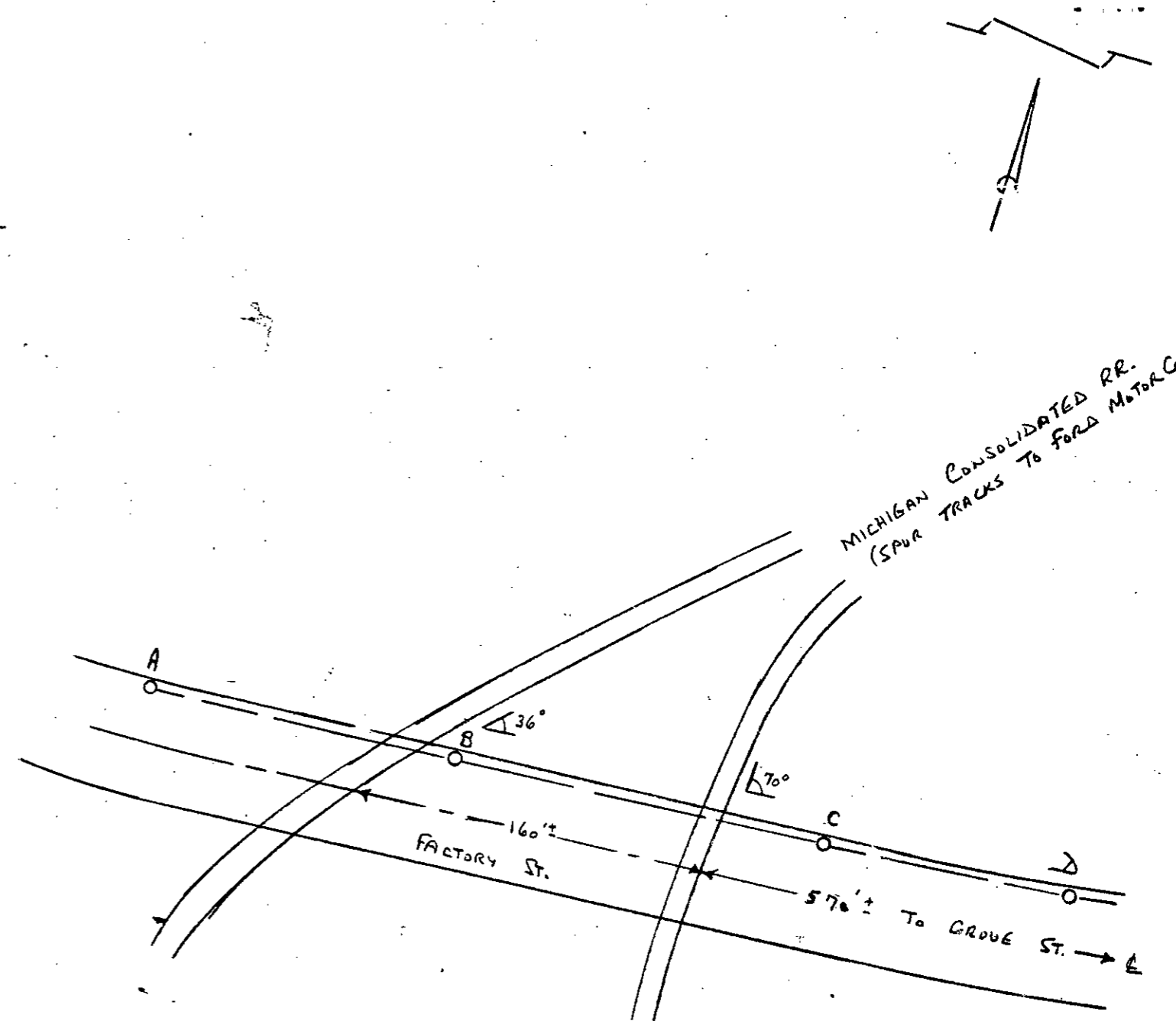

FORD MOTOR CO.

RECORDED RIGHT OF WAY NO. 31895

THE DETROIT EDISON COMPANY

DE FORM SE 32 8-75X

DC - 36135 RX 4389

PROPOSED LINE CROSSING OVER ~~MICHIGAN~~ CONSOLIDATED RR. EXISTING PERMIT NUMBER NEW

IN FACTORY ST. APPROX. 650' WEST OF GROVE ST. CITY OF YPSILANTI

SECTION 9 S.E. 1/4 TOWNSHIP YPSILANTI T 3S R 7E COUNTY WASHTENAW

NOTES
 MATERIALS SHALL BE AS NOTED IN THE CURRENT REVISION OF DETROIT EDISON COMPANY'S GENERAL SPECIFICATIONS FOR OVERHEAD LINE CONSTRUCTION AT RAILROAD CROSSINGS.
 ACTUAL FIELD DIMENSIONS MAY VARY SOMEWHAT FROM THOSE SHOWN, BUT THE REQUIREMENTS OF THE CURRENT REVISIONS OF ORDER NO'S. 1679 AND 1868 OF MICHIGAN PUBLIC SERVICE COMMISSION WILL BE COMPLIED WITH.

MINIMUM CLEARANCES

NEAREST POLE TO RAIL	SIDING	7 FT
	MAIN LINE	12 FT
WIRES OVER TRACKS	0 - 750 VOLTS	27 FT
	750 - 15,000 VOLTS	28 FT
	15,000 - 50,000 VOLTS	30 FT
	50,000 - 120,000 VOLTS	33 FT
WIRES OVER R R SIGNAL	0 - 750 VOLTS	2 FT
	750 - 8,700 VOLTS	4 FT
	8,700 - 50,000 VOLTS	6 FT
	50,000 - 120,000 VOLTS	9 FT

CONDUCTORS				POLES			
NUMBER	SIZE	KIND	VOLTAGE	LOCATION	LENGTH	CLASS	SET
3	0	ACSR	4.8 KV	A	45	4	6.5'
1	4A2T		120 VLT.	B	45	4	6.5'
				C	45	4	6.5'
				D	45	4	6.5'

DESIGNED BY TERRY SMART DIVISION ANN ARBOR
 CHECKED BY F.M. HOFFMAN SYSTEM ENGINEERING DEPT. DATE 5-22-78

SPAN	SPAN LENGTH	LOWEST CONDUCTOR OVER R. R. TRACKS	STRINGING SAG AT 60° F	HEIGHT OF LOWEST CONDUCTOR OVER	
				R. R. TRACKS	R. R. SIGNAL WIRE
A - B	171' 9"	4A2T 120 VLT. SEC.	34"	31' 7"	
B - C	170'	4A2T 120 VLT. SEC.	34"	30' 1"	

SAG TABLE ST. I AL 3 ACSR
 RULING SPAN ST. I - 175 AA
 FINAL SAG RATIO 1.24

MINIMUM HEIGHT OF WIRE NO.

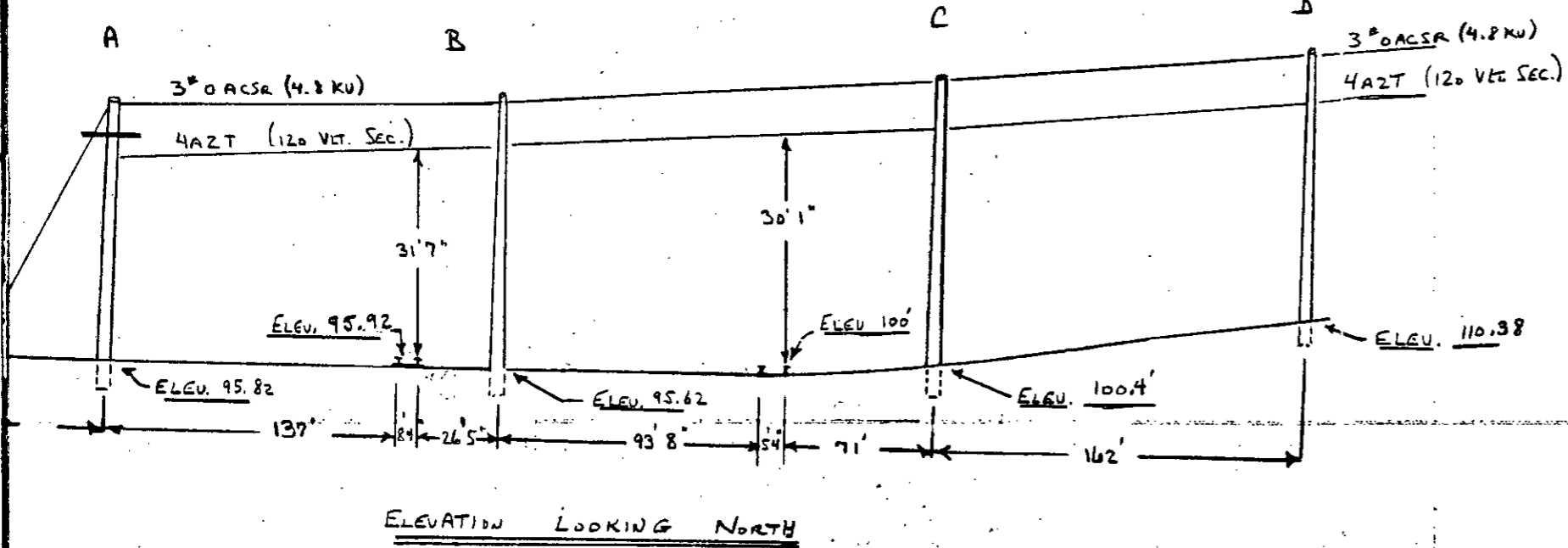
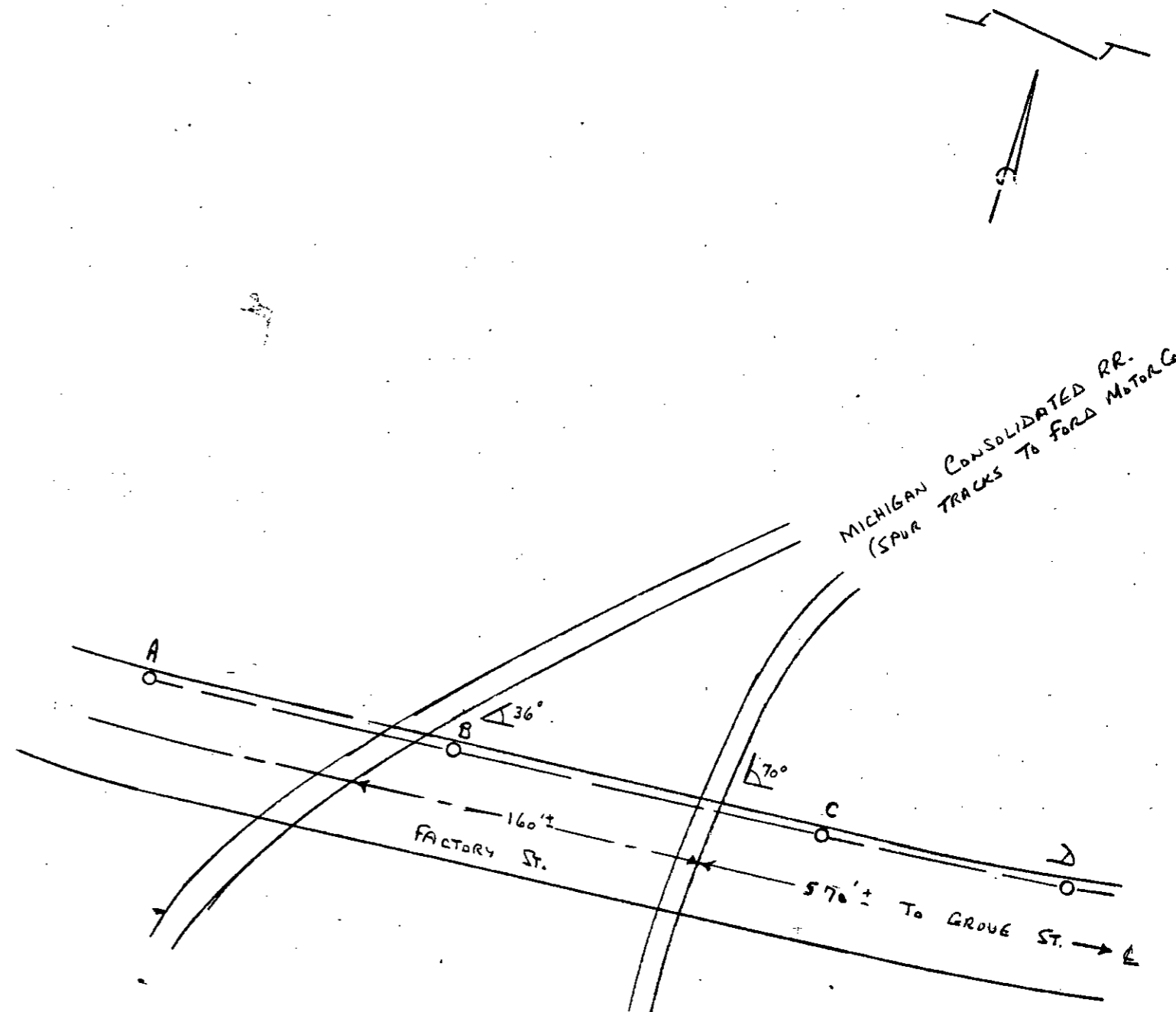

FORD MOTOR CO.

MICHIGAN CONSOLIDATED RR.
 (SPUR TRACKS TO FORD MOTOR CO.)

RECORDED RIGHT OF WAY NO. 31895

PROPOSED LINE CROSSING OVER MICHIGAN CONSOLIDATED RR. EXISTING PERMIT NUMBER NEW
IN FACTORY ST. APPROX. 650' WEST OF GROVE ST. CITY OF YPSILANTI

SECTION 9 S.E. 1/4 TOWNSHIP YPSILANTI T 3 S R 7 E COUNTY WASHTENAW

NOTES	CONDUCTORS				POLES			
	NUMBER	SIZE	KIND	VOLTAGE	LOCATION	LENGTH	CLASS	SET
MATERIALS SHALL BE AS NOTED IN THE CURRENT REVISION OF DETROIT EDISON COMPANY'S GENERAL SPECIFICATIONS FOR OVERHEAD LINE CONSTRUCTION AT RAILROAD CROSSINGS. ACTUAL FIELD DIMENSIONS MAY VARY SOMEWHAT FROM THOSE SHOWN, BUT THE REQUIREMENTS OF THE CURRENT REVISIONS OF ORDER NO'S. 1679 AND 1868 OF MICHIGAN PUBLIC SERVICE COMMISSION WILL BE COMPLIED WITH.	3	0	ACSR	4.8 KV	A	45	4	6.5'
	1	4A2T		120 V.T.	B	50	3	7'
					C	45	4	8.5'
					D	45	4	6.5'

MINIMUM CLEARANCES		
NEAREST POLE TO RAIL	SIDING	7 FT
	MAIN LINE	12 FT
WIRES OVER TRACKS	0 - 750 VOLTS	27 FT
	750 - 15,000 VOLTS	28 FT
	15,000 - 50,000 VOLTS	30 FT
	50,000 - 120,000 VOLTS	33 FT
WIRES OVER R R SIGNAL	0 - 750 VOLTS	2 FT
	750 - 8,700 VOLTS	4 FT
	8,700 - 50,000 VOLTS	6 FT
	50,000 - 120,000 VOLTS	9 FT

DESIGNED BY TERRY SMART DIVISION ANJ ARBOR
CHECKED BY DONNA PHILLIPS SYSTEM ENGINEERING DEPT. DATE 12-13-78

SPAN	SPAN LENGTH	LOWEST CONDUCTOR OVER R. R. TRACKS	STRINGING SAG AT 60° F	HEIGHT OF LOWEST CONDUCTOR OVER	
				R. R. TRACKS	R. R. SIGNAL WIRE
A-B	171' 9"	4A2T 120 V.T. SEC.	34"	32.2'	
B-C	170'	1/4" E.H.S. R. GUY		33'	

SAG TABLE ST. I AL & ACSR
RULING SPAN ST. I - 175 AA
FINAL SAG RATIO 1.24

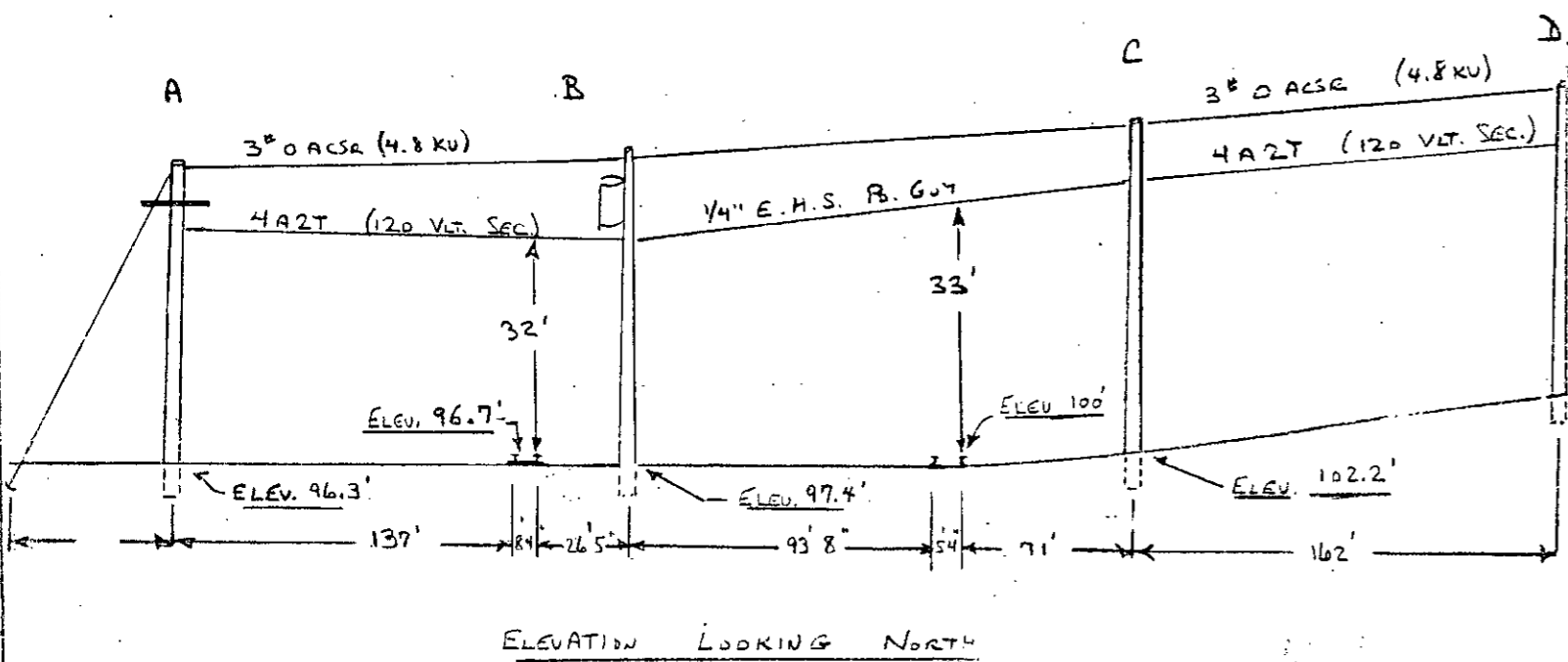
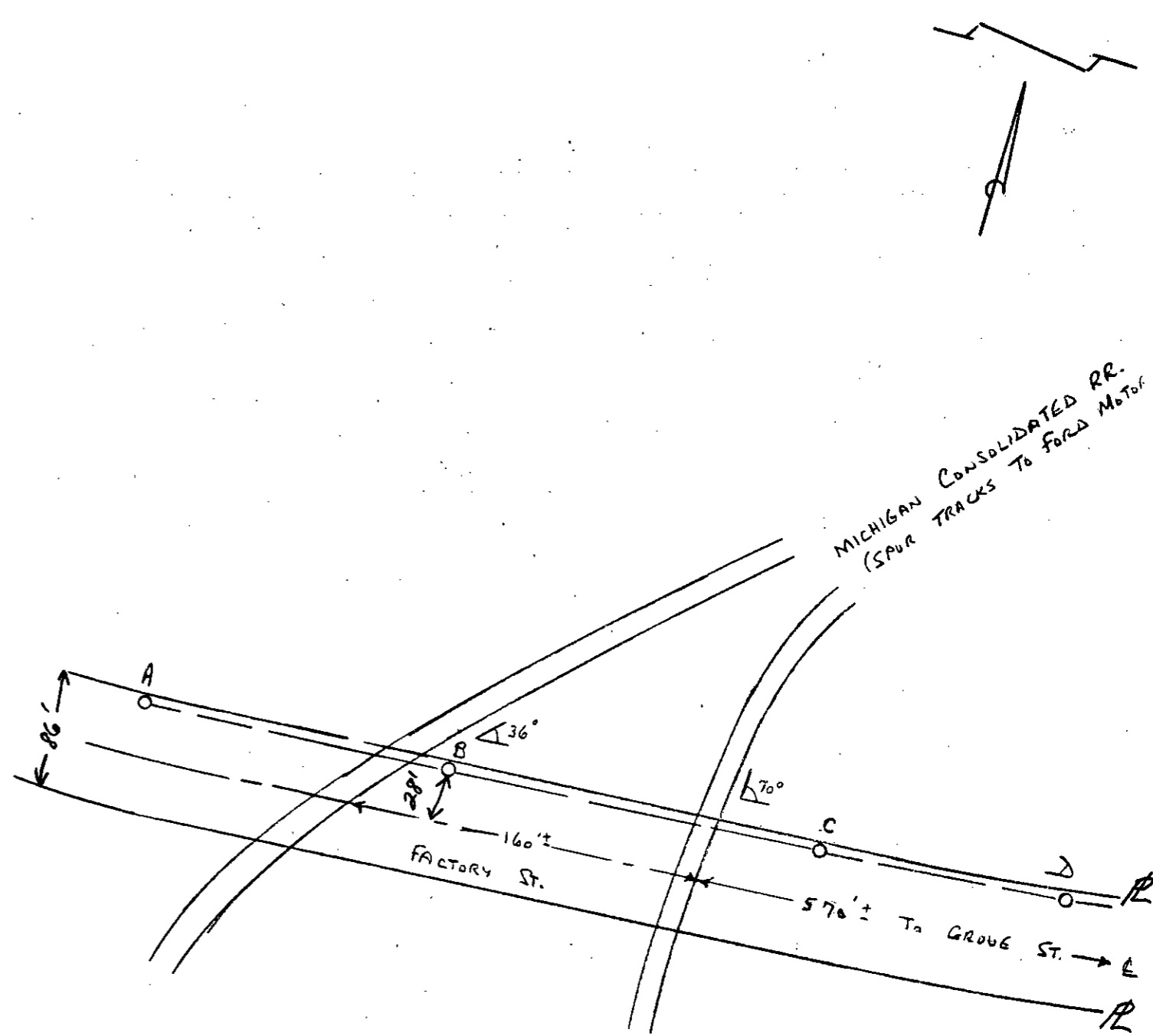

FORD MOTOR CO.

NOTE: POLE "B" EXISTING 45', CL 4 WAS REPLACED WITH A 50', CL 3. TRANSFORMER WAS INSTALLED ON POLE TO SERVE CROSSING SIGNALS LOCATED ON FACTORY STREET.

RECORDED RIGHT OF WAY NO. 31895

gm

April 24, 1979

To: Records Center

From: Yolanda M. Vansteenkiste
Real Estate and Rights of Way Department

Subject: IN FACTORY STREET, 4800 volt crossing over Consolidated Rail Corp., RX-4389A, City of Ypsilanti, Sec. 9, Washtenaw County.

The attached papers are for records center storage. Information about the completed transaction is shown in the following summary.

1 R.R.	3 R.R. INVOICE NO. M.P.S.C. NO. OR R.E. & R.W. NO.	10 Update Type	11 D.E.C.O. RECORDS CENTER FILE NO.	15 R.X. NO. OR MAP NO.	20 Facility	21 Agreement Date
09	00DE292	2	31895	4389A	1	110178
28 Payment Frequency	29 Rental	33 OH-UG Code	34 Division	35 County	36 City or Township	45 Section
X	XXXXX	1	1	12	YPSILAW	09

47 Location 50									
IN FACTORY ST 650' W OF GROVE ST									

Update Type Codes
 1 = New Agreement
 2 = Revised Agreement
 3 = Terminated Agreement

The Accounts Payable Department is requested to start or change the rental payment effective

Approved: *J. A. [Signature]*

- cc: Accounts Payable
 Service Planning
 System Engineering
 Transmission & Distribution

31895



2000 Second Avenue
Detroit, Michigan 48226
(313) 237-8000

March 20, 1979

Mr. David Wilson, Chief Engineer
Dept. of State Highways & Transportation
P.O. Box 1226
18101 Nine Mile Road
Southfield, MI 48075

Gentlemen:

The Detroit Edison Company plans to construct, operate, and maintain an overhead line in Ypsilanti Township, Washtenaw County.

The line will cross the tracks of the Consolidated Rail Corporation. The wires to be installed are:

Span A-B and B-C

Three #0 ACSR, 4800 volts
One #42AT, 120 volts

The railroad has given the following waiver of hearing:

 Waiver dated enclosed
XX Blanket Waiver on file with the MPSC.

The proposed crossing is shown on drawing No. RX- 4389A

 This is a new crossing.
XX This is a re-construction.

Please grant a State Highway Permit to the Detroit Edison Company for the proposed crossing.

APPLICATION NO. 81000-16-79R
Permit No. JN-115-79

RECEIVED

Date 4-4-79
By John Fomsky
Dist. Utility Permits Engineer

MAR 29 1979

Very truly yours,
JACKSON DISTRICT #8
Michigan State Highway Department

 Leslie G. Sundstrom
Leslie G. Sundstrom
Office Supervisor
Real Estate & Rights of Way
630 WCB

no fee

RECORDED
31895

PROPOSED LINE CROSSING OVER MICHIGAN CONSOLIDATED RR. EXISTING PERMIT NUMBER NEW
IN FACTORY ST. APPROX. 650' WEST OF GROVE ST. CITY OF YPSILANTI

SECTION 9 S.E. 1/4 TOWNSHIP YPSILANTI T3S R7E COUNTY WASHTENAW

		CONDUCTORS				POLES			
		NUMBER	SIZE	KIND	VOLTAGE	LOCATION	LENGTH	CLASS	SET
NOTES MATERIALS SHALL BE AS NOTED IN THE CURRENT REVISION OF DETROIT EDISON COMPANY'S GENERAL SPECIFICATIONS FOR OVERHEAD LINE CONSTRUCTION AT RAILROAD CROSSINGS. ACTUAL FIELD DIMENSIONS MAY VARY SOMEWHAT FROM THOSE SHOWN, BUT THE REQUIREMENTS OF THE CURRENT REVISIONS OF ORDER NO'S. 1679 AND 1868 OF MICHIGAN PUBLIC SERVICE COMMISSION WILL BE COMPLIED WITH.		3	0	ACSR	4.8KV	A	45	4	6.5'
		1	4A2T		120 V.T.	B	50	3	7'
						C	45	4	8.5'
						D	45	4	6.5'
MINIMUM CLEARANCES									
NEAREST POLE TO RAIL	SIDING	7 FT							
	MAIN LINE	12 FT							
WIRES OVER TRACKS	0 - 750 VOLTS	27 FT							
	750 - 15,000 VOLTS	29 FT							
	15,000 - 50,000 VOLTS	30 FT							
	50,000 - 120,000 VOLTS	33 FT							
WIRES OVER R R SIGNAL	0 - 750 VOLTS	2 FT							
	750 - 8,700 VOLTS	4 FT							
	8,700 - 50,000 VOLTS	6 FT							
	50,000 - 120,000 VOLTS	9 FT							
		DESIGNED BY <u>TERRY SMART</u>		DIVISION <u>ANN ARBOR</u>					
		CHECKED BY <u>DONNA PHILLIPS</u>		SYSTEM ENGINEERING DEPT.		DATE <u>12-13-72</u>			
SPAN	SPAN LENGTH	LOWEST CONDUCTOR OVER R. R. TRACKS	STRINGING SAG AT 60° F	HEIGHT OF LOWEST CONDUCTOR OVER					
A-B	171' 9"	4A2T 120 V.T. SEC.	34"	R. R. TRACKS	32.2'				
B-C	170'	1/4" E.H.S. R. GUY	— D —	R. R. SIGNAL WIRE	33'				

SAG TABLE ST. I AL & ACSR
 RULING SPAN ST. I - 175 AA
 FINAL SAG RATIO 1.24

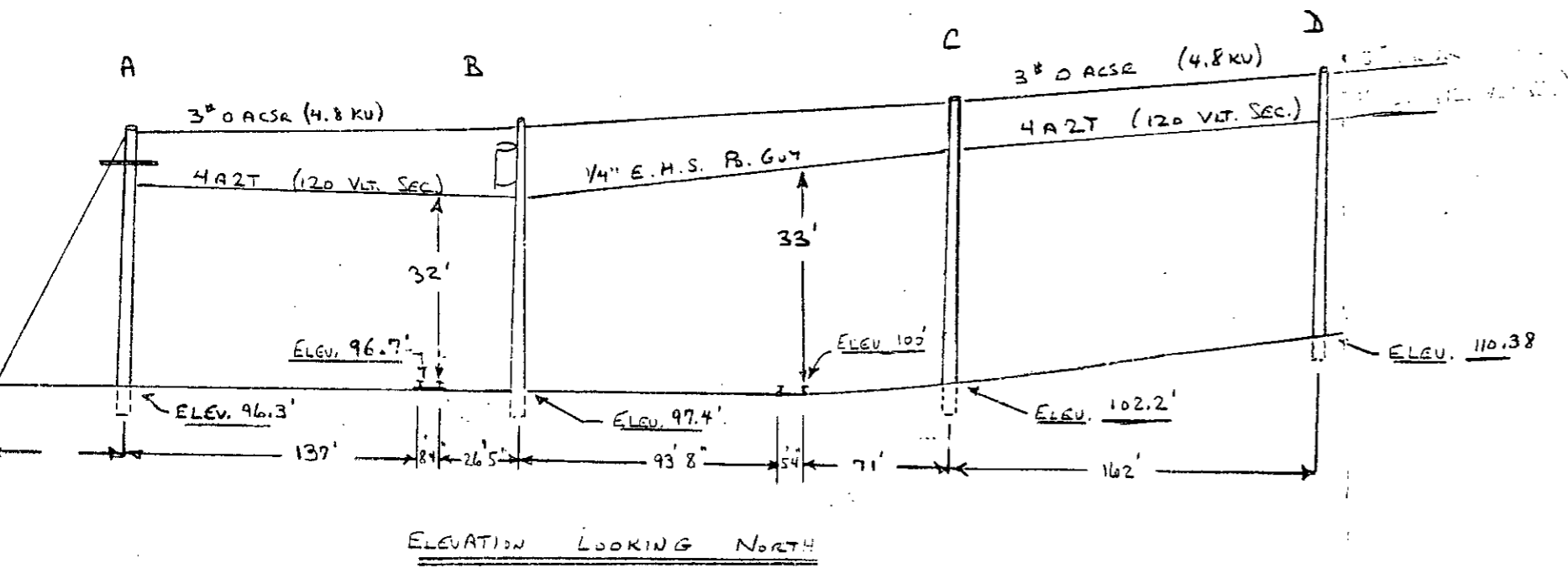
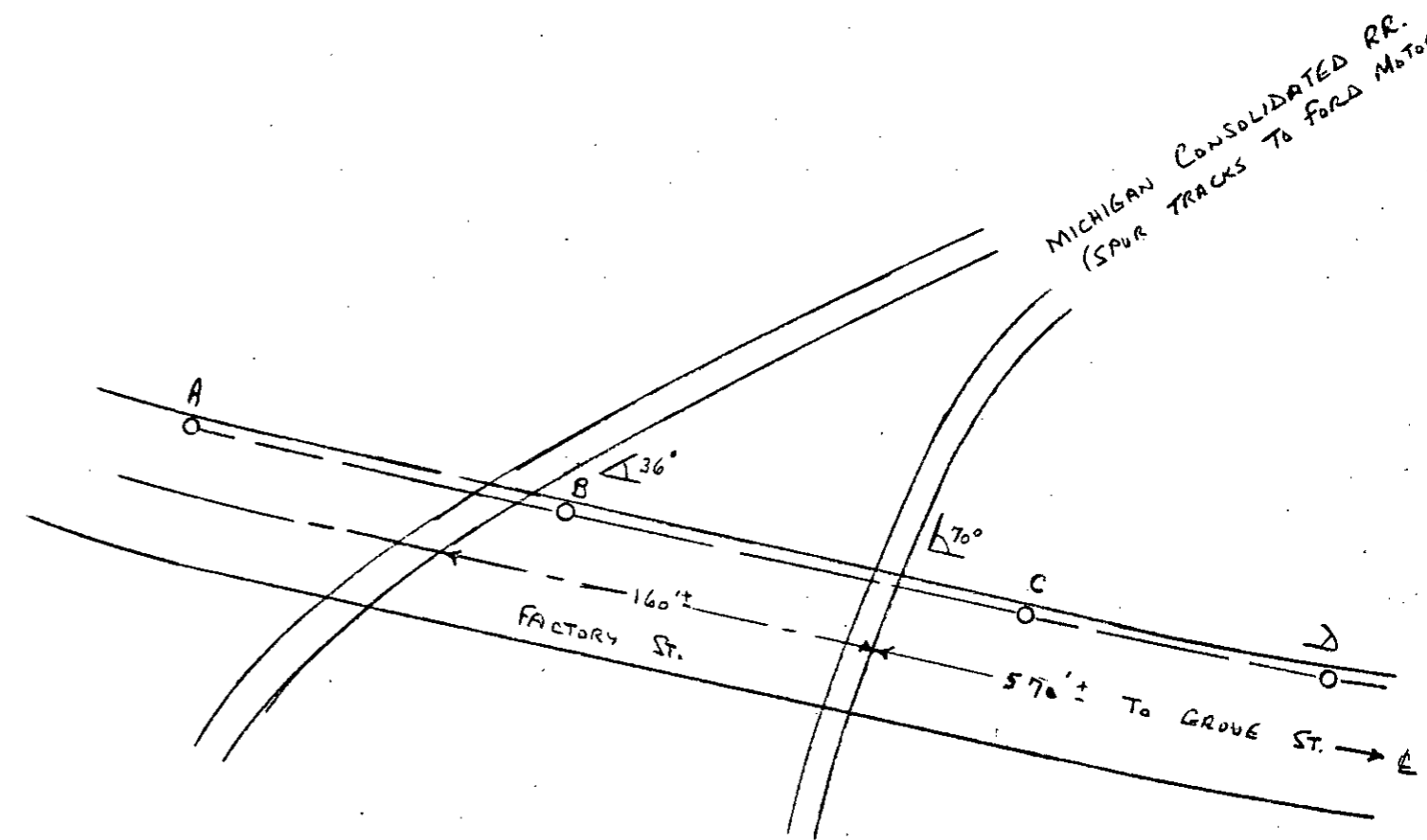

FORD MOTOR CO.